



Cubo™ SG45 & SG150 Gas Line Instruction

1. Install Gas Line as shown in **Figure 1. below.**
 - Configurations vary slightly between SG45 and SG150. The 55907 Adapter and 55906 Bushing is not required on the SG45.
2. Use Gas Pipe Tape (Supplied) on Threaded Connections.
3. The Gas Regulator (55897) includes a Vent Limiter and may be installed indoors near the unit. Ensure that the Vent Limiter is oriented vertically. Install so that when unit is tipped over for cleaning, regulator will not interfere with cabling.
4. The Gas Regulator (55897) comes with a Red Spring Pre-installed capable of 10-22 in. w.c. It is not pre-set to a certain pressure. If using propane gas, operating pressure should be 12-15 in. w.c. Therefore, adjustment is required. For Natural gas, operating pressure should be 7-9 in. w.c. To achieve this lower pressure the Violet Regulator Spring (56242-1) must be installed in place of the Red Spring supplied in the Regulator. Refer to the Cubo manual for exact gas pressures.

Gas Supply Line

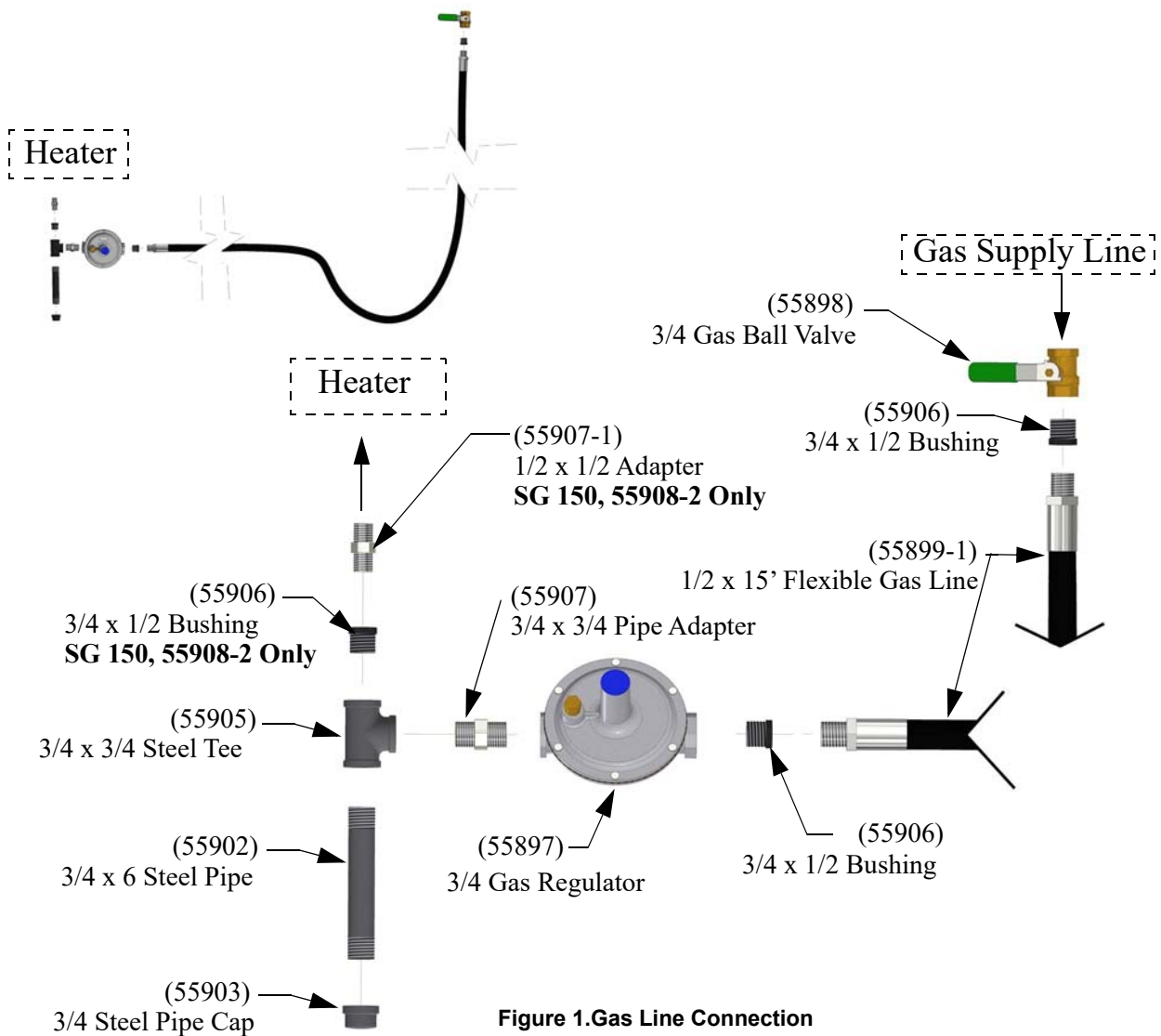
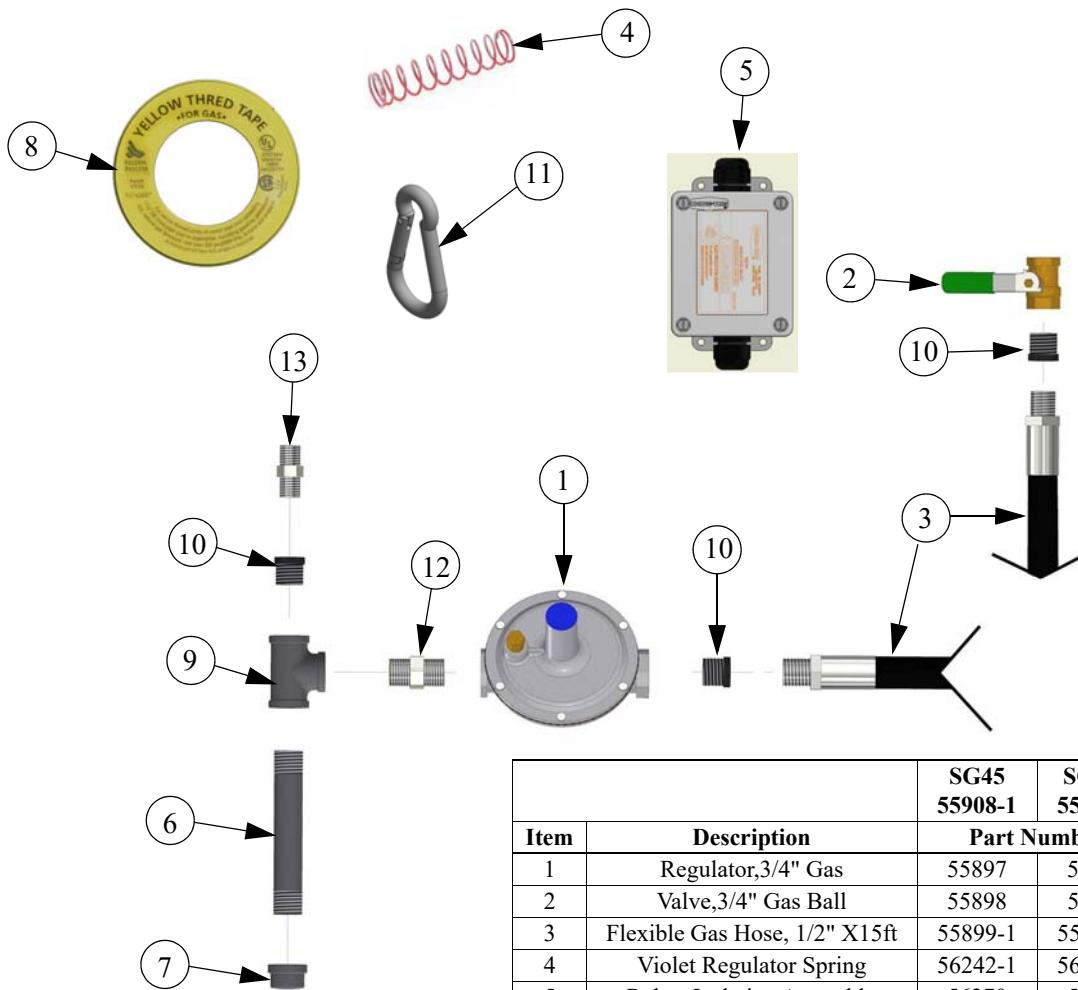

Figure 1. Gas Line Connection

Part Numbers



| Item | Description | SG45 | SG150 |
|------|-------------------------------|----------|----------|
| | | 55908-1 | 55908-2 |
| 1 | Regulator,3/4" Gas | 55897 | 55897 |
| 2 | Valve,3/4" Gas Ball | 55898 | 55898 |
| 3 | Flexible Gas Hose, 1/2" X15ft | 55899-1 | 55899-1 |
| 4 | Violet Regulator Spring | 56242-1 | 56242-1 |
| 5 | Relay, Isolation Assembly | 56270 | 56270 |
| 6 | 3/4" X 6" Steel Pipe | 55902 | 55902 |
| 7 | Cap,3/4" Steel Pipe | 55903 | 55903 |
| 8 | Gas Pipe Tape | 55904 | 55904 |
| 9 | 3/4"X 3/4" Steel Tee | 55905 | 55905 |
| 10 | 3/4"X 1/2" Bushing | 55906 | 55906 |
| 11 | Spring Snap 1/4" Hook | 39-20485 | 39-20485 |
| 12 | 3/4" Threaded Pipe Adapter | 55907 | 55907 |
| 13 | 1/2" Threaded Pipe Adapter | -- | 55907-1 |

Revisions to this Manual

| Page No. | Description of Change | ECO |
|----------|---|-------|
| | Moved Regulator, Switched to 1/2" ID hose, and removed quick connect coupler. | 33517 |

Contact your nearby Chore-Time distributor or representative for additional parts and information.
CTB Inc.

P.O. Box 2000 • Milford, Indiana 46542-2000 • U.S.A.
Phone (574) 658-4101 • Fax (877) 730-8825
E-Mail: ctb@ctbinc.com • Internet: <http://www.ctbinc.com>
Printed in the U.S.A.