

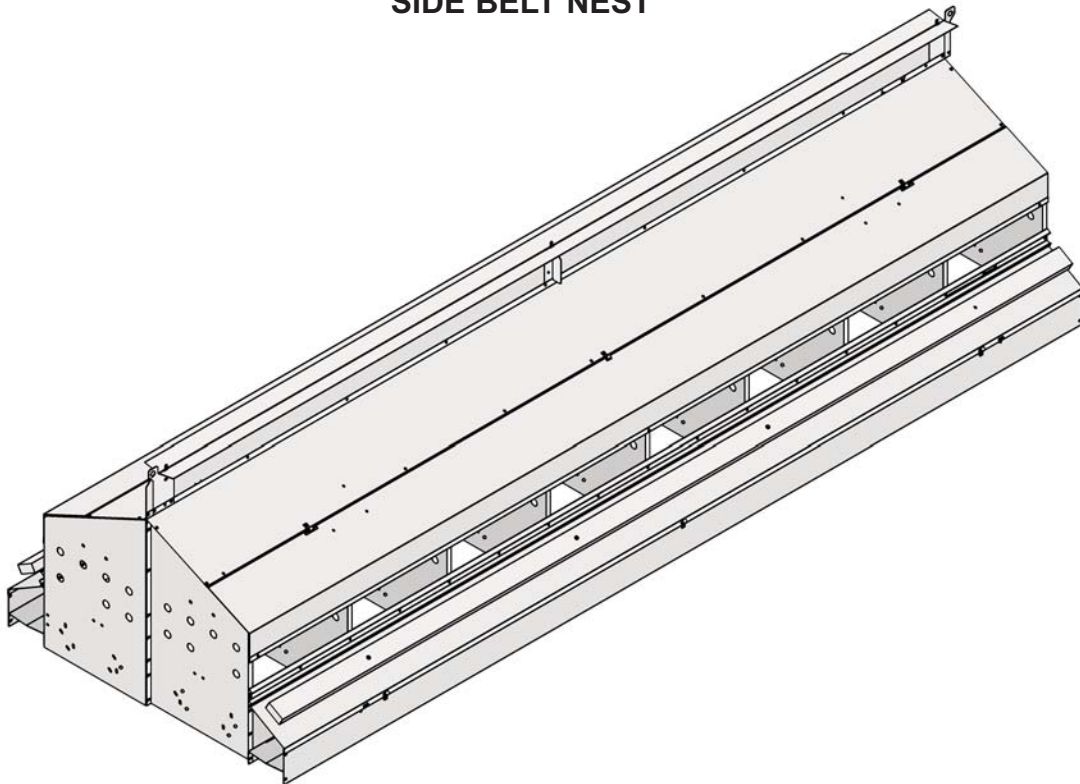

## Assembly Instructions

### SIDE BELT NEST



*Made to Work. Built to Last.*<sup>SM</sup>  
P.O. Box 2000 State Road 15 North  
Milford, IN. 46542-2000 U.S.A.  
574-658-4101 Fax 877-730-8825  
[www.ctbinc.com](http://www.ctbinc.com)

Made in the U.S.A.

**Note:** The original, authoritative version of this manual is the English version produced by CTB, Inc. or any of its subsidiaries or divisions, (hereafter collectively referred to as "CTB"). Subsequent changes to any manual made by any third party have not been reviewed nor authenticated by CTB. Such changes may include, but are not limited to, translation into languages other than English, and additions to or deletions from the original content. CTB disclaims responsibility for any and all damages, injuries, warranty claims and/or any other claims associated with such changes, inasmuch as such changes result in content that is different from the authoritative CTB-published English version of the manual. For current product installation and operation information, please contact the customer service and/or technical service departments of the appropriate CTB subsidiary or division. Should you observe any questionable content in any manual, please notify CTB immediately in writing to: CTB Legal Department, P.O. Box 2000, Milford, IN 46542-2000 USA.

# ASSEMBLY INSTRUCTIONS FOR 8' SIDE BELT NEST (16 & 20 Hole)

This guide will address the assembly of and parts identification for the revised side belt nest of common partition design. This guide will also include attachment of and parts identification for the passageways.

Installation of the collection table, variable speed control and egg belt as well as system operation will be covered in a separate document.

**⚠ WARNING:** Improper installation, adjustment, alteration, service or maintenance can cause property damage, injury or death. Read the installation, operating and maintenance instructions thoroughly before installing or servicing this equipment.

L'installation déplacée, l'ajustement, le changement, le service ou l'entretien peuvent causer les dommages de propriété, la blessure ou la mort. Lire l'installation, fonctionnant et les instructions d'entretien à fond avant d'installer ou entretenir cet équipement.

La instalación impropia, ajuste, modificación, servicio o mantenimiento puede causar dañado propiedad, herida o muerte. Lea la instalación, trabajar y mantenimiento instrucciones completamente antes de instalar o poner en funcionamiento equipo.

## **DANGER**

**Take necessary precautions when working with sheet metal, edges may be SHARP!**



**Faites attention quand travaillant avec feuillet, les bords peuvent être AIGUISÉ !**

**¡Tome las precauciones necesarias al trabajar con metal laminado, las orillas pueden ser AGUDAS!**

Read assembly guide completely before beginning setup. For most efficient assembly, two people should work together on nests.

Lire assemblée guide avant que commencer. Deux gens devoir travailler ensemble sur les nids.

Lea la asamblea guía completamente antes de empezar montaje. Para la más asambleas eficientes, dos personas deben trabajar juntos en nidos.

## SIDE BELT NEST BODY ASSEMBLY AND INSTALLATION INSTRUCTIONS

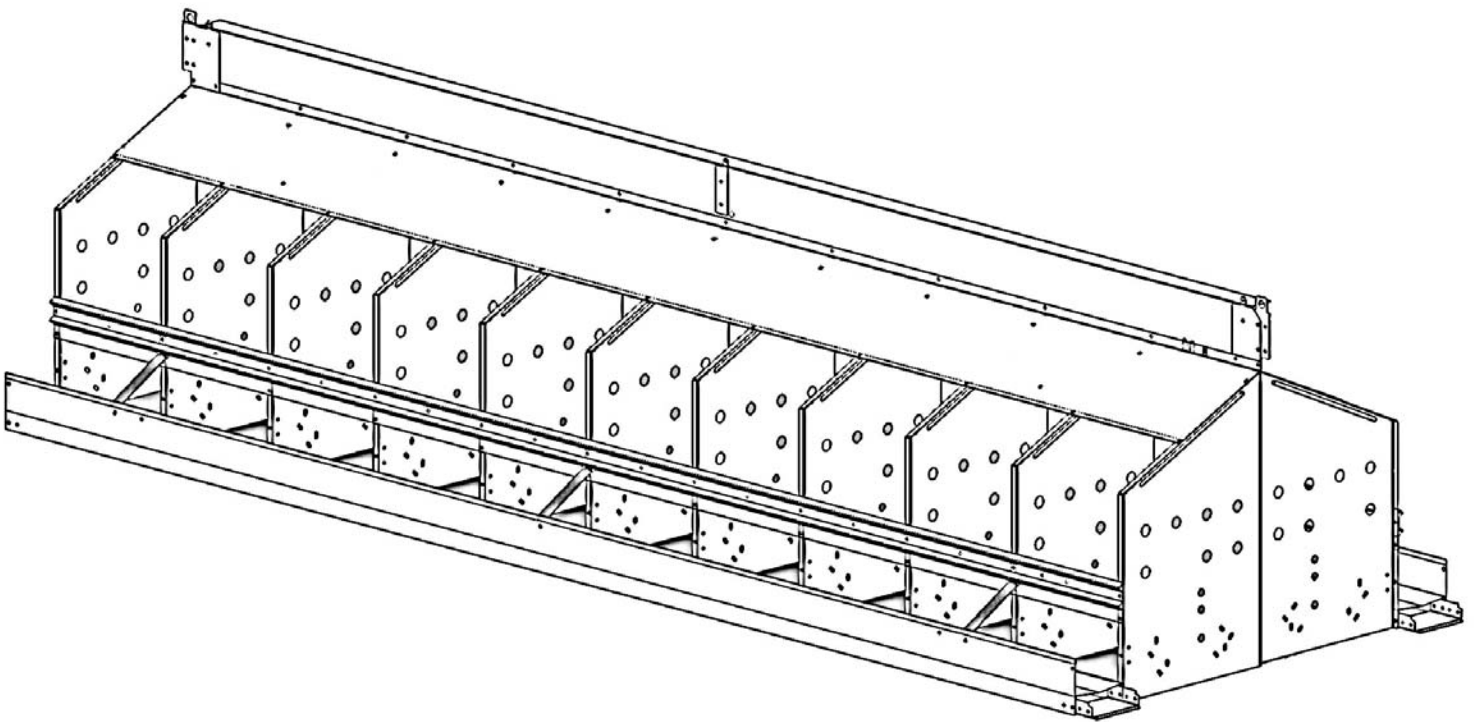
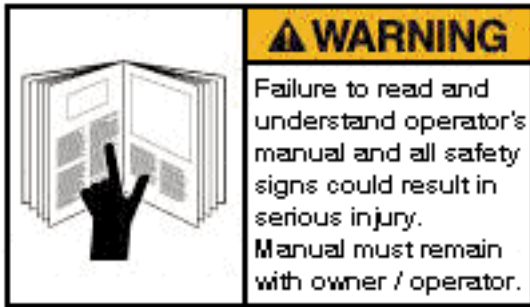

# 20 HOLE NEST (narrow) 9.6"

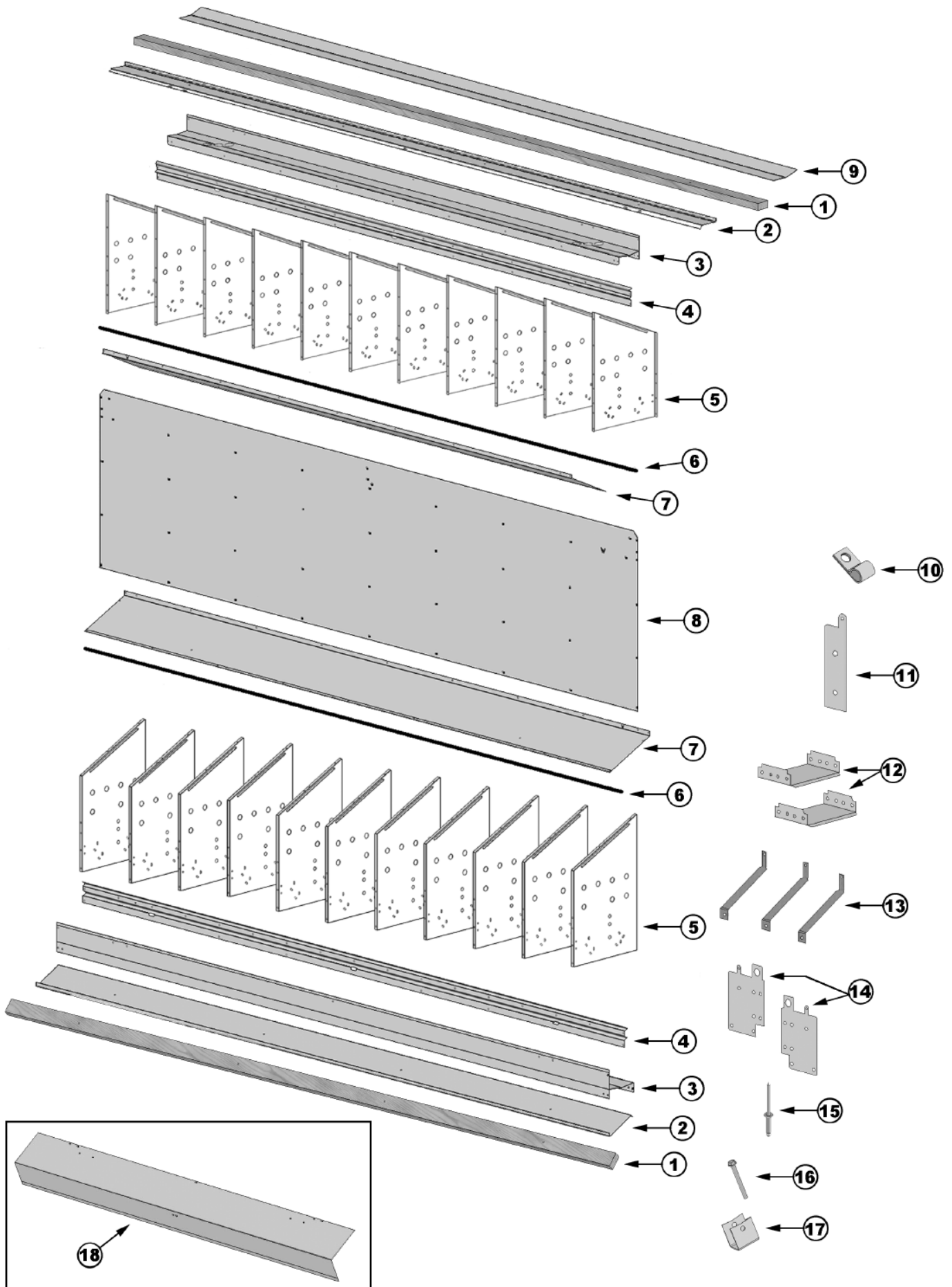

## 20HOLE NEST (narrow)

1	16-34533	PERCH: 95" - DRILLED	2
2	16500017	TOP: 9.6" HOLE UNIV. NEST	2
3	16560012	TRAY ASM: 20 HOLE SIDE BELT	2
4	16560008	STRINGER: 20 HOLE NEST UNIV.	2
5	16500166	PARTITION:NEST UNIV-RTNR HOLES	22
6	16060026	WIRE:BTM SUPPRT GLV #5 95.125"	4
7	16500010	TOP: 9.6" HOLE UNIV. NEST	2
8	16560040	BACK: 20 HOLE CHORE-TIME	1
9	16-30190	FLIPPER, 8FT NEST UNIV.	1
10	16-8904	CLAMP: HINGE SS 3/8 WIDE	6
11	16-34790	BRACKET, S.BELT CENTER FLIPPER	1
12	16560017	BRACKET:EGG TRAY CHANNEL CONN.	2
13	16560004	BRACE, EGG TRAY SIDE BELT	6
14	16560016	BRACKET,NEST SUSP. & JOINT	2
15	16-34096	RIVET: POP 3/16" AL AD62ABS SH	150
16	16-90078	SCREW:10-24 x 2-1/4 HX HD WHSR	8
17	16500006	BRKT: PERCH / ROD SUPPORT UNIV	16

### OPTIONAL EQUIPMENT

12	16500016	LID: SIDEBELT CLOSEOUT UNIV.	2
ADDITIONAL 6 HINGE CLAMPS REQUIRED FOR CLOSEOUT LIDS			

### PARTS NOT SHOWN IN ILLUSTRATION

16-12500	PIN: COTTER STEEL 1/8" X 3/4"	3
16560036	RIVET PACK,NEST FRONT & HINGE	1
16-90076	NUT, HEX 10-24 W/NYLON INSERT	20
16-90077	SCREW,HX HD MACH 10-24 x 1/2	12

### NEST KIT PART NUMBERS

61911201	20 HOLE WITH LIDS
61911101	20 HOLE WITHOUT LIDS



16 HOLE NEST (wide) 12"

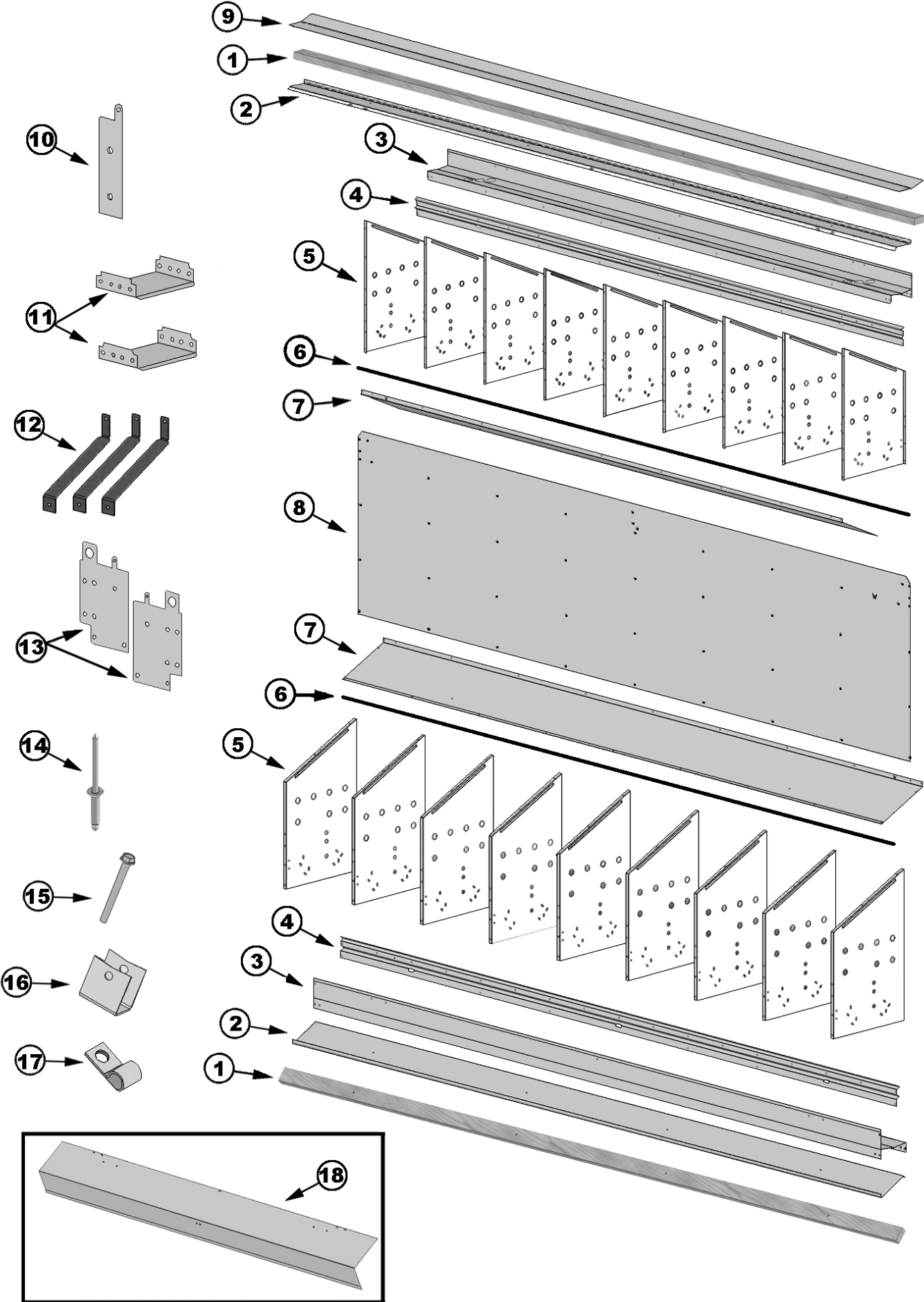

## 16 HOLE

1	16-34533	PERCH: 95" - DRILLED	2
2	16500017	COVER, EGG TRAY SIDEBELT NEST	2
3	16560013	TRAY ASM: 16 HOLE SIDE BELT	2
4	16560007	STRINGER: 16 HOLE NEST UNIV.	2
5	16500166	PARTITION:NEST UNIV-RTNR HOLES	18
6	16060026	WIRE:BTM SUPPRT GLV #5 95.125"	4
7	16500009	TOP: 12" HOLE UNIV. NEST	2
8	16560039	BACK: 16 HOLE CHORE-TIME	1
9	16-30190	FLIPPER, 8FT NEST UNIV.	1
10	16-34790	BRACKET, S.BELT CENTER FLIPPER	1
11	16560017	BRACKET:EGG TRAY CHANNEL CONN.	2
12	16560004	BRACE, EGG TRAY SIDE BELT	6
13	16560016	BRACKET,NEST SUSP. & JOINT	2
14	16-34096	RIVET: POP 3/16" AL AD62ABS SH	125
15	16-90077	SCREW,HX HD MACH 10-24 x 1/2	8
16	16500006	BRKT: PERCH / ROD SUPPORT UNIV	16
17	16-8904	CLAMP: HINGE SS 3/8 WIDE	6

## OPTIONAL EQUIPMENT

18	16500016	LID: SIDEBELT CLOSEOUT UNIV.	2
ADDITIONAL 6 HINGE CLAMPS REQUIRED FOR CLOSEOUT LIDS			

## PARTS NOT SHOWN IN ILLUSTRATION

16-12500	PIN: COTTER STEEL 1/8" X 3/4"	3
16560036	RIVET PACK,NEST FRONT & HINGE	1
16-90076	NUT, HEX 10-24 W/NYLON INSERT	20
16-90077	SCREW,HX HD MACH 10-24 x 1/2	12

## NEST KIT PART NUMBERS

61921201	16 HOLE WITH LIDS
61921101	16 HOLE WITHOUT LIDS

**STEP 1.** Attach **Partitions** to the **Back** as shown. The rivet should capture both partition flanges and the back. Orientation of the “N” or “W” I.D. stamping on the **Back** is not critical.

I.D. LETTER

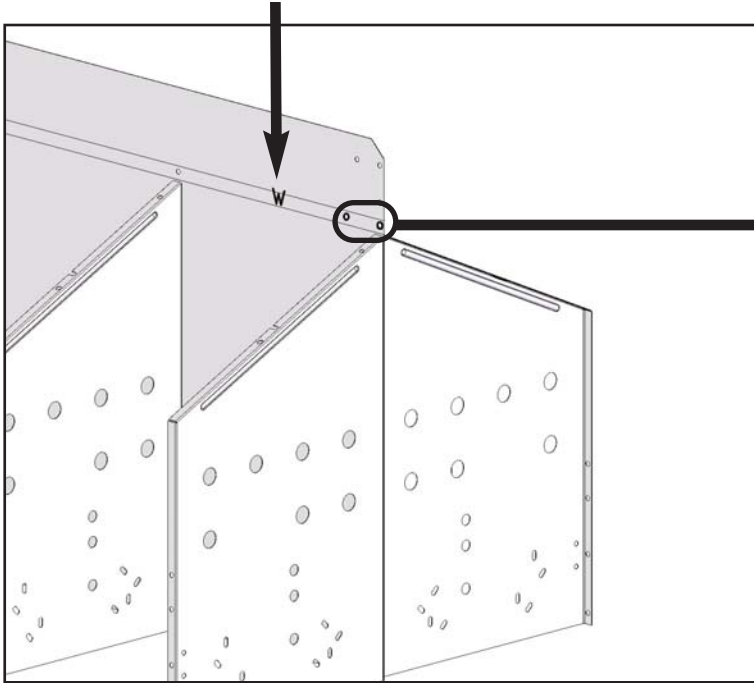

Do not rivet top at both ends at this step.

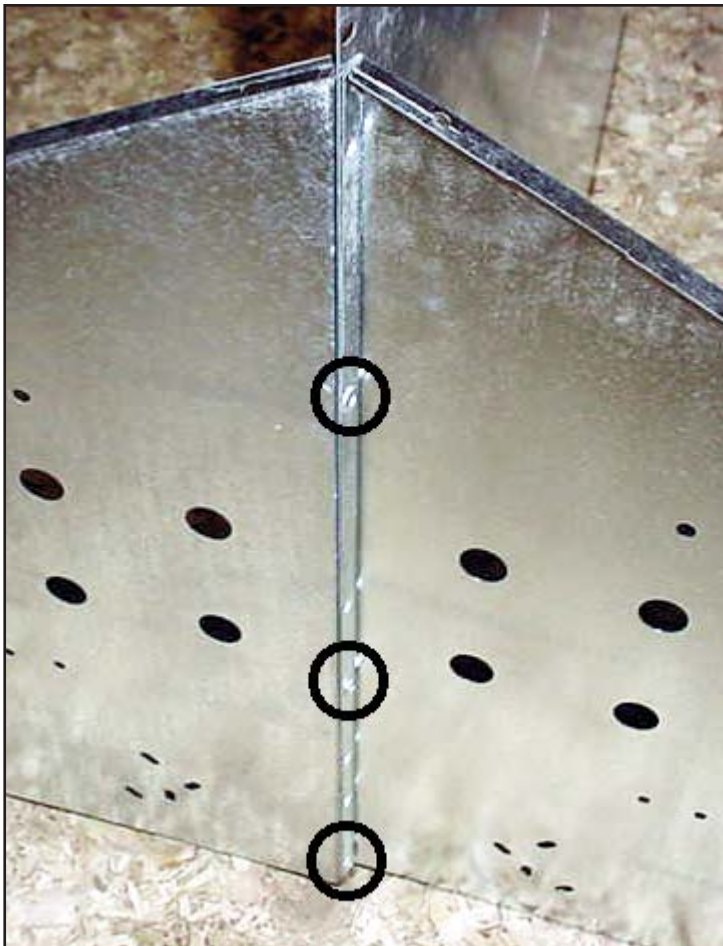

Fasten two partitions to back using **THREE** rivets.



**STEP 2.** Attach egg trays to partitions.

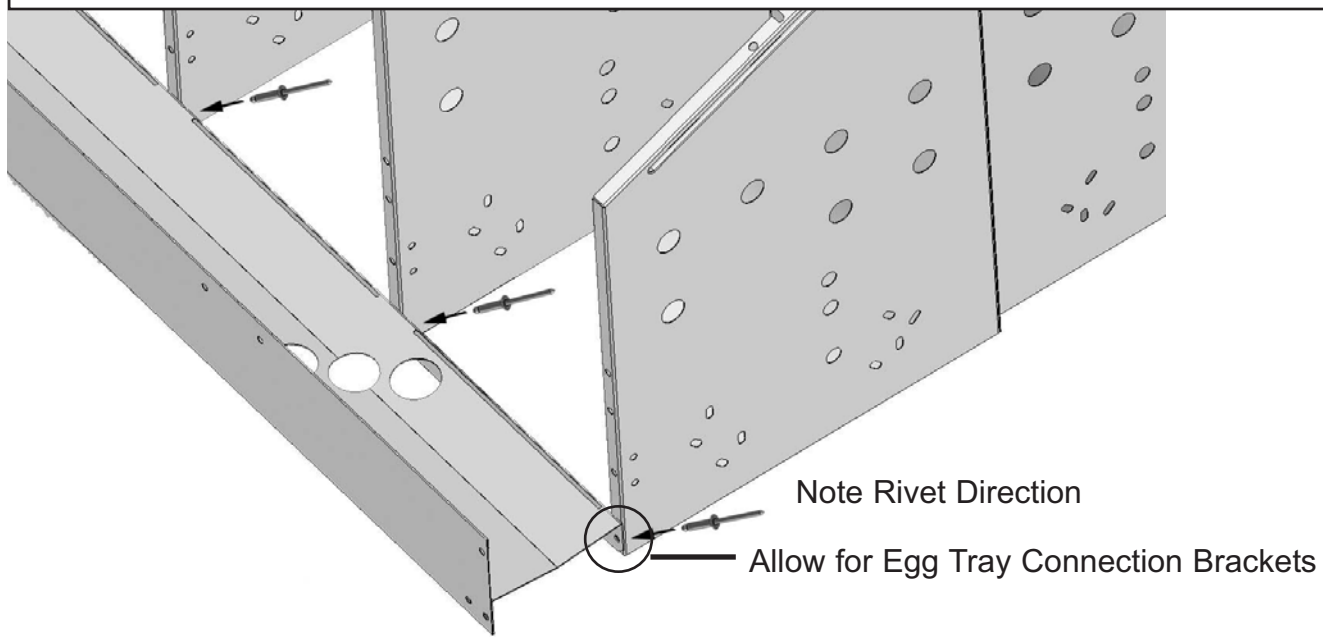

Attach connection brackets to one end (2 places) or both ends (4 places) of nest body depending on single, double or triple nest grouping in house.

Egg tray connector attached using FOUR rivets on each end of egg trays.

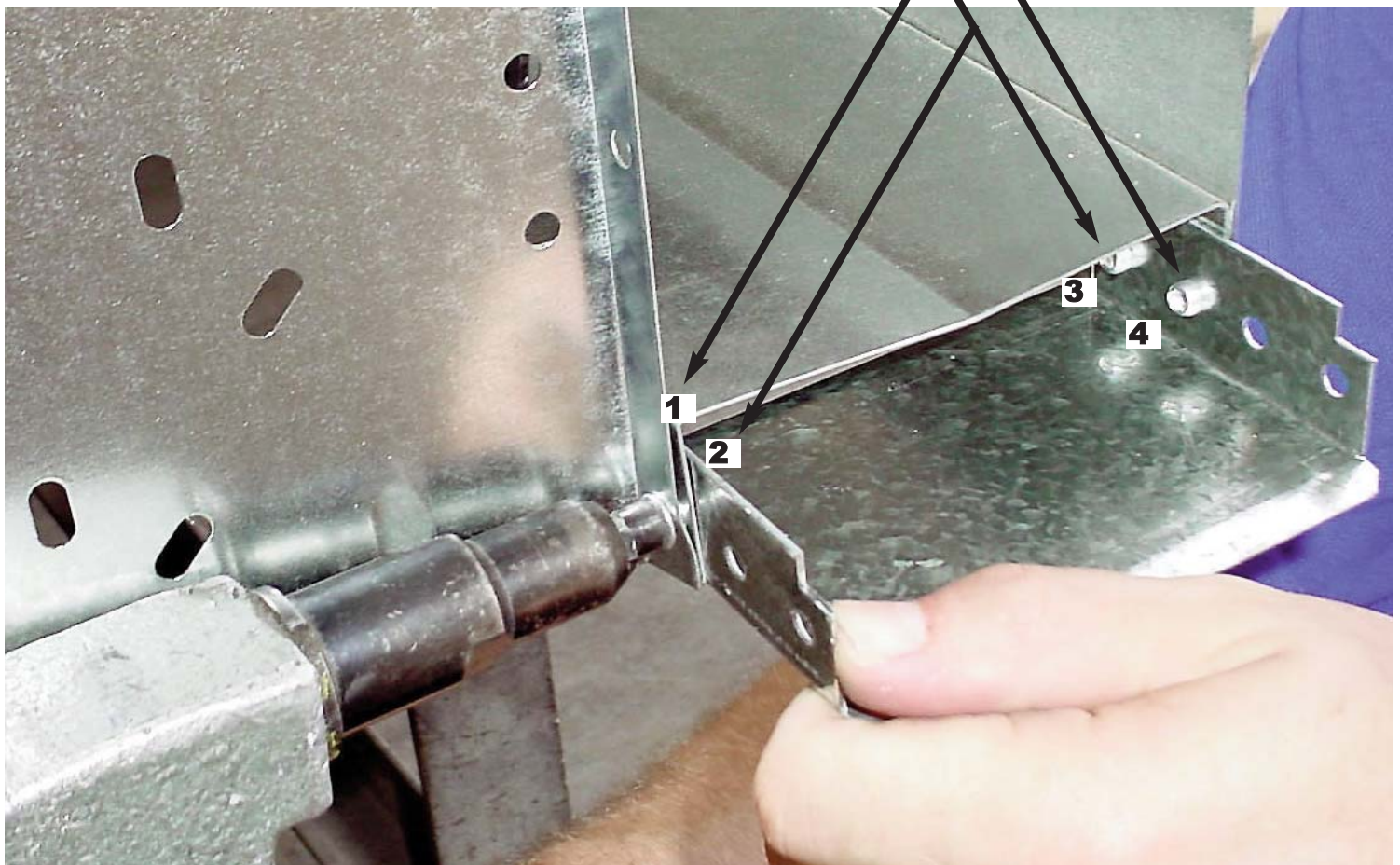

**NOTE.** For nests not using plastic fronts, skip to Step 4. See picture for example.



Nest **NOT** using plastic fronts.



**NOTE:** For Nests Using Plastic Fronts:

## **ATTENTION** ⚠ **USE LONG RIVETS FOR:** **Plastic Nest Front Attachment**

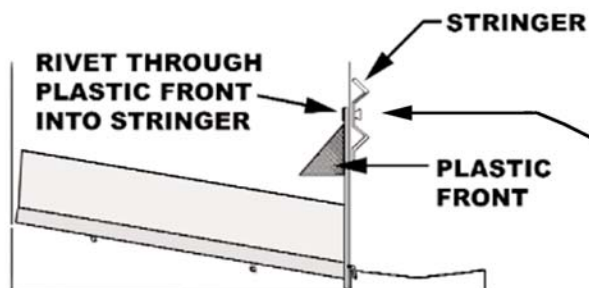

### **Pop-Rivet Detail**

16-33139



Enclosed in bag,  
use HERE

SHOWN FOR REFERENCE

16-34096



Shipped in bulk  
with nest parts.



**STEP 3.** For nests using plastic fronts, attach fronts to stringer as shown. Insert **Rivet** through plastic front into **Stringer**.

Rivet through plastic into stringer.

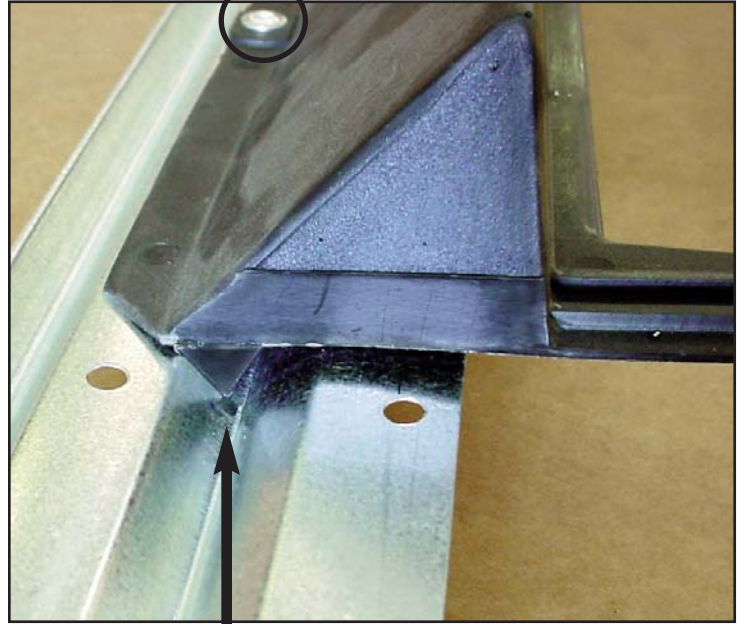

Triangle shaped tabs on Fronts should lock into stringers as shown.

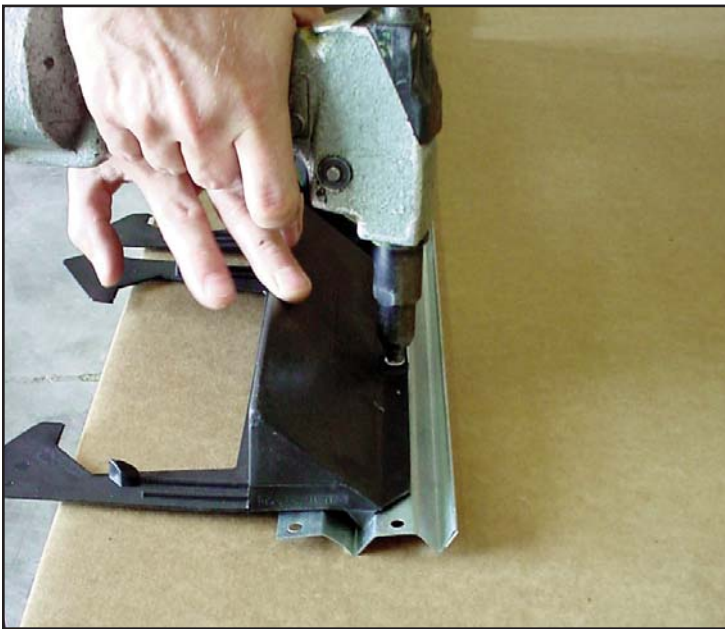

**STEP 4.** Attach Front/Stringer Assembly as shown. Attach **Egg Tray Braces** (narrow end) between the **Stringer** and the **Partitions** at the following positions:

- a. 20-Hole nests : Partitions #2, #6 and #10.
- b. 16-Hole Nests : Partitions #2, #5 and #8.

Step 5 shows how to attach the wide end of the bracket to the Egg Tray Assembly.

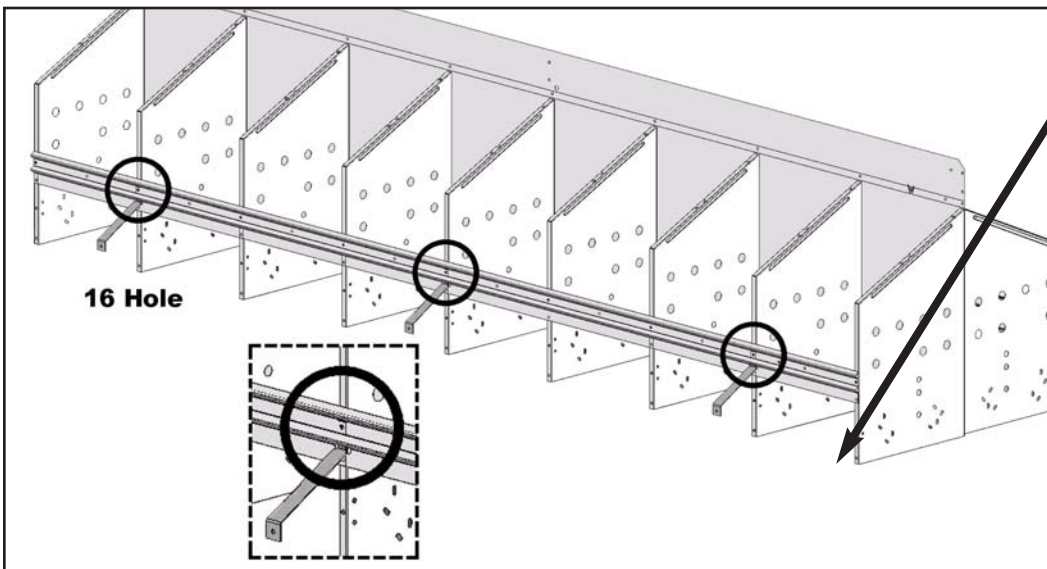
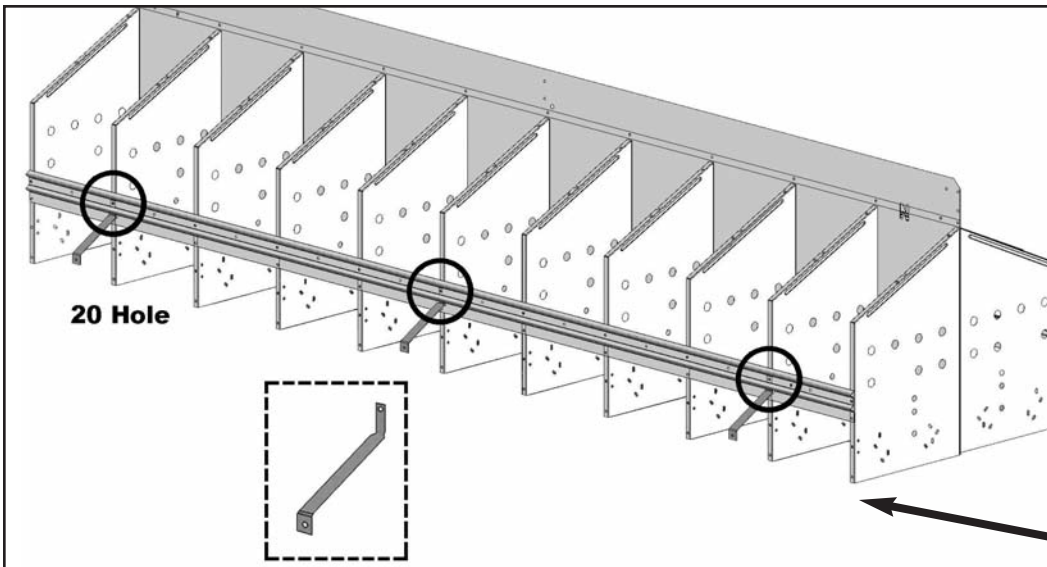

**NOTE:**

Egg Tray Assemblies and Fronts are not shown in the illustrations for clarity of instruction.





**STEP 5.** Attach the **Egg Tray Covers** as follows:

- Compress **Hinge Clamp** with pliers or guide nail and align with middle **Egg Tray Brace**. Fasten with long rivet from RIVET PACK through **Hinge**, **Egg Tray** and **Tray Brace**.
- Insert **Hinge Clamp** into middle slot on **Tray Cover** flange.
- Repeat for **Cover/Hinge/Egg Tray/ Bracket** connection on each end of cover.

Covers should 'latch' closed beneath **Stringer** when hinges are installed properly. Open covers again for Step 6.

**ATTENTION** ⚠  
**USE LONG RIVETS FOR:  
Hinge Attachment**

RIVET THROUGH HINGE  
FOR LID ATTACHMENT

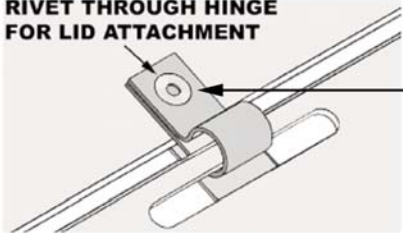

**Pop-Rivet Detail**

16-33139



Enclosed in  
bag,  
use HERE

SHOWN FOR REFERENCE

16-34096



Shipped in bulk  
with nest parts.

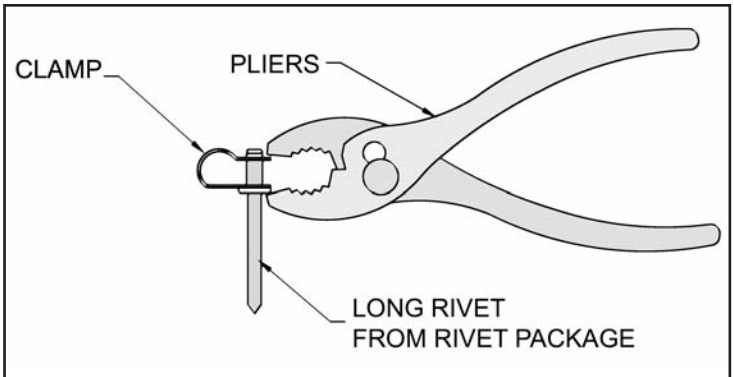

Close-up view of **Hinge**

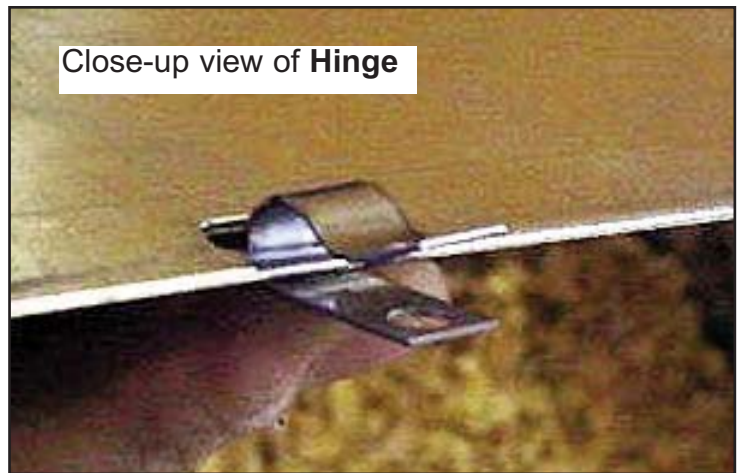

View of rivet through **Hinge**, **Egg Tray** and **Bracket**.



Close-up view of **Rivet** installed





**STEP 6.** Install **Perch Brackets** and wooden **Perch** to **Egg Tray Covers** as shown. The shallow 'V' in the ends of the bracket legs should install toward the wooden **Perch**.

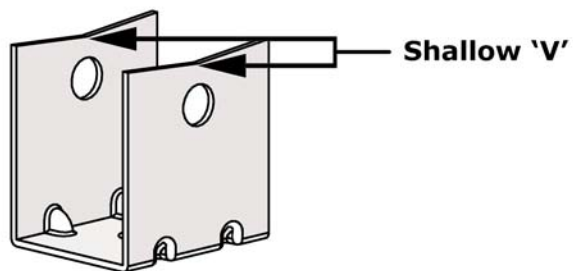
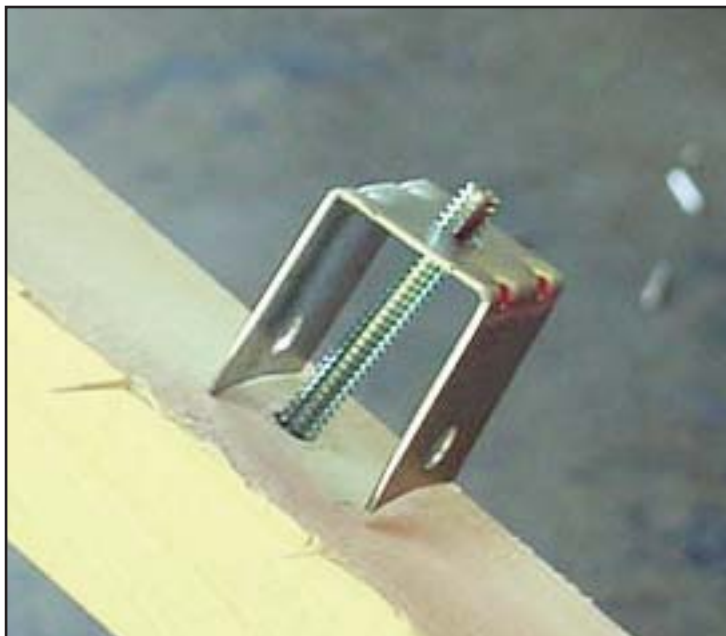

**Perch Bracket**  
16500006



**STEP 7-A.** Slide **Support Rods** through the appropriate positioning slots in the end partition.  
See Diagrams below.

**USE THESE HOLES.**

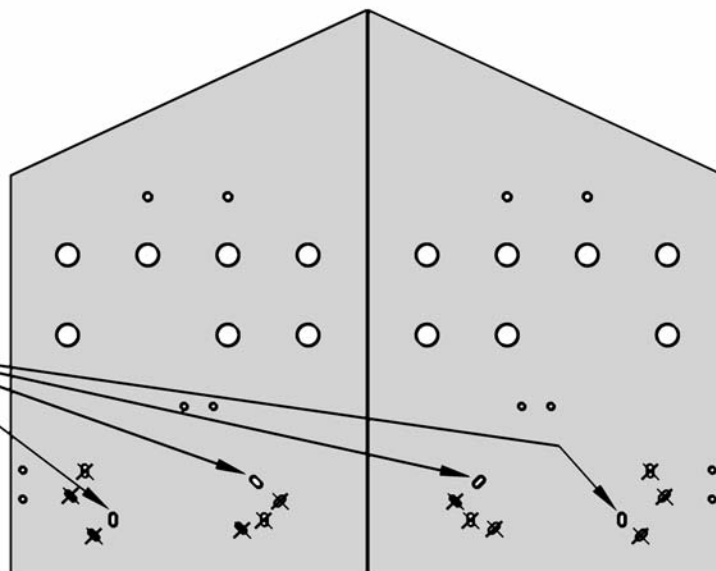

**Rod Positions For  
MOLDED BOTTOM & CHUTE  
In Side Belt Nests**

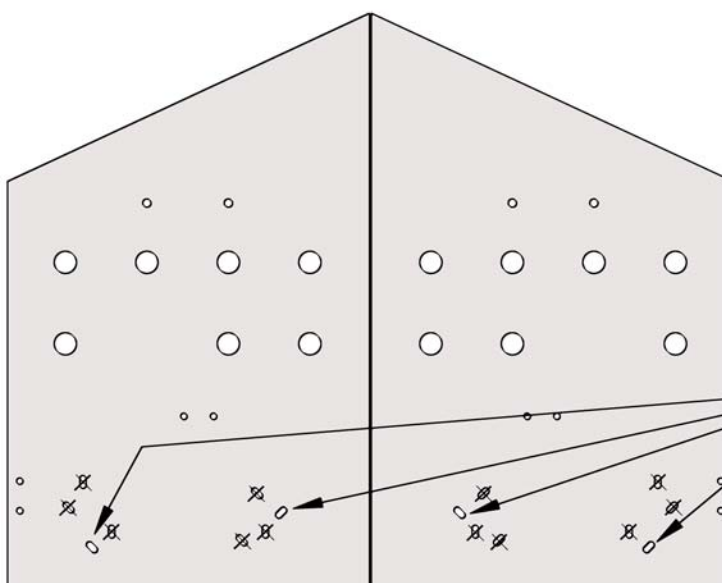
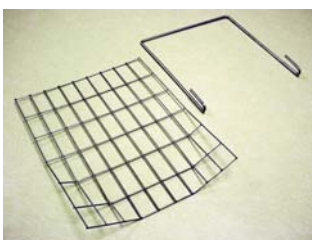

**USE THESE HOLES.**

**Rod Positions For  
PLASTIC & WIRE BOTTOMS  
In Side Belt Nests**

**STEP 7-B.** Install **Support Rod/Perch Brackets** with rivets on End Partitions only.

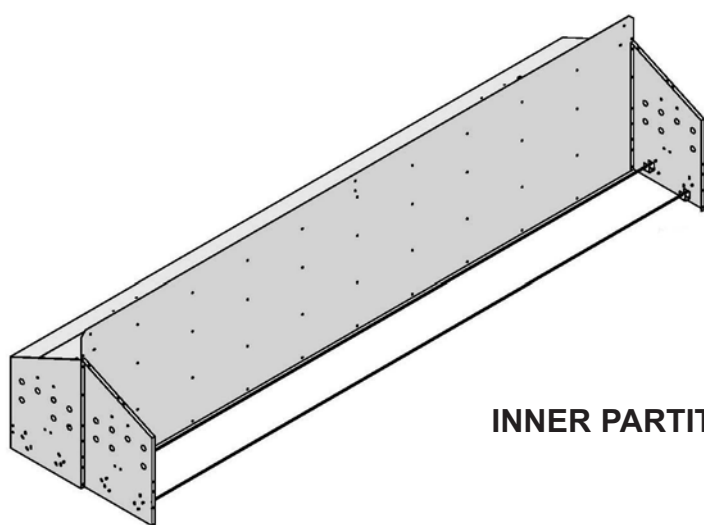

Support Rod installation and Rod Support Bracket locations.

**INNER PARTITIONS NOT SHOWN FOR CLARITY**

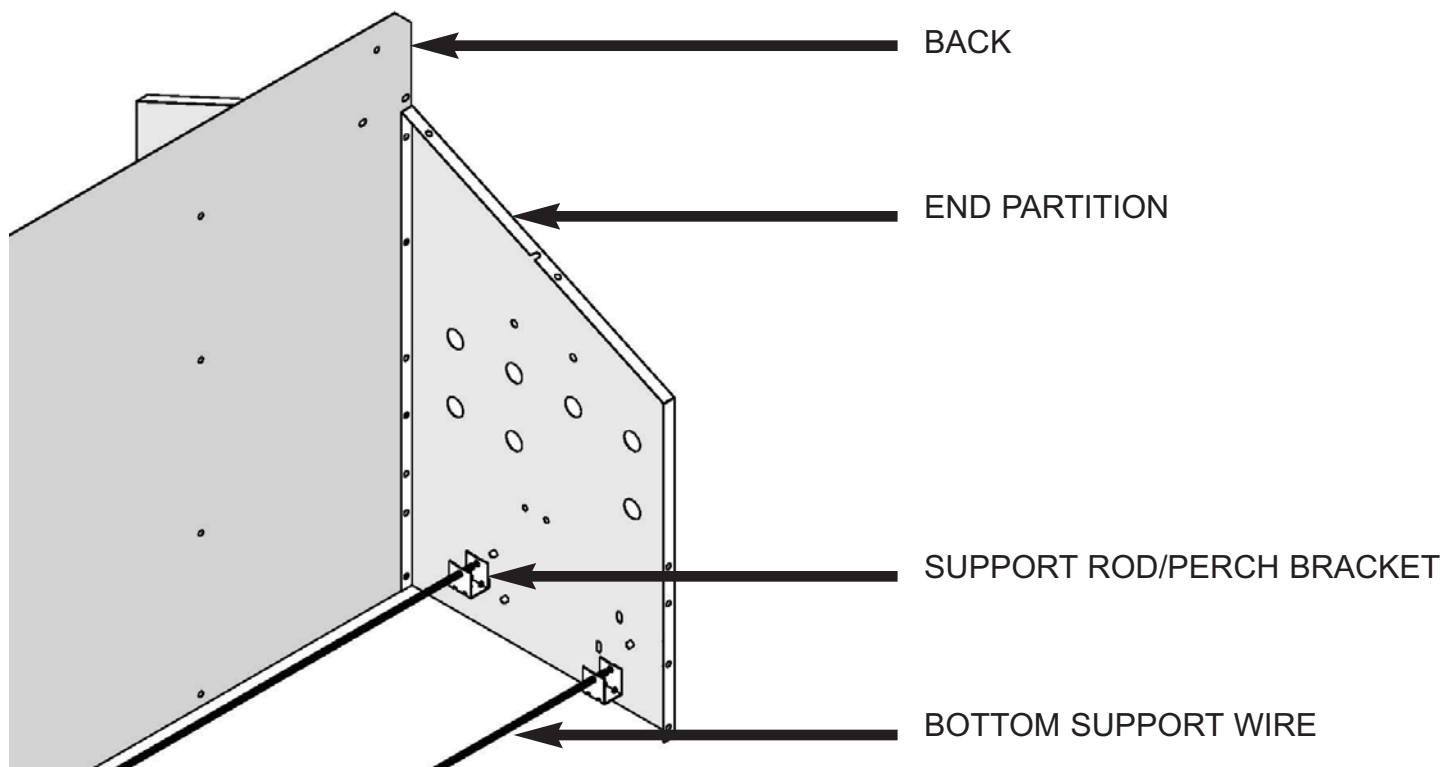



## IF CLOSE OUT LIDS ARE USED:

**STEP 8.** Attach **Tops** as shown. **DO NOT** apply rivets in the following positions at this time.

- a. First and last holes (both ends of Top) on flange to Back.
- b. 20-Hole Nests: Partition #2, #6 and #10 (Both Sides)
- c. 16-Hole Nests: Partitions #2, #5 and #8 (Both Sides)

The nest lid **Hinge Clamps** will attach here and are installed later.

## IF CLOSE OUT LIDS ARE NOT USED, ATTACH ALL HOLES WITH RIVETS.

Go on to step #10.

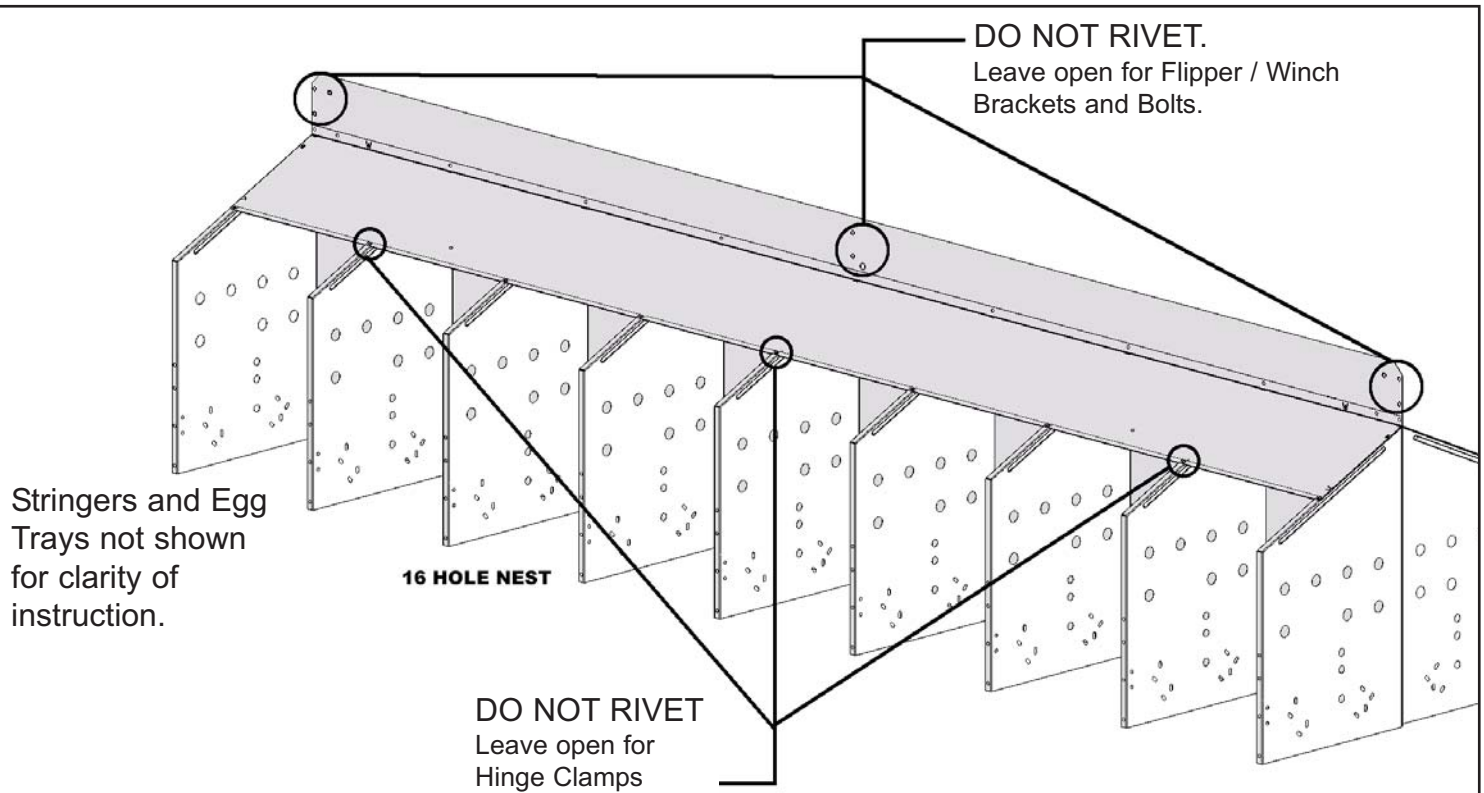
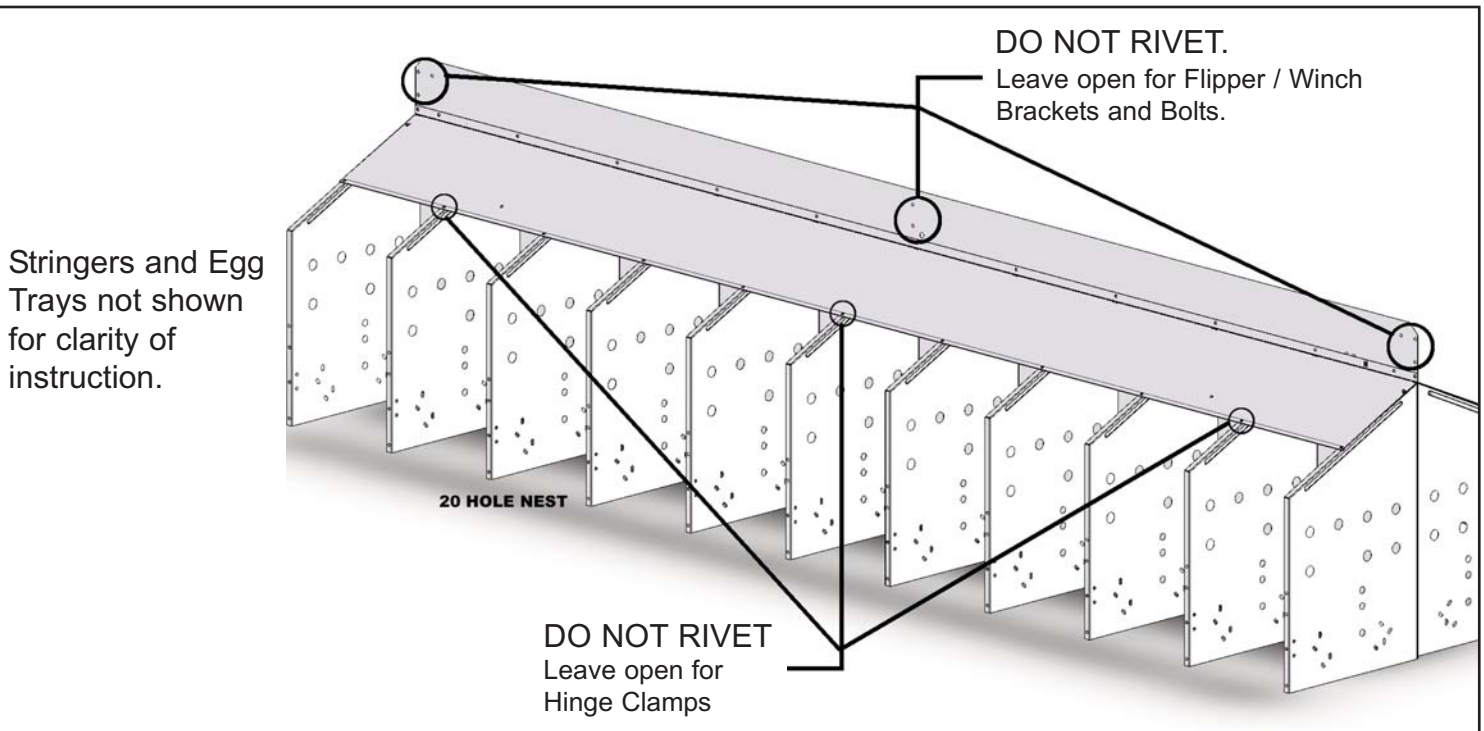

**IF CLOSE OUT LIDS ARE INCLUDED:**

**STEP 9.** Attach the **Nest Lid** as follows:

- a. Compress **Hinge Clamp** with pliers or guide nail and align with middle hole on **Top** and **Partition**. Fasten with Long rivet from RIVET PACK through **Hinge** and **Top** into **Partition**.
- b. Insert **Hinge Clamp** into middle slot on **Nest Lid**.
- c. Repeat for **Lid/Hinge/Partition** connection on each end of **Lid**.

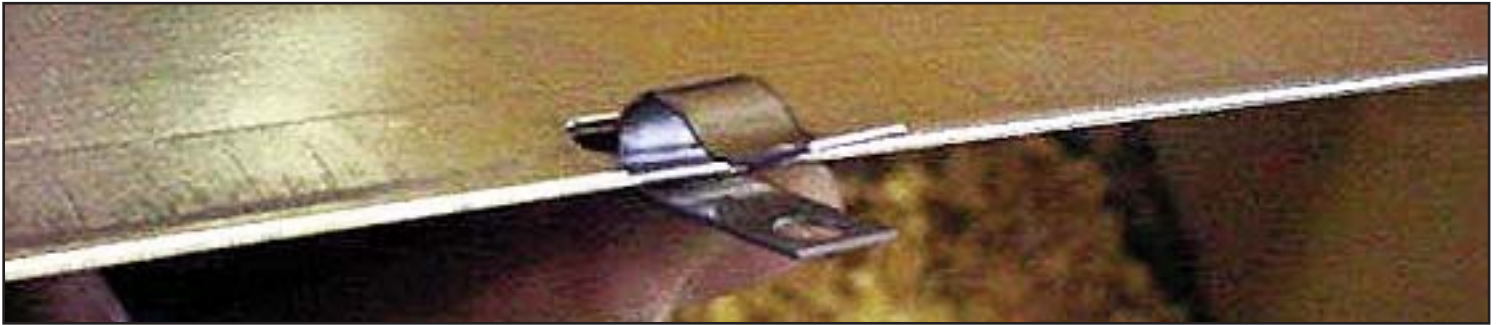

**ATTENTION ⚠**  
**USE LONG RIVETS FOR:**  
**Hinge Attachment**

RIVET THROUGH HINGE  
FOR LID ATTACHMENT

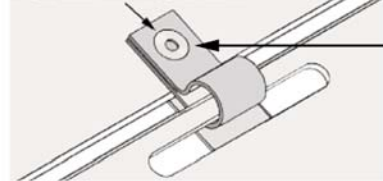

**Pop-Rivet Detail**

16-33139

.450"



Enclosed in  
bag,  
use HERE

SHOWN FOR REFERENCE

16-34096

.325"



Shipped in bulk  
with nest parts.

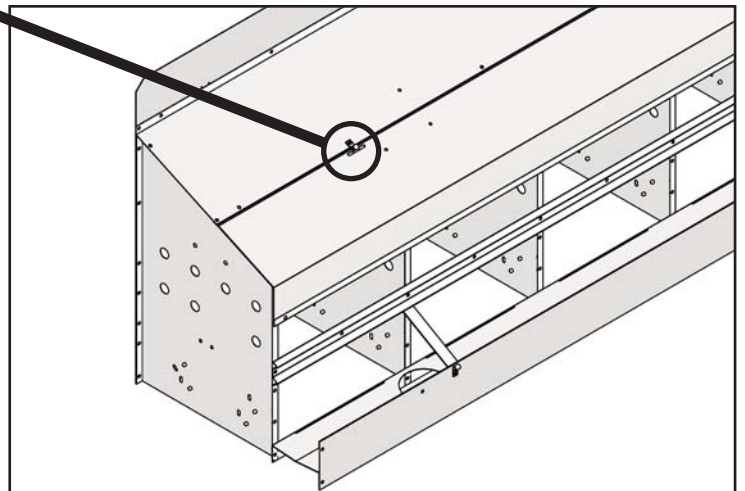
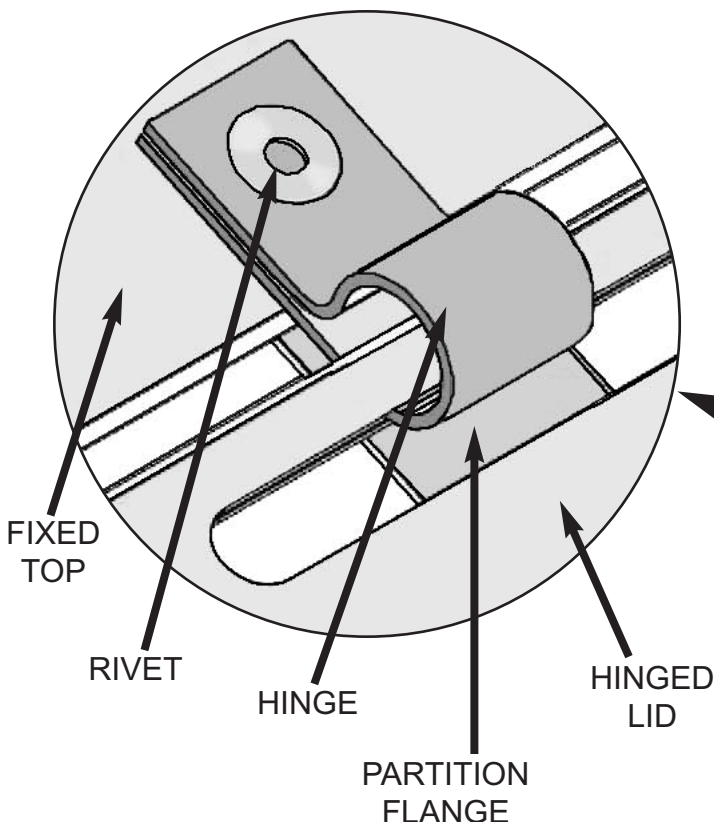



**STEP 10-A.**

Install **Universal Flipper Bracket** using #10-24 hardware as shown.  
Align holes on **Flipper** with **Universal Bracket** to determine correct Bracket mounting.



**STEP 10-B.**

Install **Flipper** over stems on **Winch** and **Universal Center Brackets** and insert **Cotter Pins** through bracket stem holes. Secure by curling pin ends.

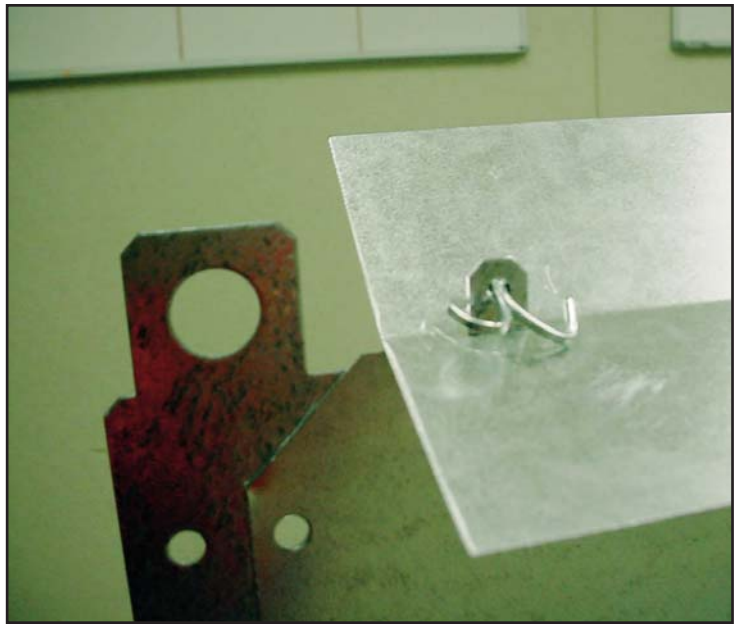

**STEP 10-C.** Install **Winch Brackets** on top corners of back with the #10-24 hardware supplied.  
**DO NOT USE RIVETS.**



## **STEP 11. CONNECTING NESTS TOGETHER AND TO WINCHING SYSTEM.**

Select winches that will safely support the system. An 8' section weighs approximately 128-130 pounds.

**WE, THE MANUFACTURER, CANNOT BE RESPONSIBLE FOR THE CAPABILITIES OF THE STRUCTURE TO SUPPORT THIS SYSTEM. FOR WEIGHT LOAD CAPABILITIES, CONTACT YOUR BUILDING CONTRACTOR.**

A cable drop is required at the end of each 8' nest section. Cable saddles, cable clamps or 'S' hooks may be used to attach to the nest brackets.

Level the system from side to side as well as along the length of the line.



**DO NOT USE RIVETS TO SECURE SUSPENSION BRACKETS TO NEST.**



**NOTE:**  
Suspension Brackets  
should overlap

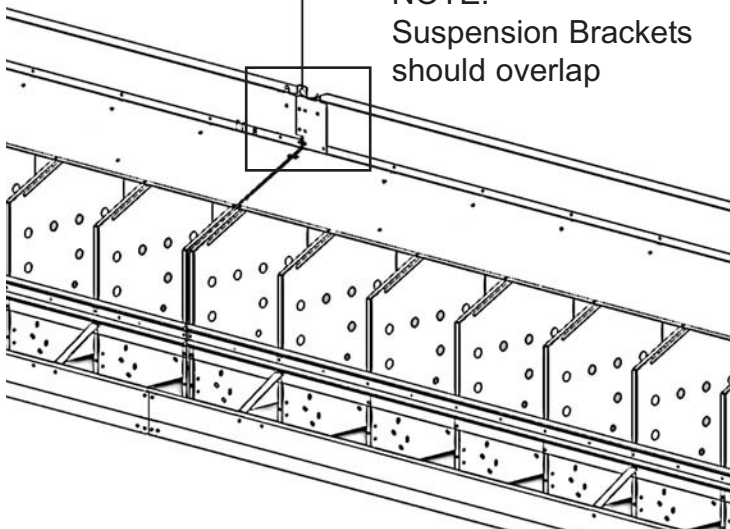

Egg Tray Connection Brackets Require **EIGHT** rivets in total: **FOUR** outside of egg tray as shown and **FOUR** inside of egg tray (see step 2).



When placing the nest system on slats, whether wooden or plastic, Agile Mfg. requires that the nest line be level along the entire length of the line. This can be accomplished by placing 1" x 4" strips over the slats and underneath the nests as a base to shim the nests.

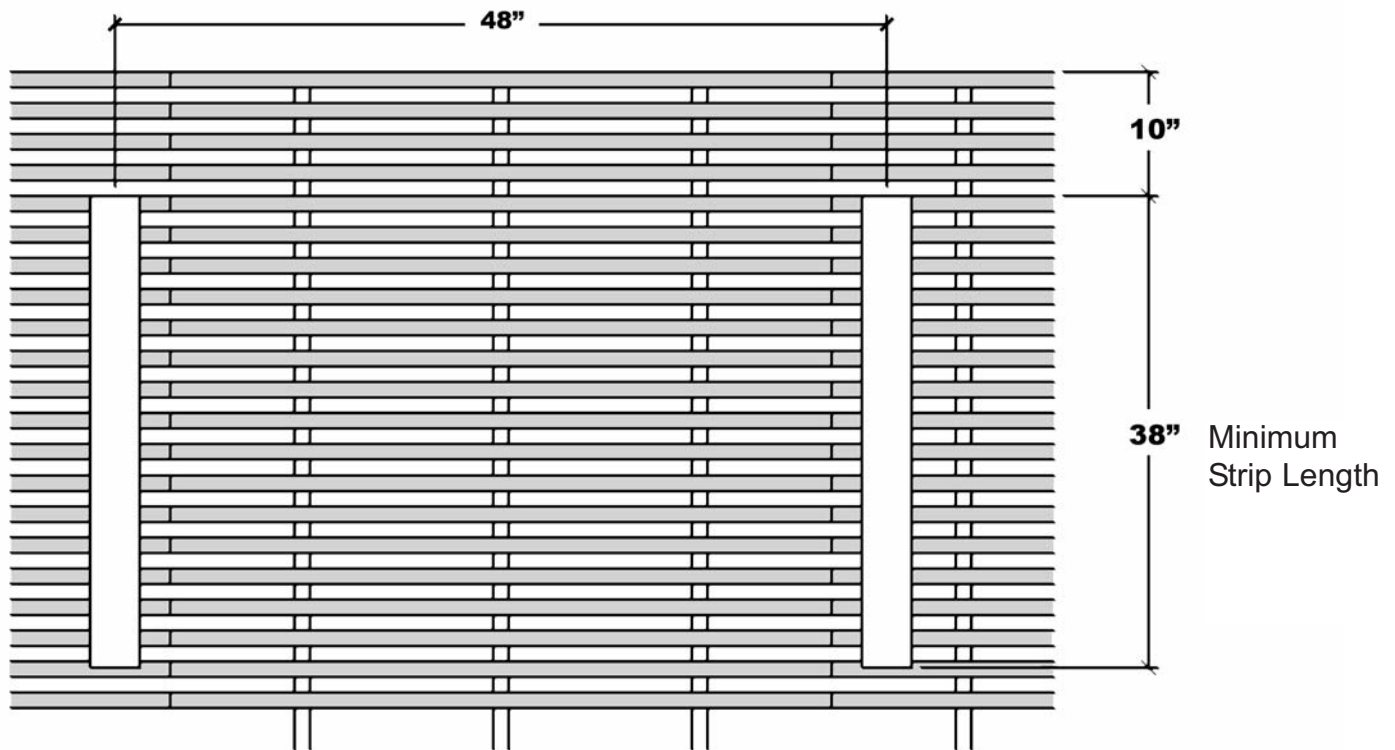

### 8' SECTION PLACEMENT OF 1 x 4 x 38 STRIPS

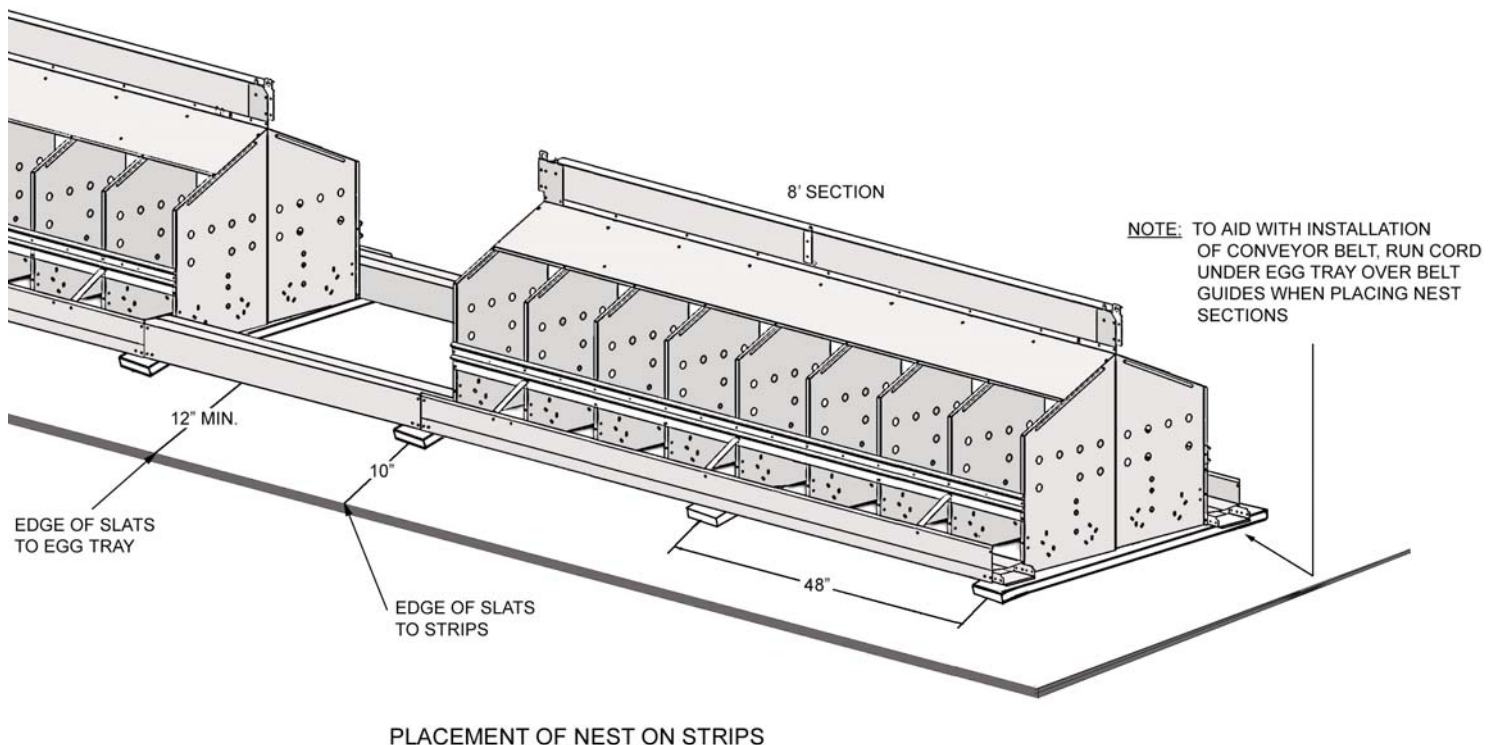

PLACEMENT OF NEST ON STRIPS

## STEP 12. PASSAGEWAY INSTALLATION INSTRUCTIONS

It is essential the sections be properly aligned and leveled to allow free movement of the conveyor belt.

The double nest sections are to be connected together, or to the conveyor passage, by the connector brackets on the conveyor trays and suspension bracket at the top.

View from front of nest.

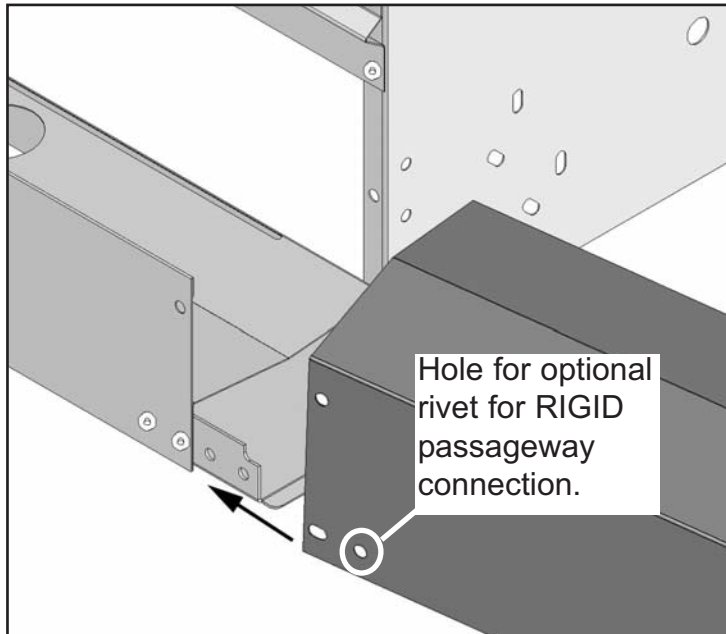

View from back of nest.

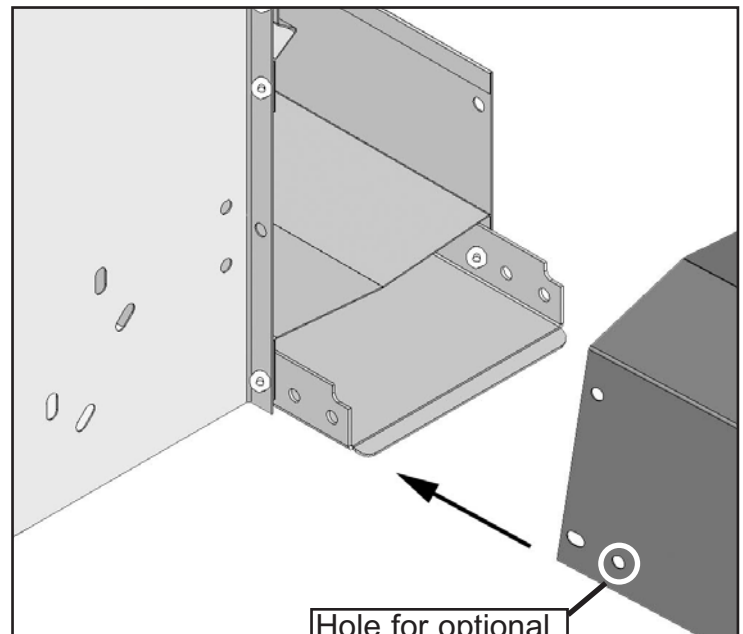

Attach passageway to nest brackets using rivets. Rivet in all holes (4x) are OPTIONAL for added strength and line rigidity. Rivets in holes nearest nest body only (2x) allow for flex between uneven suspension points or winching systems along line length. See picture below.



Illustration of a 2 Rivet connection per end of passageway to permit line flex.

## **ATTENTION:**

### **Nest Line Alignment Notice**

**Nest Lines MUST be aligned and straightened after installation and before egg collection begins at the start of each flock. Once the nests are resting on the slats, the nest egg trays must be straightened with each other horizontally from side to side, and vertically. Shims may be required to lift the nests from underneath off the slats for vertical leveling the egg trays.**

**Failure to complete this alignment of the nest line WILL result in premature egg belt wear, belt edge fraying, eggs under belts, and possible belt breakage. In addition, badly frayed and worn belts can cause damage to the egg belt drive system and control.**

**Also, the nests must be adjusted to be level from side to side to insure the correct bottom and pad angle for proper egg roll-out from the nest pads to the egg belt and trays. Nests that are not level from side to side may have eggs remaining in the nest hole on one side of the line, while the other side will be too steep and may cause egg shell checks and cracks. Again, shims may be required to lift the nests from underneath off the slats for vertical leveling the nest bodies.**

**A** - Dimensions from nest to outer wall or slat system wall. Dimension "A" assumes wall on stem wall is straight. Buildings may vary. Adjust nest line side to side to make "A" dimension equal on all nests in the line.

**B**- Vertical adjustment. Shim nest lines on slats in "B" direction (up or down) as required to make egg tray surfaces between nest bodies and nest bodies and passageways flush at connection joints.

**C** - Line leveling. Egg trays should be level from side to side to insure correct floor angle in nest bodies.

**Note:** A laser level can be used for A,B, and C.

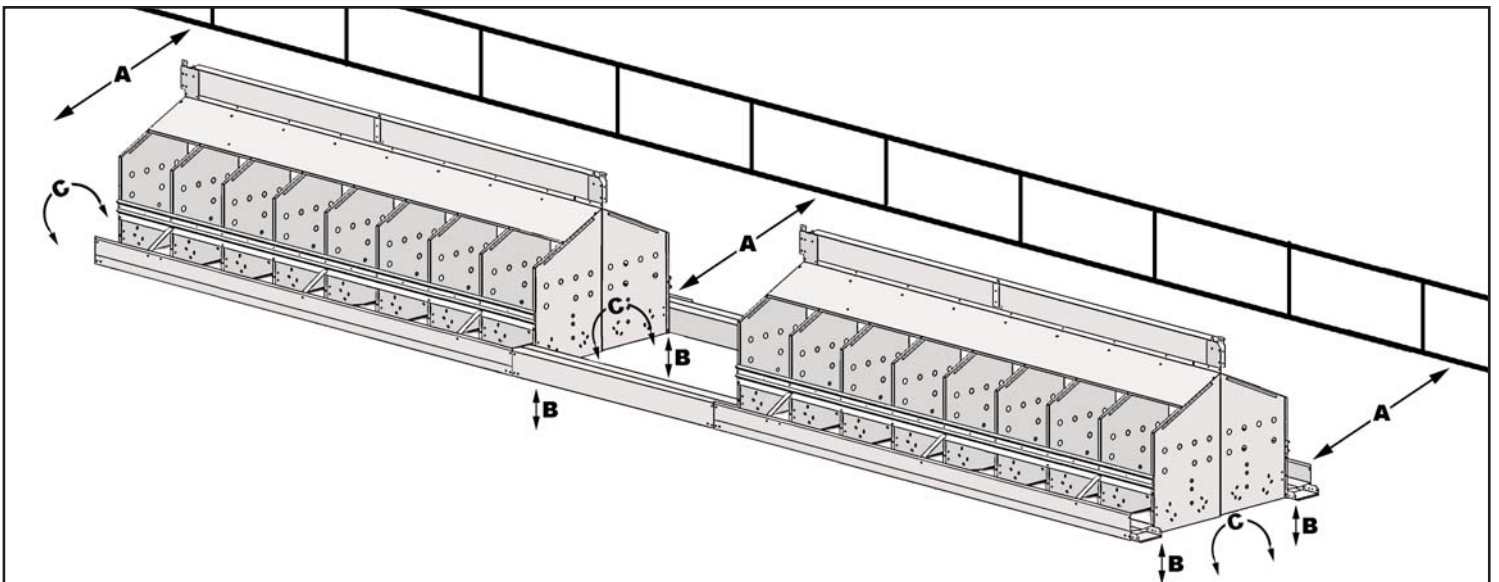



## PASSAGEWAY COMPONENTS

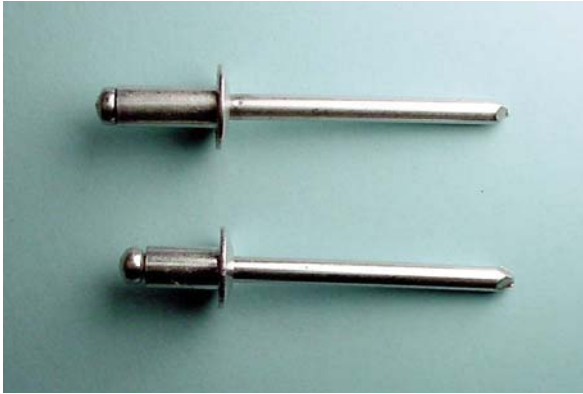

16-33139  
16-34096

RIVET: POP 3/16" AL AD64ABS LG  
RIVET: POP 3/16" AL AD62ABS SH



16560041 P-WAY, 18" SS w/CONNECTOR  
16560042 P-WAY, 24" SS w/CONNECTOR  
16560043 P-WAY, 28-3/4" SS w/CONNECTOR  
16560044 P-WAY, 36" SS w/CONNECTOR  
16560045 P-WAY, 48" SS w/CONNECTOR  
16560046 P-WAY, 72" SS w/CONNECTOR  
16560047 P-WAY, 96" GALV w/HINGE TOP



16560017 BRACKET: EGG TRAY CHANNEL  
CONN.

## END RETURN ROLLER ASSEMBLY

1. Align Roller Assembly to Last Nest End as shown, making sure that rollers are lined up with the centers of the Egg Trays.
2. Use Idler Assembly as a guide to drill two 9/32" holes for 1/4-20 bolts.
3. Two 1/4-20x1" bolts and two 1/4-20 flange nuts and one nylon shoulder washer are included for Return Roller Assembly attachment. Use the shoulder washer as a spacer -- see picture below.

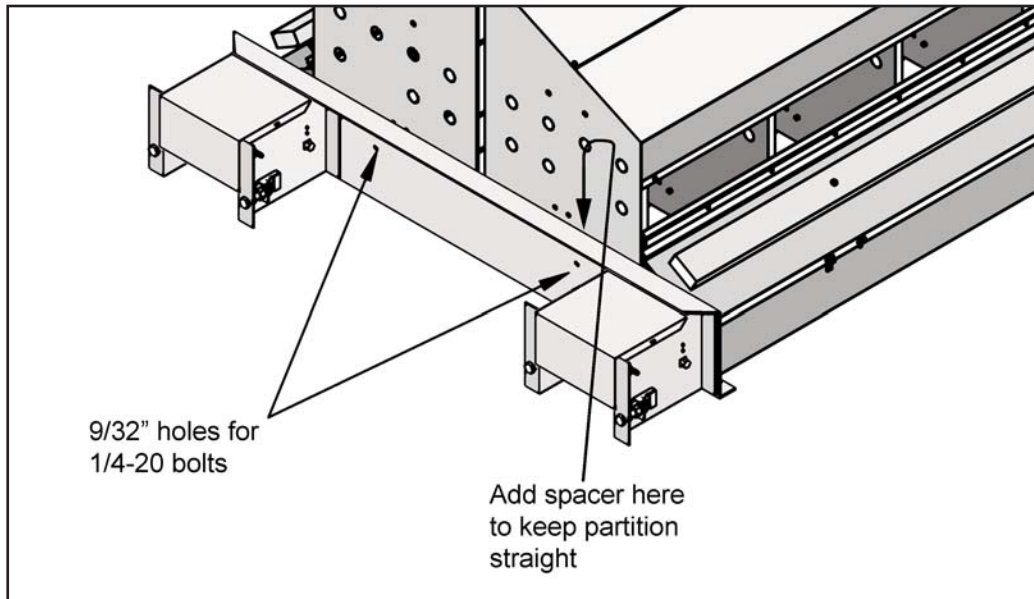

1	16-8904	CLAMP: HINGE SS 3/8 WID
2	16560061	DUST COVER,SB IDLER ROLL
3	16-35572	BRUSH: TAMPICO WHT 5" x 2
4	16-13200550	NUT: HEX FLG LCK 3/8-16
5	16-63700	SCREW: HEX 1/4-20 X 1/2
6	16560060	BRACKET,BRUSH SB IDLER
7	16005182	NUT 3/8-16 NYLON LOCK
8	16-102977	SHAFT: ADJ ROLLER 5/8OD
9	16060012	ROLLER,TAKE-UP 1.5 x 6.
10	16-63702	NUT: HEX 3/8-16 - PLATED
11	16-35629	NUT: HEX 1/4-20 SERR FL
12	16000006	BOLT,CARR SHORT NECK 5/16x3/4
13	16560064	MOUNTING FRAME, SB IDLER

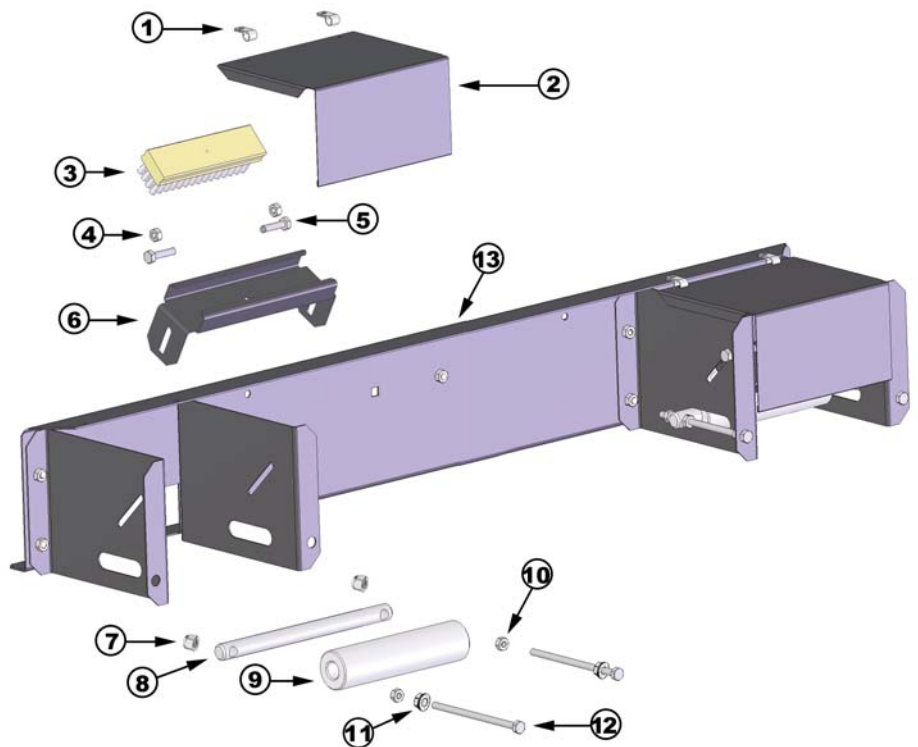

## NEST DIMENSIONS

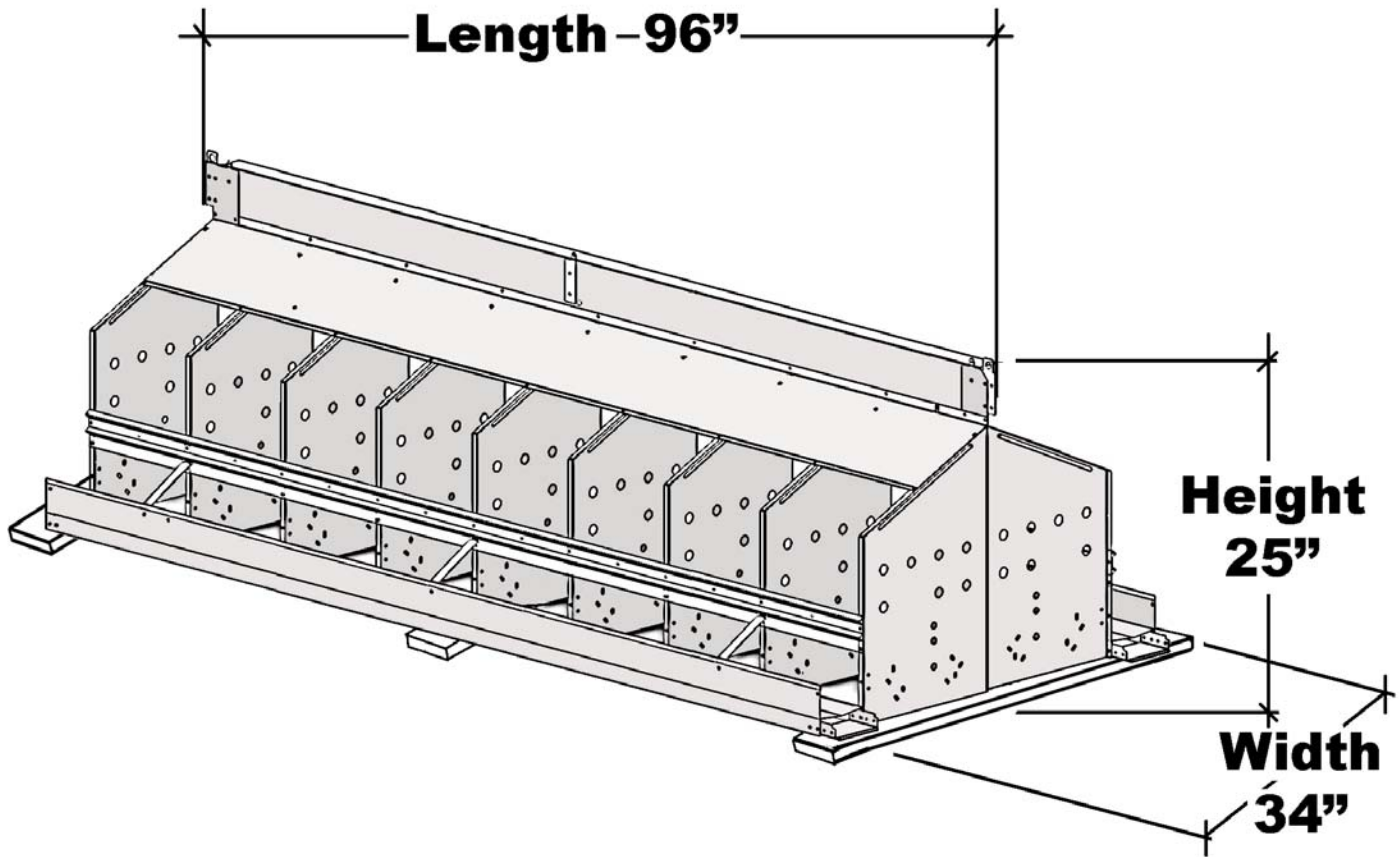

## SUSPENSION COMPONENTS

00102368 Winch manual 3000 pound



Cable Sleeves

00101733 3/16"



00101725 1/8"

Cable Clamps

00101758 3/16"



00101741 1/8"

00100420  
3 1/2 Cast Pulley



10106151  
1 3/4 Nylon Pulley



00101741  
2 1/2 Steel Pulley



16-95824  
1 1/2 Solid Pulley



00101824  
7/8 Nylon Pulley



00101865 HANDLE LONG ELEC. 8'  
00101691 CABLE 3/16" 7 X 7 WEAVE  
00101683 CABLE 1/8" 7 X 7 WEAVE



Install **Pads** and **Bottoms** into nest holes per the following diagrams.

- a. Molded Bottom and Chute
- b. Finger Pad
- c. Turf Pad
- d. Full Turf Pad
- e. Wire Bottom and Blue Plastic Pad

### MOLDED NEST BOTTOM ASSEMBLY

1. Assemble decoy egg, nest pad to molded nest bottom.
2. Secure Finger Pad with plastic cable tie. Insert Cable Tie from underside of Nest Bottom through small hole in Nest Bottom through matching hole in Finger Pad back down through adjacent hole in Finger Pad through larger hole in nest bottom. Close Plastic Cable Tie. Do not over tighten tie.

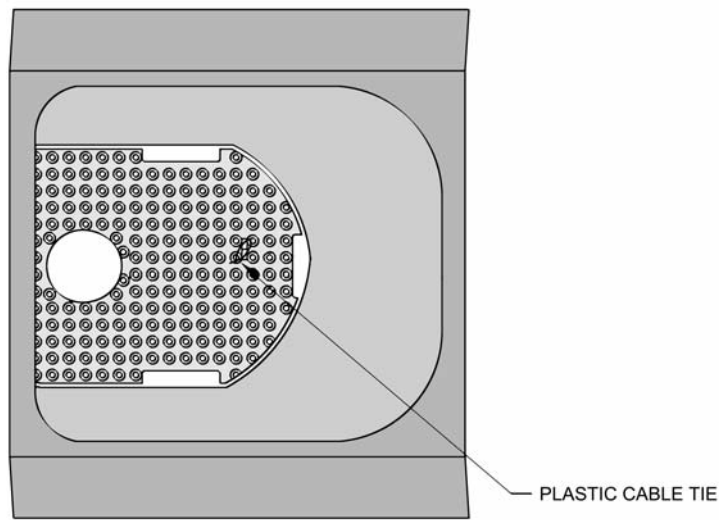

### CHUTE AND NEST INSTALLATION

1. Insert lip of chute into slot in tray and over front support rod.
2. Place the nest bottom assembly into nest opening with door facing out. Insert front lip of molded nest bottom into lower groove on the stringer then press back of molded nest bottom down so it rests on support rod.

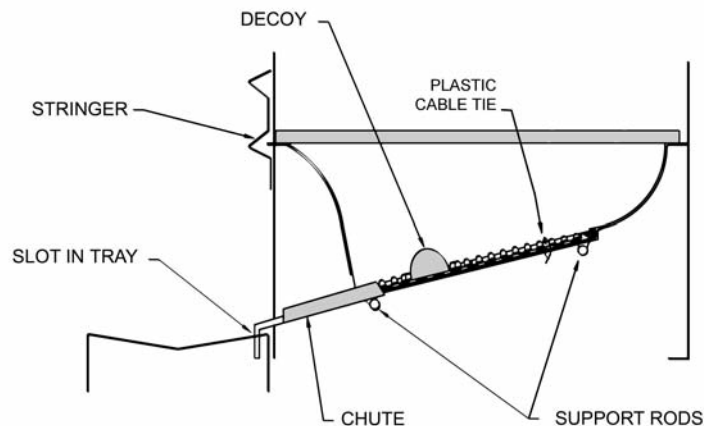



## **61511100** for 9.6" holes

**Kit: 20 Hole, Plastic Molded Btm w/Egg, chute, pad**



**16-37192 : Chute**

**16-37199 : Tie: Cable Outdoor 7-1/2"**

**16-37184 : Molded Bottom**

**16-37187 : Decoy Egg**

**16-37186 : Finger Pad for Molded Bottom**

## **61521100** for 12" holes

**Kit: 16 hole, plastic molded btm w/egg, chute, sm. finger pad**



**16-37190 : Chute**

**16-37199 : Tie: Cable Outdoor 7-1/2"**

**16-37183 : Molded Bottom**

**16-37187 : Decoy Egg**

**16-37186 : Finger Pad for Molded Bottom**

## ASSEMBLY OF FINGER PAD TO NEST BOTTOM

1. Insert pad under (3) fingers on right-hand side.
2. Insert pad under (3) fingers on left-hand side.
3. Insert plastic cable tie up from the underside of the plastic nest bottom through small hole (matching on the nest finger pad) through the finger pad, back down through adjacent hole in the finger pad, through large hole in the plastic nest bottom.  
Secure the plastic cable tie.

Do not over-tighten tie or pad may buckle.

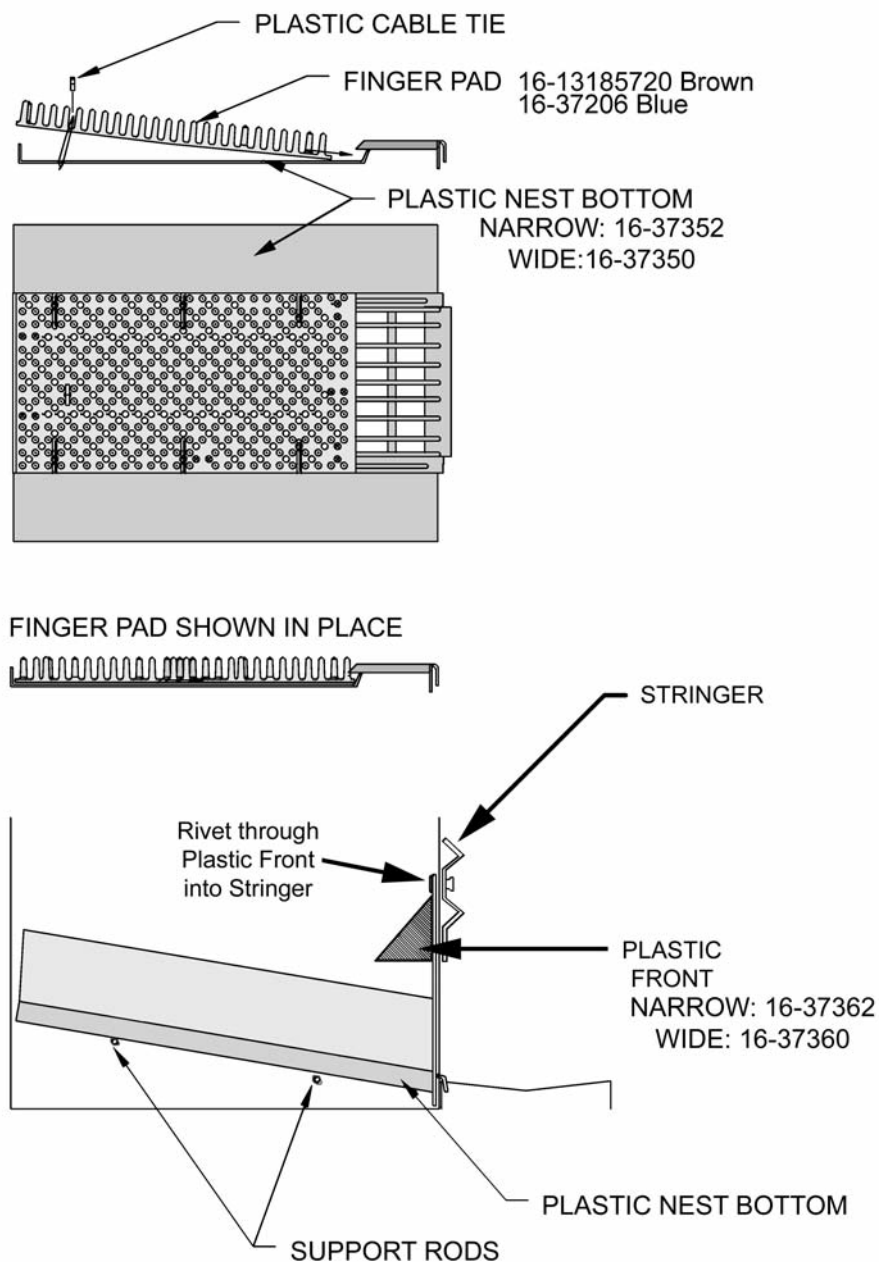

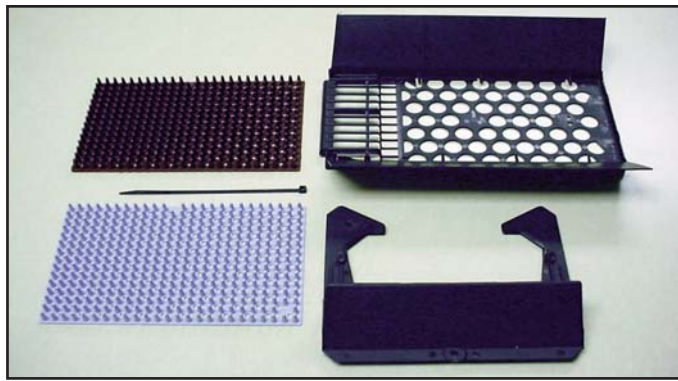

## 61512200 for 9.6" holes

**KIT, 20 HOLE: BROWN FINGER PAD  
PLAST BTM w/GRILL, FRONT, TIE**

16-37352 : Bottom with Grill  
16-13185720 : 5.63 x 9.63 BROWN Finger Pad  
16-37199 : Tie: Cable Outdoor 7-1/2"  
16-37362 : Front

## 61512600 for 9.6" holes

**KIT, 20 HOLE: BLUE FINGER PAD  
PLAST BTM w/GRILL, FRONT, TIE**

16-37352 : Bottom with Grill  
16-37206 : 5.63 x 9.63 BLUE Finger Pad  
16-37199 : Tie: Cable Outdoor 7-1/2"  
16-37362 : Front

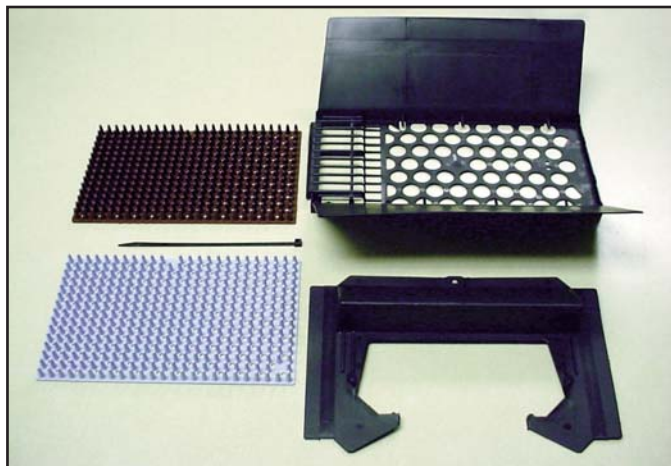

## 61522200 for 12" holes

**Kit: 16 hole, plastic btm. w/grill, finger pad,  
front**

16-37350 : Bottom with Grill  
16-13185720 : 5.63 x 9.63 BROWN Finger Pad  
16-37360 : Front  
16-37199 : Tie: Cable Outdoor 7-1/2"

## 61522600 for 12" holes

**Kit: 16 hole, plastic btm. w/grill, finger pad,  
front**

16-37350 : Bottom with Grill  
16-37206 : 5.63 x 9.63 BLUE Finger Pad  
16-37360 : Front  
16-37199 : Tie: Cable Outdoor 7-1/2"



## ASSEMBLY OF TURF TO NEST BOTTOM

1. Insert turf under three fingers on right side.
2. Insert turf under three fingers on left side.
3. Be sure turf lays flat in bottom.

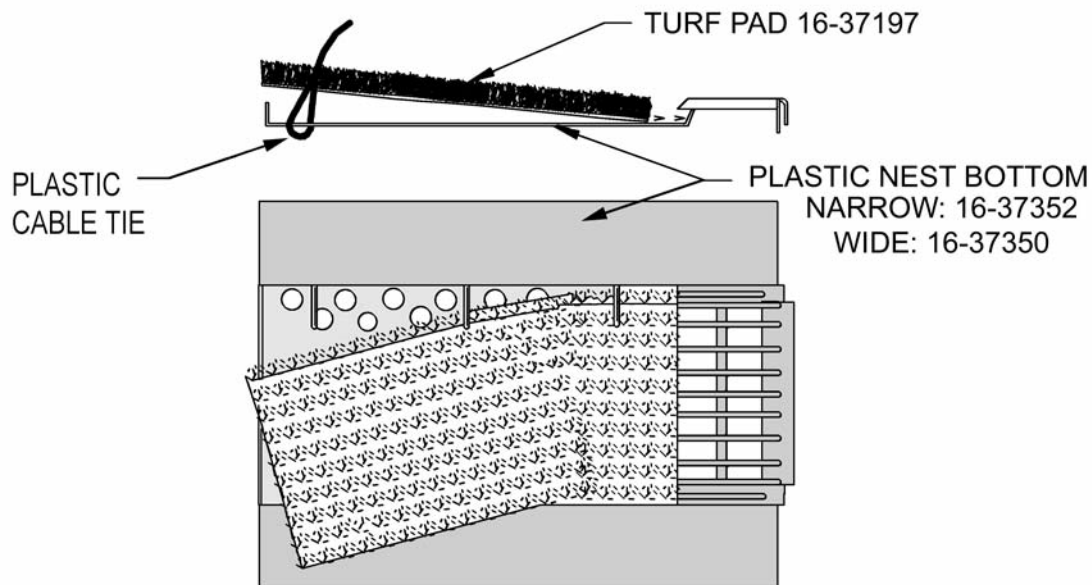

TURF SHOWN IN PLACE

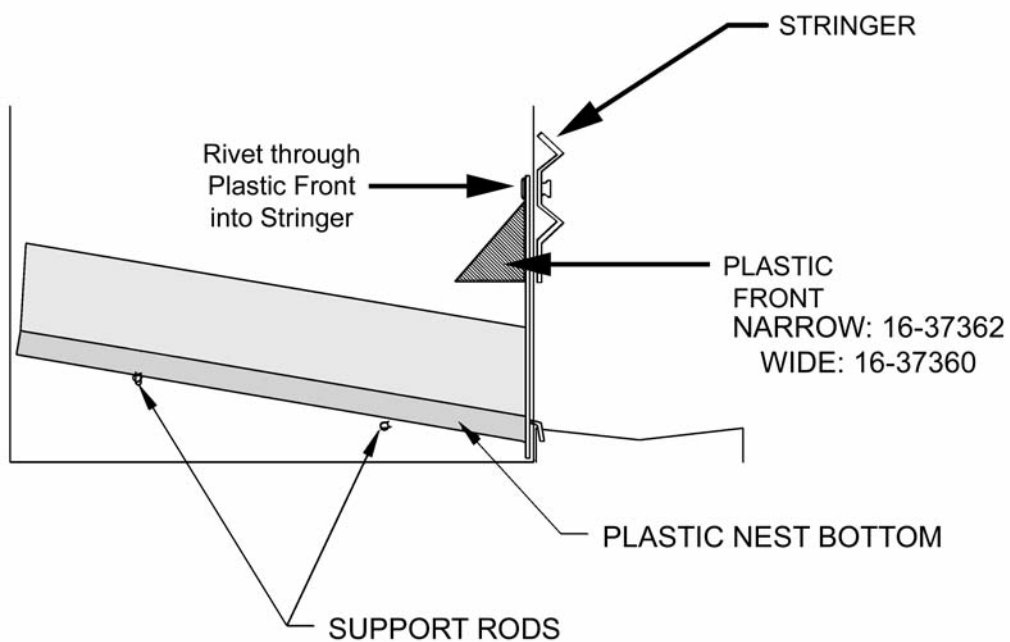

## **61512300** for 9.6" holes

**Kit: 20 Hole, Plastic btm w/grill, turf pad, front**

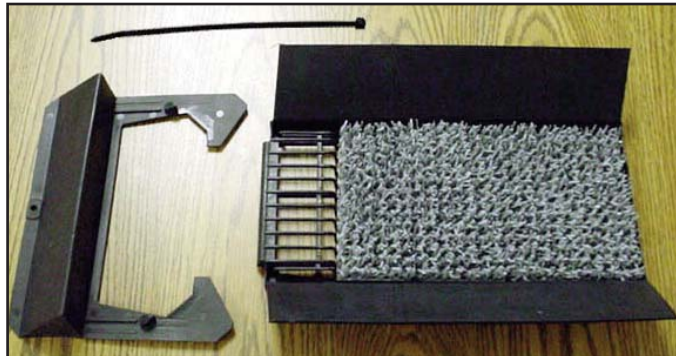

- 16-37362 : Front**
- 16-37352 : Bottom with Grill**
- 16-37197 : 5.63 x 9.63 Turf Pad**
- 16-37199 : Tie: Cable Outdoor 7-1/2"**

## **61522300** for 12" holes

**Kit: 16 hole, plastic btm w/grill, sm. turf pad, front**



- 16-37360 : Plastic Front**
- 16-37350 : Plastic Bottom with Grill**
- 16-37197 : 5.63 x 9.63 Turf Pad**
- 16-37199 : Tie: Cable Outdoor 7-1/2"**

## ASSEMBLY OF FULL TURF AND NEST BOTTOM

1. Insert Nest Bottom in Nest Hole as shown
2. Install basket retainers into the nest partitions as shown.
3. Insert pad on bottom and clipped under basket retainer to secure.

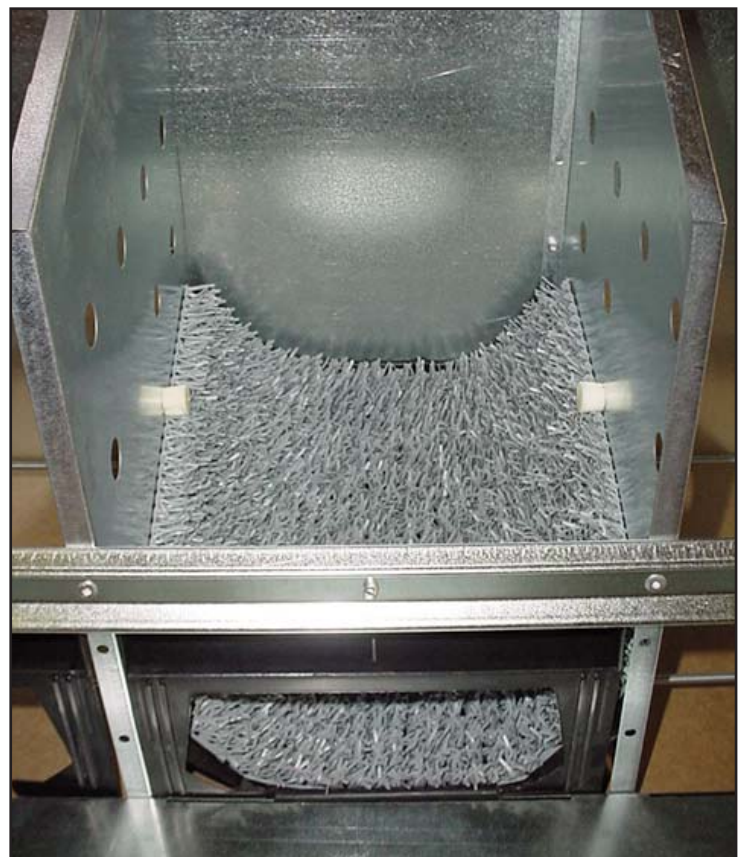
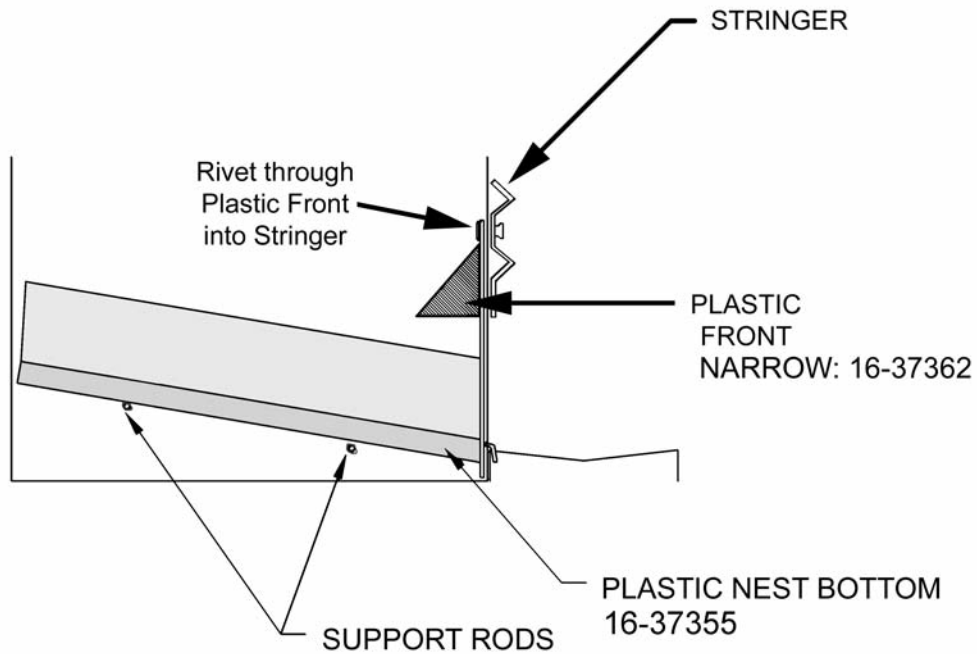



## **61513401** for 9.6" holes

**Kit: 20 hole, plastic btm. less grill, full turf 12x13, front**

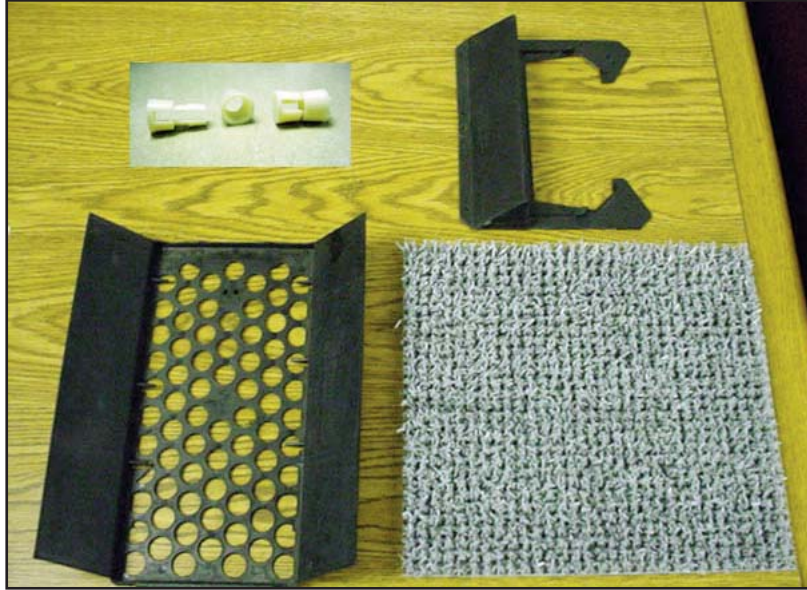

**16-37193  
16-37355  
16-37362  
JD3922**

**PAD: NEST TURF GRAY 12  
BTM: NEST - NO GRID - N  
FRONT: NEST-SEGS-NARR  
RETAINER,BASKET**

## ASSEMBLY OF WIRE BOTTOM AND BLUE DIRECTIONAL PAD.

1. install wireform support on support rods in nest hole. See picture below.



2. Insert Wire Bottom into nest hole. See diagram below.
3. Tie Bottom to BACK support rod as shown. Wire bottoms MUST be tied to rods, as shown below.

4. Install retainer clips into middle holes in partition. Pads latch in below clips.

5. Insert Blue Pad onto wire bottom and center within nest hole.  
NOTE: Insert pad so that bent Grass Fingers are TOWARD Egg Tray.  
On 9.6" nests, pad will lay against nest partitions on each side.

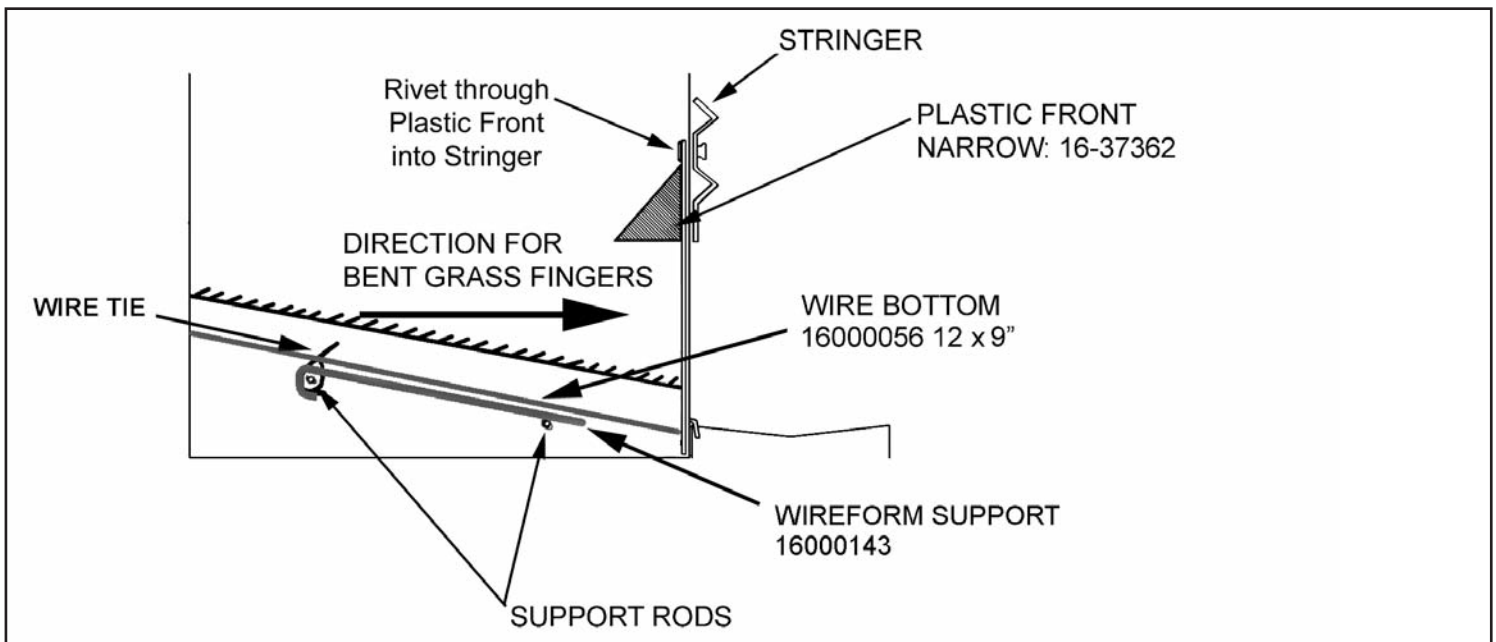
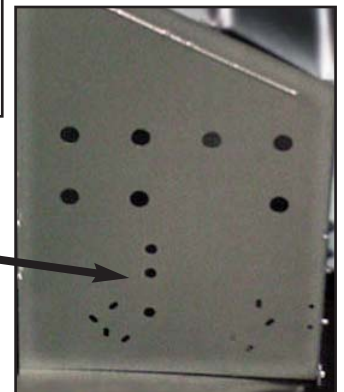



6. Install Edge Guard over slot edge in egg tray as shown. Edge guard should grip metal very tightly



**61514502 for 9.6" holes**  
KIT,20 HOLE WIRE BTM BLUE PAD  
11.8x12.8 PAD,WIRE BTM,RETNR

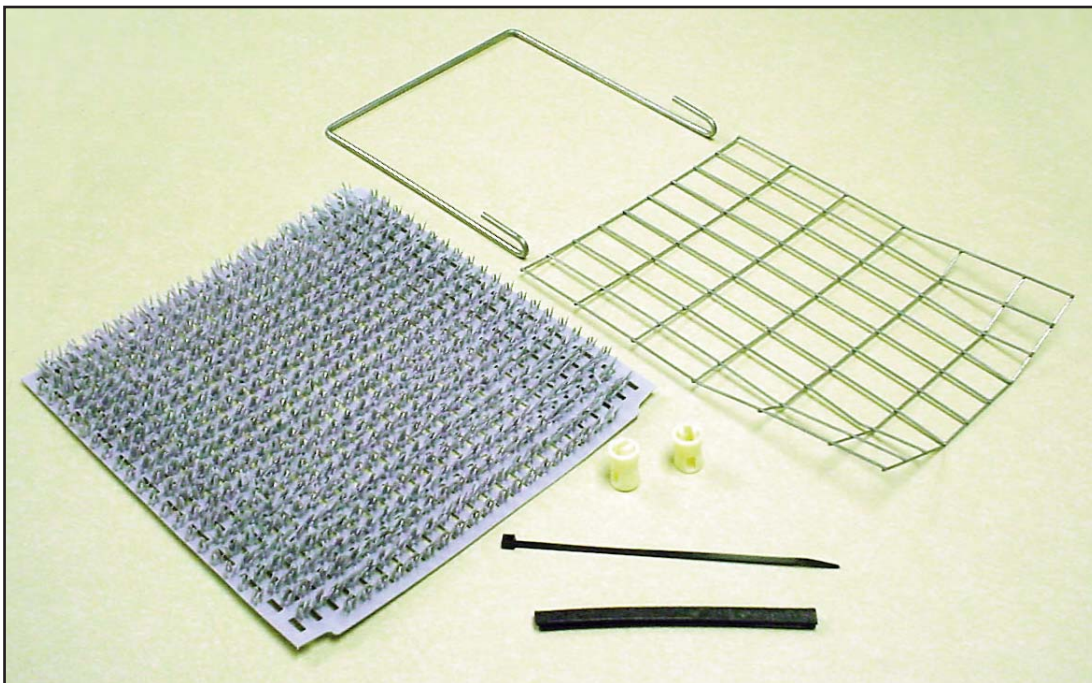

16-37362  
16560050  
16000030  
16500107  
16-37199  
JD3922  
16000143

FRONT: NEST-SEGS-NARR (not shown)  
BOTTOM,WIRE 9" x 11.5"  
PAD,BLUE PL 11.75"x12.7  
GUARD,EDGE WIRE BOTTOM  
TIE: CABLE OUTDOOR 7 1/2"  
RETAINER,BASKET  
SUPPORT, NEST BOTTOM WIRE



## WARRANTY

**Manufacturer** warrants each new product manufactured by it to be free from defects in material or workmanship for one (1) year from and after the date of initial installation by or for the original purchaser. If such a defect is found by Manufacturer to exist within the one-year period, the Manufacturer will, at its option, (a) repair or replace such product free of charge, F.O.B. the factory of manufacture, or (b) refund to the original purchaser the original purchase price, in lieu of such repair or replacement. Labor costs associated with the replacement or repair of the product are not covered by the Manufacturer.

### Conditions and Limitations

1. The product must be installed by and operated in accordance with the instructions published by the **Manufacturer or Warranty will be void.**
2. Warranty is void if **all components** of the system are not original equipment supplied by the Manufacturer.
3. This product must be purchased from and installed by an authorized distributor or installer or a certified representative thereof **or the Warranty will be void.**
4. Malfunctions or failure resulting from misuse, abuse, negligence, alteration, accident, or lack of proper maintenance, or from lightning strikes, electrical power surges or interruption of electricity, shall not be considered defects under the Warranty.
5. This Warranty applies only to systems for the care of poultry and livestock. Other applications in industry, commerce, or residential applications are not covered by this Warranty and are **strictly prohibited.** Any such use **will void the Warranty.**

Manufacturer shall not be liable for any **Consequential or Special Damage** which any purchaser may suffer or claim to suffer as a result of any defect in the product. **"Consequential"** or **"Special Damages"** *as used herein include, but are not limited to, lost or damaged products or goods, costs of transportation, lost sales, lost orders, lost income, increased overhead, labor and incidental costs and operational inefficiencies.*

THIS WARRANTY CONSTITUTES THE MANUFACTURER'S ENTIRE AND SOLE WARRANTY AND THIS MANUFACTURER EXPRESSLY DISCLAIMS ANY AND ALL OTHER WARRANTIES, INCLUDING, BUT NOT LIMITED TO, EXPRESS AND IMPLIED WARRANTIES AS TO MERCHANTABILITY, FITNESS FOR PARTICULAR PURPOSES SOLD AND DESCRIPTION OR QUALITY OF THE PRODUCT FURNISHED HEREUNDER.

Distributors are not authorized to modify or extend the terms and conditions of this Warranty in any manner or to offer or grant any other warranties for the products in addition to those terms expressly stated above. An officer of the Manufacturer must authorize any exceptions to this Warranty in writing. Manufacturer reserves the right to change models and specifications at any time without notice or obligation to improve previous models.

Effective 01/07

## NOTES

[illegible]

## NOTES

This image shows a full page of blank, lined paper. It features approximately 20 evenly spaced horizontal grey lines across the entire width of the page, typical of notebook or legal stationery. The background is white, and there are no margins, text, or other markings present.