

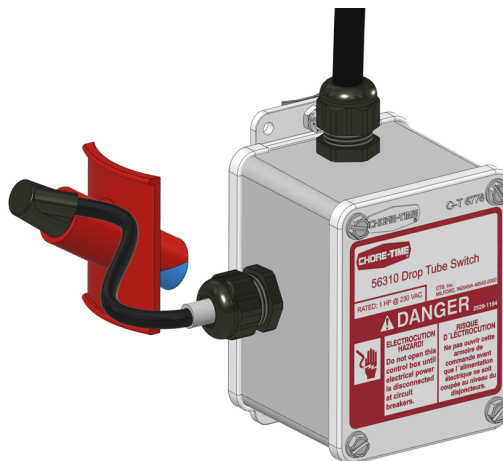

Drop Tube Switch Part No. 56310



Introduction

The 56310 Drop Tube Switch is designed for use with any feeding system that carries free flowing feed.

It is designed to be mounted to the Drop Tubes.

The Delay Timer will allow the operator to set the start delay time before the fill time system restarts. This feature will minimize short-cycling.

Follow Safety Instructions

Carefully read all safety messages in this manual and on your equipment safety signs. Follow recommended precautions and safe operating practices.

DANGER: Moving Parts

Disconnect electrical power before working on system, equipment may start automatically. Otherwise personal injury will result.

Severe personal injury will result if the equipment is operated without covers properly installed.

DANGER: Electrical Hazard

Disconnect electrical power before inspecting or servicing equipment unless maintenance instructions specifically state otherwise.

Ground all electrical equipment for safety.

All electrical wiring must be done by a qualified electrician in accordance with local and national electric codes.

Ground all non-current carrying metal parts to guard against electrical shock.

Electrical disconnects and over current protection are not supplied with the equipment.

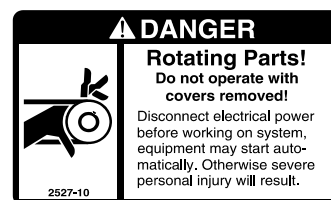

For additional parts and information, contact your nearest Chore-Time distributor or representative.

Find your nearest distributor at: www.choretime.com/contacts

CTB, Inc.

PO Box 2000

Milford, Indiana 46542-2000 USA

Phone (574) 658-4101 Fax (877) 730-8825

Email: choretime@choretime.com

Internet: www.choretime.com

Contents

| Topic | Page |
|--|----------|
| Introduction | 1 |
| Follow Safety Instructions | 1 |
| DANGER: Moving Parts | 1 |
| DANGER: Electrical Hazard | 1 |
| Installation | 3 |
| Switch assembly/Installation | 3 |
| Switch Adjustment | 3 |
| Wiring | 4 |
| DANGER: Electrical Hazard | 4 |
| | 4 |
| Parts Listing | 5 |
| 56310 Drop Tube Switch | 5 |

Installation

Switch assembly/Installation

Mounting the Drop Tube Switch in the Last Hopper lower than all the other Hopper Switches will prevent all other Hoppers from running out of feed before the Switch activates to fill the system.

Attach the Switch to the Drop Tube as shown.

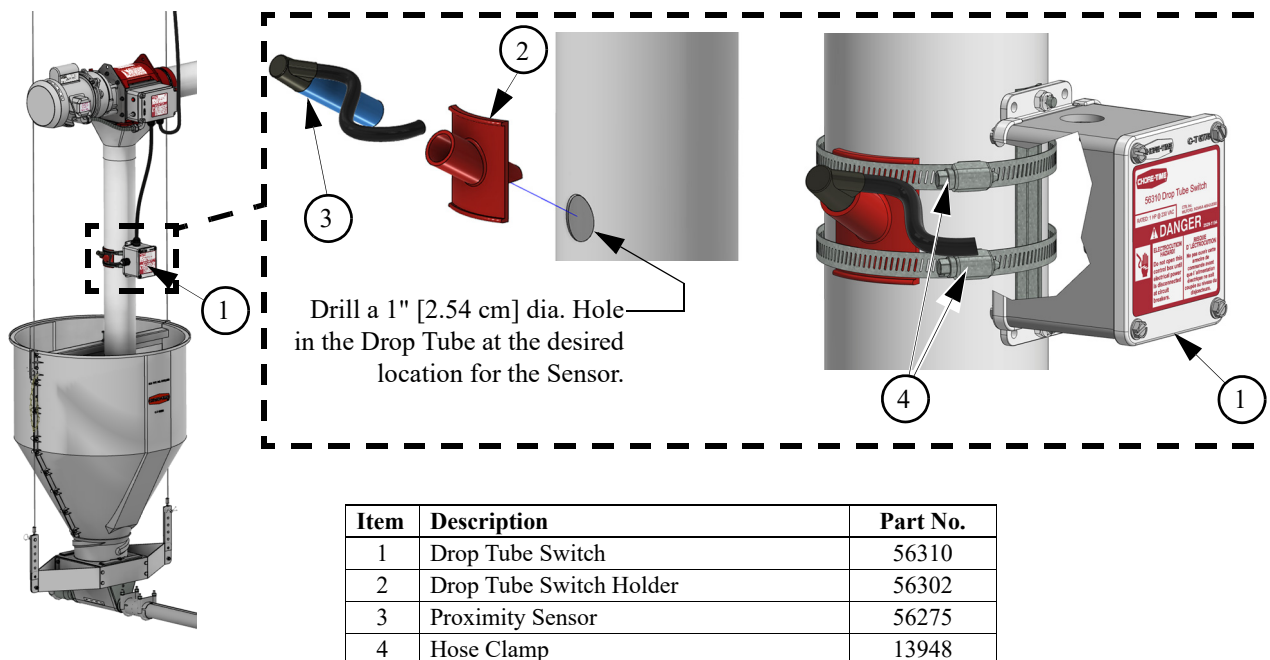

Figure 1.Installation

Switch Adjustment

Drop Tube Switch is pre-adjusted at the factory to a delay of "90" seconds. The delay may be changed for a specific installation.

Time Delay Adjustment

- For Less Time: Turn the **Time Delay Adjustment Screw** counter-clockwise (light blinks faster).
- For More Time: Turn the **Time Delay Adjustment Screw** clockwise. (light blinks slower)

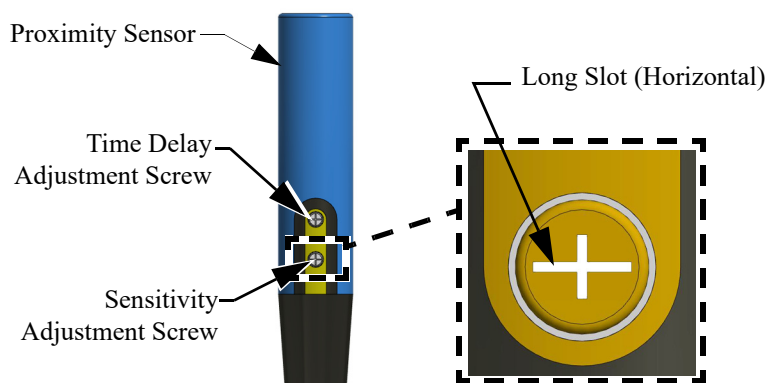

Figure 2.Switch Adjustment

Sensitivity Adjustment

- The **Sensitivity Adjustment Screw** is set from the factory and glued in place. If for some reason Sensitivity Adjustment needs reset to the factory setting: Turn Adjustment Screw all the way Counter-Clockwise, then Rotate Clockwise until the long slot is Horizontal.

Wiring

DANGER: Electrical Hazard

Disconnect electrical power before inspecting or servicing equipment unless maintenance instructions specifically state otherwise.

Ground all electrical equipment for safety.

All electrical wiring must be done by a qualified electrician in accordance with local and national electric codes.

Ground all non-current carrying metal parts to guard against electrical shock.

Electrical disconnects and over current protection are not supplied with the equipment.

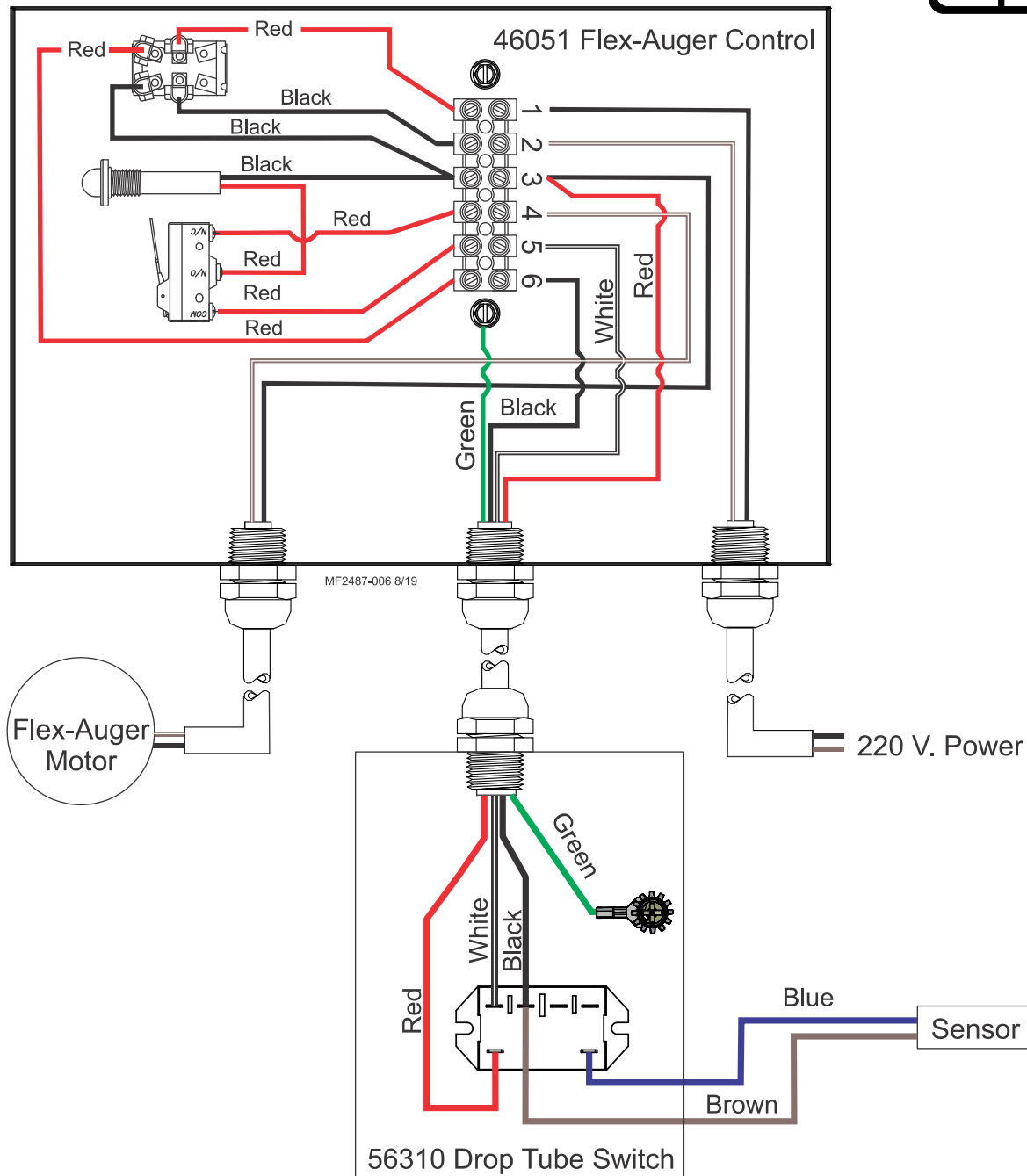
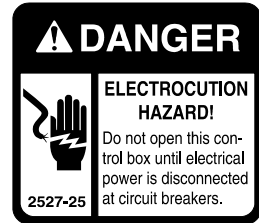
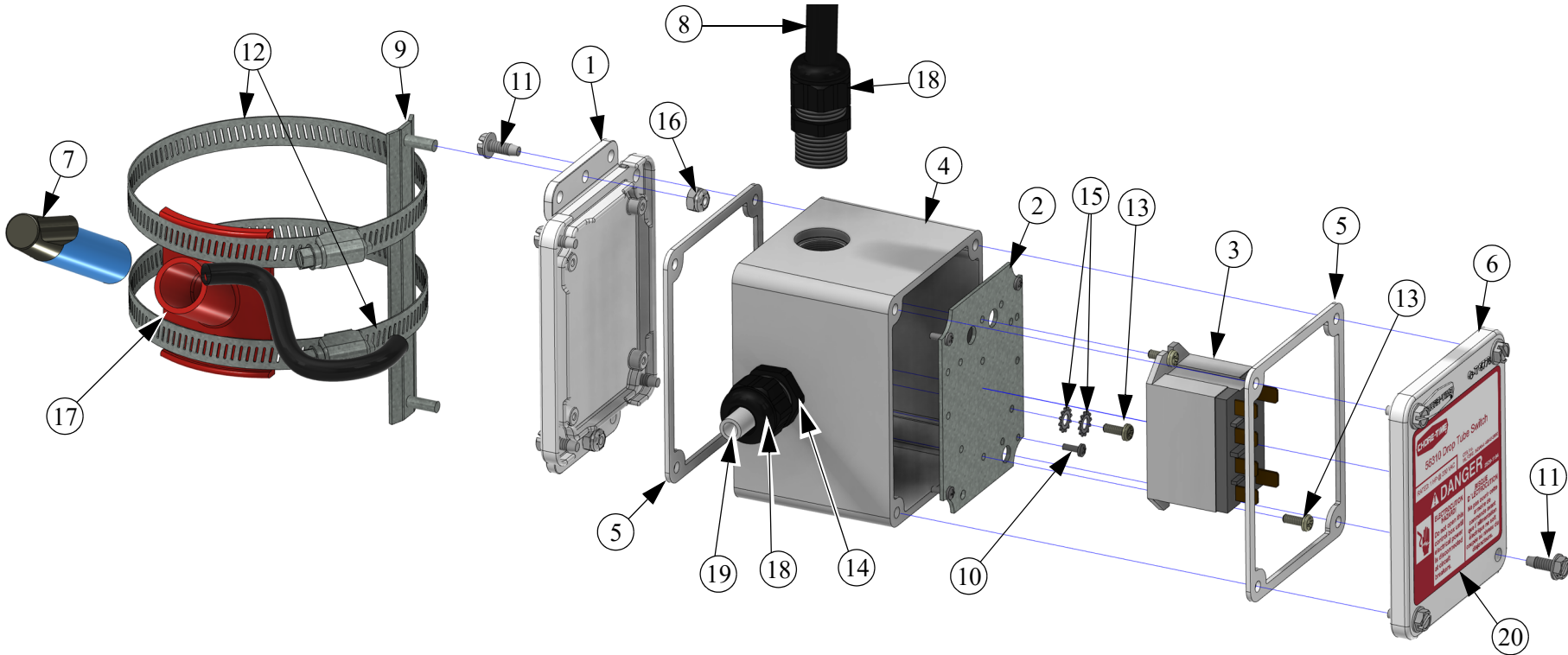

Figure 3.Wiring

Parts Listing

56310 Drop Tube Switch



| Item | Description | Part No. |
|------|-----------------------------|----------|
| 1 | Terminal Box Mounting Cover | 6956 |
| 2 | Relay Mount for Control | 52316-2 |
| 3 | Omron Relay | 28904 |
| 4 | General Purpose Box | 42627-16 |
| 5 | Switch Box Gasket | 6777 |
| 6 | Switch Box Cover | 6776 |
| 7 | Proximity Sensor | 56275 |
| 8 | Cord Assembly | 4999-125 |
| 9 | Mounting Bracket | 52315 |
| 10 | Pan H SFTP #6-32 Screw | 35493 |

| Item | Description | Part No. |
|------|----------------------------------|-----------|
| 11 | #10 x .5 HXWH Screw | 28075 |
| 12 | 5" Hose Clamp | 13948 |
| 13 | #6-32 x 3/8 Phil Pan H Screw | 34660 |
| 14 | .5 x 1.058 x .265 Nylon Lock Nut | 43662 |
| 15 | Lock Washer | 305 |
| 16 | Hx Lock Nut w/Nylon Insert | 34019 |
| 17 | Drop Tube Switch Holder | 56302 |
| 18 | Liquid Tight Connector | 23779 |
| 19 | .25 x 2 Vinyl Tubing | 14454-2 |
| 20 | 56310 Drop Tube Switch Decal | 2529-1194 |

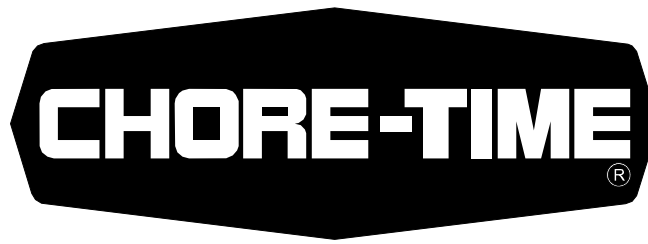

MADE TO WORK.

BUILT TO LAST.®

Revisions to this Manual

| Page No. | Description of Change | ECO |
|-----------------|------------------------------|------------|
| Various | A few wording changes | 35394 |

**For additional parts and information, contact your nearest Chore-Time distributor or representative.
Find your nearest distributor at: www.choretime.com/contacts**

CTB, Inc.
PO Box 2000
Milford, Indiana 46542-2000 USA
Phone (574) 658-4101 Fax (877) 730-8825
Email: choretime@choretime.com
Internet: www.choretime.com