

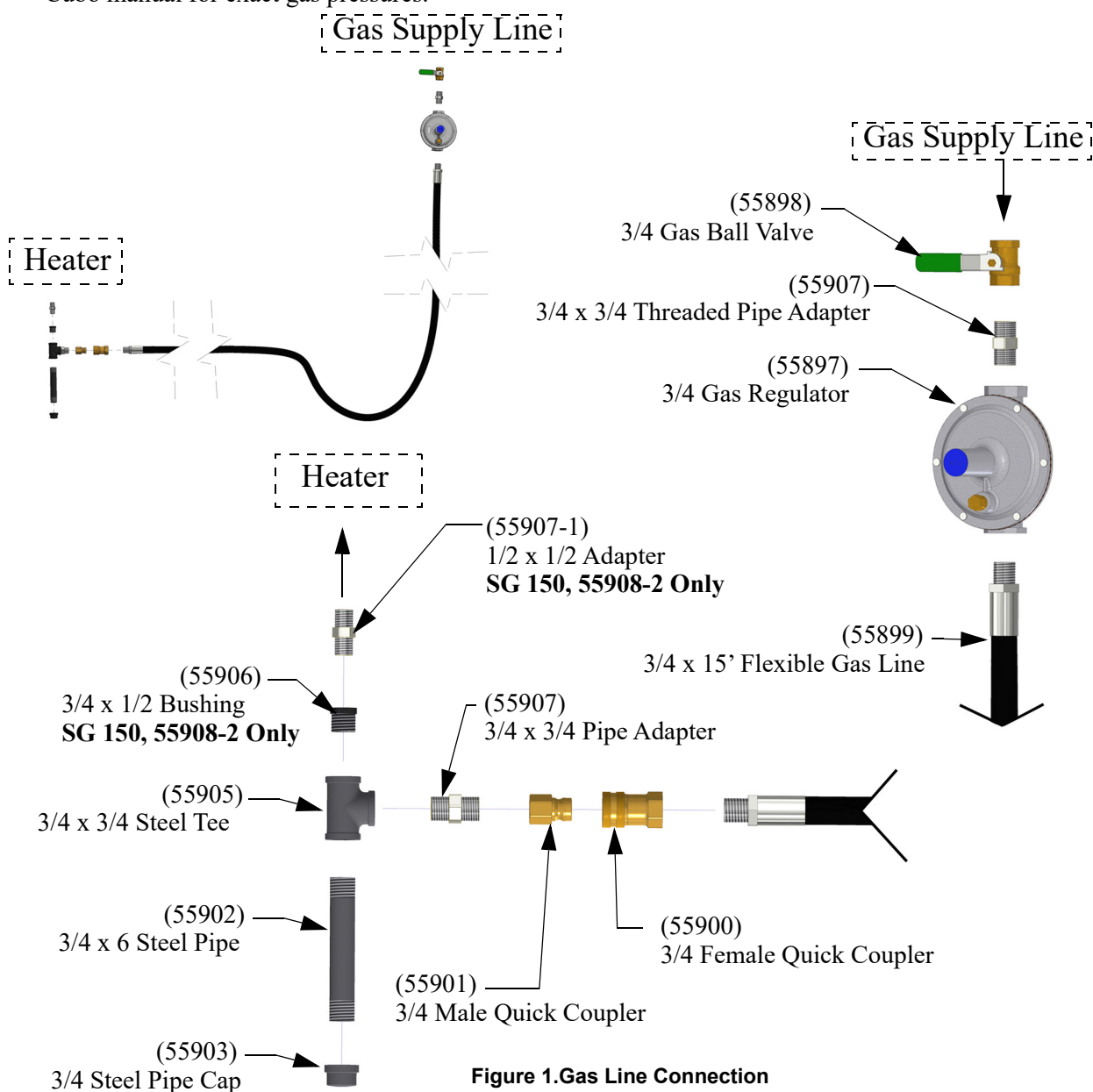

# Cubo™ SG45 & SG150 Gas Line Instruction

1. Install Gas Line as shown in **Figure 1. below.**
  - Configurations vary slightly between SG45 and SG150. The 55907 Adapter and 55906 Bushing is not required on the SG45.
2. Use Gas Pipe Tape (Supplied) on Threaded Connections.
3. The Gas Regulator (55897) includes a Vent Limiter and may be installed indoors on the ceiling, near the unit. Ensure that the Vent Limiter is oriented vertically.
4. The Gas Regulator (55897) comes with a Red Spring Pre-installed capable of 10-22 in. w.c. It is not pre-set to a certain pressure. If using propane gas, operating pressure should be 12-15 in. w.c. Therefore, adjustment is required. For Natural gas, operating pressure should be 7-9 in. w.c. To achieve this lower pressure the Violet Regulator Spring (56242-1) must be installed in place of the Red Spring supplied in the Regulator. Refer to the Cubo manual for exact gas pressures.



**Figure 1. Gas Line Connection**

# Part Numbers

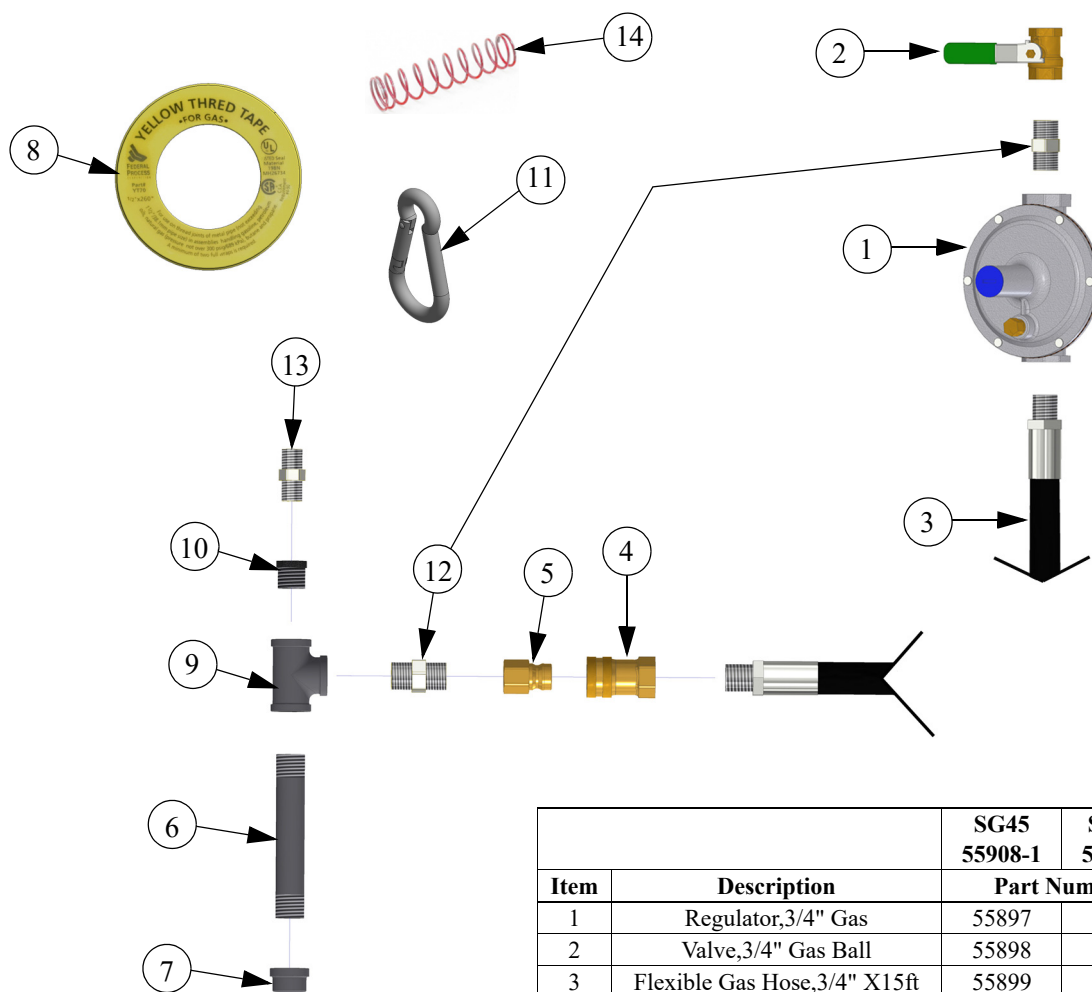

		SG45 55908-1	SG150 55908-2
Item	Description	Part Number	
1	Regulator, 3/4" Gas	55897	55897
2	Valve, 3/4" Gas Ball	55898	55898
3	Flexible Gas Hose, 3/4" X 15ft	55899	55899
4	3/4" Female Gas Quick Coupler	55900	55900
5	3/4" Male Gas Quick Coupler	55901	55901
6	3/4" X 6" Steel Pipe	55902	55902
7	Cap, 3/4" Steel Pipe	55903	55903
8	Gas Pipe Tape	55904	55904
9	3/4" X 3/4" Steel Tee	55905	55905
10	3/4" X 1/2" Bushing	--	55906
11	Spring Snap 1/4" Hook	39-20485	39-20485
12	3/4" Threaded Pipe Adapter	55907	55907
13	1/2" Threaded Pipe Adapter	--	55907-1
14	Violet Regulator Spring	56242-1	56242-1

## Revisions to this Manual

Page No.

Description of Change

ECO

Added 56242-1 Spring

33275

Contact your nearby Chore-Time distributor or representative for additional parts and information.

CTB Inc.

P.O. Box 2000 • Milford, Indiana 46542-2000 • U.S.A.

Phone (574) 658-4101 • Fax (877) 730-8825

E-Mail: [ctb@ctbinc.com](mailto:ctb@ctbinc.com) • Internet: <http://www.ctbinc.com>

Printed in the U.S.A.