

# **Linear Lift™ 800**

## **Cable to Chain Retrofit Instruction**

### **Kit Part No. 49871**

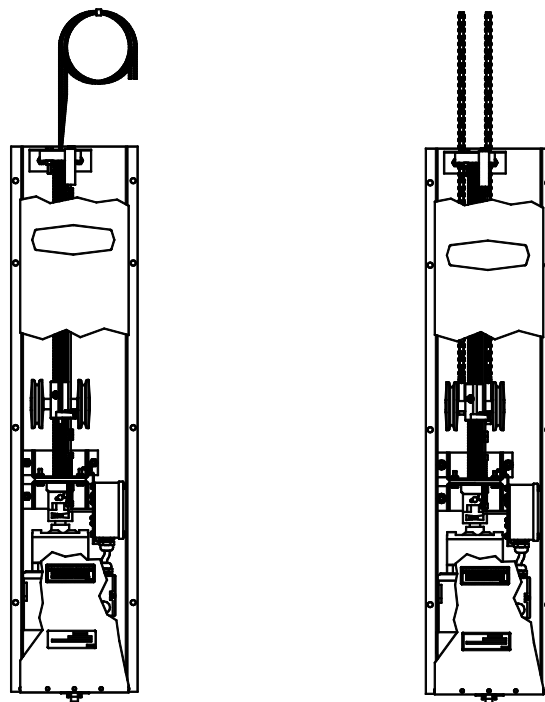

The Employees of Chore-Time Equipment would like to thank you for your recent Chore-Time purchase. If a problem should arise, your Chore-Time distributor can supply the necessary information to help you.

**Chore-Time Equipment**  
**A Division of CTB, Inc.**  
**P.O. Box 2000 • Milford, Indiana 46542-2000 • U.S.A.**  
**Phone (574) 658-4101 • Fax (877) 730-8825**  
**Email: [ctb@ctbinc.com](mailto:ctb@ctbinc.com) • Internet: <http://www.ctbinc.com>**

## Step by Step Changeover

1. Remove the Linear-Lift™ 800 Top Cover.
2. Remove the cables from the Brass Nut by pulling the cable stops (against the Brass Nut) toward the Motor end, until the cables are removed completely from the unit. Set them aside for spares.
3. Remove the Top Cover from the Lift. Remove the Cable Drive End Cover (**Item 1, Figure 1**) from the Top Cover by drilling out the 7 rivets fastening it to the Top Cover. Replace the Cable Drive End Cover with the new Chain Drive End Cover provided, and use 7 rivets to fasten it on (**See Figure 1**).

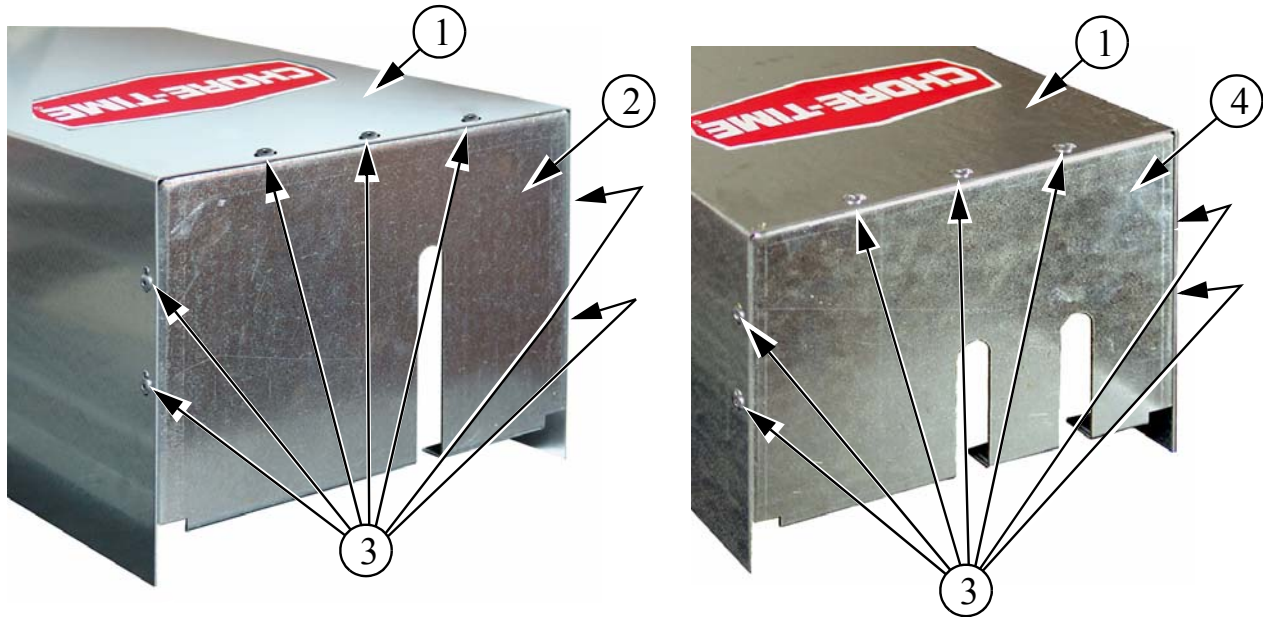

Item	Description
1	Top Cover
2	Cable Drive End Cover
3	Rivets
4	Chain Drive End Cover

**Figure 1. Changing End Cover to accept Chain**

4. **Note:** All hardware in this step will be re-used: **do not discard**. Remove the two 1/4-20 x .5 Bolts and Nuts (**Items 1 & 3, Figure 2**) that hold the Cable Drive End Bracket (**Item 4**) on to the Lift Base (**Item 6**) and set them aside. Slide the End Bracket, Cable Drive Shaft Pilot (**Item 5**), and Cable Drive Rod Support (**Item 7**) off the Threaded Rod. Remove the Cable Drive Shaft Pilot and Cable Drive Rod Support from the End Bracket by removing the 1/4-20 x 1.750 Bolts and Nuts (**Items 2 & 1**). You can discard the Cable Drive End Bracket and Cable Drive Shaft Pilot.

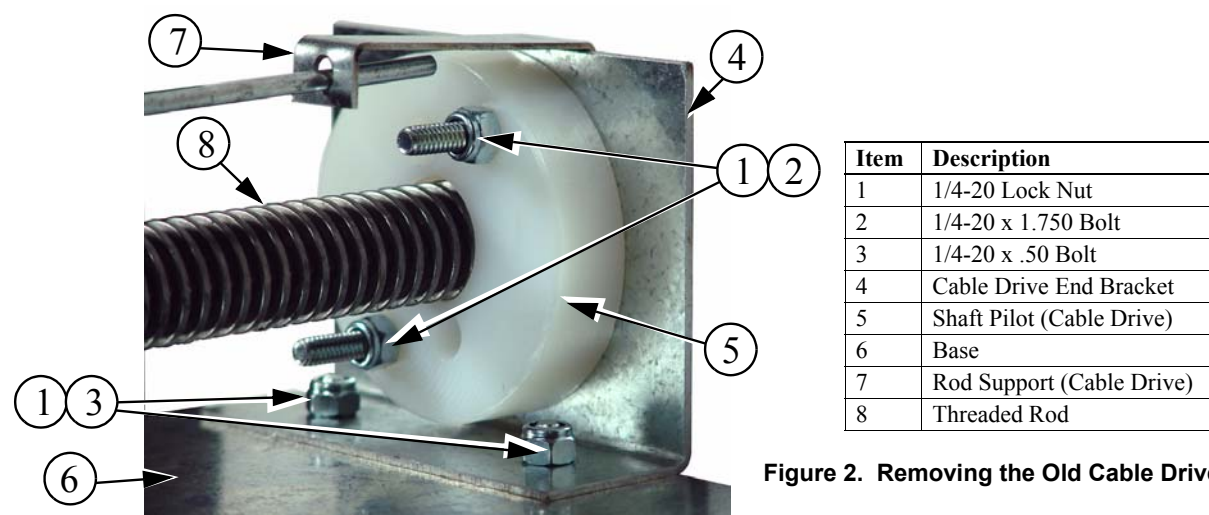

Item	Description
1	1/4-20 Lock Nut
2	1/4-20 x 1.750 Bolt
3	1/4-20 x .50 Bolt
4	Cable Drive End Bracket
5	Shaft Pilot (Cable Drive)
6	Base
7	Rod Support (Cable Drive)
8	Threaded Rod

Figure 2. Removing the Old Cable Drive Parts

5. Attach the Chain Drive Shaft Pilot (**Item 1, Figure 3**) and Chain Drive Rod Support (**Item 5**) to the Chain Drive End Bracket with two 1/4-20 x 1.750 Bolts and Lock Nuts (**Items 2 and 3, Figure 3**) that you set aside. Line up the Actuator Rod with the hole in the Chain Drive Rod Support, slide the Chain Drive Shaft Pilot over the Threaded Rod, and Fasten the Chain Drive End Bracket down to the Base with the 1/4-20 x .50 Bolts and Lock Nuts (**Items 6 and 3, Figure 4**) you had set aside.

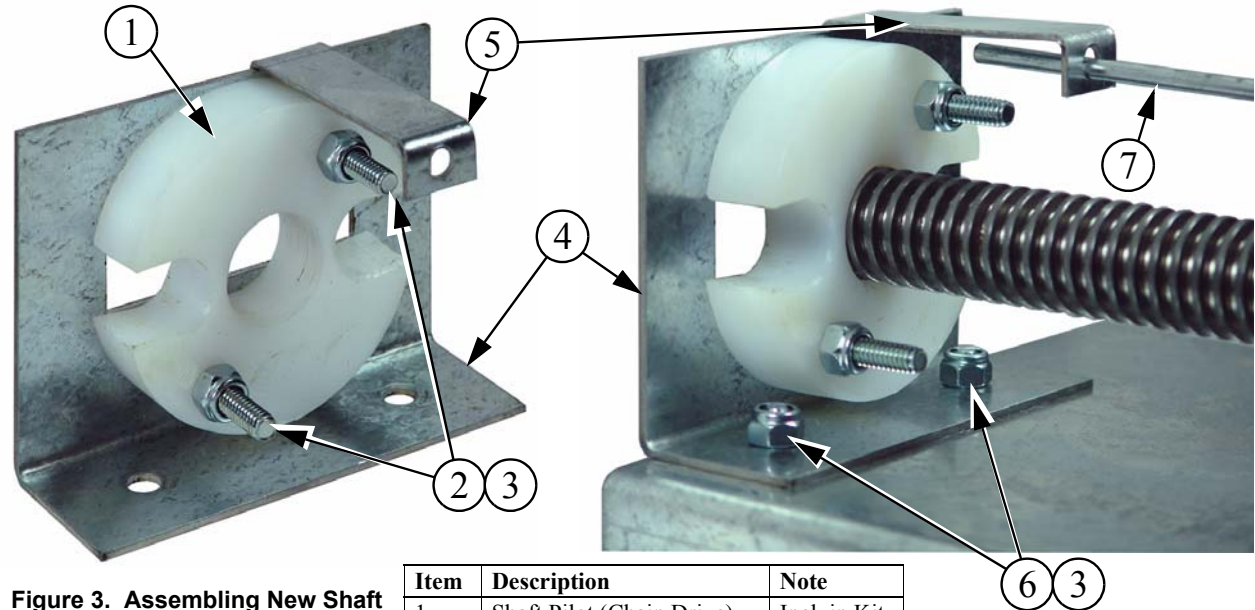

Figure 3. Assembling New Shaft Pilot to the End Bracket

Item	Description	Note
1	Shaft Pilot (Chain Drive)	Incl. in Kit
2	1/4-20 x 1.750 Bolt	
3	1/4-20 Lock Nut	
4	End Bracket (Chain Drive)	Incl. in Kit
5	Rod Support (Chain Drive)	Incl. in Kit
6	1/4-20 x .500 Bolt	
7	Actuator Rod	

Figure 4. Fastening the End Bracket to the Base

6. Insert one 1/4-20 x 1.50 Socket Head Cap Screw (**Item 1, Figure 5**) and one 1/4-20 x 2.250 Socket Head Cap Screw (**Item 2, Figure 5**) into the Brass Nut (**Item 3**) as shown.

**Important !**

**Apply Thread Locker** (LocTite® for example) **to the threads of both Cap Screws**. Thread Chain Connecting Rods (**Item 4**) onto both Cap Screws until tight with the following condition; The through-holes in the Chain Connecting Rods must be Vertically aligned, or the Bolts will fail when loading (**See Figure 5**).

7. Attach the Chains to the Connecting Rods using the Chain Link Connectors (**Item 5, Figure 6**) included in your Parts Package.

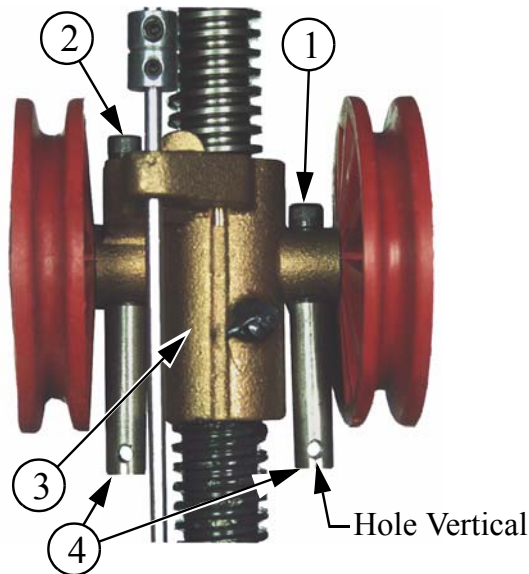

**Figure 5. Attaching Connecting Rods**

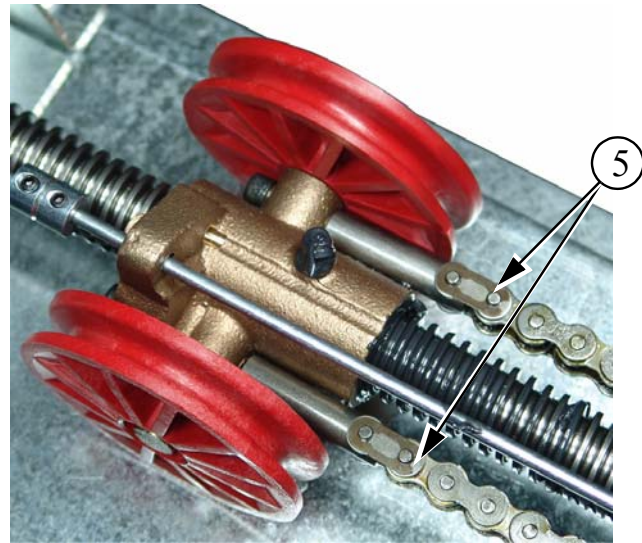

**Figure 6. Attaching Chains**

Item	Description	Note
1	1/4-20 x 1.5 SKTH Cp Screw	Incl. in Kit
2	1/4-20 x 2.25 SKTH Cp Screw	Incl. in Kit
3	Brass Nut	
4	Chain Connecting Rod	Incl. in Kit
5	Chain Connecting Link	Incl. in Kit

8. Thread the Chains through the Shaft Pilot as **shown in Figure 7** below.

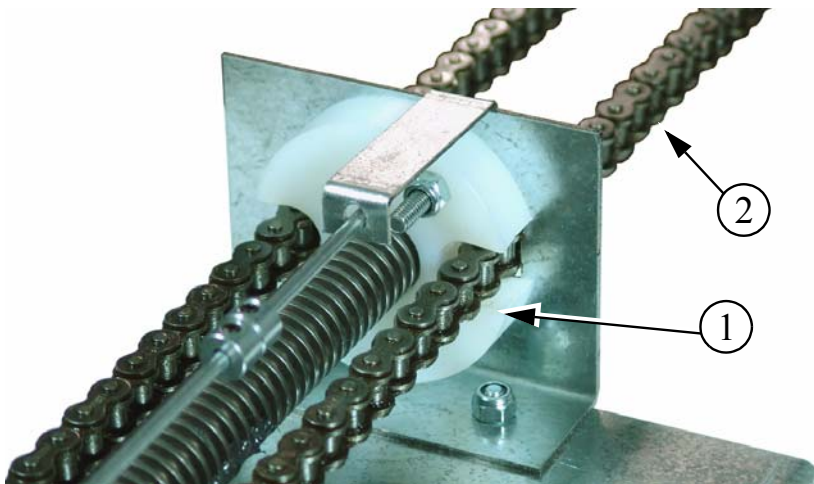

Item	Description
1	Chain Drive Shaft Pilot
2	Chain

**Figure 7. Threading Chains**

9. Grease the Brass Nut and Threaded Rod as needed.
10. Replace the Top Cover, and test for functionality and soundness.

**Part Numbers (Chore-Time Kit #49871)**

	<b>Description</b>	<b>Part No.</b>	<b>Qty.</b>
1	Linear Lift Rod Support W/Chain	44459	1
2	Linear Lift Threaded Pilot (Chain Dr.)	44413	1
3	LL 800 Pilot End Bracket (Chain Dr.)	44457	1
4	Connecting Link	20017	2
5	1/4-20 x 1.50 Socket Hd Cap Screw	5083-8	1
6	1/4-20 x 2.25 Socket Hd Cap Screw	5083-2	1
7	Chain Connecting Rod	44417	2
8	Drive Chain 34.5	21045-14	2
9	.1250 x .250 Pop Rivet	2946	7



**Made to work.  
Built to last.**

**Contact your nearby Chore-Time distributor or representative for additional parts and information.**

**CTB Inc.**

**P.O. Box 2000 • Milford, Indiana 46542-2000 • U.S.A.**

**Phone (574) 658-4101 • Fax (877) 730-8825**

**E-Mail: [ctb@ctbinc.com](mailto:ctb@ctbinc.com) • Internet: <http://www.ctbinc.com>**

Printed in the U.S.A.