

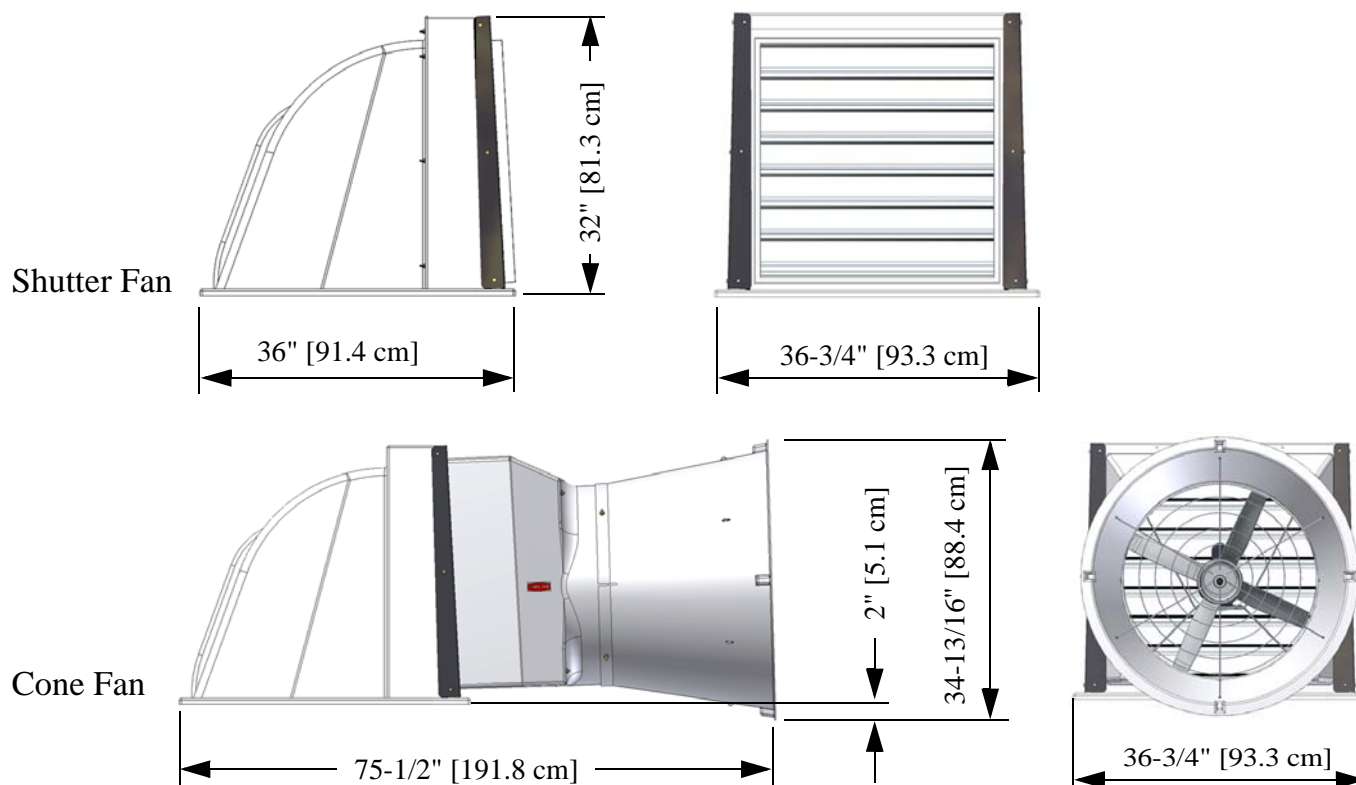

Pit Transition with Fan Installation and Operators Instruction Manual

Fan and Fan Framing Dimensions



Cone Fan Framing:

Cut a 32" [81.3 cm] x 32" [81.3 cm] opening for the Fan inlet and create a double treated 2 x 4 frame around it (See Figure 1).

Shutter Fan Framing:

Cut a 32" [81.3 cm] x 24" [60.9 cm] opening for the Fan inlet and create a double treated 2 x 4 frame around it with an extra 2 x 4 cross piece as shown in Figure 2.

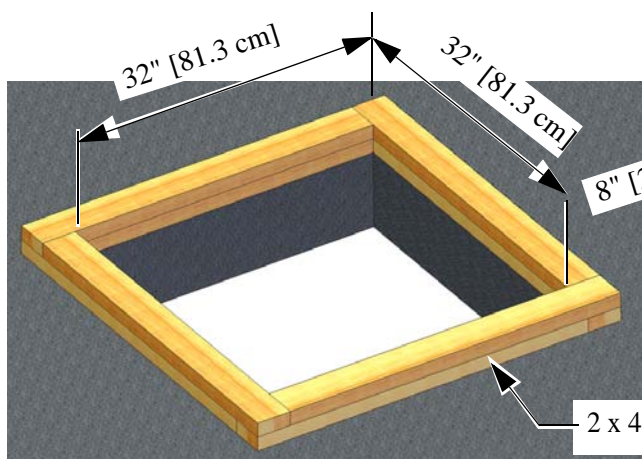

Figure 1. Cone Fan Framing

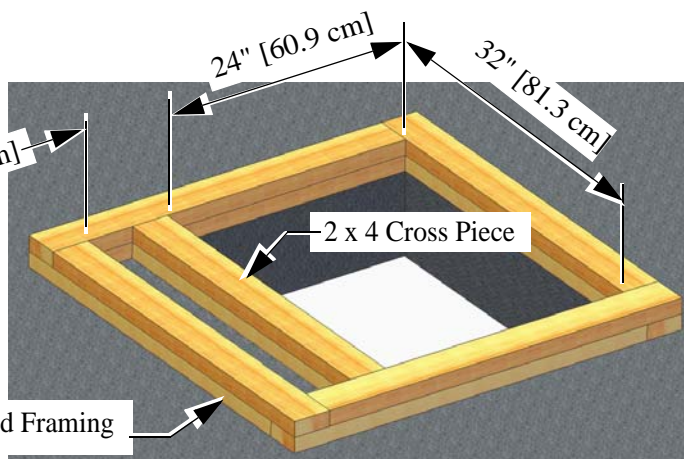
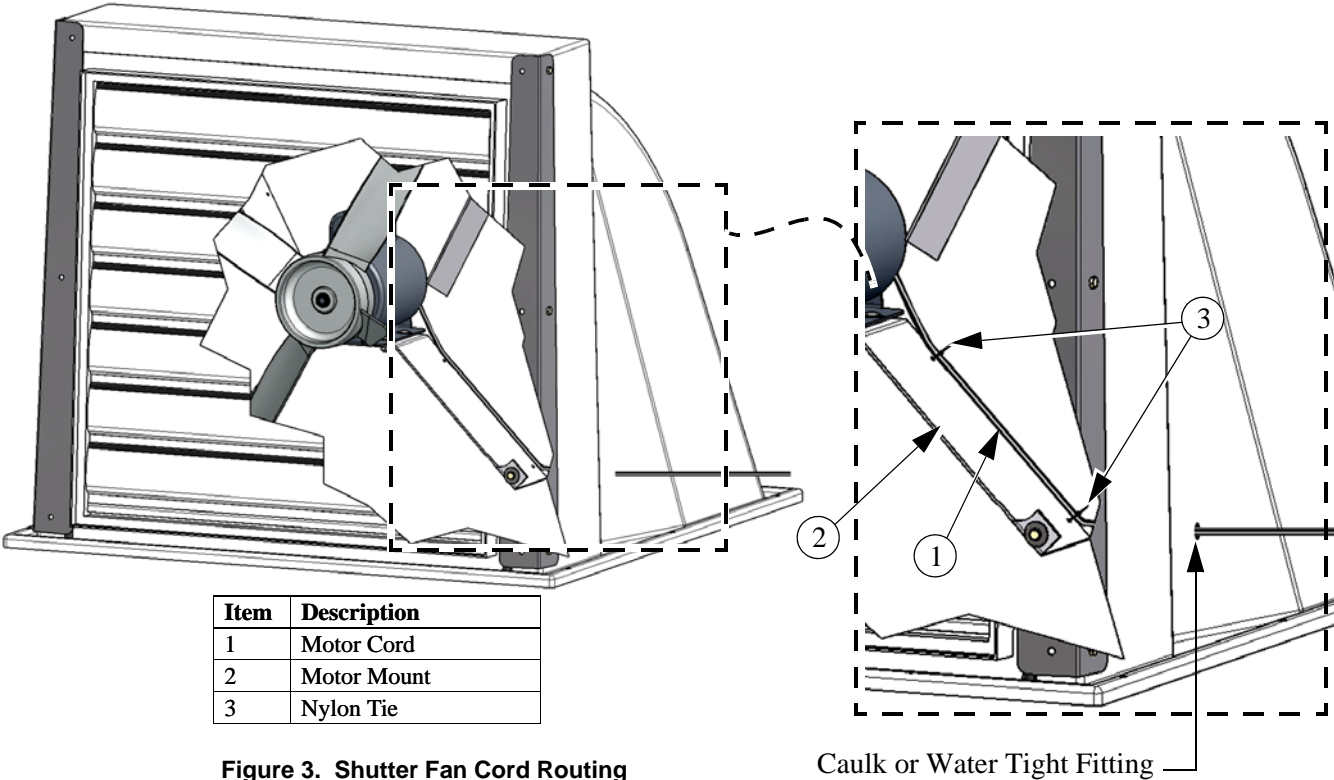

Figure 2. Shutter Fan Framing

Installation

Shutter Fan

Route the Motor Cord (**Item 1, Figure 3**) down the Motor Mount (**Item 2**) and use Nylon Ties (**Item 3**) to fasten it to the holes in the Motor Mount as shown. Drill a hole in the Transition and exit the cord through it. Use Caulk or a Water Tight Fitting to seal water out.



Attach the Transition to the 2 x 4 framing with 10 Lag Screws (**Item 1, Figure 4**) included in parts package.

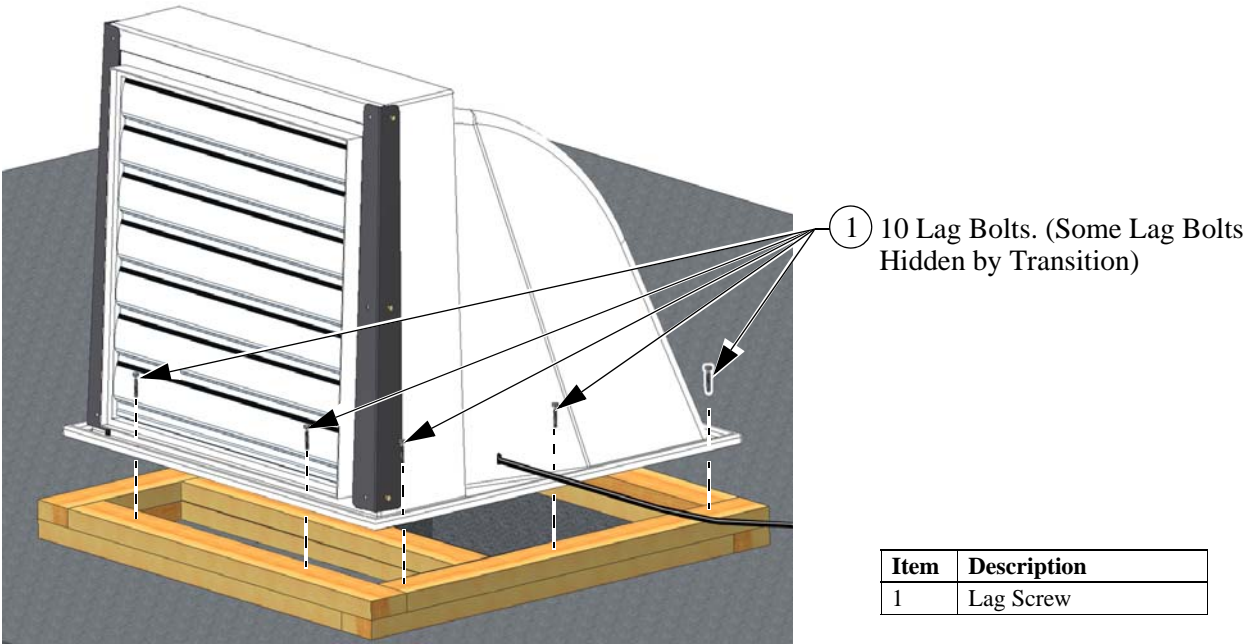

Cone Fan

Fastening Side Rails

Fasten the Side Rails (Item 1, Figure 5) to the Transition with 1/4-20 Flange Bolts (Item 2) and Nuts (Item 3) as shown.

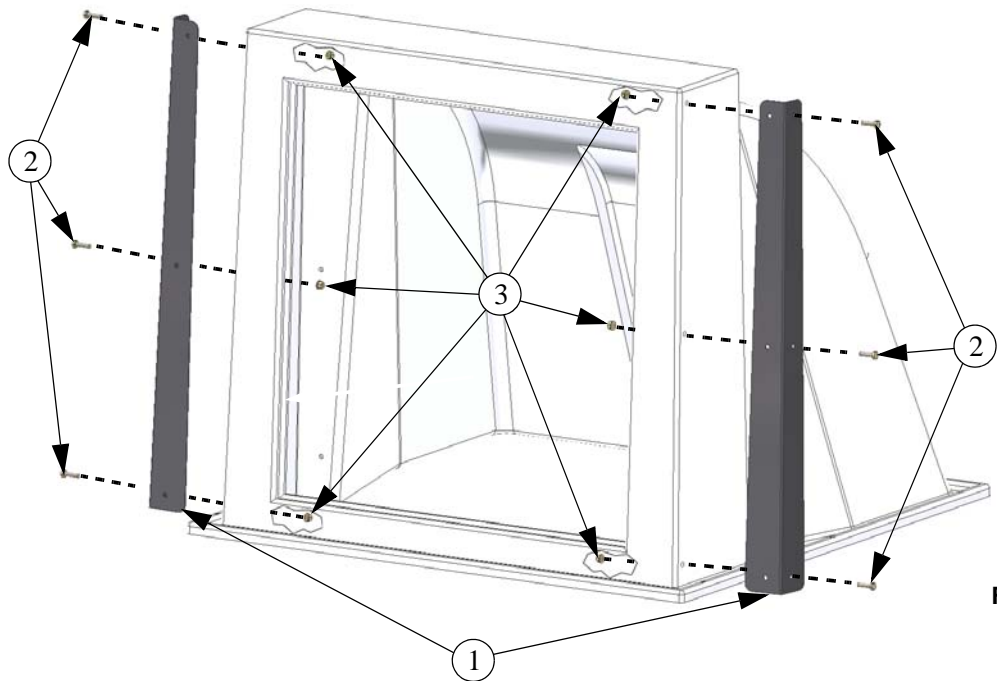

Item	Description
1	Side Rail
2	1/4-20 Flange Bolt
3	1/4-20 Flange Nut

Figure 5. Fastening Side Rails

Fastening the Transition to the Framing and Sliding Fan into Place

Set the Transition on the 2 x 4 framing and attach with 10 Lag Screws (Item 1, Figure 6) included in parts package. Capture the Fan Flanges between the Side Rails (Item 2) and the Transition (Item 3) and slide the Fan Assembly down into place as shown.

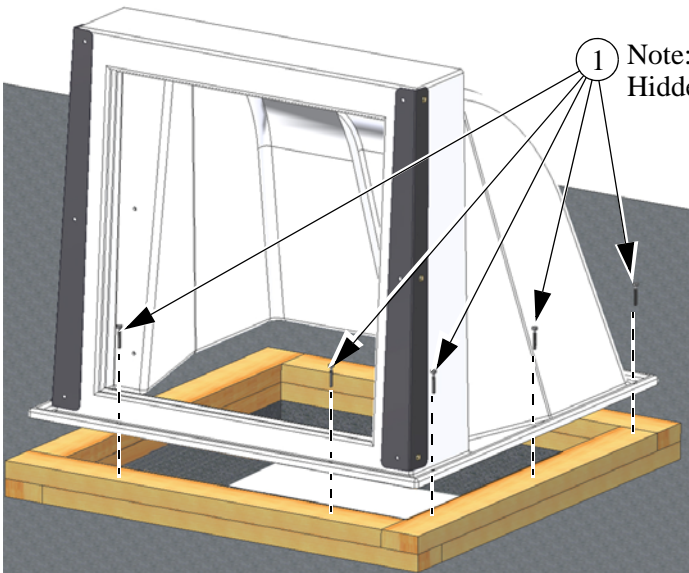

Note: 10 Lag Bolts. (Some Lag Bolts Hidden by Transition)

Item	Description
1	Lag Screw (Qty. 10)
2	Side Rail
3	Transition

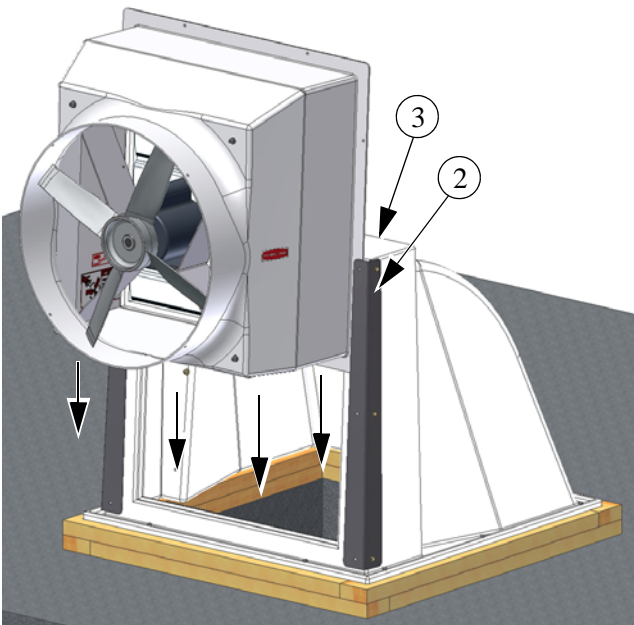

Figure 6. Fastening the Transition and sliding Fan Assembly into place

Cord Routing

Route the Motor Cord (**Item 1, Figure 7**) down the Motor Mount (**Item 2**) and use Nylon Ties (**Item 3**) to fasten it to the holes in the Motor Mount as shown. Drill a hole in the Fan Housing and exit the cord through it, making sure it does not interfere with the Shutter. Use Caulk or a Water Tight Fitting to seal water out.

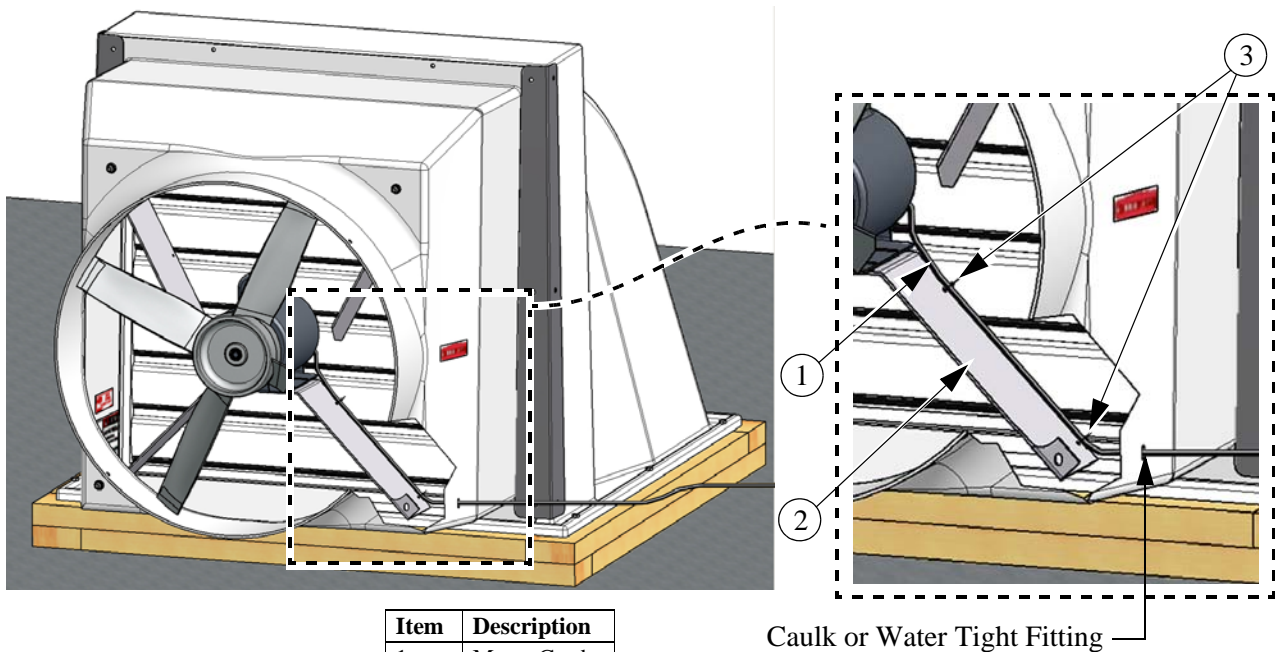

Figure 7. Cord Routing

Attaching the Cone

Slide the Cone (**Item 1, Figure 8**) onto the Fan Shroud. Spin the Cone around until the four holes in the Cone line up with the four holes in the Fan Shroud and Fasten with four Bolts (**Item 2**) and Flange Nuts (**Item 3**) as shown. Install the Grill (**Item 4**) by inserting it into the notches in the Cone as shown.

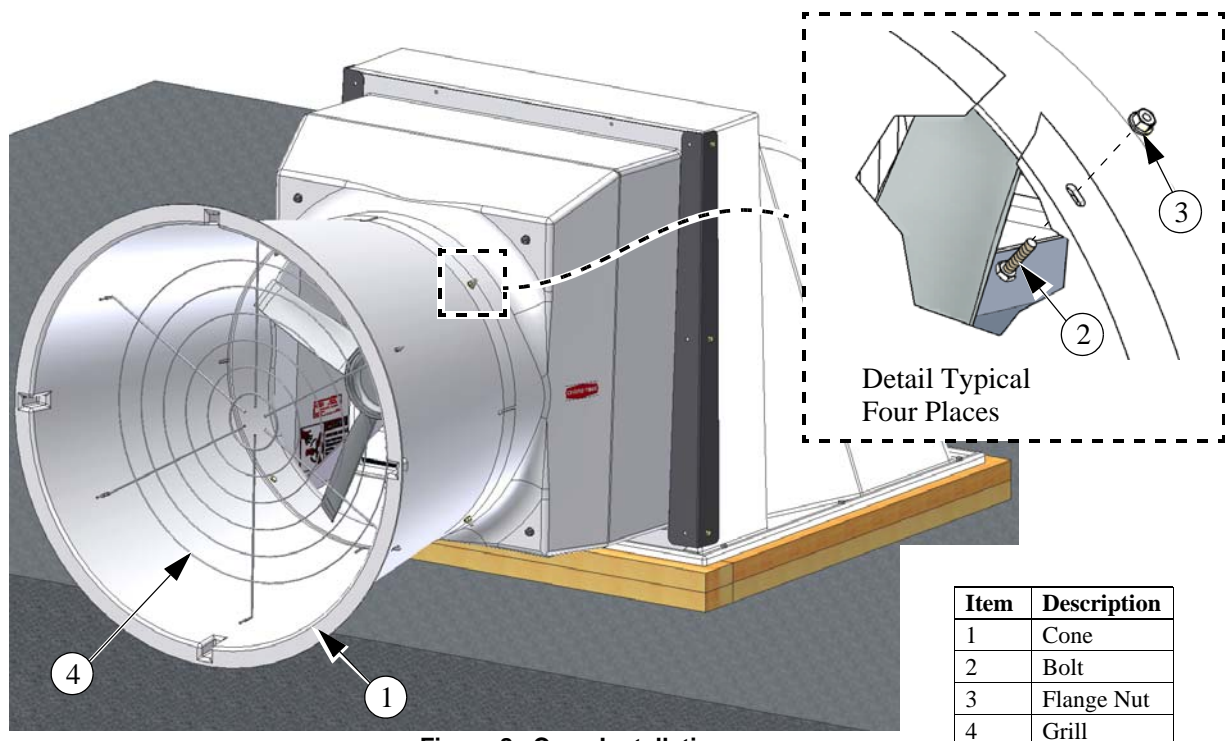
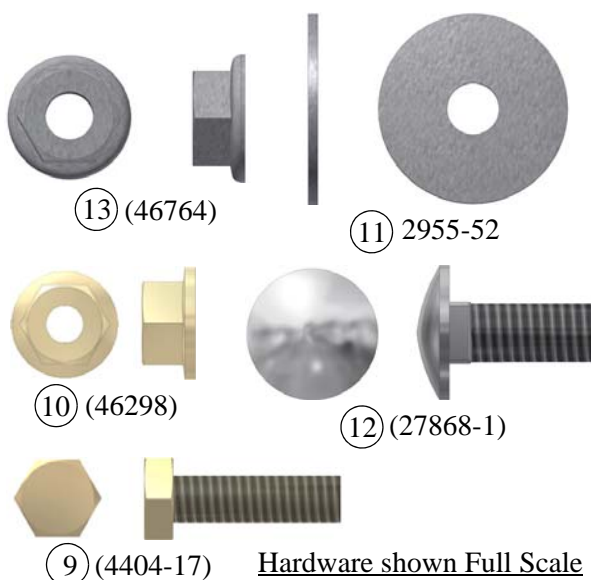
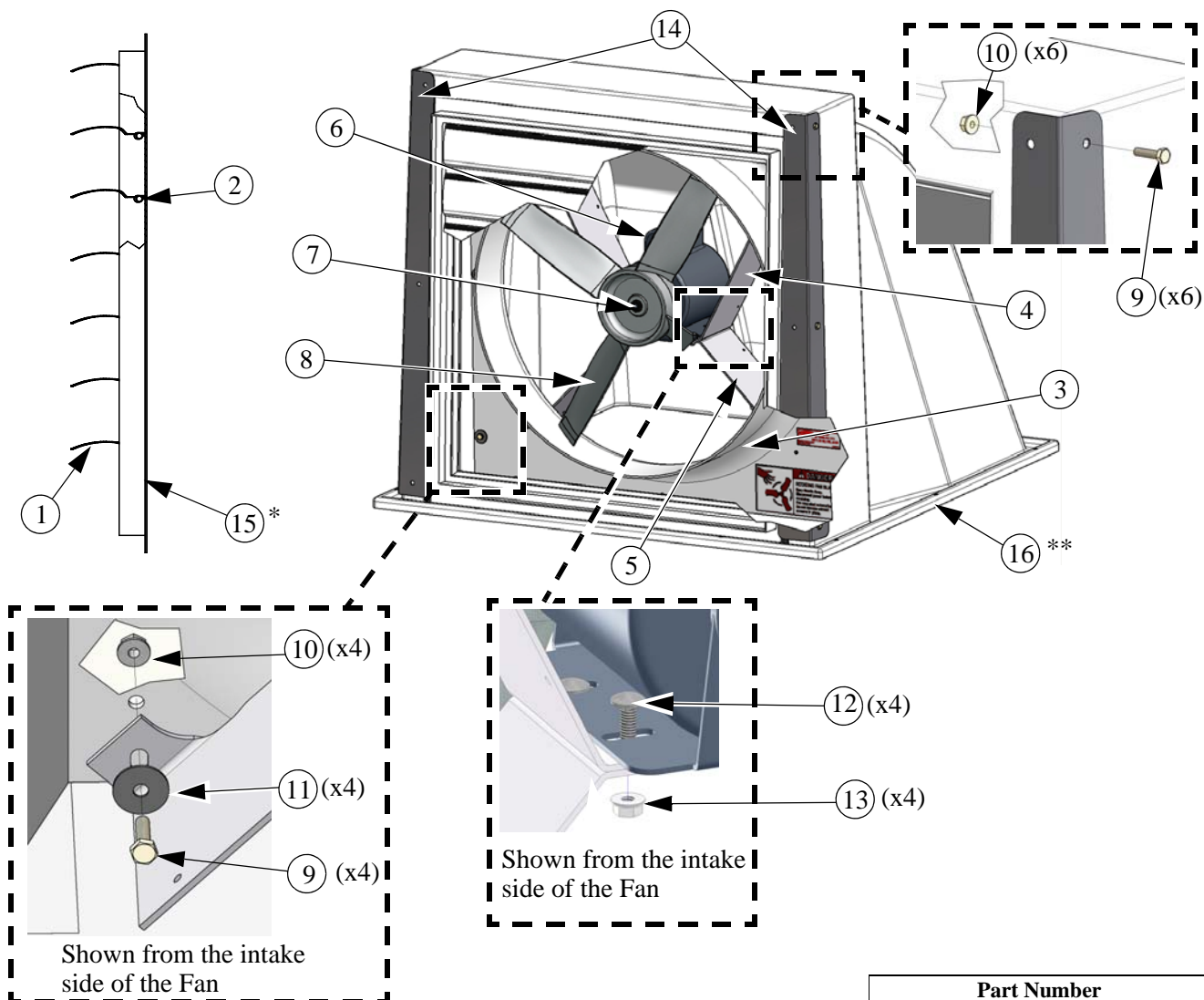

Figure 8. Cone Installation

Part Numbers

18" (53397) and 24" (50501) Shutter Fans



Item	Description	Part Number	
		50501 (24" Fan)	53397 (18" Fan)
1	Shutter Louver (Repair Part)	38038-9	38038-9
2	Pivot Rod (Repair Part)	38702-9	38702-9
3	TPO Fan Panel	41513	53380
4	Upper Motor Mount	40123	40439
5	Lower Motor Mount	40124	40440
6	Motor	33893	7034
7	1/2" Expanding Bushing	40674	40674
8	Fan Blade	40671	40672
9	1/4-20 x .88 SS Bolt	4404-17	4404-17
10	1/4-20 Ser. Fl. Nut	46298	46298
11	.275 x 1.00 x .075 Washer	2955-52	2955-52
12	5/16-18 x .75 SS Car. Bolt	27868-1	27868-1
13	5/16-18 Ser. Flg. Nut	46764	46764
14	Pit Transition Side Rail	51128	51128
15*	Fan Shutter Assembly w/trim	50500	50500
16**	Panel Fan Assembly	50499	50499

*Includes Items 1, and 2

**Includes Items 3,4,5,6,7,8,9,10,11,12,13,14,15

24" Cone Fan (Part Number 51160)

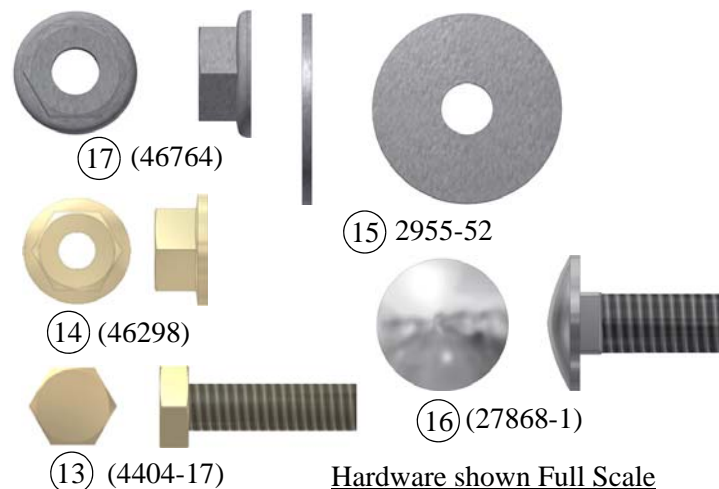
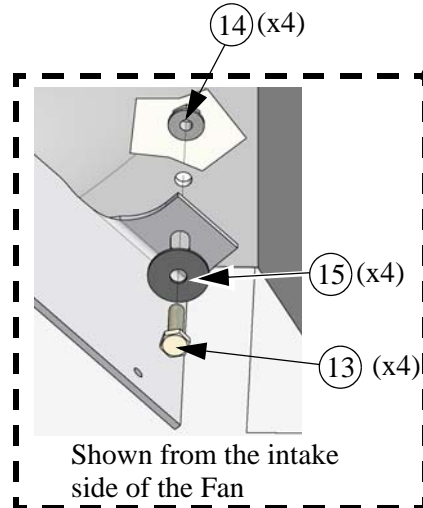
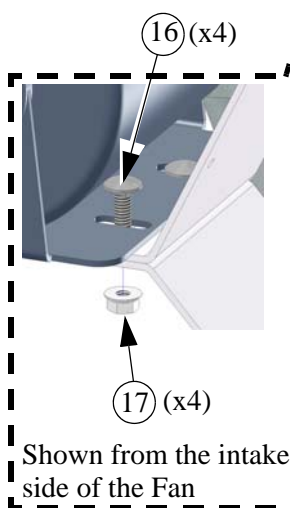
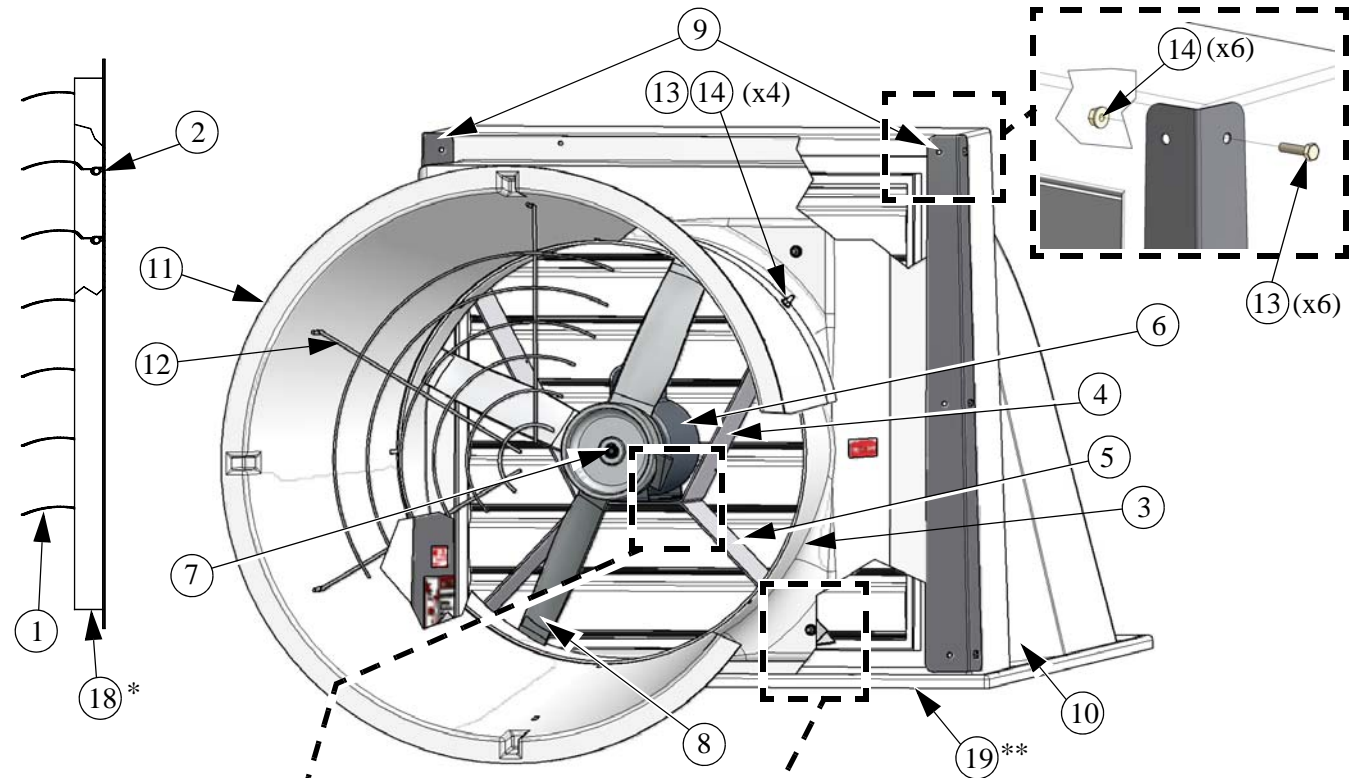

Item	Description	Part No.
1	Shutter Louver (Repair Part)	38038-9
2	Pivot Rod (Repair Part)	38702-9
3	24" Fiberglass Fan Shroud	40177
4	Upper Motor Mount	40123
5	Lower Motor Mount	40124
6	Motor	33893
7	1/2" Expanding Bushing	40674
8	24" Fan Blade	40671
9	Pit Transition Side Rail	51128
10	24" Pit Transition	50499
11	24" Turbo Fan Cone	40179
12	24" Cone Grill	35338
13	1/4-20 x .88 SS Bolt	4404-17
14	1/4-20 Hex Ser. Flng. Nut	46298
15	.275 x 1.00 x .075 Washer	2955-52
16	5/16-18 x .75 SS Car. Bolt	27868-1
17	5/16-18 Ser. Flg. Nut	46764
18*	Fan Shutter Assembly	40602
19**	Panel Fan Assembly	40461-22
* Includes Items 1, and 2		
**Includes Items 3,4,5,6,7,8,9,10,11,12,13,14,15,16,17,18		

Safety Information

Carefully read all safety messages in this manual and on your equipment safety signs. Follow recommended precautions and safe operating practices. Keep safety signs in good condition. Replace missing or damaged safety signs.

DANGER: Electrical Hazard

Disconnect electrical power before inspecting or servicing equipment. Ground all electrical equipment for safety. All electrical wiring must be done by a qualified electrician in accordance with local and national electric codes. Ground all non-current carrying metal parts to guard against electrical shock. With the exception of motor overload protection, electrical disconnects and over current protection are not supplied with the equipment.



DANGER: Rotating Fan Blade

Keep Hands away. Disconnect power before servicing. Fan may start automatically. Do not operate the Fan without the screens in place. Disregard to these things will cause serious injury including death.



Warranty

Chore-Time Equipment ("Chore-Time") warrants each new Chore-Time product manufactured by it to be free from defects in material or workmanship for one year from and after the date of initial installation by or for the original purchaser. If such a defect is found by the Manufacturer to exist within the one-year period, the Manufacturer will, at its option, (a) repair or replace such product free of charge, F.O.B. the factory of manufacture, or (b) refund to the original purchaser the original purchase price, in lieu of such repair or replacement. Labor costs associated with the replacement or repair of the product are not covered by the Manufacturer.

Conditions and Limitations

1. The product must be installed by and operated in accordance with the instructions published by the **Manufacturer** or **Warranty will be void.**
2. Warranty is void if **all components** of the system are not original equipment supplied by the **Manufacturer.**
3. This product must be purchased from and installed by an authorized distributor or certified representative thereof or the Warranty will be void.
4. Malfunctions or failure resulting from misuse, abuse, negligence, alteration, accident, or lack of proper maintenance shall not be considered defects under the Warranty.
5. This Warranty applies only to systems for the care of poultry and livestock. Other applications in industry or commerce are not covered by this Warranty.

The **Manufacturer** shall not be liable for any **Consequential or Special Damage** which any purchaser may suffer or claim to suffer as a result of any defect in the product. **"Consequential"** or **"Special Damages"** as used herein include, but are not limited to, lost or damaged products or goods, costs of transportation, lost sales, lost orders, lost income, increased overhead, labor and incidental costs and operational inefficiencies.

THIS WARRANTY CONSTITUTES THE MANUFACTURER'S ENTIRE AND SOLE WARRANTY AND THIS MANUFACTURER EXPRESSLY DISCLAIMS ANY AND ALL OTHER WARRANTIES, INCLUDING, BUT NOT LIMITED TO, EXPRESS AND IMPLIED WARRANTIES AS TO MERCHANTABILITY, FITNESS FOR PARTICULAR PURPOSES SOLD AND DESCRIPTION OR QUALITY OF THE PRODUCT FURNISHED HEREUNDER.

Chore-Time Distributors are not authorized to modify or extend the terms and conditions of this Warranty in any manner or to offer or grant any other warranties for Chore-Time products in addition to those terms expressly stated above. An officer of CTB, Inc. must authorize any exceptions to this Warranty in writing. The Manufacturer reserves the right to change models and specifications at any time without notice or obligation to improve previous models.



Made to work. Built to last.

Note: The original, authoritative version of this manual is the [English] version produced by CTB, Inc. or any of its subsidiaries or divisions, (hereafter collectively referred to as "CTB"). Subsequent changes to any manual made by any third party have not been reviewed nor authenticated by CTB. Such changes may include, but are not limited to, translation into languages other than [English], and additions to or deletions from the original content. CTB disclaims responsibility for any and all damages, injuries, warranty claims and/or any other claims associated with such changes, inasmuch as such changes result in content that is different from the authoritative CTB-published [English] version of the manual. For current product installation and operation information, please contact the customer service and/or technical service departments of the appropriate CTB subsidiary or division. Should you observe any questionable content in any manual, please notify CTB immediately in writing to: CTB Legal Department, P.O. Box 2000, Milford, IN 46542-2000 USA.

Revisions to this Manual

Page No.	Description of Change
Various	Added 18" Fan information.

Contact your nearby Chore-Time distributor or representative for additional parts and information.
CTB Inc.

P.O. Box 2000 • Milford, Indiana 46542-2000 • U.S.A.

Phone (574) 658-4101 • Fax (877) 730-8825

E-Mail: ctb@ctbinc.com • Internet: <http://www.ctbinc.com>

Printed in the U.S.A.