

Tunnel Door (Black)

Installation Instruction Manual

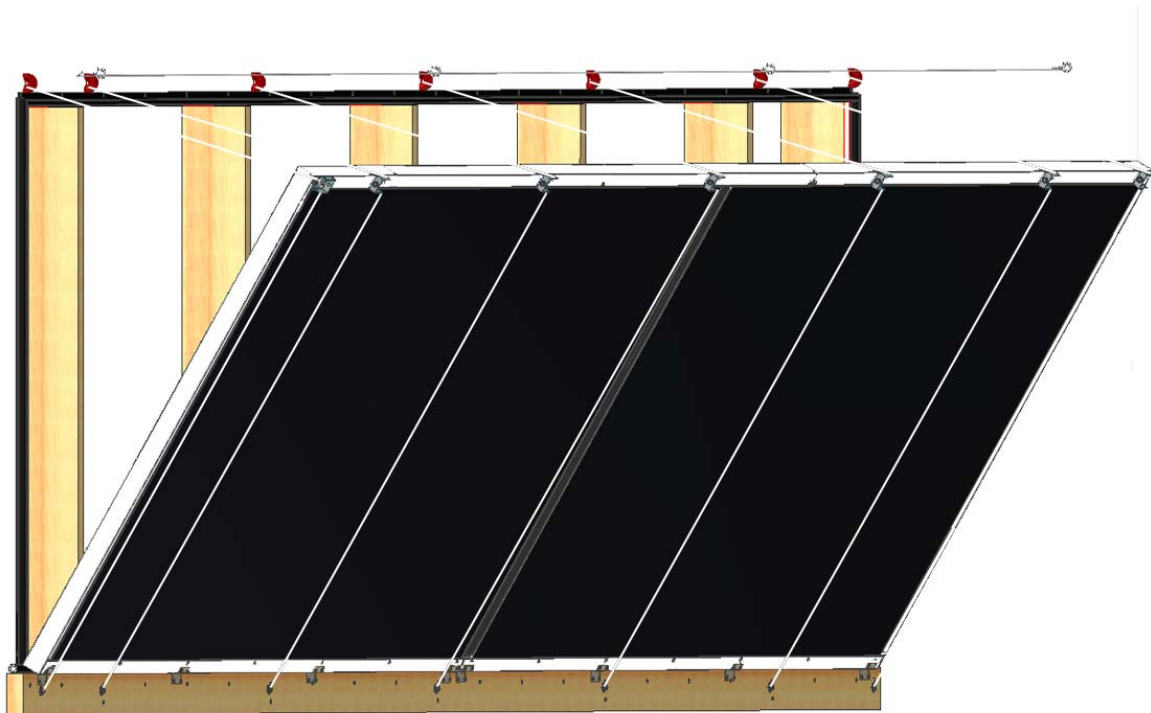

Chore-Time Warranty

Chore-Time Equipment ("Chore-Time") warrants each new Chore-Time product manufactured by it to be free from defects in material or workmanship for one year from and after the date of initial installation by or for the original purchaser. If such a defect is found by the Manufacturer to exist within the one-year period, the Manufacturer will, at its option, (a) repair or replace such product free of charge, F.O.B. the factory of manufacture, or (b) refund to the original purchaser the original purchase price, in lieu of such repair or replacement. Labor costs associated with the replacement or repair of the product are not covered by the Manufacturer.

Conditions and Limitations

1. The product must be installed by and operated in accordance with the instructions published by the **Manufacturer or Warranty will be void.**
2. Warranty is void if **all components** of the system are not original equipment supplied by the **Manufacturer.**
3. This product must be purchased from and installed by an authorized distributor or certified representative thereof or the Warranty will be void.
4. Malfunctions or failure resulting from misuse, abuse, negligence, alteration, accident, or lack of proper maintenance shall not be considered defects under the Warranty.
5. This Warranty applies only to systems for the care of poultry and livestock. Other applications in industry or commerce are not covered by this Warranty.

The **Manufacturer** shall not be liable for any **Consequential or Special Damage** which any purchaser may suffer or claim to suffer as a result of any defect in the product. **"Consequential" or "Special Damages"** *as used herein include, but are not limited to, lost or damaged products or goods, costs of transportation, lost sales, lost orders, lost income, increased overhead, labor and incidental costs and operational inefficiencies.*

THIS WARRANTY CONSTITUTES THE MANUFACTURER'S ENTIRE AND SOLE WARRANTY AND THIS MANUFACTURER EXPRESSLY DISCLAIMS ANY AND ALL OTHER WARRANTIES, INCLUDING, BUT NOT LIMITED TO, EXPRESS AND IMPLIED WARRANTIES AS TO MERCHANTABILITY, FITNESS FOR PARTICULAR PURPOSES SOLD AND DESCRIPTION OR QUALITY OF THE PRODUCT FURNISHED HEREUNDER.

Chore-Time Distributors are not authorized to modify or extend the terms and conditions of this Warranty in any manner or to offer or grant any other warranties for Chore-Time products in addition to those terms expressly stated above. An officer of CTB, Inc. must authorize any exceptions to this Warranty in writing. The Manufacturer reserves the right to change models and specifications at any time without notice or obligation to improve previous models.

Effective: **February 2013**

CTB Inc.
A Division of CTB, Inc.
P.O. Box 2000 • Milford, Indiana 46542-2000 • U.S.A.
Phone (574) 658-4101 • Fax (877) 730-8825
Email: ctb@ctbinc.com • Internet: <http://www.ctbinc.com>

Thank You

The employees of CTB Inc. would like to thank you for your recent Chore-Time purchase. If a problem should arise, your Chore-Time distributor can supply the necessary information to help you.

Contents

Topic	Page	User
Chore-Time Warranty	2	C,D
General	4	I,C
Support Information	4	
Safety Information	4	I,C
DANGER: Electrical Hazard	4	
Tools Needed	4	I
Installation Planning	5	I
Framed Opening	5	
Installation	6	I
Top and Bottom Chalklines and 2 x 4 Door Support.	6	
Seal Installation	7	
Rope Guides	8	
Door Installation	9	
Adding Door Sections	10	
Installation of Split Bolts for Rope/Cable Attachments.	11	
Cable Tensioner and Cable Installation (Cable Version Only)	12	
Installing Remaining Door Sections	13	
Last Door Section.	14	
Winch Installation	15	
Door Suspension Installation	16	
Installing Counter Weight	17	
Rope Attachment	18	
Cable Attachment	19	
Final Door Adjustment	20	
4' and 5' Tall Door Sections	22	I,C
Part Numbers for 4' and 5' Tall Door Sections	23	I,C
Part Numbers for Individual Door Assemblies	24	I,C

General

Support Information

The Chore-Time Tunnel Door is to be used to control the airflow in a Tunnel Ventilated poultry house. Using this equipment for any other purpose or in a way not within the operating recommendations specified in this manual will void the warranty and may cause personal injury.

This manual is designed to provide comprehensive planning, installation, safety, operation, and parts listing information. The Table of Contents provides a convenient overview of the information in this manual. The Table of Contents also specifies which pages contain information for the sales personnel, installer, and consumer (end user).

Safety Information

Caution, Warning and Danger Decals have been placed on the equipment to warn of potentially dangerous situations. Care should be taken to keep this information intact and easy to read at all times. Replace missing or damaged safety decals immediately.

Using the equipment for purposes other than specified in this manual may cause personal injury and/or damage to the equipment.

DANGER: Electrical Hazard

Disconnect electrical power before inspecting or servicing equipment. Ground all electrical equipment for safety. All electrical wiring must be done by a qualified electrician in accordance with local and national electric codes. Ground all non-current carrying metal parts to guard against electrical shock. With the exception of motor overload protection, electrical disconnects and over current protection are not supplied with the equipment.



Tools Needed

Tape Measure
Chalkline
Electric Drill
 -Square Driver Bit
 -3/8" Hex Socket
 - Screwdriver Bit
 -1/2" [1.3cm] Drill Bit (For Doors with Rope Suspension)
Hammer
Knife
Tin Snips

Installation Planning

Framed Opening

Winch Capacity- approximately 15 lbs/ft [6.8 Kg/30.5cm] of Door length

Wall should be flat within 1/8" per 4' [3.2mm per 1.219m] to ensure a good seal around the Doors

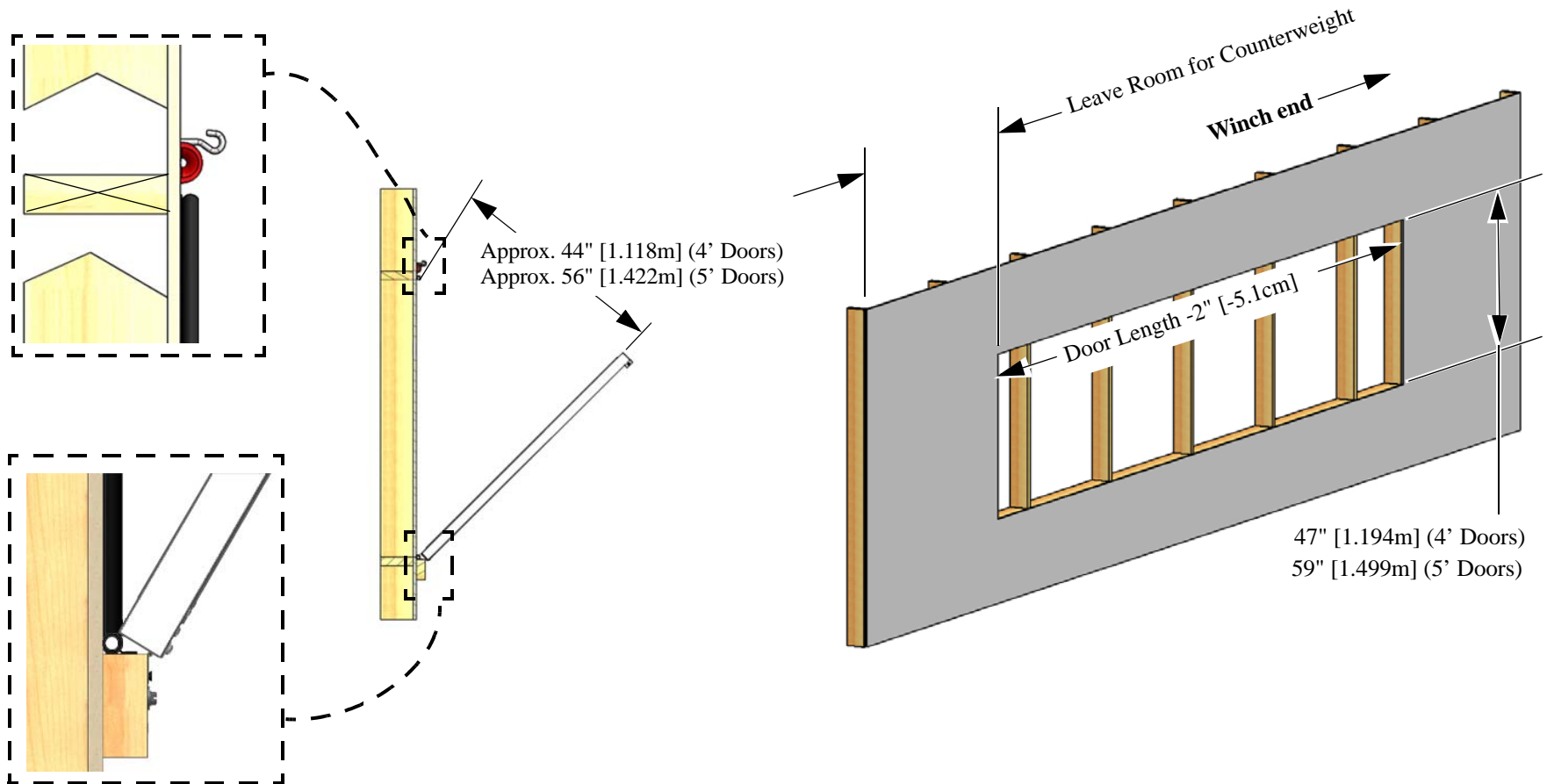

Installation

Top and Bottom Chalklines and 2 x 4 Door Support

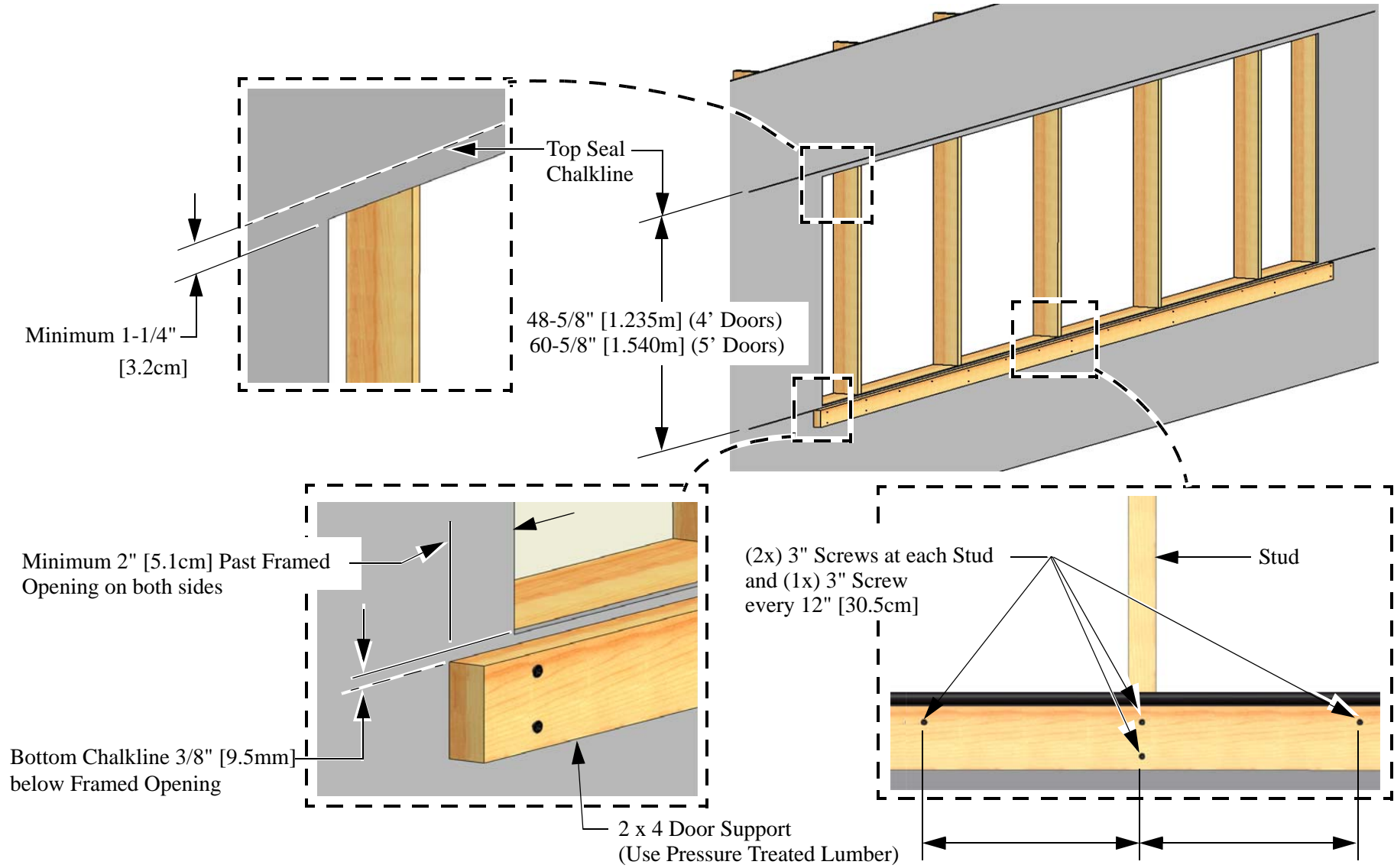

Seal Installation

Step 1. Black Seal- Attach Black Seal across the bottom of the Framed opening with Roofing Nails or Screws. Space Nails/Screws 12" [30.5cm] apart, except 1" [2.5cm] at the ends (See below).

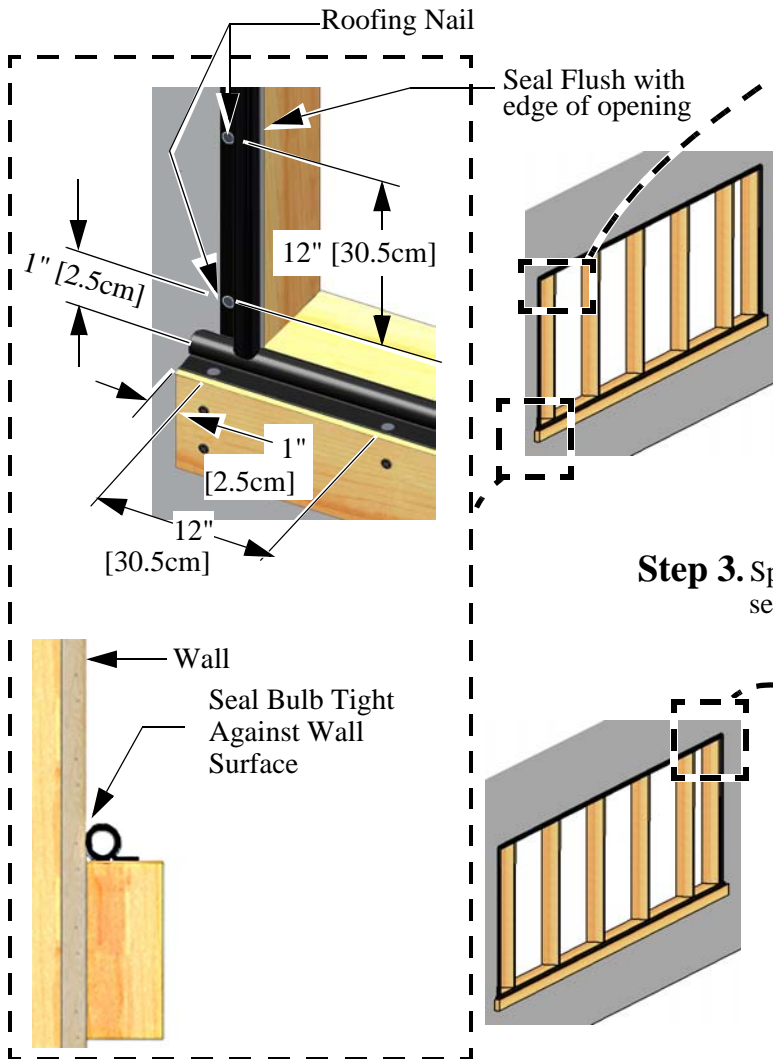

Step 2. Attach one continuous piece of Black Seal to the Sides and Top of the opening. Start attaching seal at a bottom corner of the framed opening with Nails/Screws 12" [30.5cm] apart and 1" [2.5cm] at the end. Make a Slit and a Notch in the Seal to allow for bending 90° at the 1st Corner (as shown below).

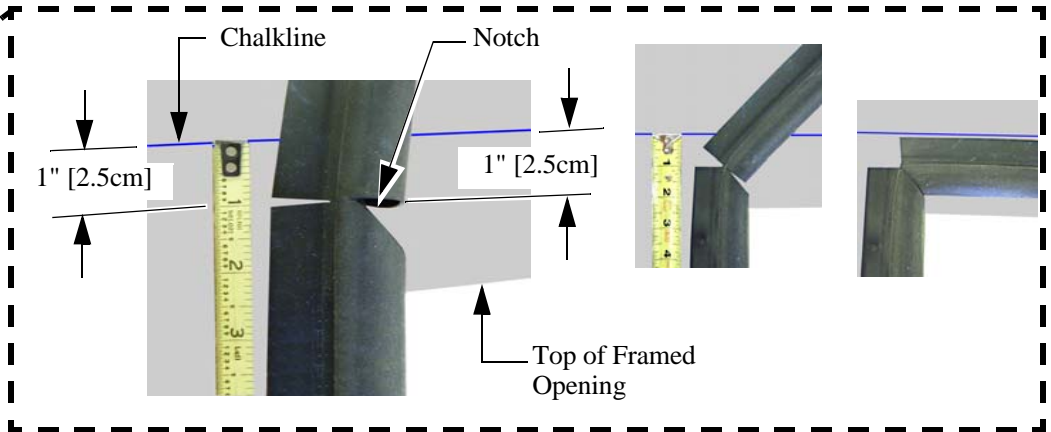

Step 3. Split the Seal 3/4" [1.9cm] past the Framed opening at the second corner as shown below.

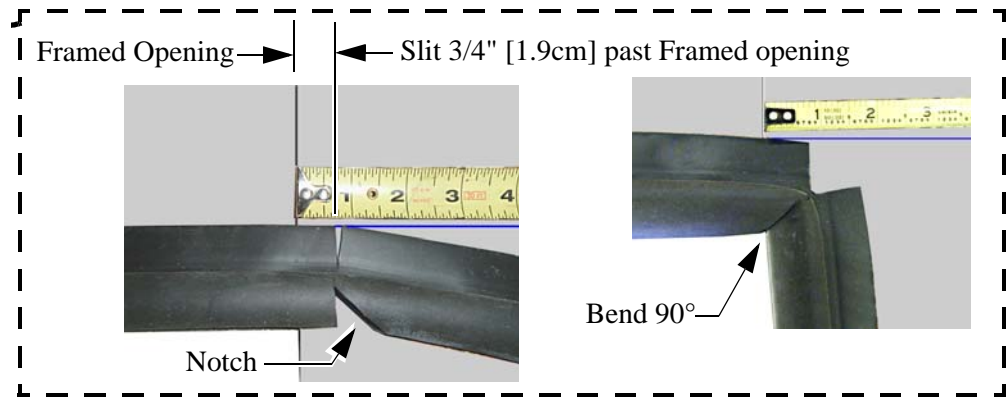

Rope Guides

Counter weight End

At the End of the Doors Angle the 1/4 x 1-3/4 Lag Screw down into the Top 2x4 as shown.

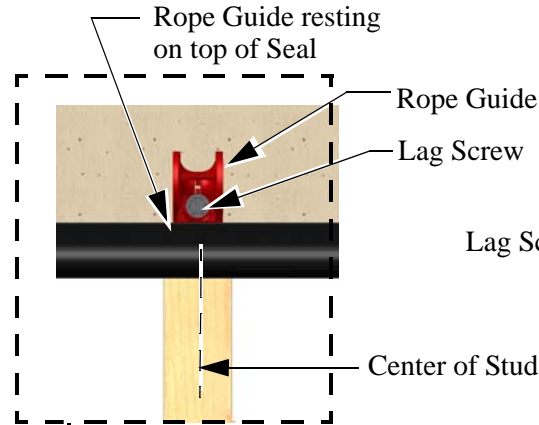
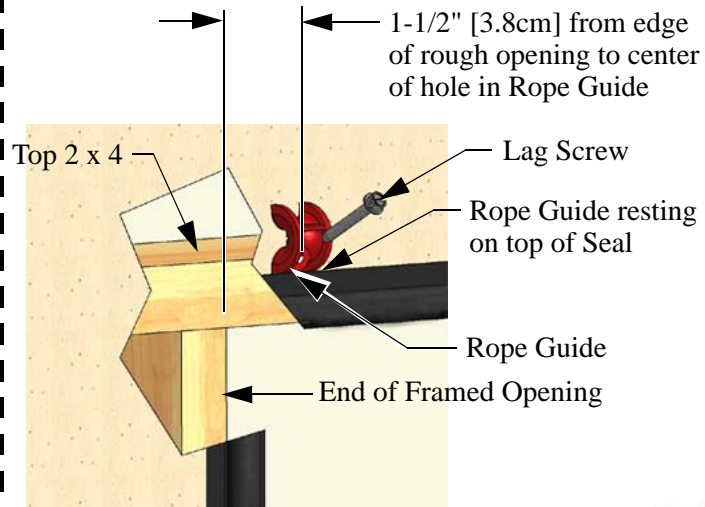

Winch End

At the End of the Doors Angle the 1/4 x 1-3/4" Lag Screw down into the Top 2x4.

1/4" [6.4mm] from Rough Opening to center of hole in Rope Guide.

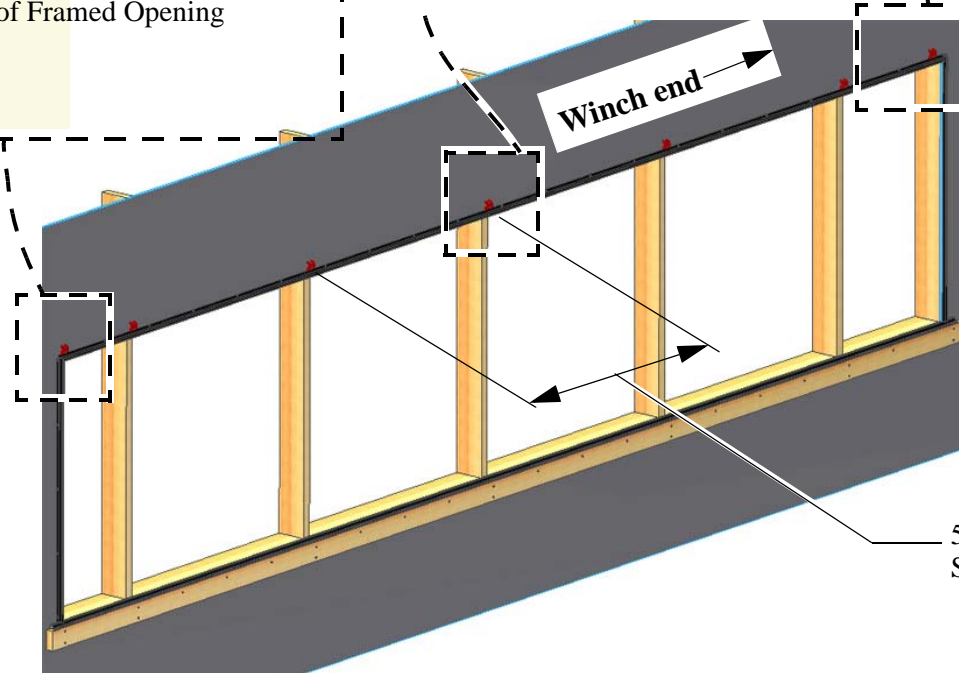
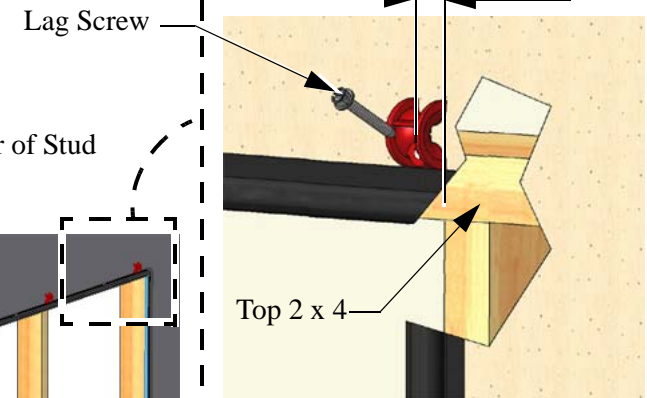

Door Installation

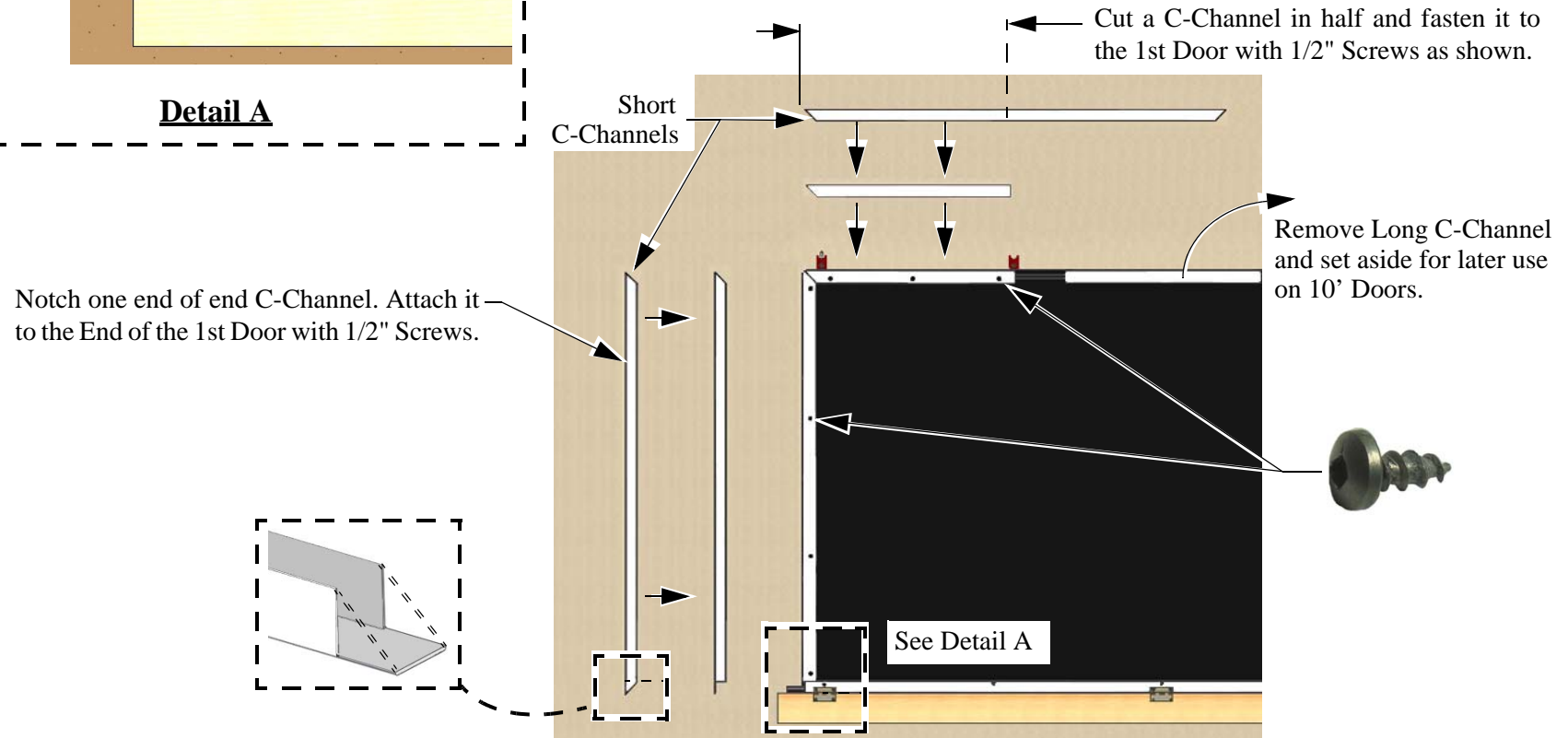
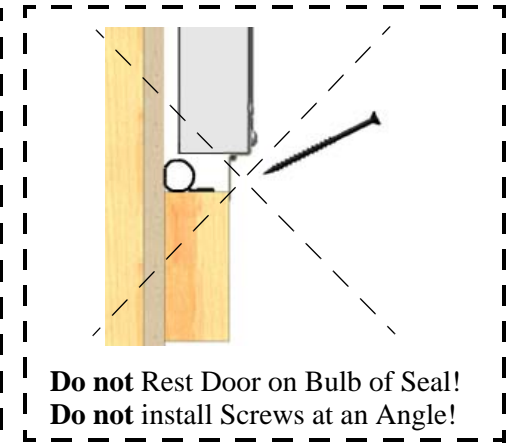
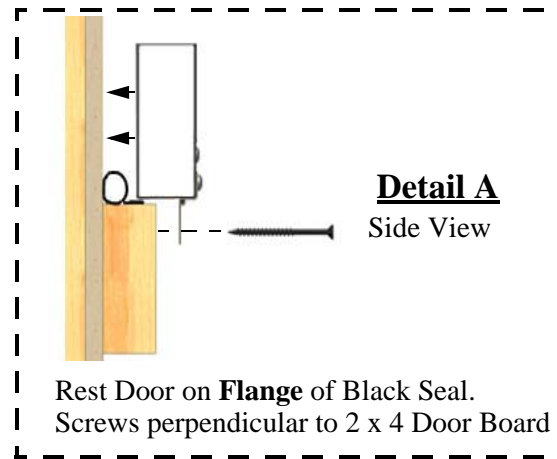
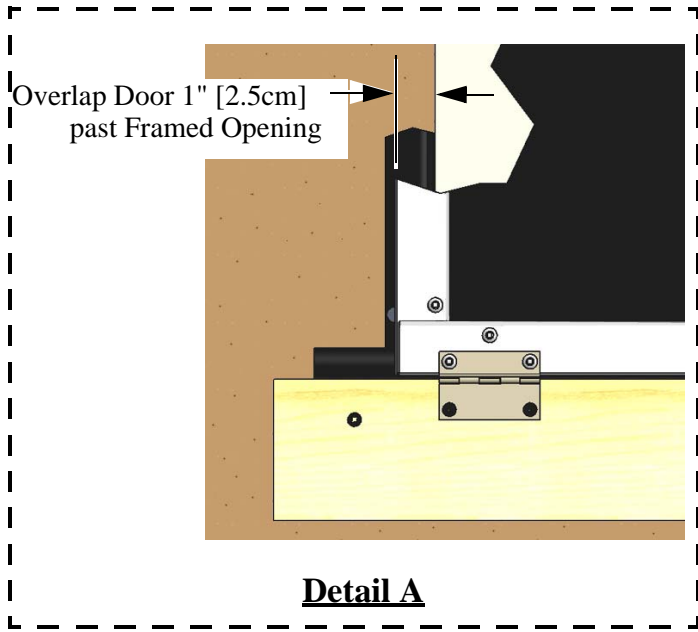

Adding Door Sections

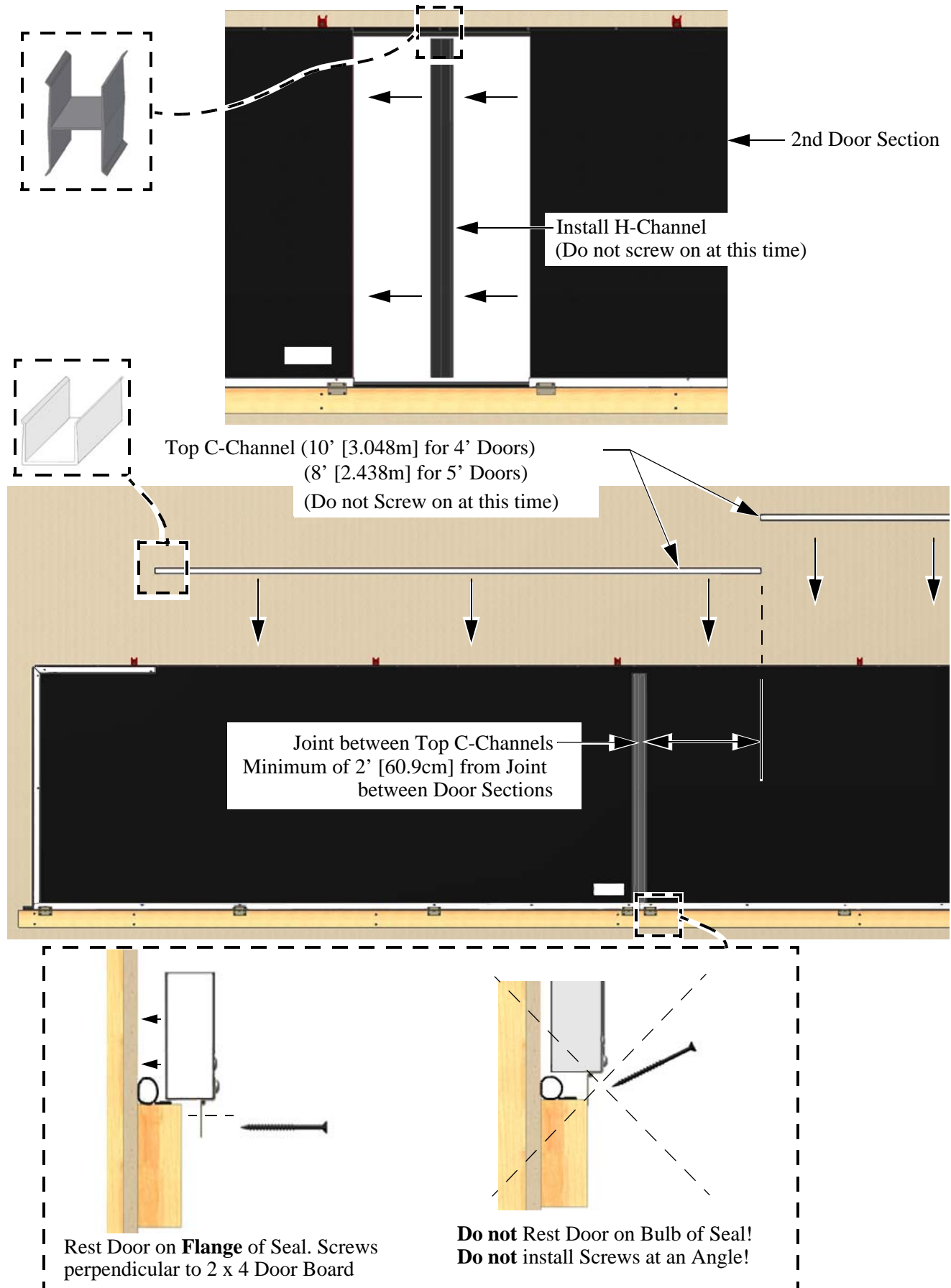

Installation of Split Bolts for Rope/Cable Attachments

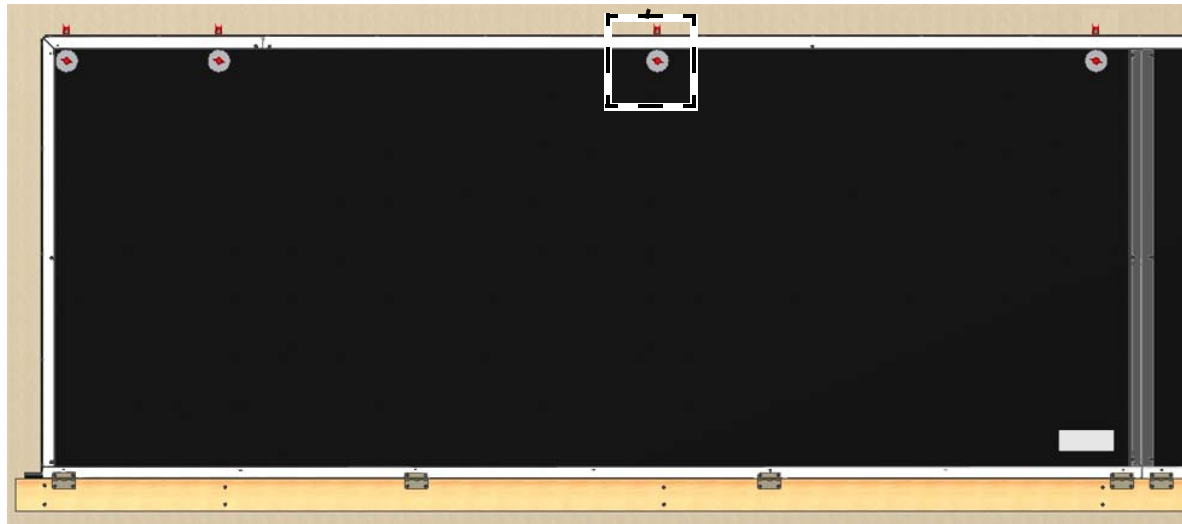
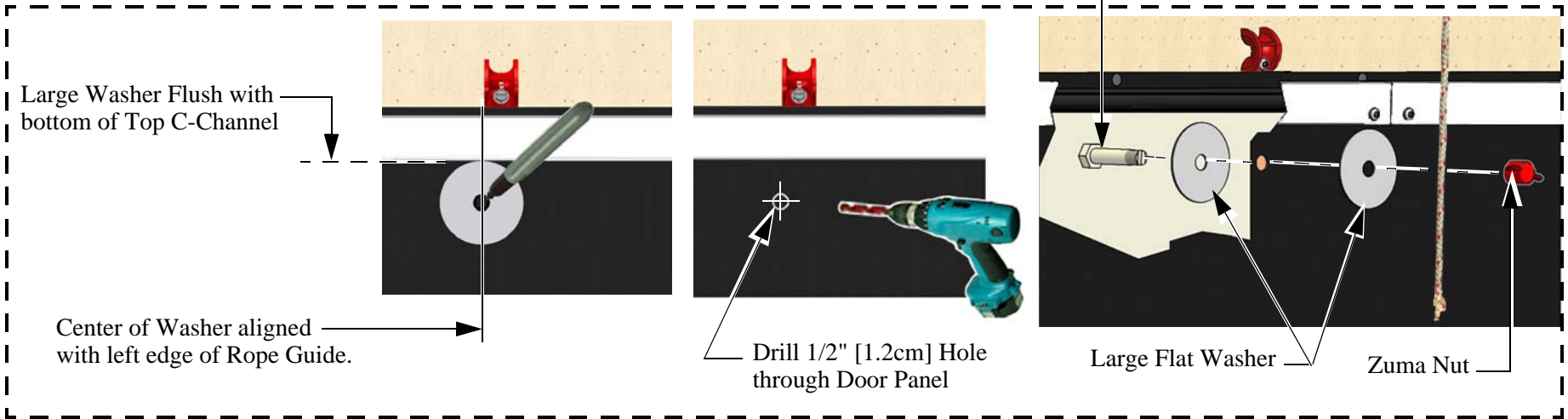

Cut Rope to length...

4' Doors= 60" [1.524m] of Rope

5' Doors= 72" [1.829m] of Rope

Tie off Doors at least every 30' [9.144m] while assembly is in process.

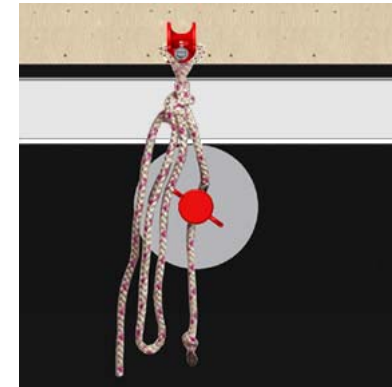

Cable Tensioner and Cable Installation (Cable Version Only)

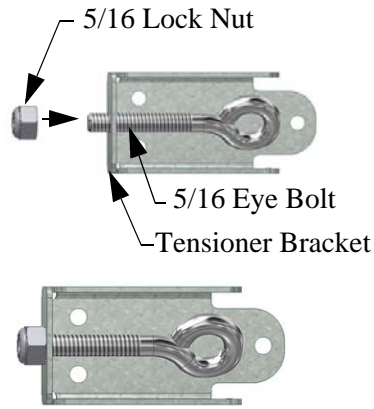

Tighten Nut flush
with end of Eye Bolt

Step 1

Door Ends

Notch in Tensioner
lined up with edge of
Rope Guide. Top
of Tensioner Flush
with Top of Top
Channel.

(2x) #10 x 1/2" Screw

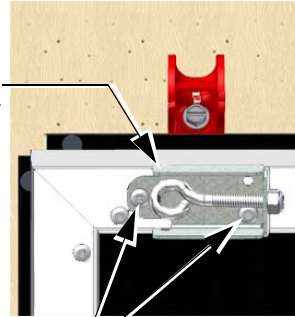

Step 2

Use a Cable Clamp every
30' [9.144m] to hold up the Doors
during assembly.

Thread the SS Cable through
the notches in the Tensioner,
through the Eye Bolt, and
through the Rope Guide.

(2x) #10 x 1/2" Screw

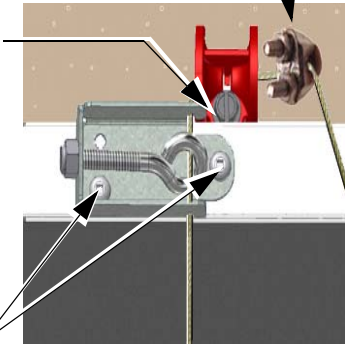

Step 4

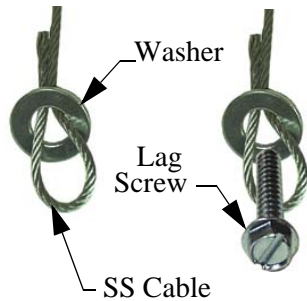

Attach a Cable to the 2 x 4 Door Support with a
Lag Screw as shown directly below the notch
in each Rope Guide. SS Cable Length as follows:
4' Doors = 9' [2.743m] SS Cable
5' Doors = 10' [3.048m] SS Cable

Step 3

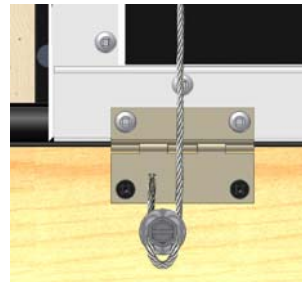

Winch End →

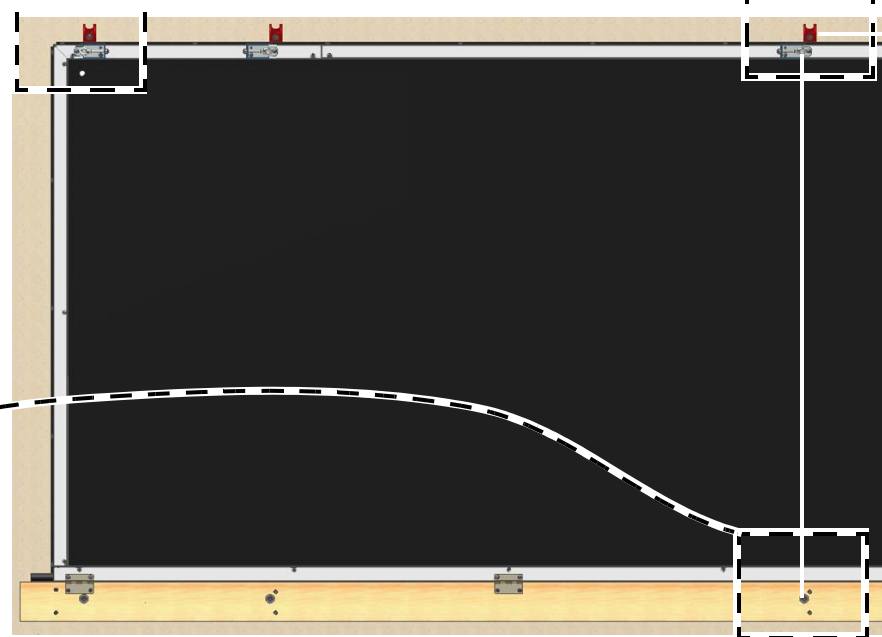

Installing Remaining Door Sections

Step 1. Cut the last Door and Bottom C-Channel off 1" [2.5cm] past the Black Seal Bulb. Remove the last Hinge and Re-attach it as shown if necessary.

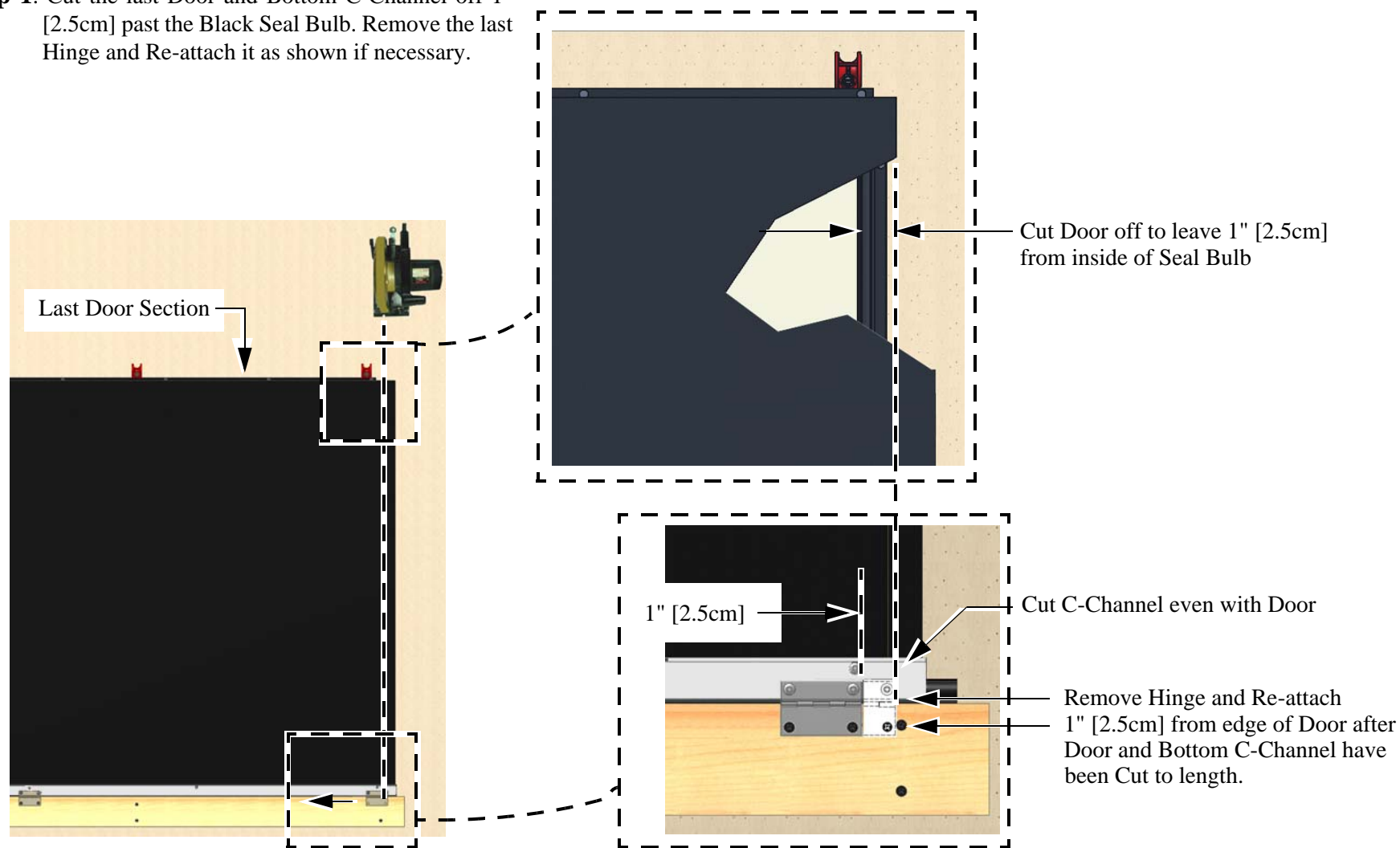

Figure 10. Installing last Door Section

Last Door Section (Continued)

Step 2. Attach all of the Top C-Channels and H-Channels with 1/2" Screws **as shown**.

Step 3. Miter and Attach the last Top C-Channel with 1/2" Screws.

Step 4. Notch the end, and attach it to the end of the last Door with 1/2" Screws

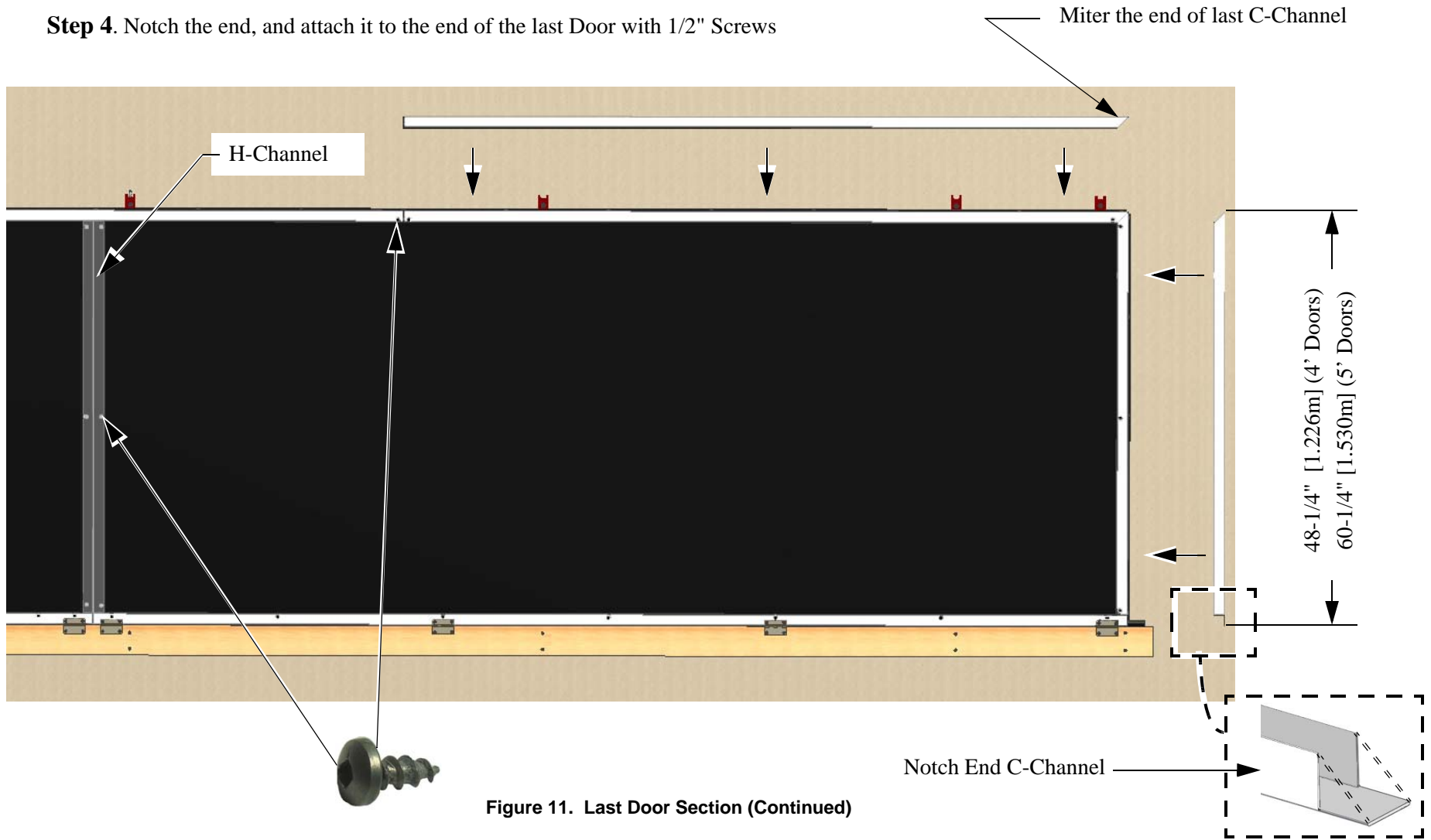
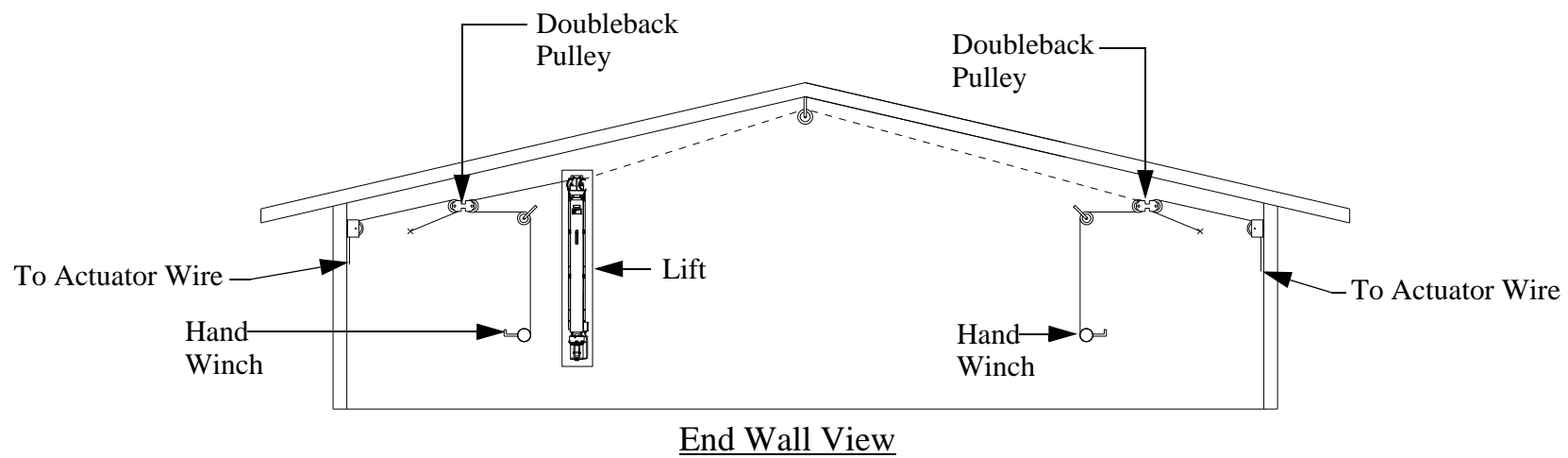
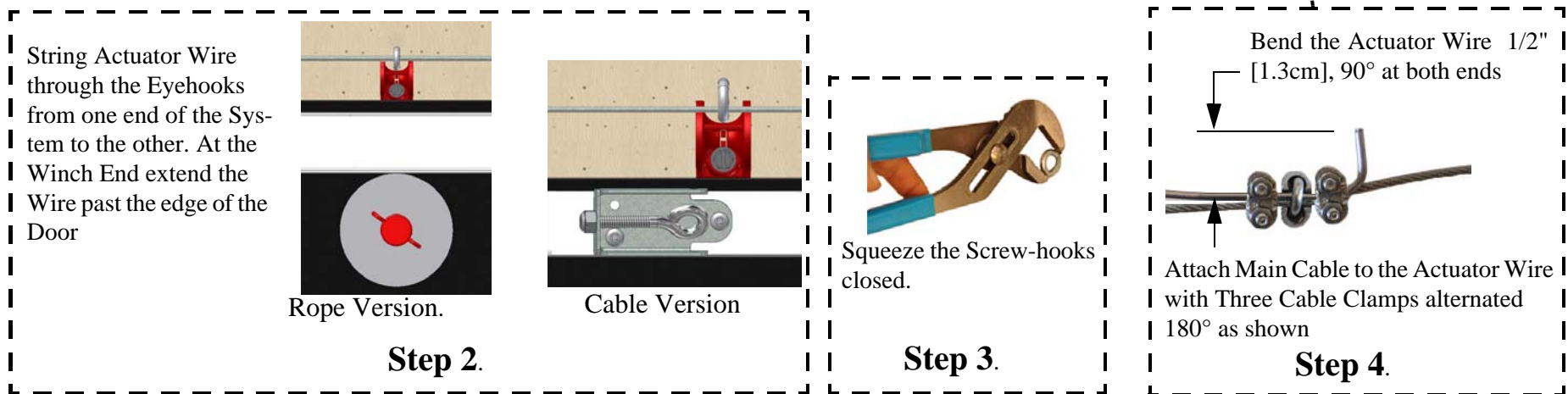
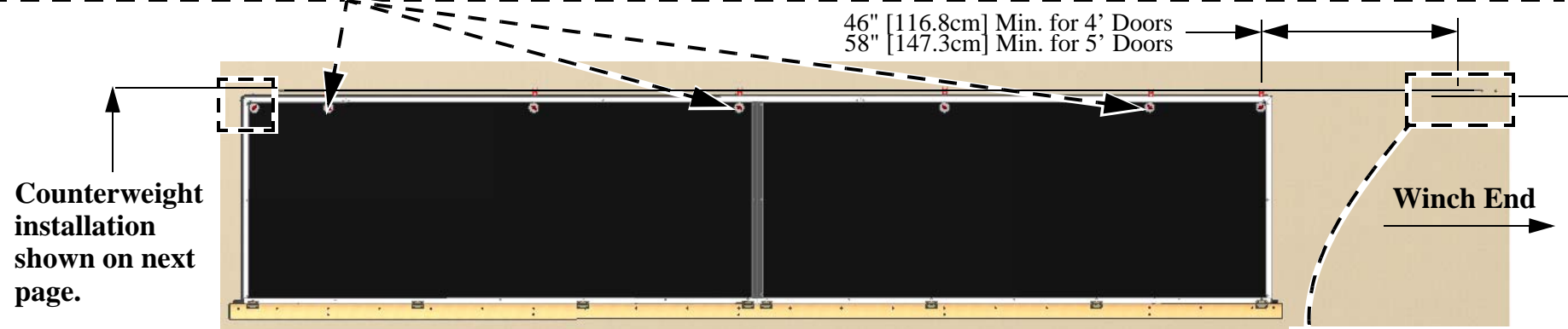
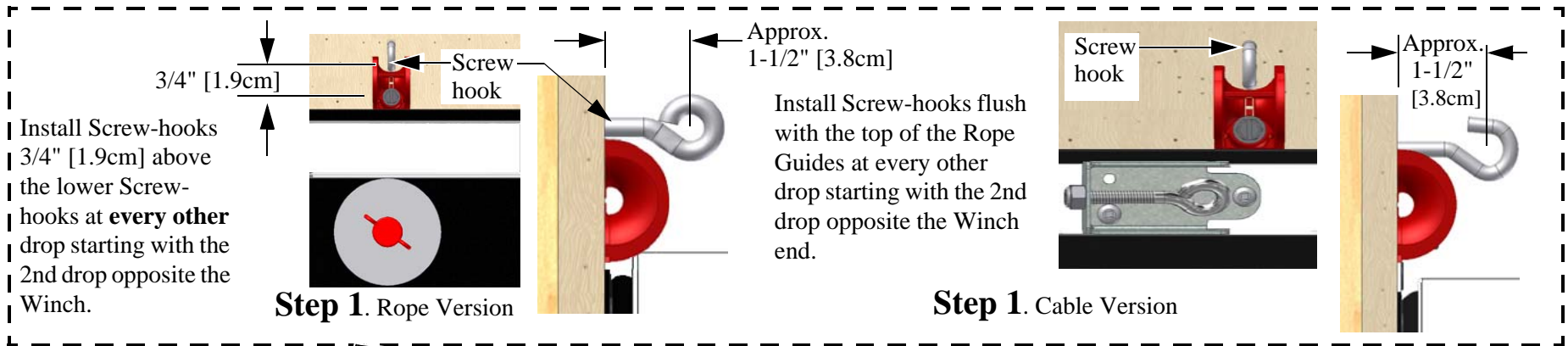

Figure 11. Last Door Section (Continued)

Winch Installation



Door Suspension Installation



Installing Counter Weight

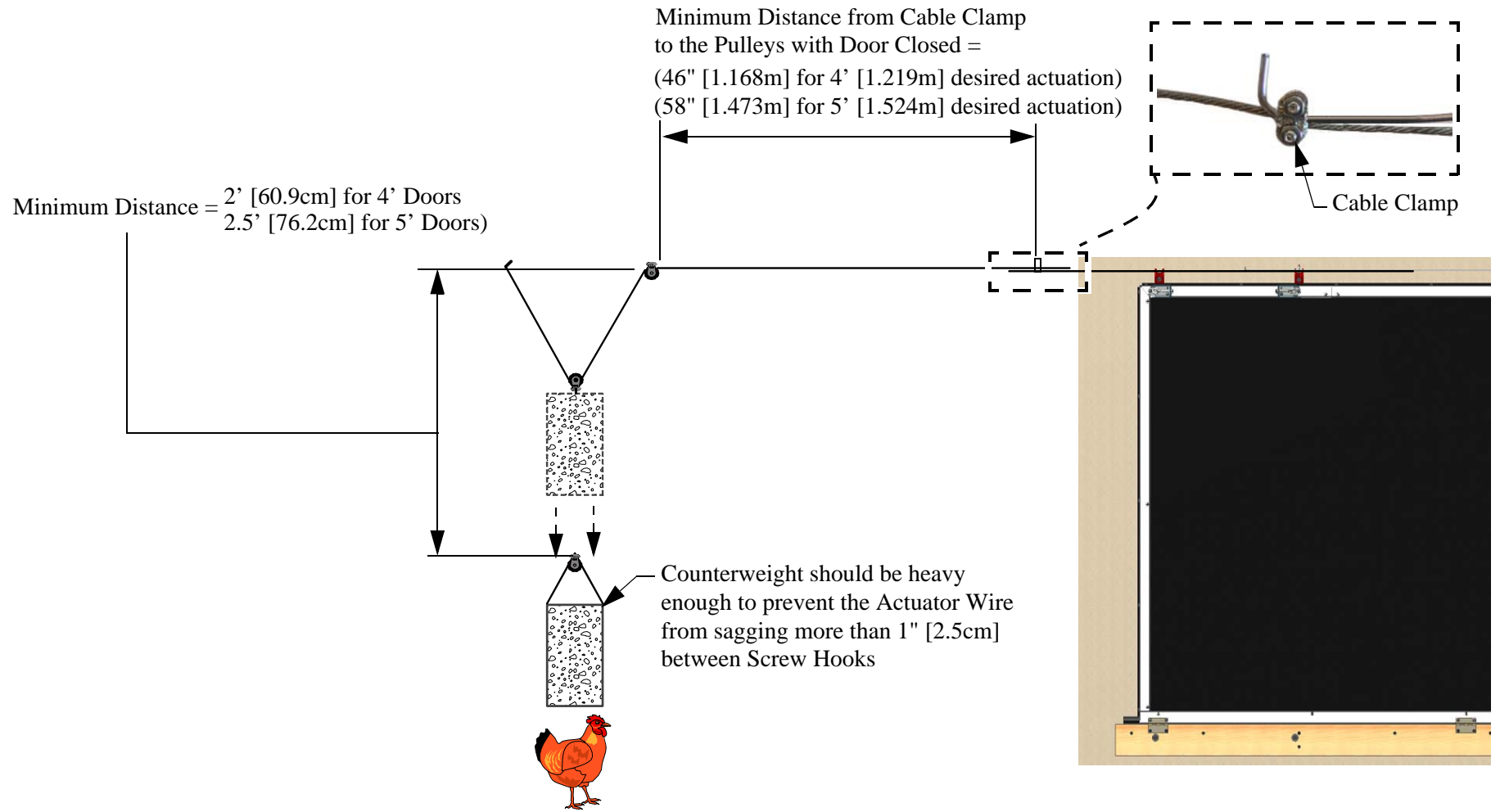

Rope Attachment

Step 1. Use the Hand Winch to pre-stretch the Main Cable before installing Rope drops.

Step 2. Run Lift to the fully closed position.

Lift in Closed Position
(Brass Nut toward Motor)

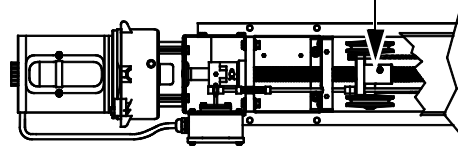

Minimum = 44" [1.118m] for 4' doors
56" [1.422m] for 5' doors

Step 3. Attach Ropes to Door Wire with a Cable Clamp. The Minimum distance between the Cable Clamp and the next Eyehook is the desired Door opening distance.

Feed Rope through skipped Rope Guides

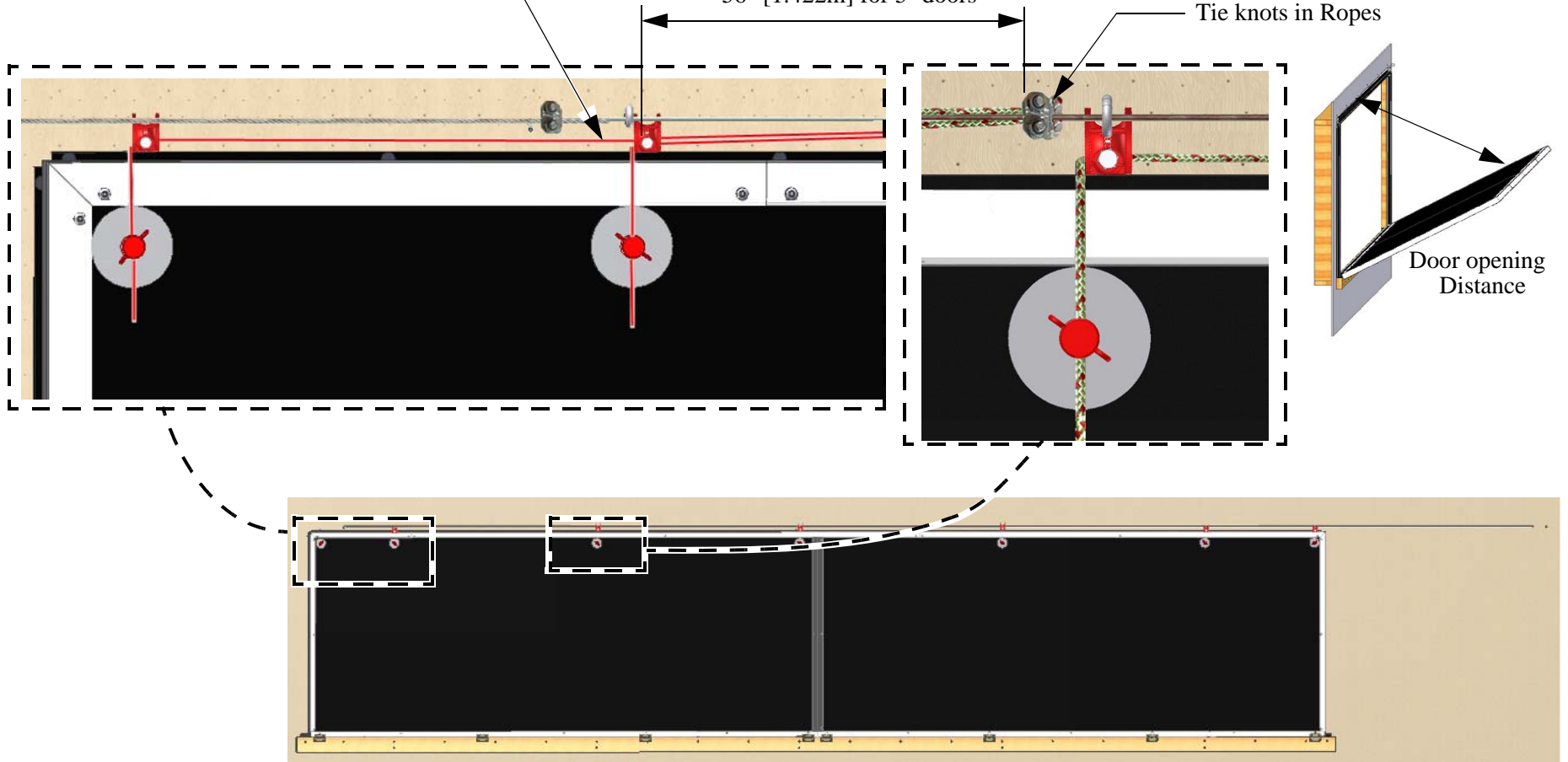

Cable Attachment

Step 1. Use the Hand Winch to pre-stretch the Main Cable before installing Cable drops.

Step 2. Run Lift to the fully closed position.

Lift in Closed Position
(Brass Nut toward Motor)

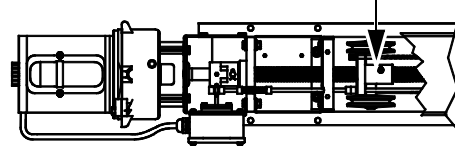

Step 3. Attach Cables to Door Wire with a Cable Clamp. The Minimum distance between the Cable Clamp and the next Eyehook is the desired Door opening distance.

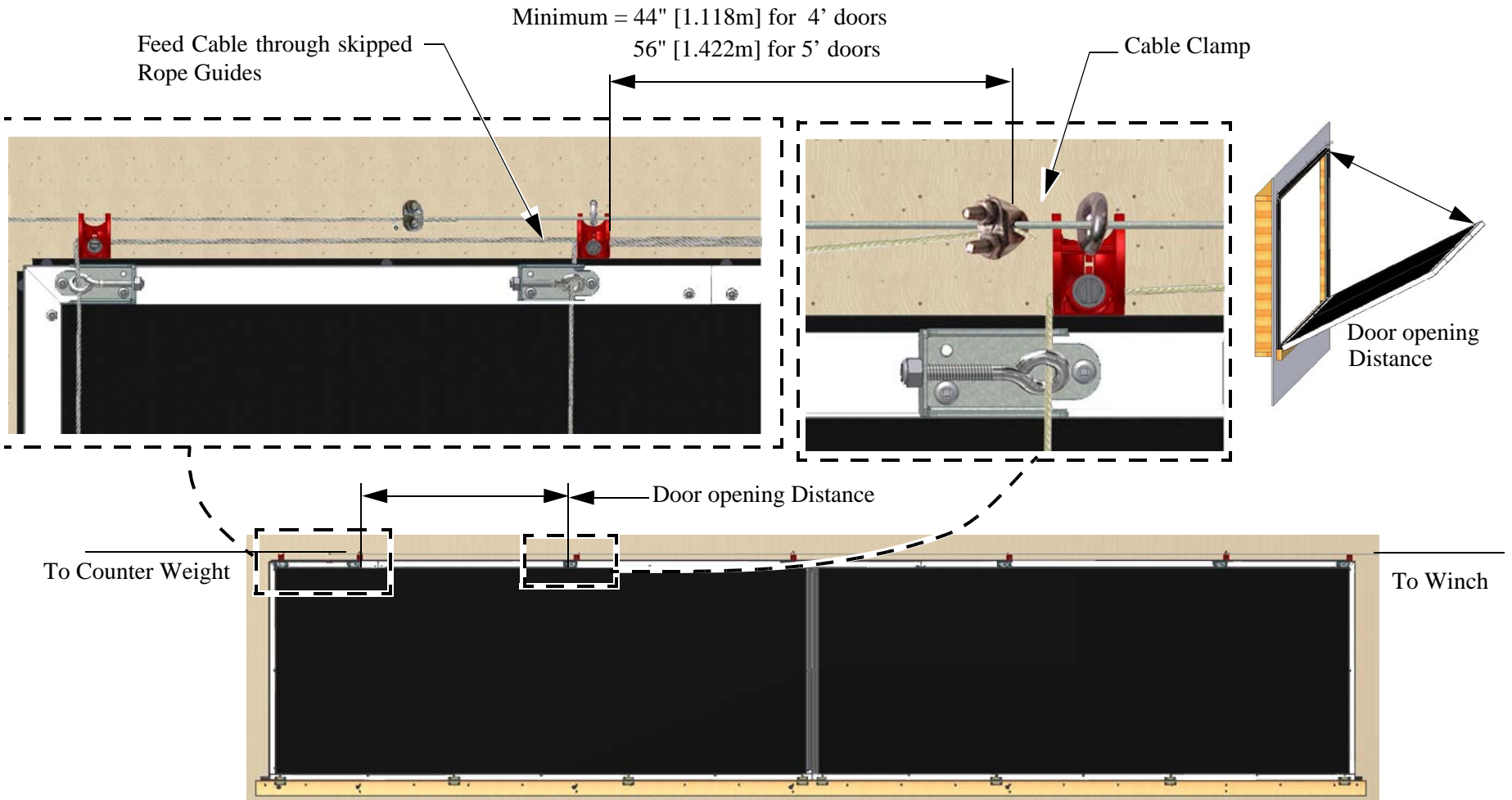

Final Door Adjustment

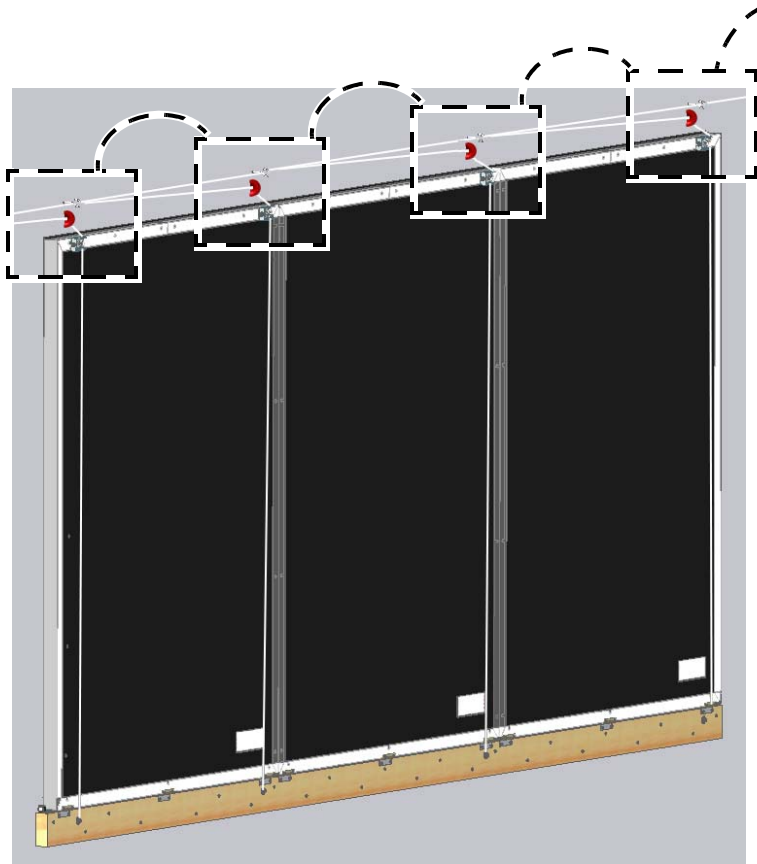

5/16 Nut

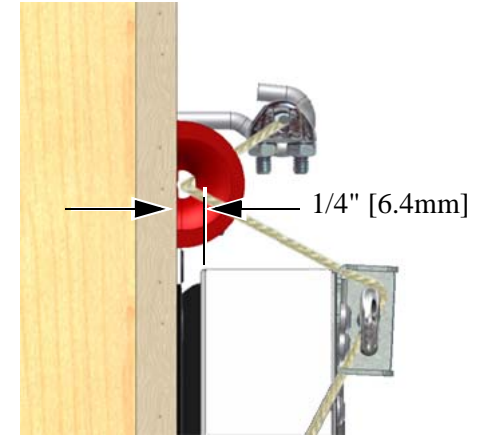
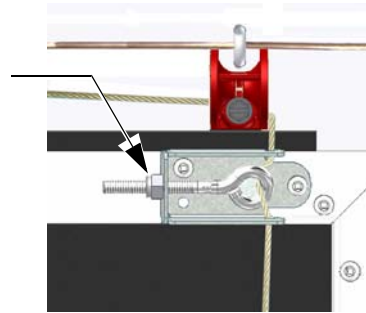

Adjust Cable Tension at each Drop-

Tighten the 1/4-20 Nut on the Cable Tensioner at each drop until the gap between the Door and the Black Seal is 1/4" [6.4mm]

Cable Version

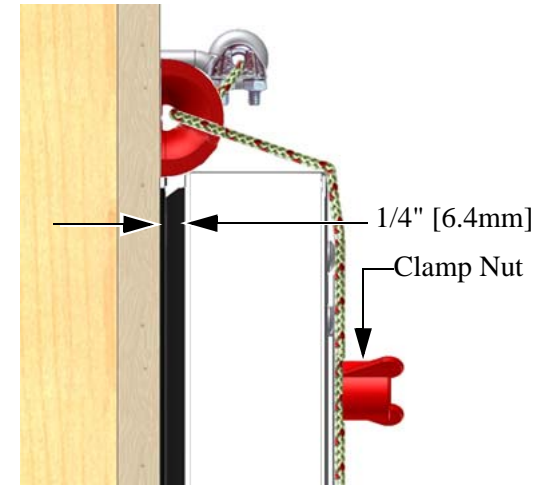
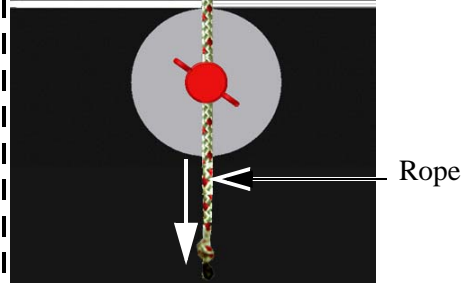
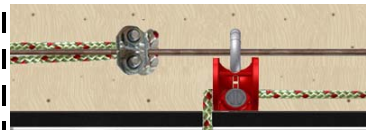

Adjust Rope Tension at each Drop- Loosen the Clamp Nut and pull down on the Rope at each drop until there is a 1/4" [6.4mm] Gap between the Door and the Black Seal.

Rope Version

This Page Left Blank Intentionally....

4' and 5' Tall Door Sections

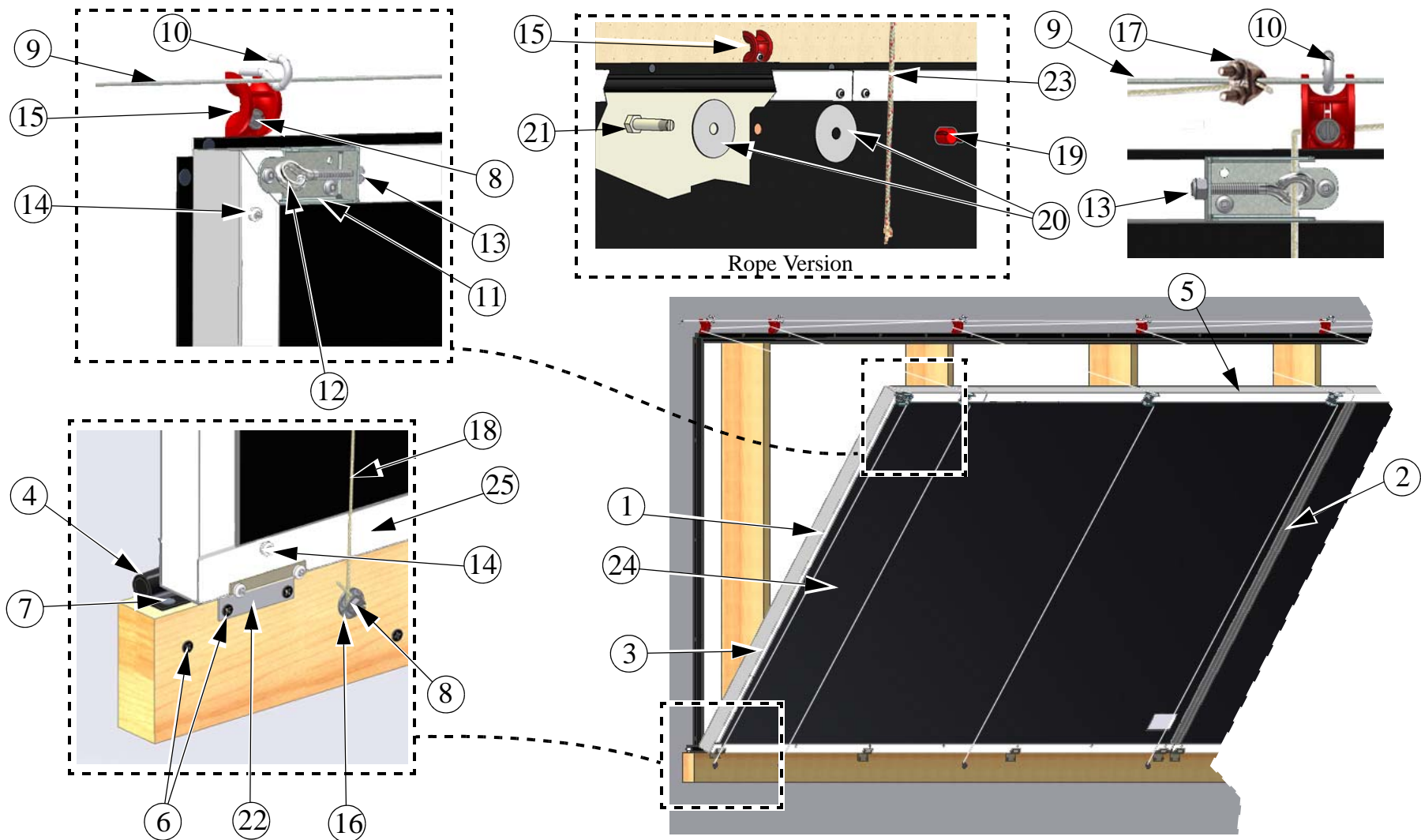
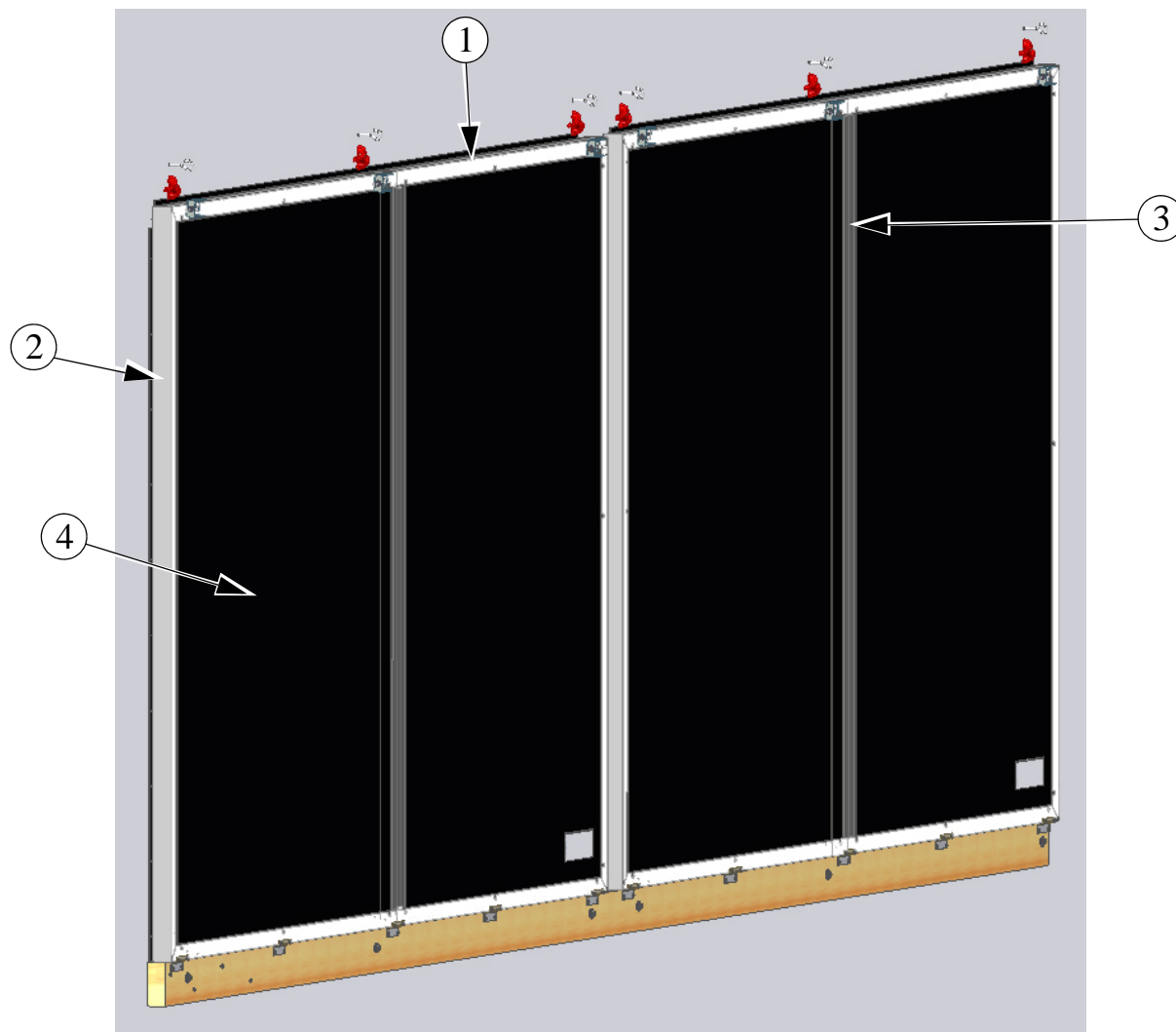

Figure 45. Part Numbers

Part Numbers for 4' and 5' Tall Door Sections

		Models				Models	
		4' Door	5' Door			4' Door	5' Door
Item	Description	Part No.	Part No.	Item	Description	Part No.	Part No.
1	48" Tall x 120" Blk Tunnel Door Section	51345 ⁵	--	14	#10 x 1/2" Sq. Drive Panhead Screw	52102 ²	52102 ²
	60" Tall x 48" Blk Tunnel Door Section	--	51528 ⁶	15	Rope Guide	51173 ²	51173 ²
2	45.63" Blk. H-Channel (Sq. ends)	51153-7	--	16	.406 x .812 x .065 Washer	4967	4967
	57.63" Blk. H-Channel (Sq. ends)	--	51153-8	17	.125 Cable Clamp	14898	14898
3	48.32" Wht. C-Channel 45° Ends ⁷	52591-1	--	18	3/32-7x19 Aircraft Cable	28394	28394
	60.32" Wht. C-Channel 45° Ends ⁷	--	52591-2	19	Split Bolt Cap	40788	40788
4	1" Black Bulb Seal	52589-200 ¹	52589-200 ¹	20	Large Washer for Split Bolt	50234	50234
5	96.55 C-Channel (w/ Sq. Ends) ⁷	--	52591-9	21	Split Bolt	50236	50236
6	#9-9x3 Quadrex Drive Wood Screw	50241 ²	50241 ²	22	1.5 x 2.5 SS Hinge	51917	51917
7	2D x 1 11 Gauge Roofing Nail	50239 ²	50239 ²	23	Rope	5-37173 ⁴	5-37173 ⁴
8	1/4 x #10 x 1.75 Lag Screw	51039	51039	Available Replacement Panels			
9	Actuator Wire (500')	46059-500 ³	46059-500 ³	24	1.5 x 48 x 120 Blk FRP Panel	51344	
10	Screw Hook	1214	1214		1.5 x 48 x 60 Blk FRP Panel		51344-6
11	Cable Tensioner Bracket	51489	51489	25	48.55 C-Channel (White. w/ Sq. Ends)	--	52591-7
12	5/16 x 3.25" Eyebolt	30663	30663		120.55 C-Channel (White. w/ Sq. Ends)	52591-10	
13	.31x 18 (Nyl. Insert) Nut	ST99074	ST99074	¹ Packaged in boxes of 200' ² Must be ordered in increments of 100 pieces ³ 46059-500 is a 500' roll. ⁴ Rope must be ordered in increments of 1000' 5-37173-1000 ⁵ Section includes 51344 Panel with 52591-10 Top and Bottom C-Channels and 51917 Hinges assembled ⁶ Section includes 51344-6 Panel with 52591-7 Bottom C-Channel and 51917 Hinges assembled ⁷ Was Black C-Channel from 1-25-08 to 9-2-09. Replacement Black 10' C-Channel Part No. 51152-10.			

Part Numbers for Individual Door Assemblies



Item	Description	Size, Assembly Part No. and Component Part Numbers					
		4' x 48"	4' x 93"	4' x 115"	5' x 48"	5' x 93"	5' x 115" Door
1	White Top and Bottom C-Channel (45° ends) ¹	51664	51665	51666	51868	51869	51870
2	White Side C-Channel (45° ends) ¹	52591-1	52591-1	52591-1	52591-2	52591-2	52591-2
3	H-Channel	--	--	--	--	51153-8	51153-8
Available Replacement Panel Sizes		Part No.					
4	Panel, 1.5" x 48" x 60" Black FRP	51344-6					
	Panel, 1.5" x 48" x 96" Black FRP	51344-8					
	Panel, 1.5" x 48" x 120" Black FRP	51344					

¹Was Black C-Channel from 1-25-08 to 9-2-09. Replacement Black 10' C-Channel Part No. 51152-10.

This Page Left Blank for Notes.....



Note: The original, authoritative version of this manual is the [English] version produced by CTB, Inc. or any of its subsidiaries or divisions, (hereafter collectively referred to as "CTB"). Subsequent changes to any manual made by any third party have not been reviewed nor authenticated by CTB. Such changes may include, but are not limited to, translation into languages other than [English], and additions to or deletions from the original content. CTB disclaims responsibility for any and all damages, injuries, warranty claims and/or any other claims associated with such changes, inasmuch as such changes result in content that is different from the authoritative CTB-published [English] version of the manual. For current product installation and operation information, please contact the customer service and/or technical service departments of the appropriate CTB subsidiary or division. Should you observe any questionable content in any manual, please notify CTB immediately in writing to: CTB Legal Department, P.O. Box 2000, Milford, IN 46542-2000 USA.

Revisions to this Manual

Page No.	Description of Change
22	Removed "Black" from the description on Item 5.
Various	Added Blank Pages so Parts Pages are adjacent to one another.
Various	Added Metric Dimensions

Contact your nearby Chore-Time distributor or representative for additional parts and information.

CTB Inc.
P.O. Box 2000 • Milford, Indiana 46542-2000 • U.S.A.
Phone (574) 658-4101 • Fax (877) 730-8825
E-Mail: ctb@ctbinc.com • Internet: <http://www.ctbinc.com>

Printed in the U.S.A.