

Tunnel Door (Black)

Installation Instruction Manual

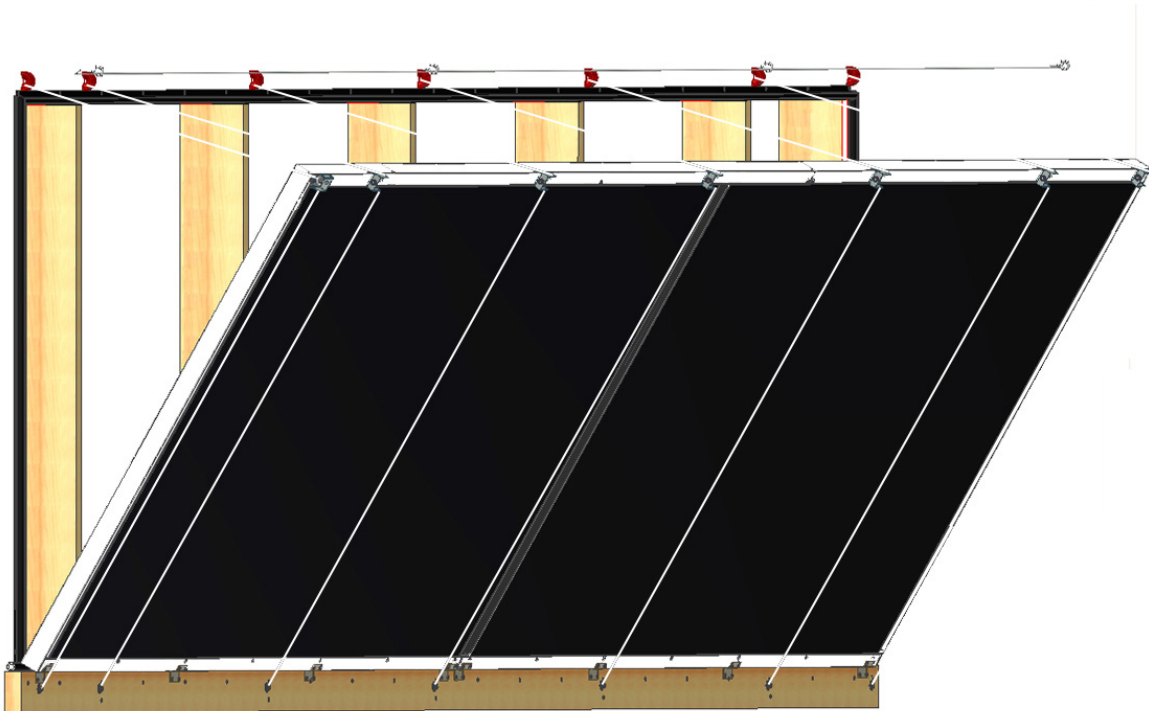

Limited Warranty

Chore-Time Group, a division of CTB, Inc. ("Chore-Time") warrants new CHORE-TIME equipment manufactured by Chore-Time to be free from defects in material or workmanship under normal usage and conditions, for One (1) year from the date of installation by the original purchaser ("Warranty"). If such a defect is determined by Chore-Time to exist within the applicable period, Chore-Time will, at its option, (a) repair the Product or Component Part free of charge, F.O.B. the factory of manufacture or (b) replace the Product or Component Part free of charge, F.O.B. the factory of manufacture. This Warranty is not transferable, and applies only to the original purchaser of the Product.

CONDITIONS AND LIMITATIONS

THIS WARRANTY CONSTITUTES CHORE-TIME'S ENTIRE AND SOLE WARRANTY AND CHORE-TIME EXPRESSLY DISCLAIMS ANY AND ALL OTHER WARRANTIES, INCLUDING, BUT NOT LIMITED TO, EXPRESS AND IMPLIED WARRANTIES, INCLUDING, WITHOUT LIMITATION, WARRANTIES AS TO MERCHANTABILITY OR FITNESS FOR PARTICULAR PURPOSES. CHORE-TIME shall not be liable for any direct, indirect, incidental, consequential or special damages which any purchaser may suffer or claim to suffer as a result of any defect in the Product. Consequential or Special Damages as used herein include, but are not limited to, lost or damaged products or goods, costs of transportation, lost sales, lost orders, lost income, increased overhead, labor and incidental costs, and operational inefficiencies. *Some jurisdictions prohibit limitations on implied warranties and/or the exclusion or limitation of such damages, so these limitations and exclusions may not apply to you. This warranty gives the original purchaser specific legal rights. You may also have other rights based upon your specific jurisdiction.*

Compliance with federal, state and local rules which apply to the location, installation and use of the Product are the responsibility of the original purchaser, and CHORE-TIME shall not be liable for any damages which may result from non-compliance with such rules.

The following circumstances shall render this Warranty void:

- Modifications made to the Product not specifically delineated in the Product manual.
- Product not installed and/or operated in accordance with the instructions published by the CHORE-TIME.
- All components of the Product are not original equipment supplied by CHORE-TIME.
- Product was not purchased from and/or installed by a CHORE-TIME authorized distributor or certified representative.
- Product experienced malfunction or failure resulting from misuse, abuse, mismanagement, negligence, alteration, accident, or lack of proper maintenance, or from lightning strikes, electrical power surges or interruption of electricity.
- Product experienced corrosion, material deterioration and/or equipment malfunction caused by or consistent with the application of chemicals, minerals, sediments or other foreign elements.
- Product was used for any purpose other than for the care of poultry and livestock.

The Warranty and Extended Warranty may only be modified in writing by an officer of CHORE-TIME. CHORE-TIME shall have no obligation or responsibility for any representations or warranties made by or on behalf of any distributor, dealer, agent or certified representative.

Effective: **April, 2014**

Contents

Topic	Page	User
Limited Warranty	2	C,D
General	4	I,C
Support Information	4	
Safety Information	4	I,C
DANGER: Electrical Hazard	4	
Tools Needed	4	I
Installation Planning	5	I
Framed Opening	5	
Installation	6	I
Top and Bottom Chalklines and 2 x 4 Door Support	6	
Seal Installation	7	
Rope Guides	8	
Door Installation	9	
Adding Door Sections	10	
Installation of Split Bolts for Rope/Cable Attachments	11	
Cable Tensioner and Cable Installation (Cable Version Only)	12	
Installing Remaining Door Sections	13	
Last Door Section	14	
Winch Installation	15	
Door Suspension Installation	16	
Installing Counter Weight	17	
Rope Attachment	18	
Cable Attachment	19	
Final Door Adjustment	20	
4' and 5' Tall Door Sections	22	I,C
Part Numbers for 4' and 5' Tall Door Sections	23	I,C
Part Numbers for Individual Door Assemblies	24	I,C

General

Support Information

The Chore-Time Tunnel Door is to be used to control the airflow in a Tunnel Ventilated poultry house. Using this equipment for any other purpose or in a way not within the operating recommendations specified in this manual will void the warranty and may cause personal injury.

This manual is designed to provide comprehensive planning, installation, safety, operation, and parts listing information. The Table of Contents provides a convenient overview of the information in this manual. The Table of Contents also specifies which pages contain information for the sales personnel, installer, and consumer (end user).

Safety Information

Caution, Warning and Danger Decals have been placed on the equipment to warn of potentially dangerous situations. Care should be taken to keep this information intact and easy to read at all times. Replace missing or damaged safety decals immediately.

Using the equipment for purposes other than specified in this manual may cause personal injury and/or damage to the equipment.

DANGER: Electrical Hazard

Disconnect electrical power before inspecting or servicing equipment. Ground all electrical equipment for safety. All electrical wiring must be done by a qualified electrician in accordance with local and national electric codes. Ground all non-current carrying metal parts to guard against electrical shock. With the exception of motor overload protection, electrical disconnects and over current protection are not supplied with the equipment.



Tools Needed

Tape Measurer
Chalkline
Electric Drill
 -Square Driver Bit
 -3/8" Hex Socket
 - Screwhook Driver Bit
 -1/2" [1.3cm] Drill Bit (For Doors with Rope Suspension)
Hammer
Knife
Tin Snips

Installation Planning

Framed Opening

Winch Capacity- approximately 15 lbs/ft [6.8 Kg/30.5cm] of Door length

Wall should be flat within 1/8" per 4' [3.2mm per 1.219m] to ensure a good seal around the Doors

Note: Tunnel Doors should be shaded from direct sun light to avoid damage!

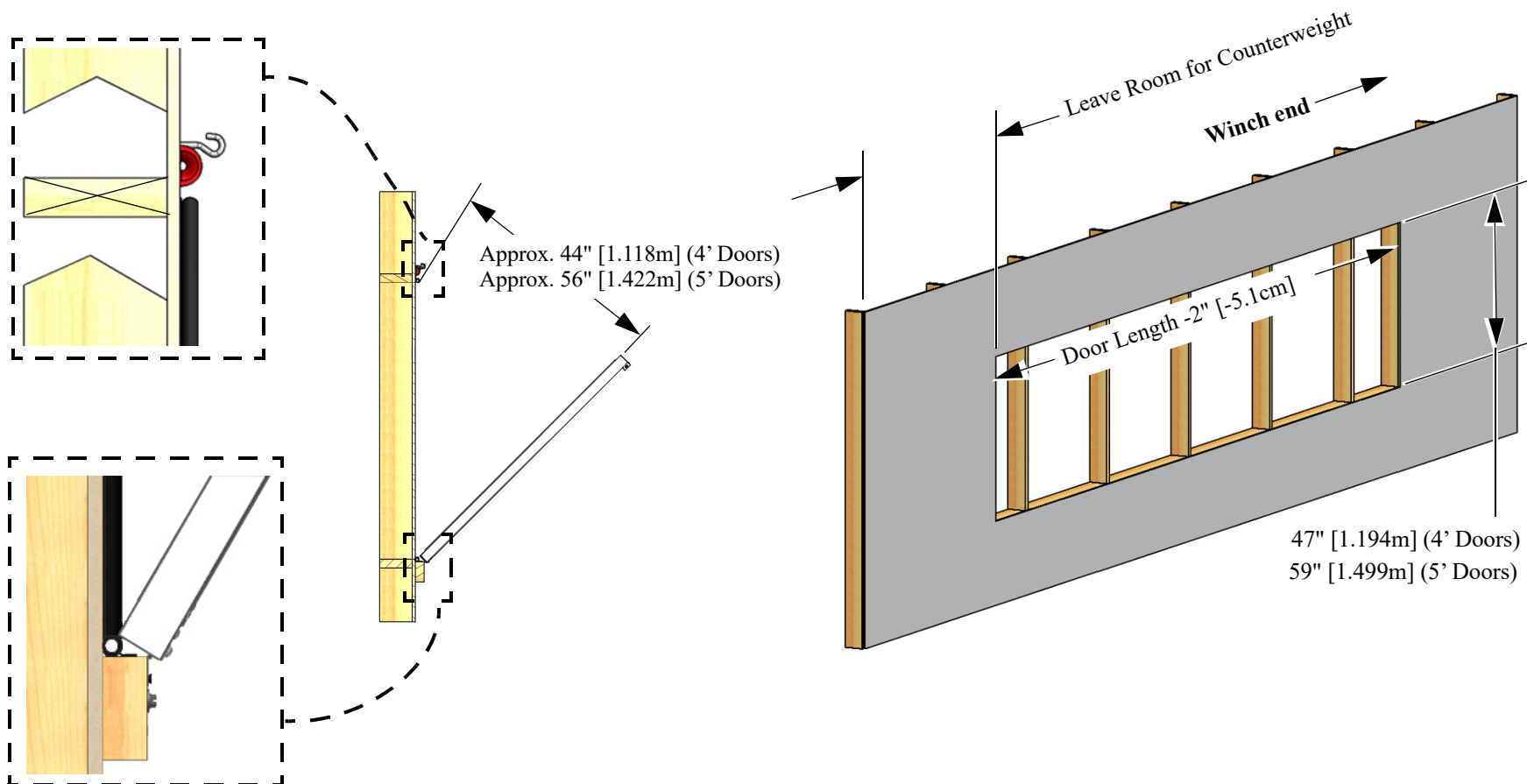

Installation

Top and Bottom Chalklines and 2 x 4 Door Support

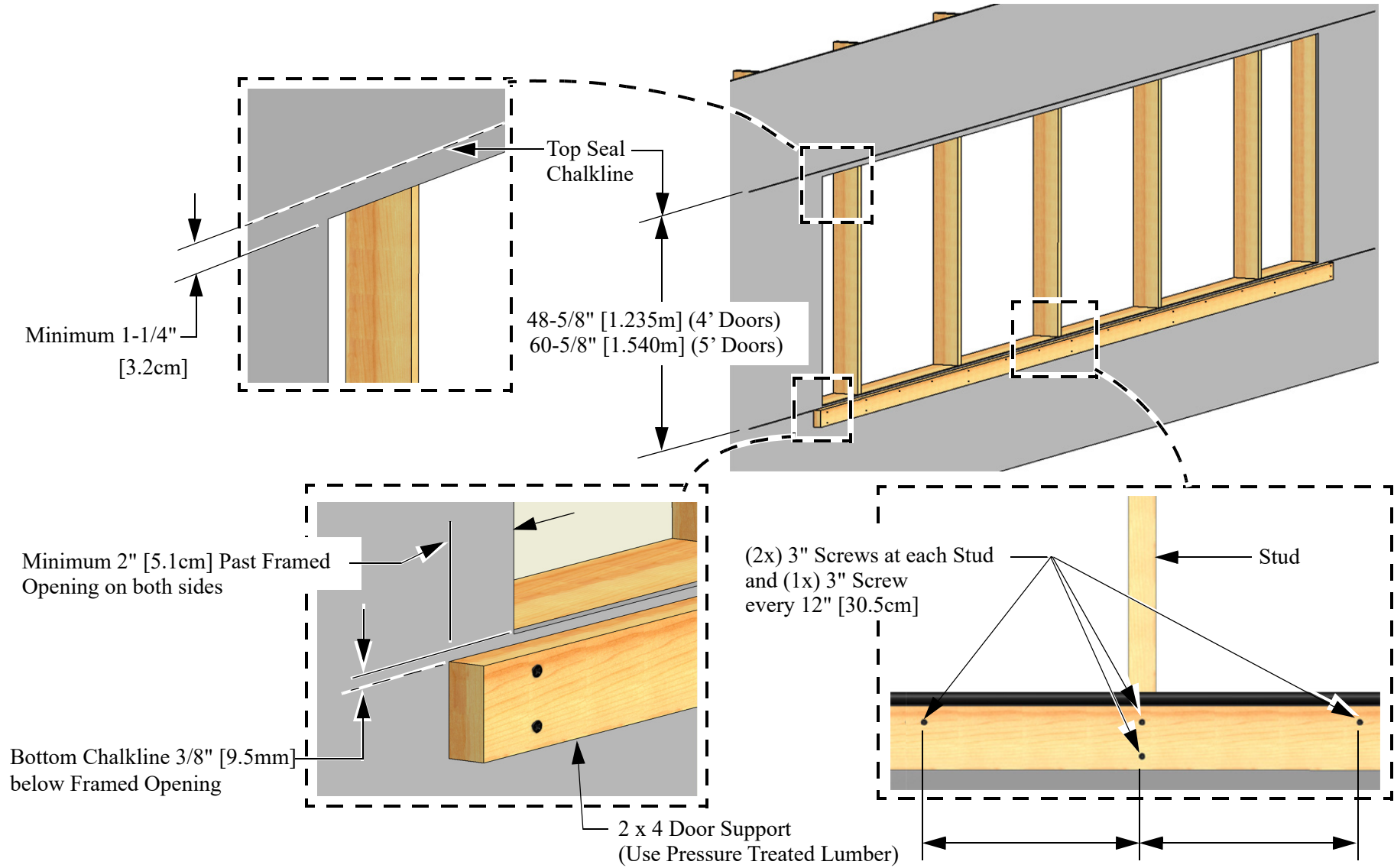

Seal Installation

Step 1. Black Seal- Attach Black Seal across the bottom of the Framed opening with Roofing Nails. Space Nails 12" [30.5cm] apart, except 1" [2.5cm] at the ends (See below).

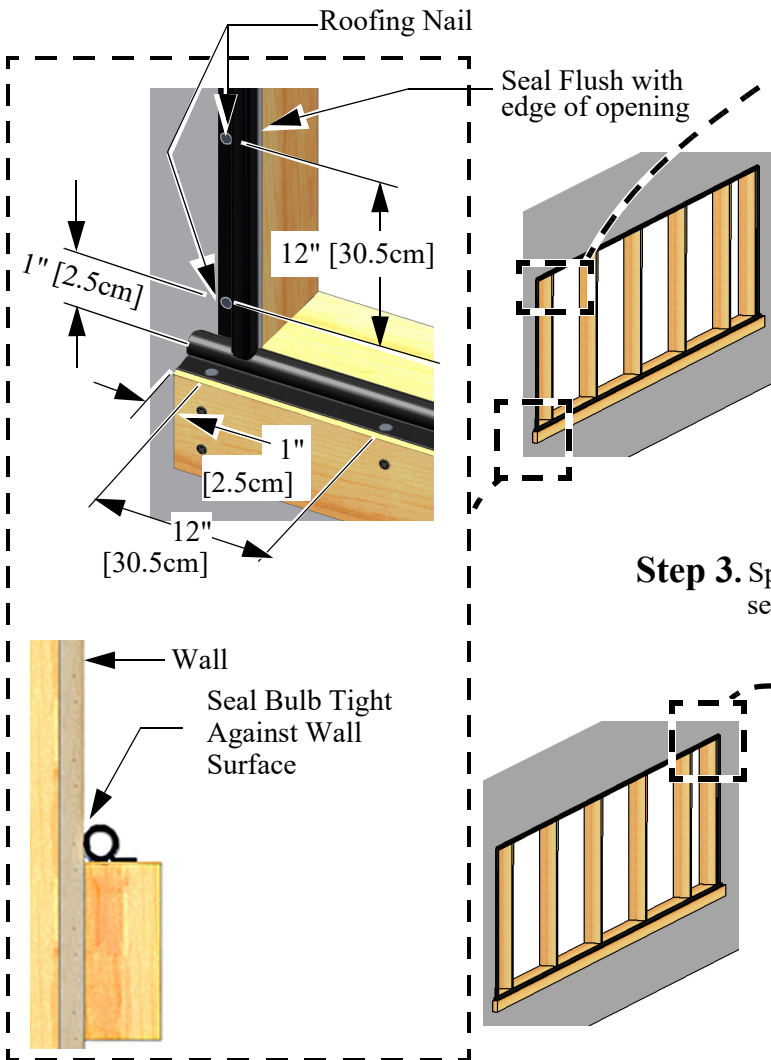

Step 2. Attach one continuous piece of Black Seal to the Sides and Top of the opening. Start attaching seal at a bottom corner of the framed opening with Nails 12" [30.5cm] apart and 1" [2.5cm] at the end. Make a Slit and a Notch in the Seal to allow for bending 90° at the 1st Corner (as shown below).

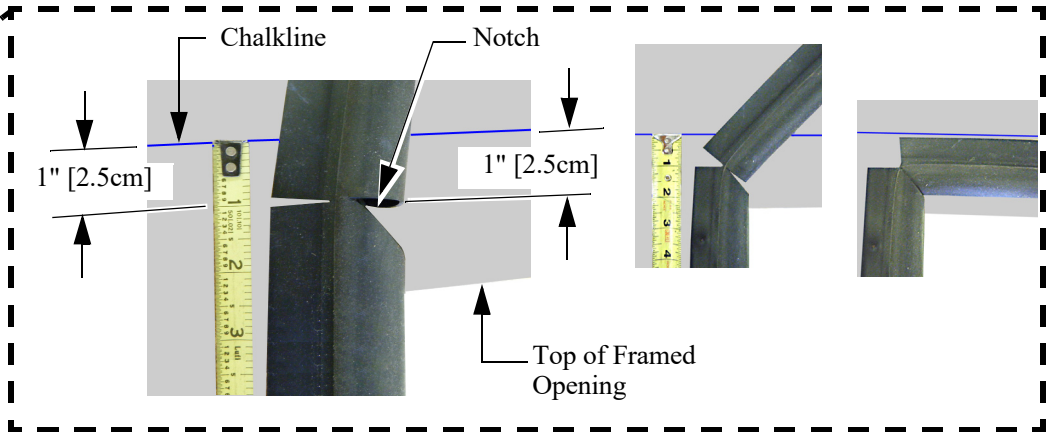

Step 3. Split the Seal 3/4" [1.9cm] past the Framed opening at the second corner as shown below.

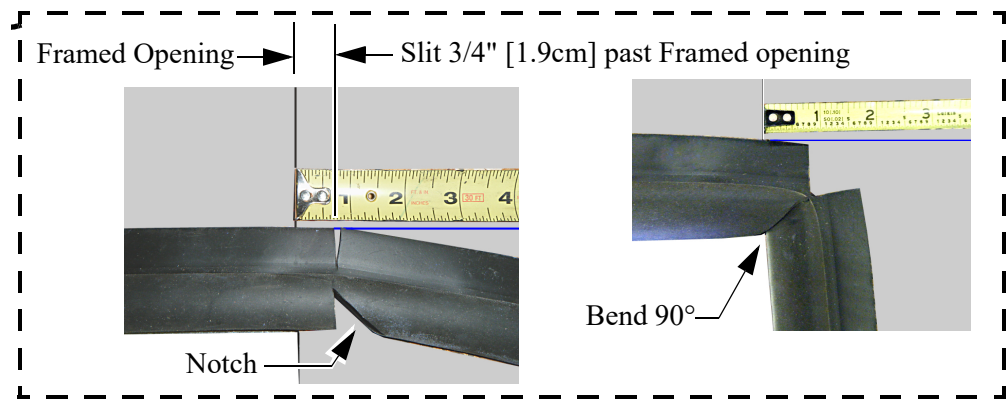

Rope Guides

Counter weight End

At the End of the Doors Angle the 1/4 x 1-3/4 Lag Screw down into the Top 2x4 as shown.

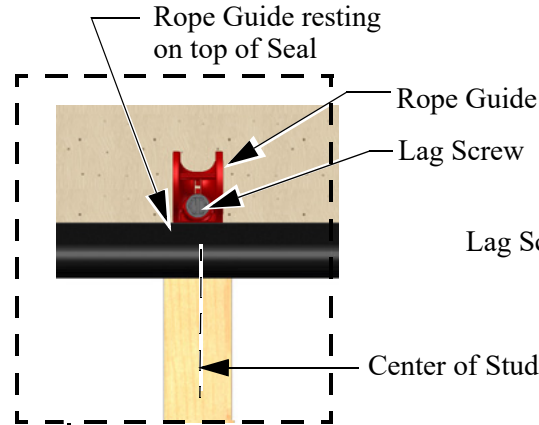
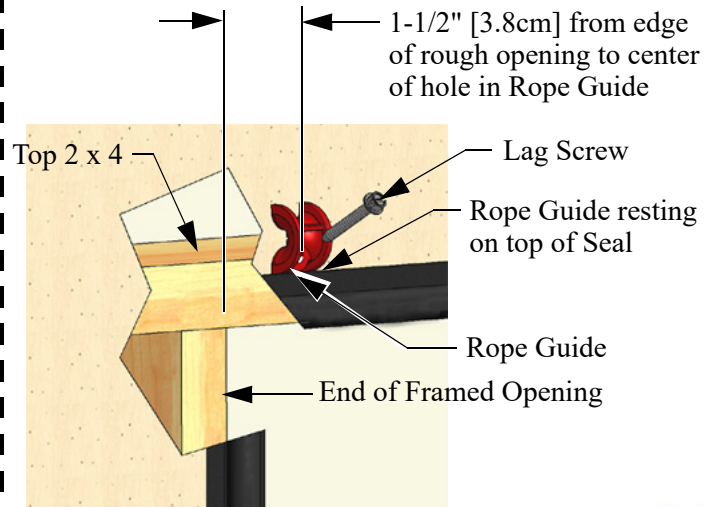

Winch End

At the End of the Doors Angle the 1/4 x 1-3/4" Lag Screw down into the Top 2x4.

1/4" [6.4mm] from Rough Opening to center of hole in Rope Guide.

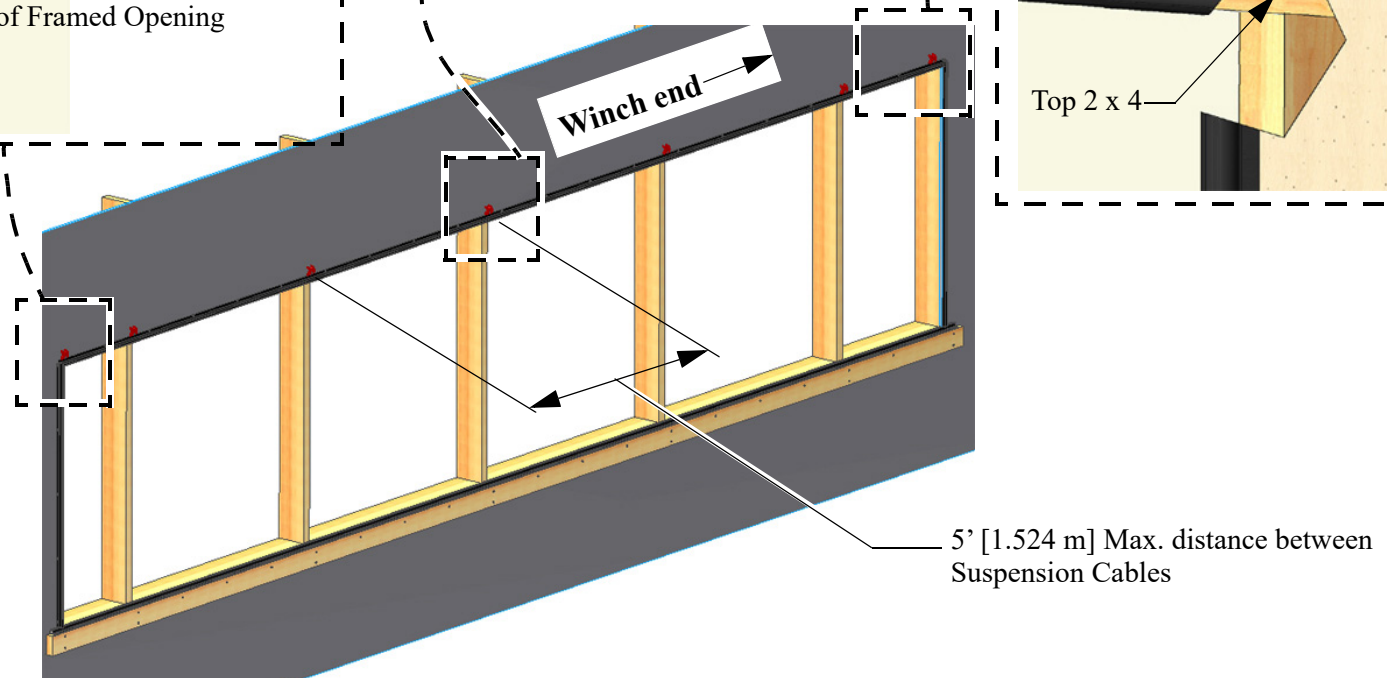
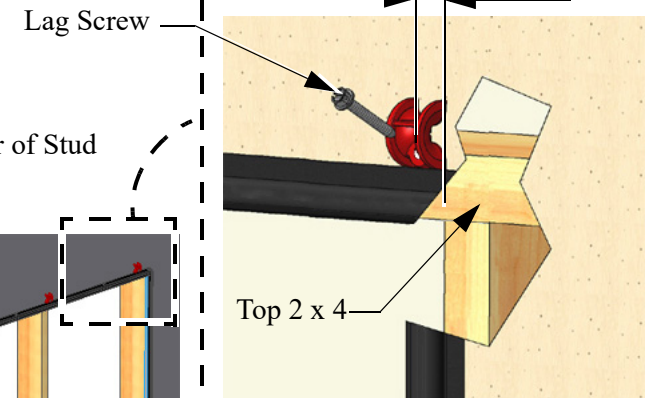

Door Installation

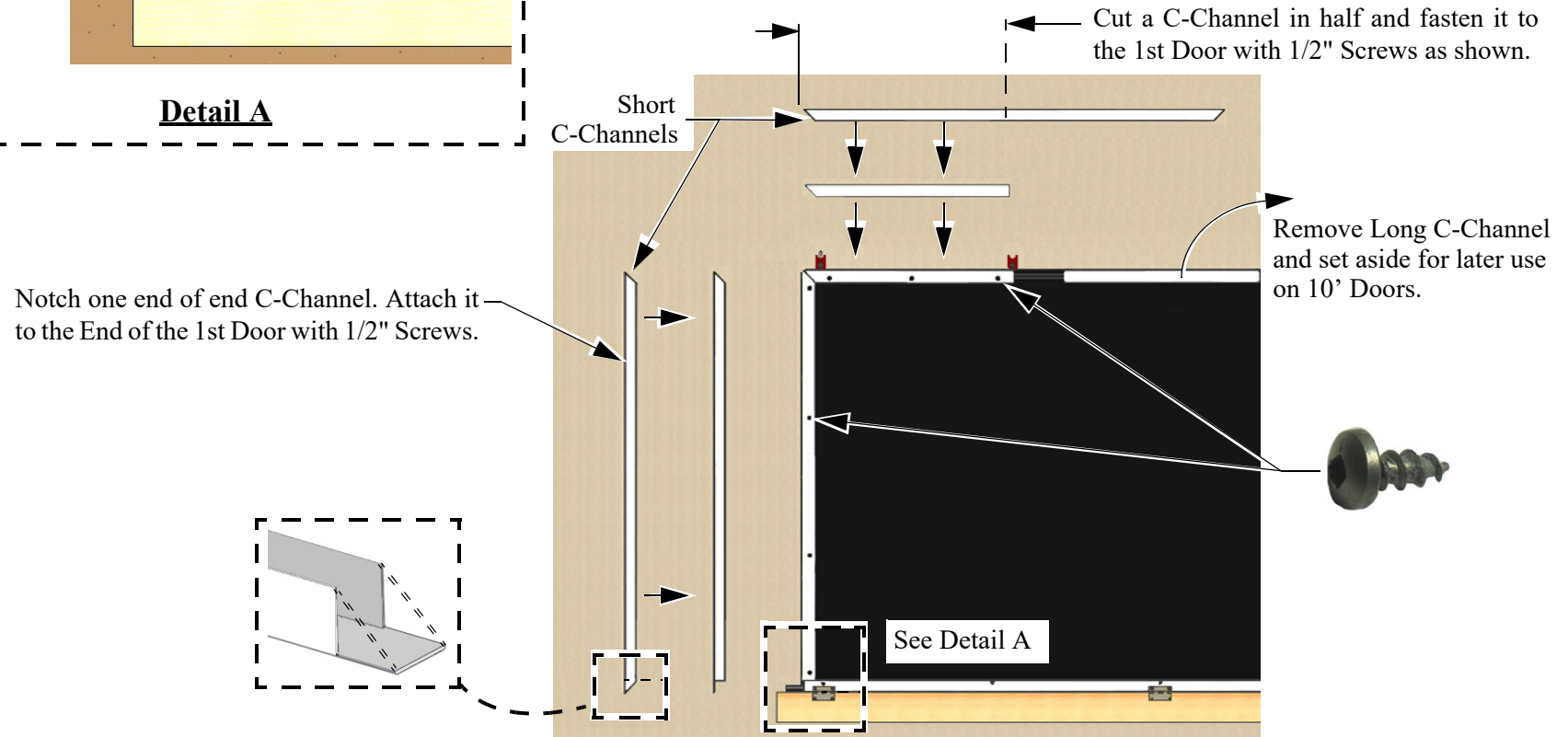
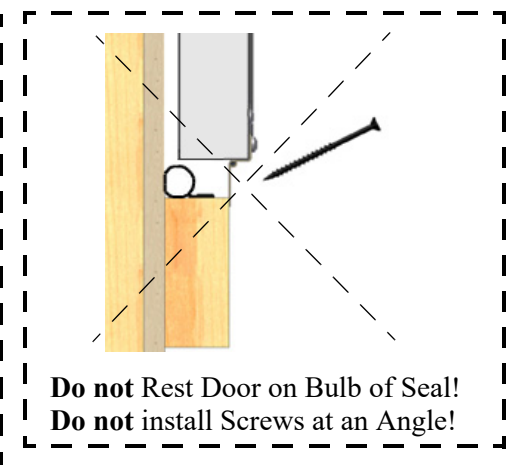
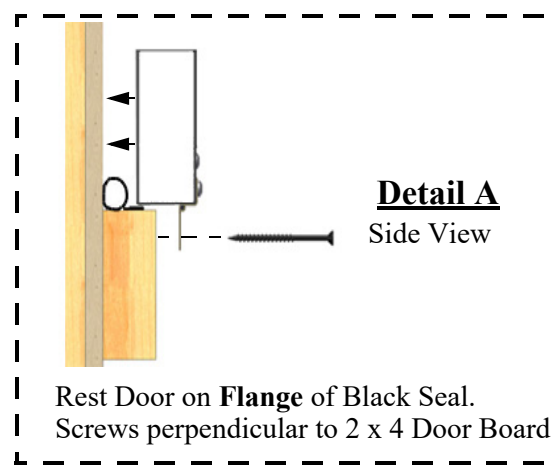
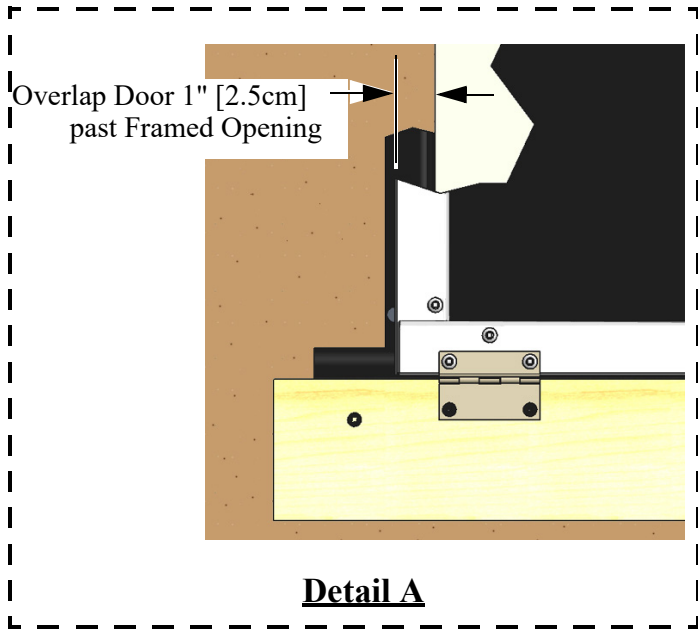

Adding Door Sections

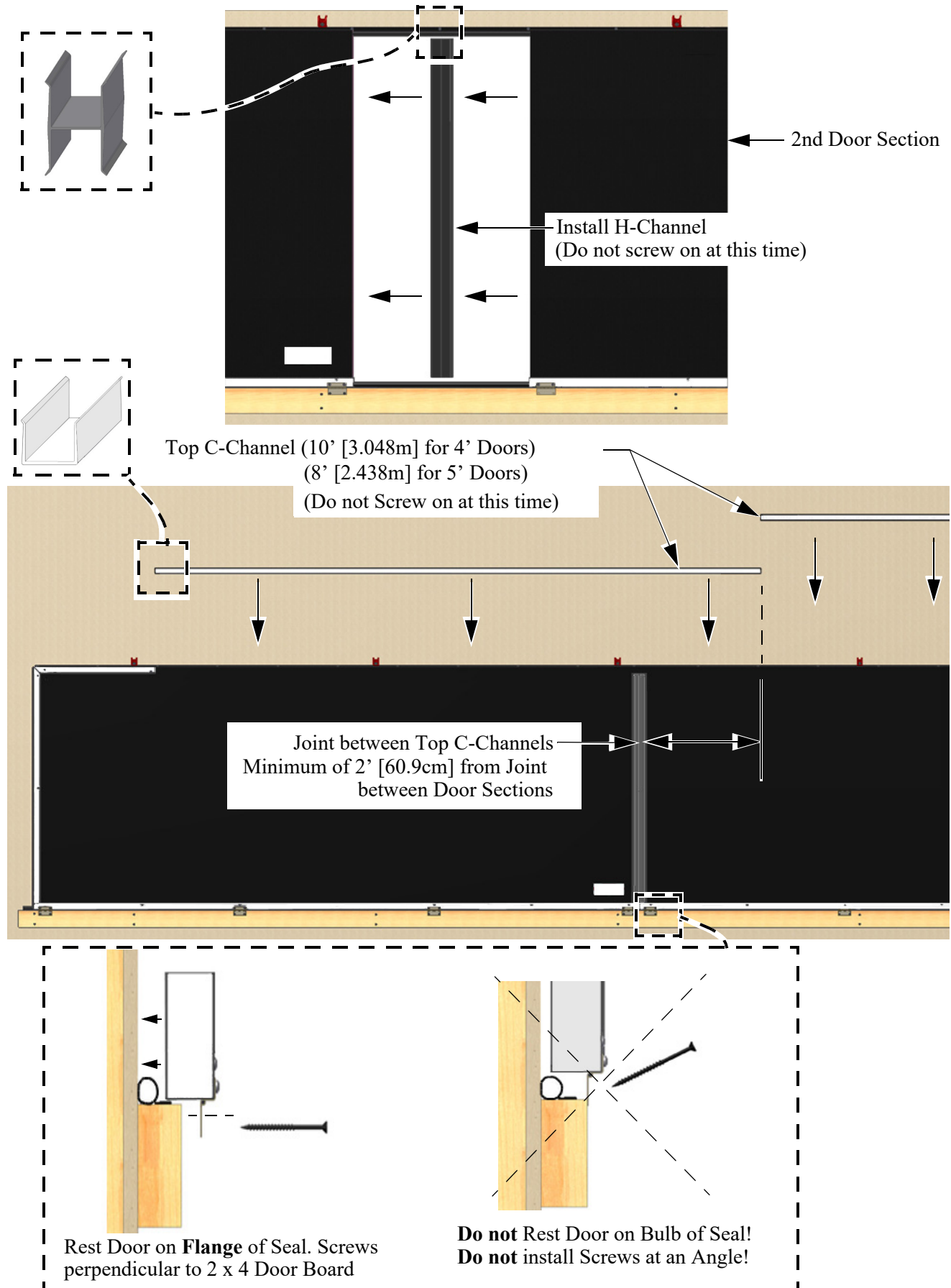

Installation of Split Bolts for Rope/Cable Attachments

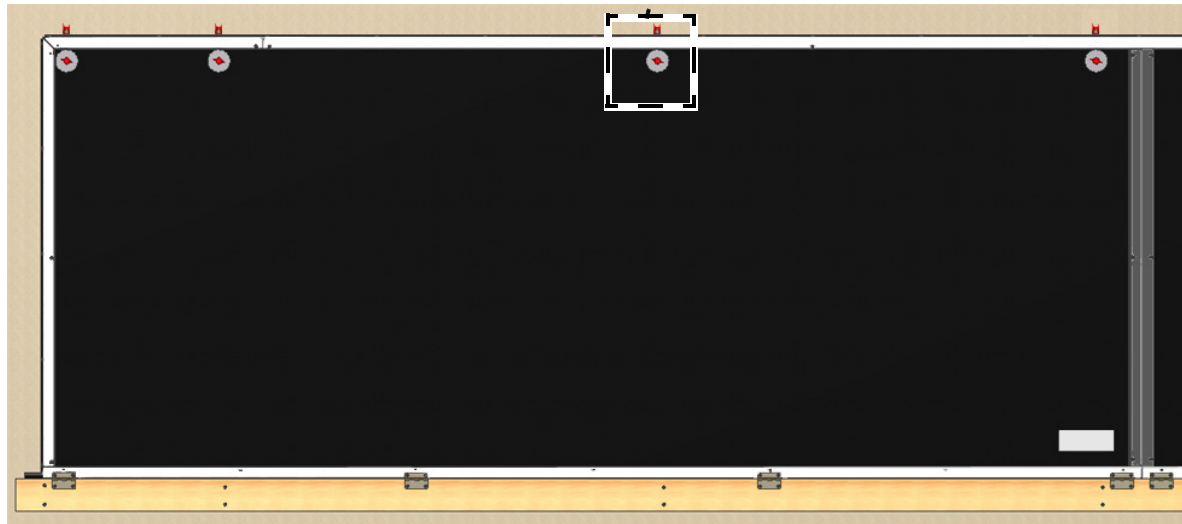
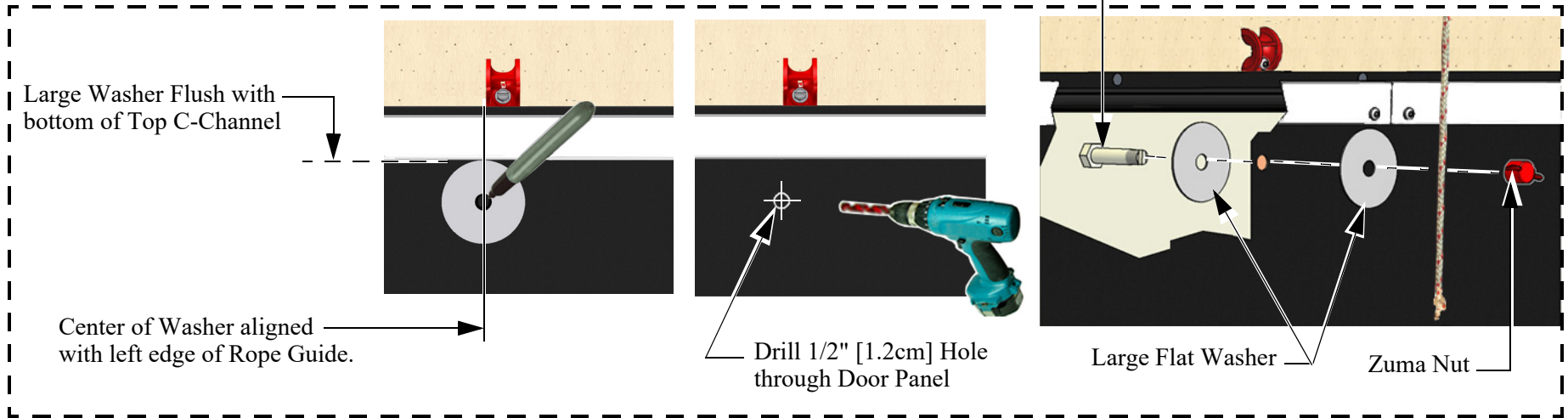

Cut Rope to length...

4' Doors= 60" [1.524m] of Rope

5' Doors= 72" [1.829m] of Rope

Tie off Doors at least every 30' [9.144m] while assembly is in process.

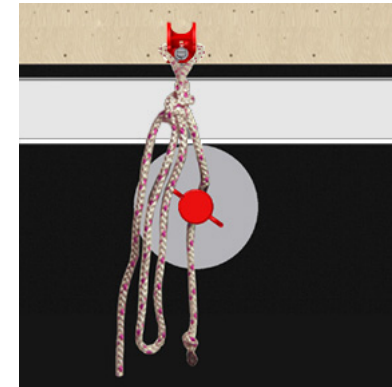

Cable Tensioner and Cable Installation (Cable Version Only)

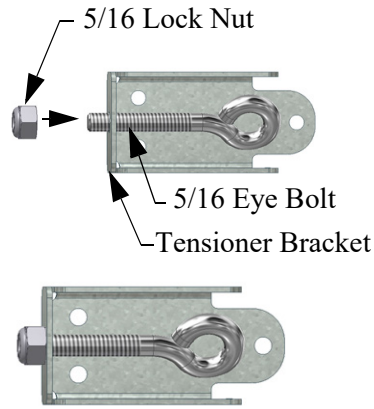

Tighten Nut flush
with end of Eye Bolt

Step 1

Door Ends

Notch in Tensioner
lined up with edge of
Rope Guide. Top
of Tensioner Flush
with Top of Top
Channel.

(2x) #10 x 1/2" Screw

Step 2

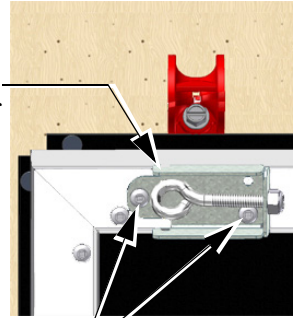

Use a Cable Clamp every
30' [9.144m] to hold up the Doors
during assembly.

Thread the SS Cable through
the notches in the Tensioner,
through the Eye Bolt, and
through the Rope Guide.

(2x) #10 x 1/2" Screw

Step 4

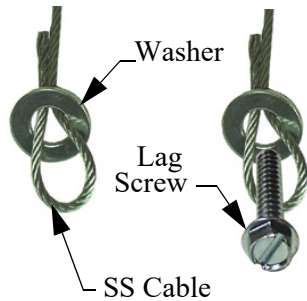
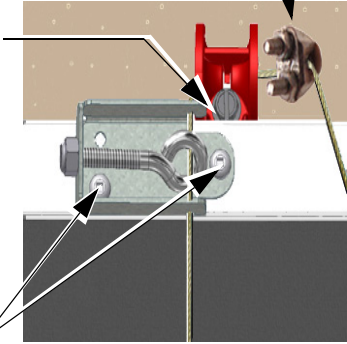

Attach a Cable to the 2 x 4 Door Support with a
Lag Screw as shown directly below the notch
in each Rope Guide. SS Cable Length as follows:
4' Doors = 9' [2.743m] SS Cable
5' Doors = 10' [3.048m] SS Cable

Step 3

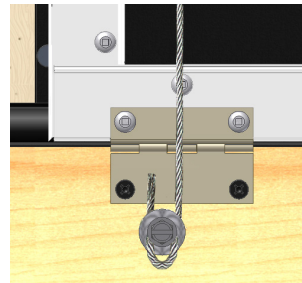

Winch End →

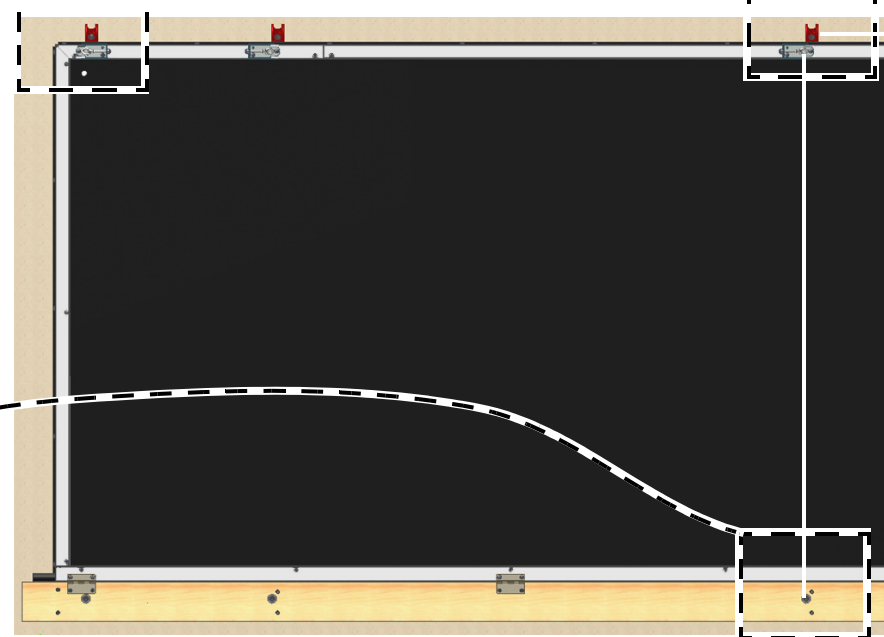

Installing Remaining Door Sections

Step 1. Cut the last Door and Bottom C-Channel off 1" [2.5cm] past the Black Seal Bulb. Remove the last Hinge and Re-attach it as shown if necessary.

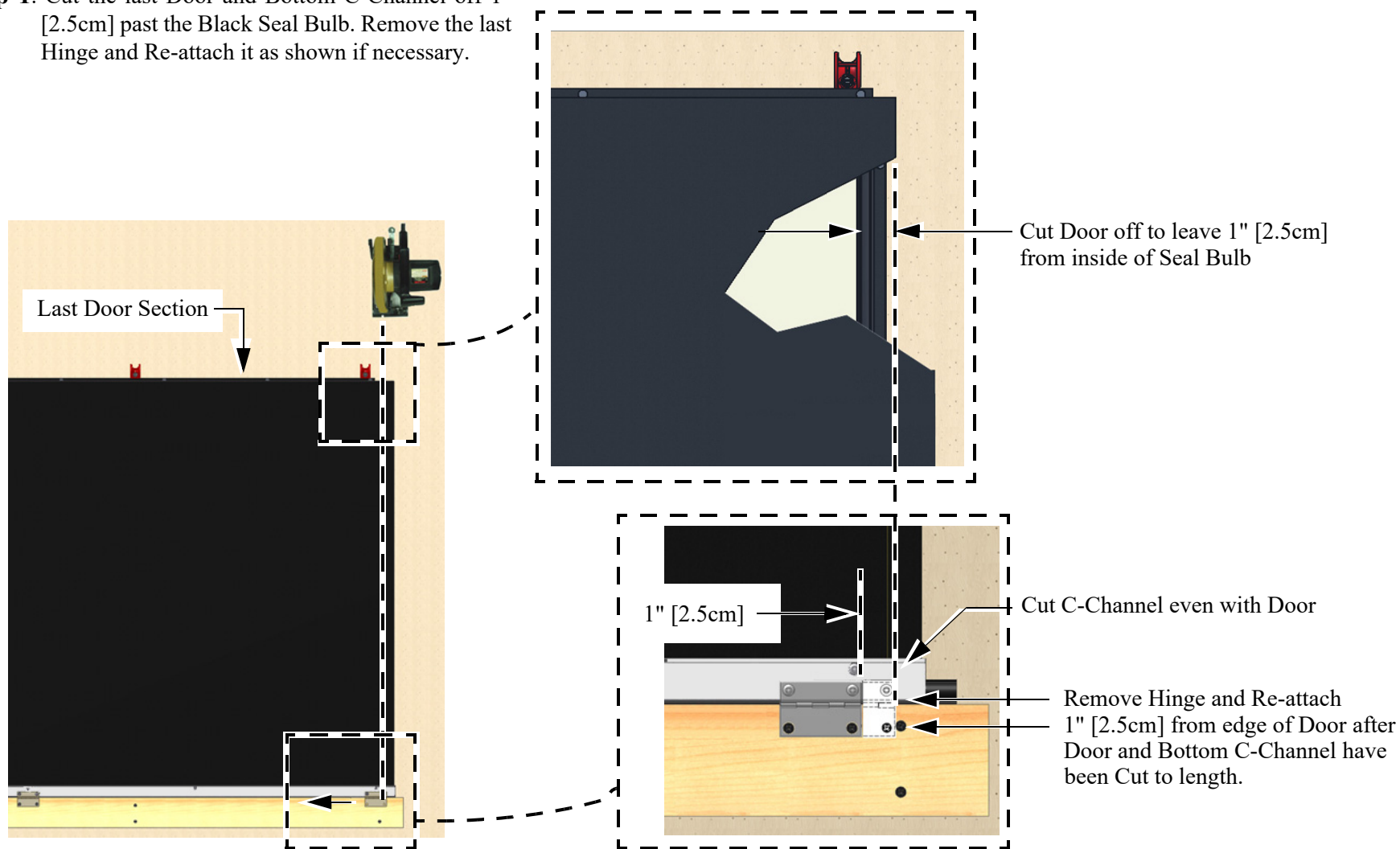

Figure 10. Installing last Door Section

Last Door Section (Continued)

Step 2. Attach all of the Top C-Channels and H-Channels with 1/2" Screws **as shown**.

Step 3. Miter and Attach the last Top C-Channel with 1/2" Screws.

Step 4. Notch the end, and attach it to the end of the last Door with 1/2" Screws

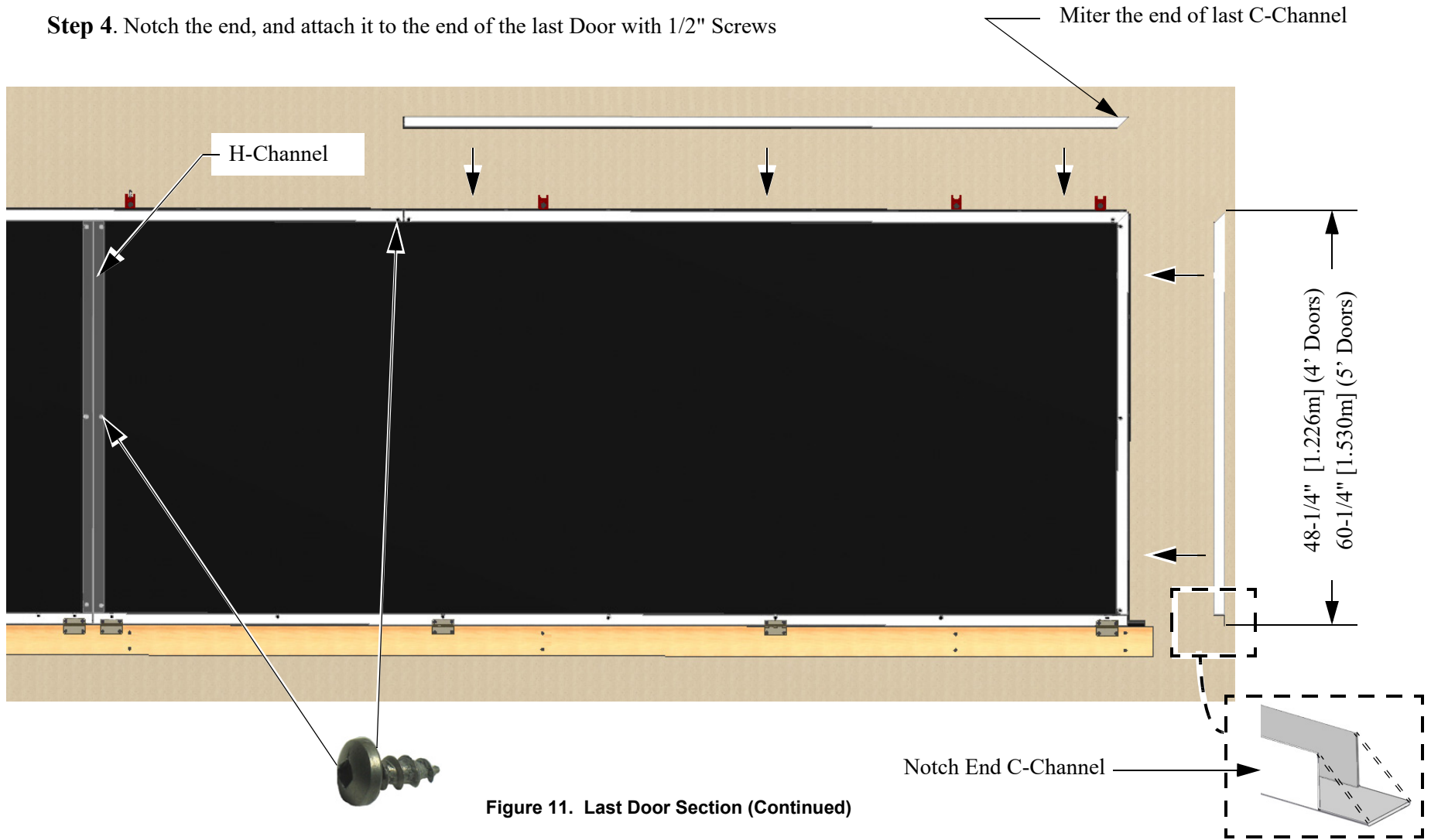
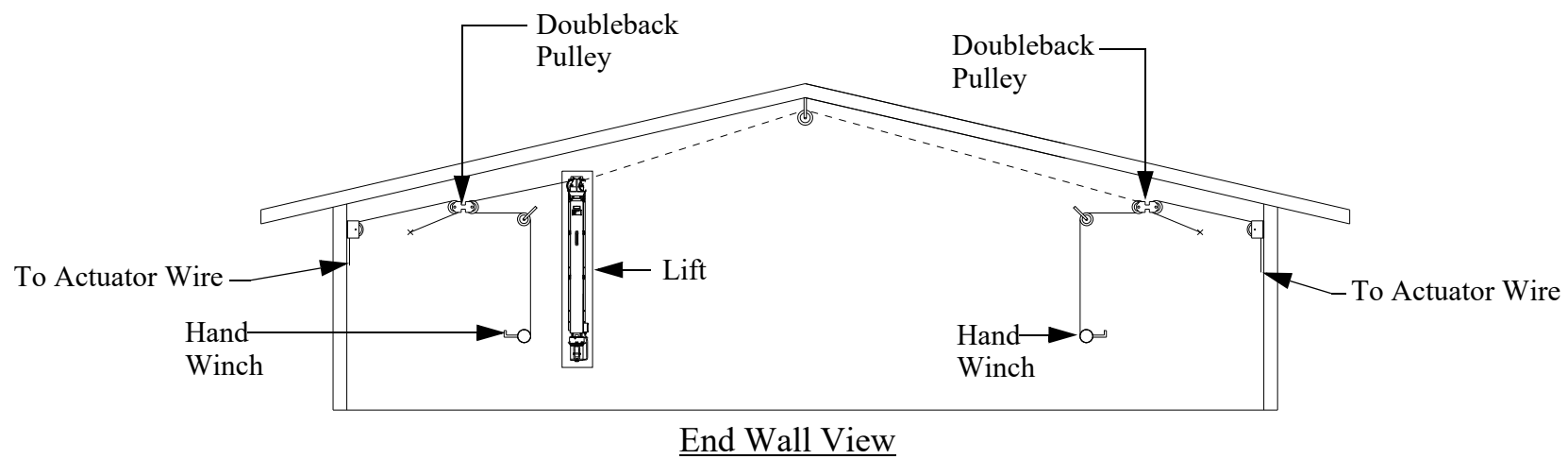
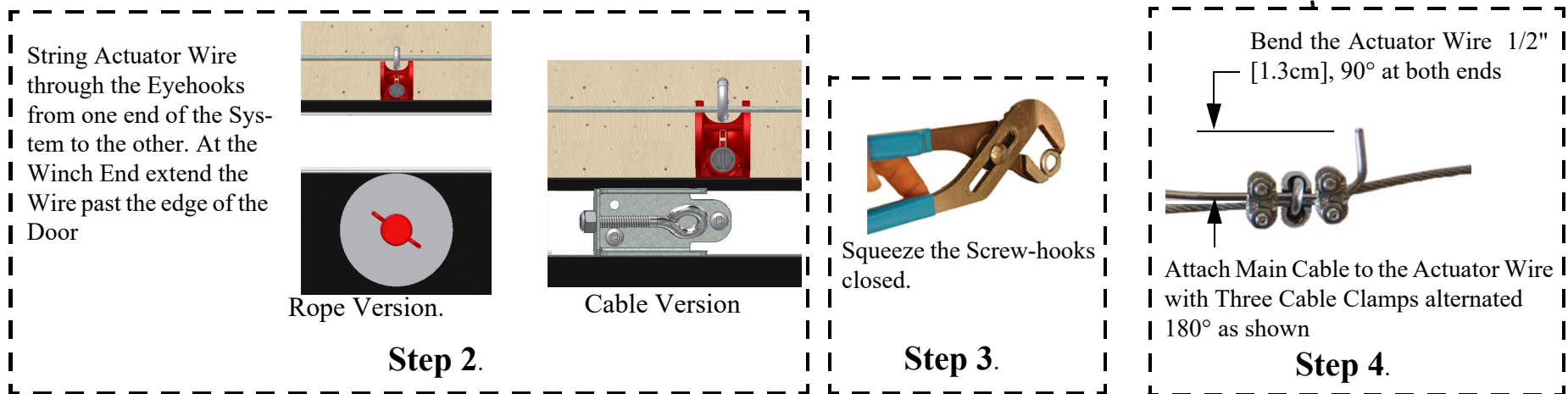
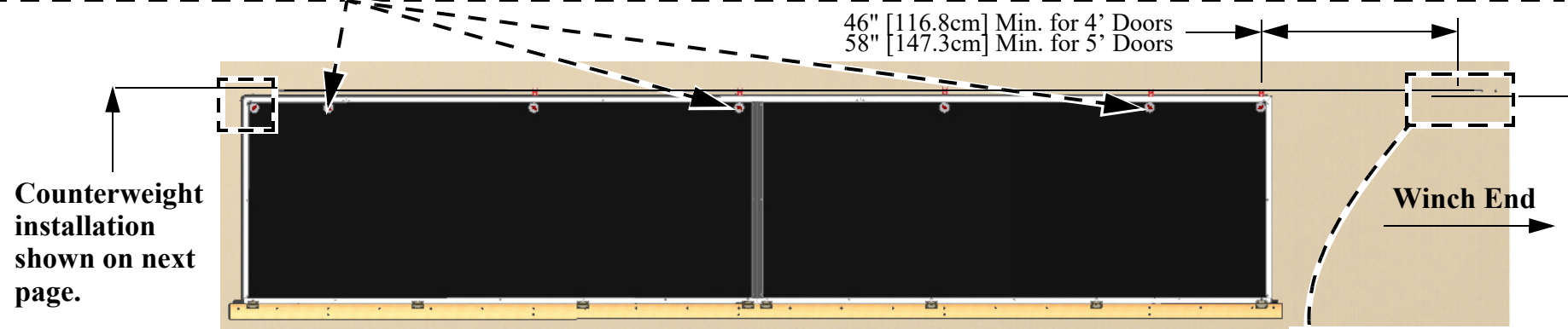
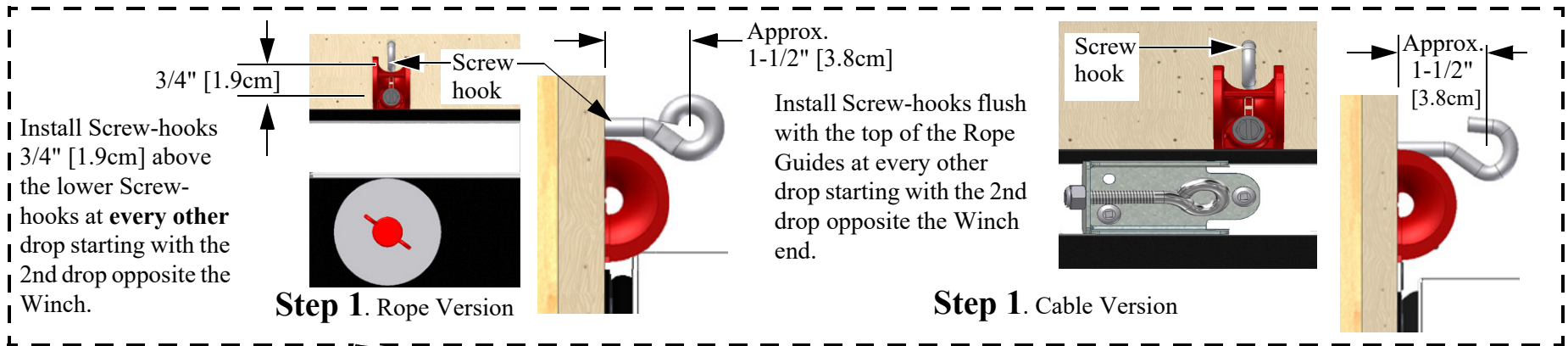

Figure 11. Last Door Section (Continued)

Winch Installation



Door Suspension Installation



Installing Counter Weight / Extension Spring

Counter Weight Installation

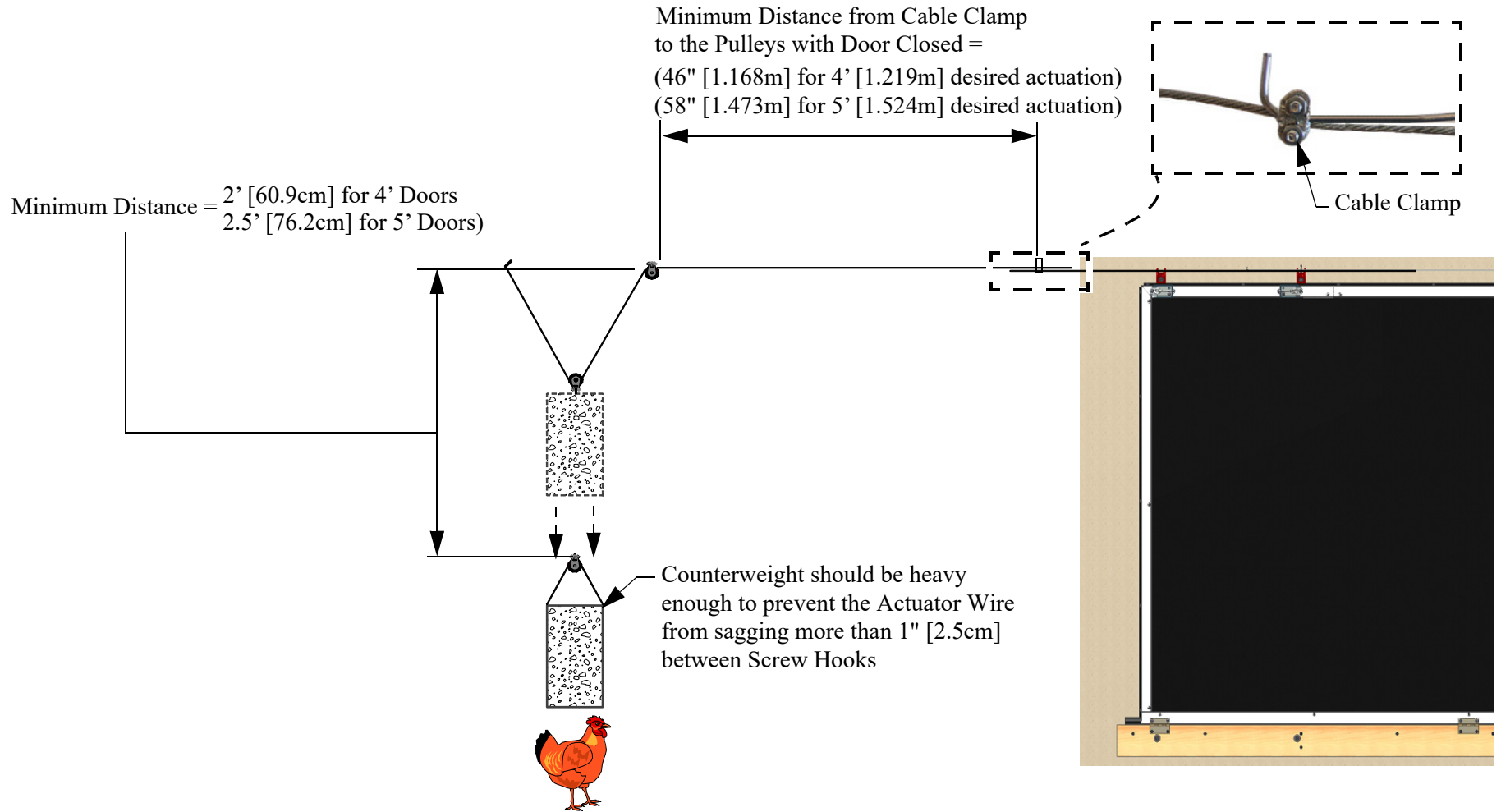

Rope Attachment

Step 1. Use the Hand Winch to pre-stretch the Main Cable before installing Rope drops.

Step 2. Run Lift to the fully closed position.

Lift in Closed Position
(Brass Nut toward Motor)

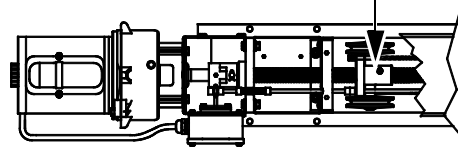

Minimum = 44" [1.118m] for 4' doors
56" [1.422m] for 5' doors

Step 3. Attach Ropes to Door Wire with a Cable Clamp. The Minimum distance between the Cable Clamp and the next Eyehook is the desired Door opening distance.

Feed Rope through skipped Rope Guides

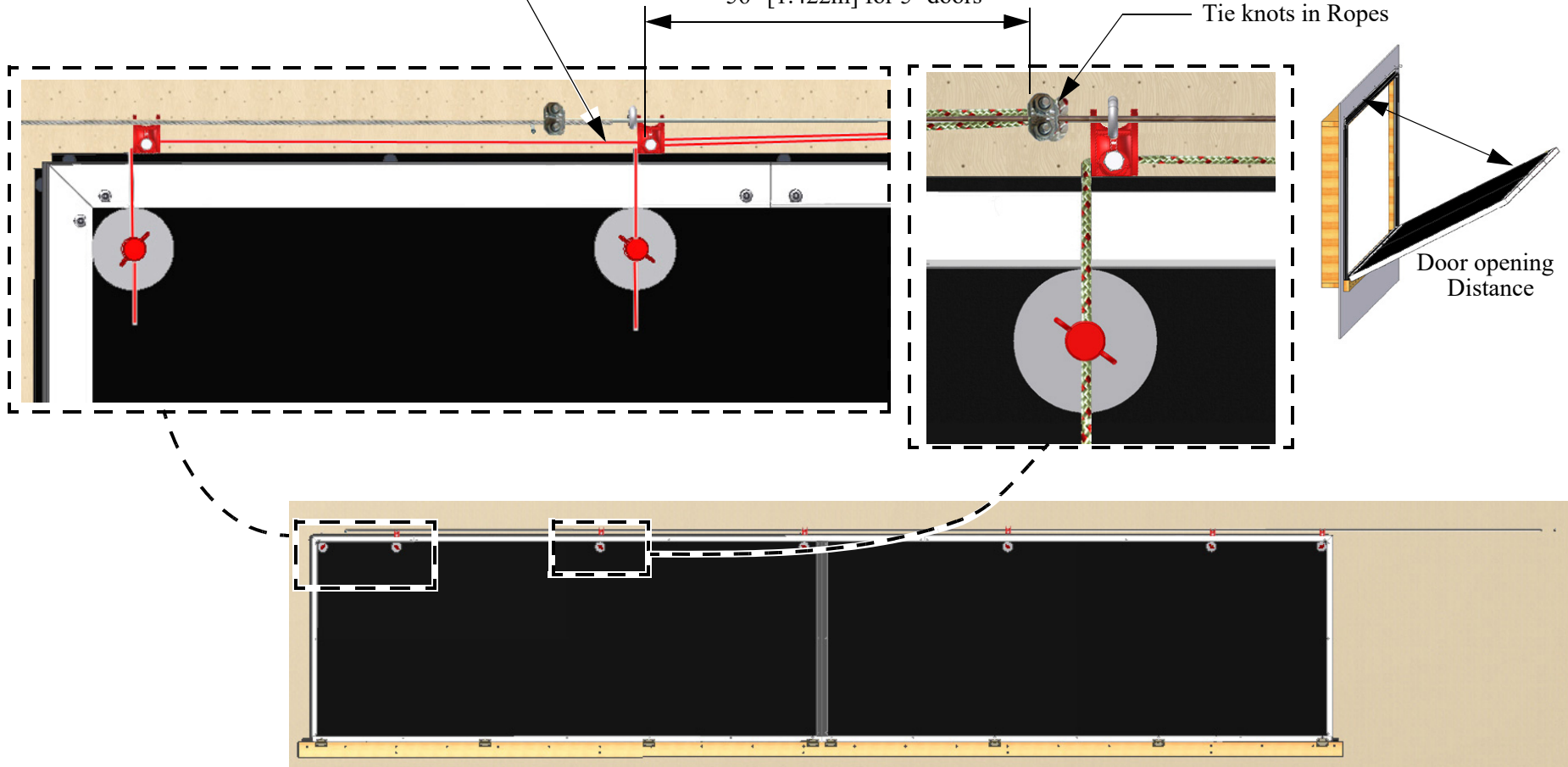

Cable Attachment

Step 1. Use the Hand Winch to pre-stretch the Main Cable before installing Cable drops.

Step 2. Run Lift to the fully closed position.

Lift in Closed Position
(Brass Nut toward Motor)

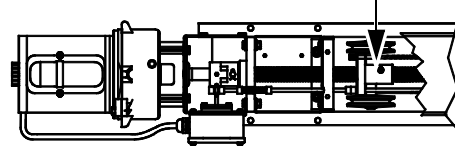

Step 3. Attach Cables to Door Wire with a Cable Clamp. The Minimum distance between the Cable Clamp and the next Eyehook is the desired Door opening distance.

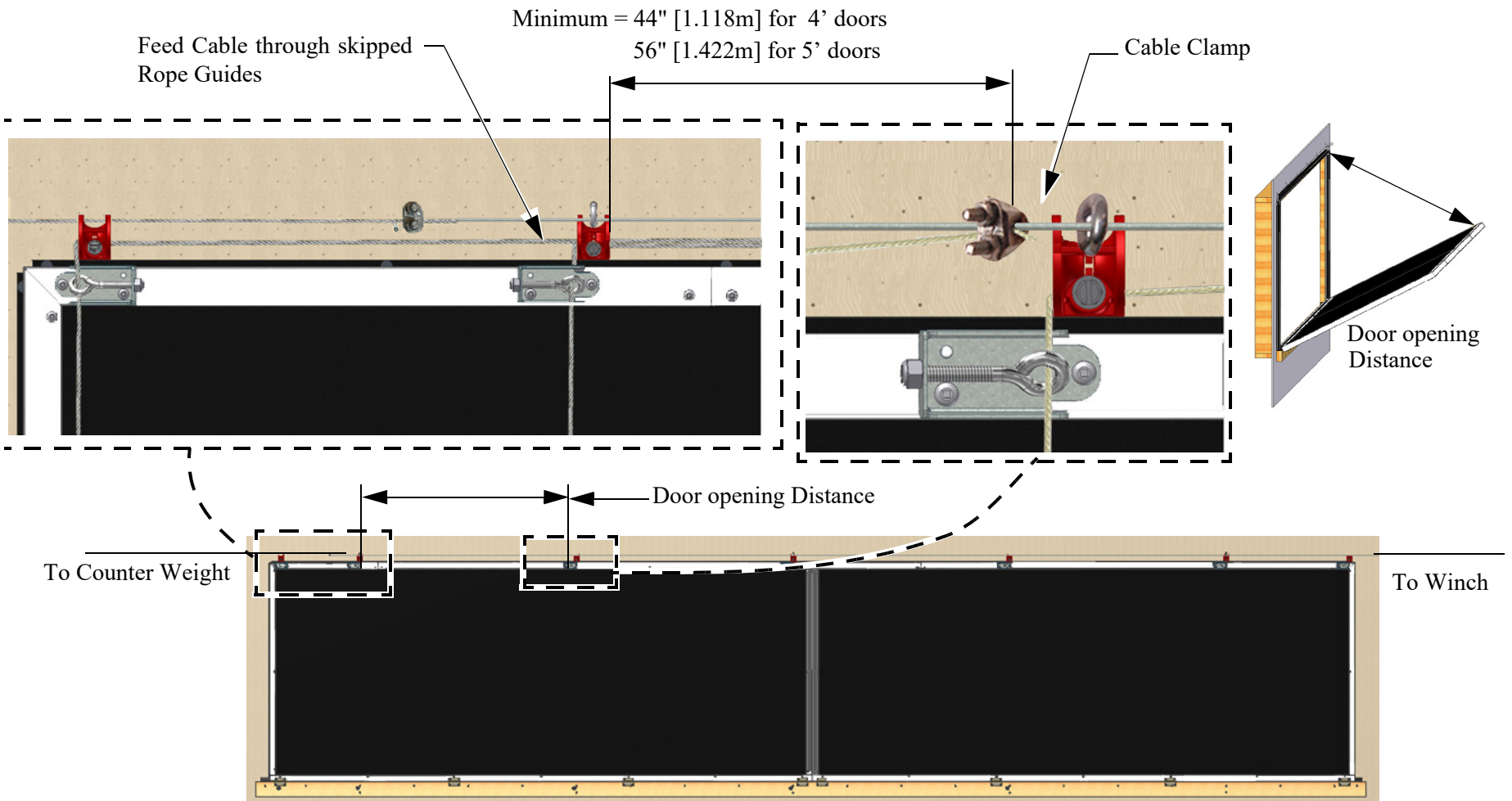

Final Door Adjustment

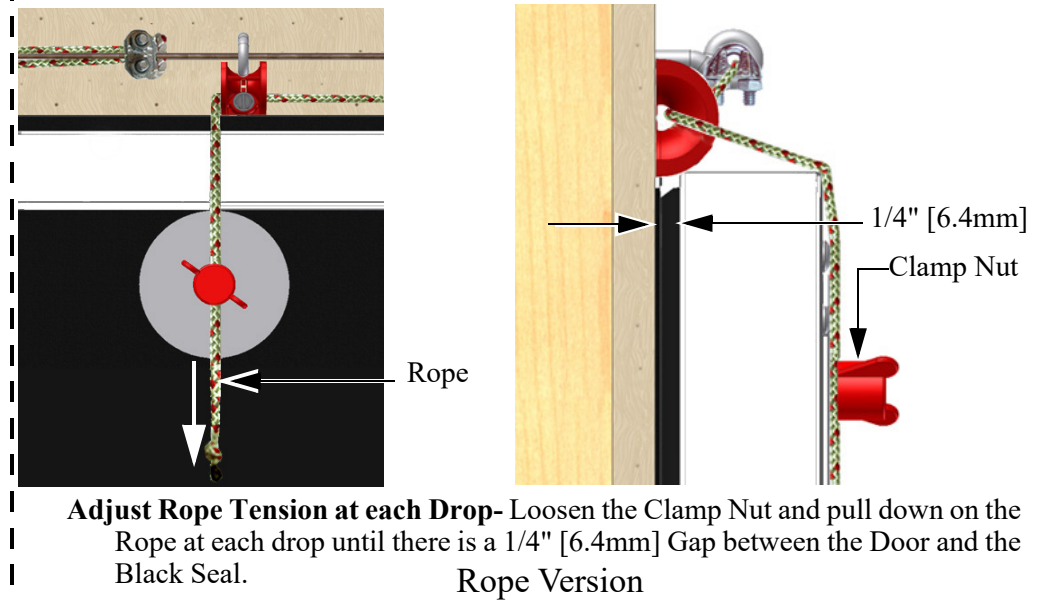
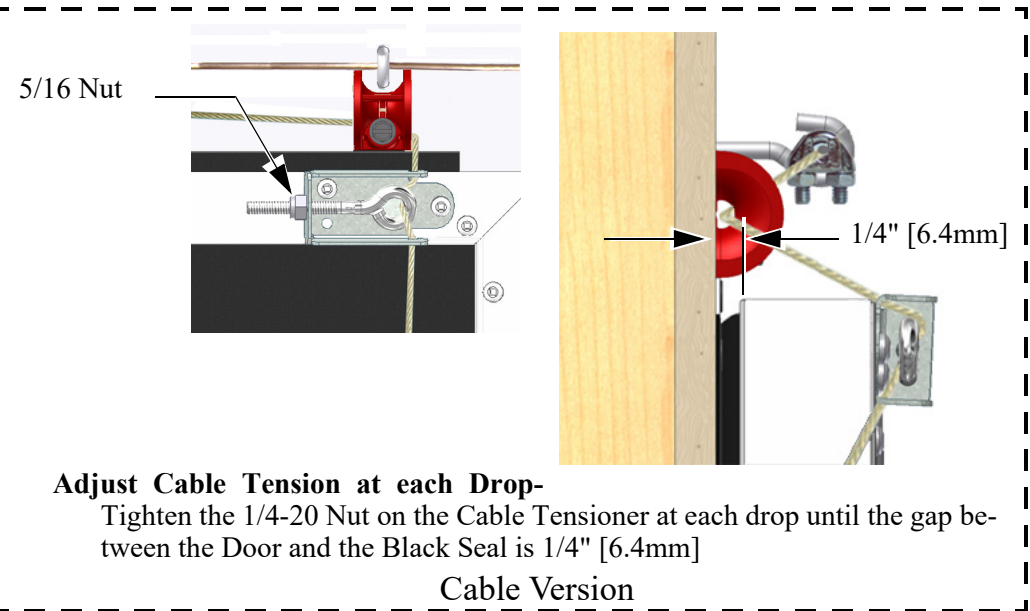
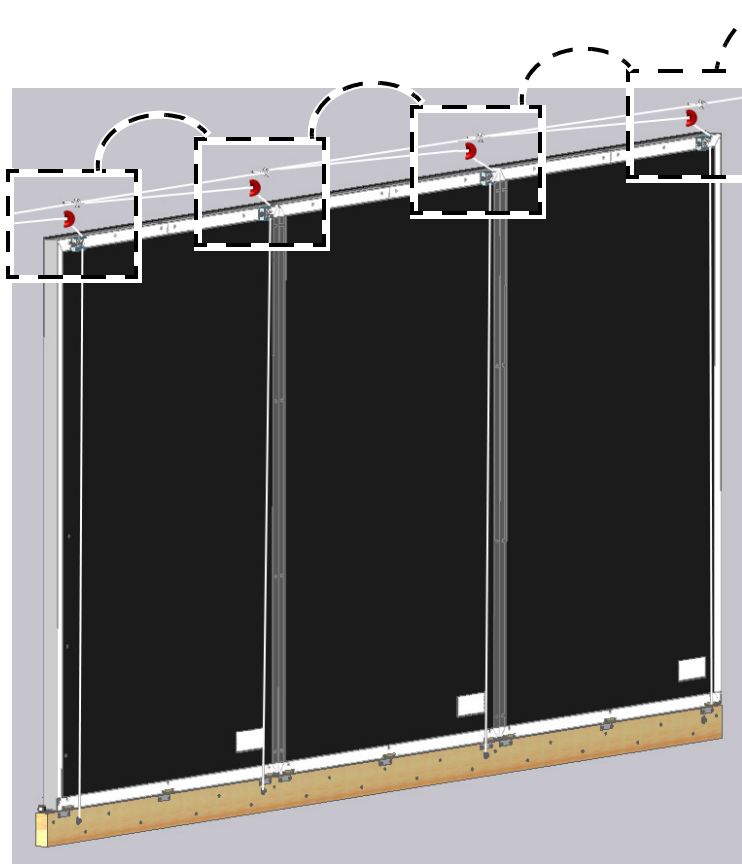

This Page Left Blank Intentionally....

4' and 5' Tall Door Sections

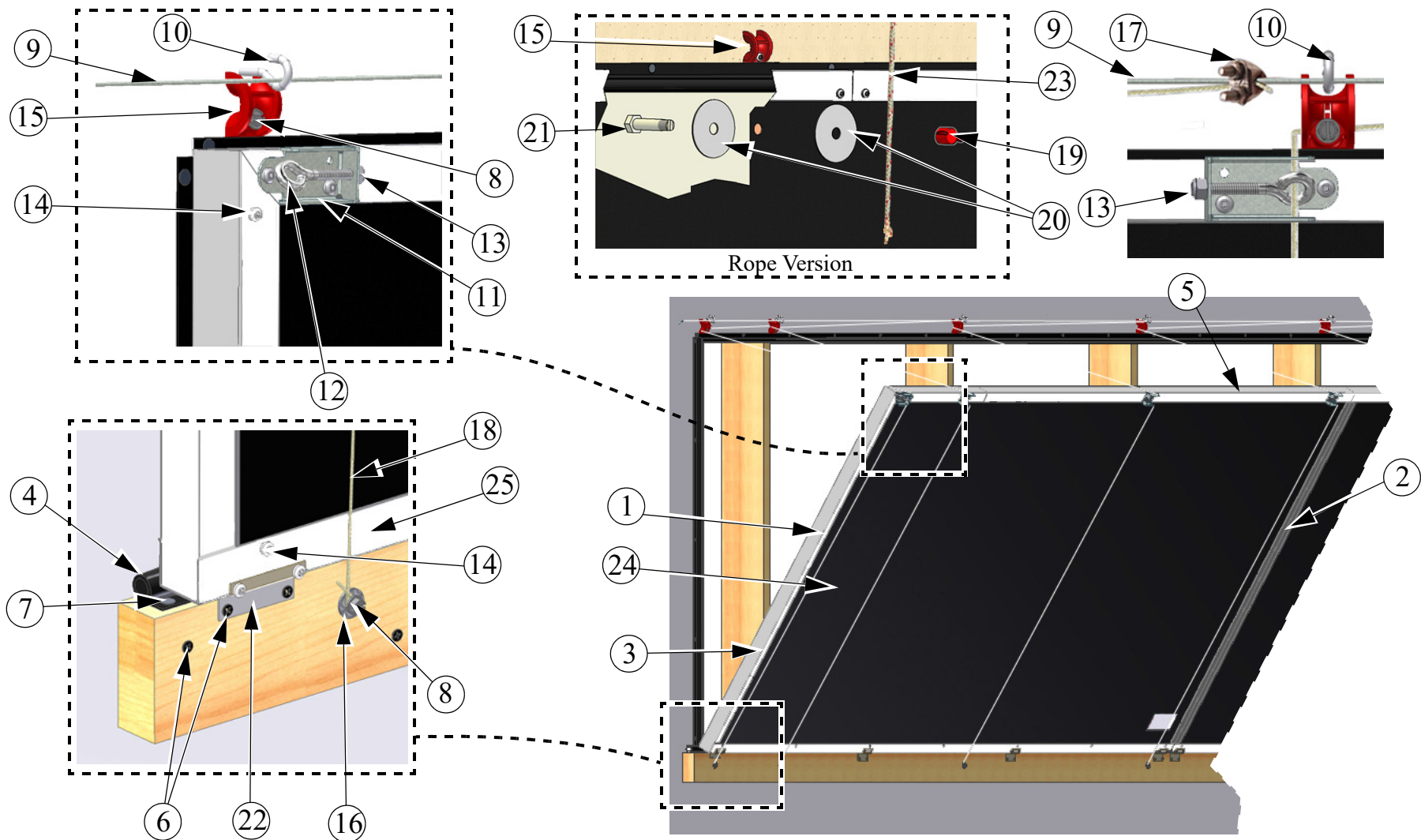

Figure 45. Part Numbers

Part Numbers for 4' and 5' Tall Door Sections

Item	Description	Models	
		4' Door Part No.	5' Door Part No.
1	48" Tall x 120" Blk Tunnel Door Section	51345 ⁵	--
	60" Tall x 48" Blk Tunnel Door Section	--	51528 ⁶
2	45.63" Blk. H-Channel (Sq. ends)	51153-7	--
	57.63" Blk. H-Channel (Sq. ends)	--	51153-8
3	48.32" Wht. C-Channel 45° Ends ⁷	52591-1	--
	60.32" Wht. C-Channel 45° Ends ⁷	--	52591-2
4	1" Black Bulb Seal	52589-200 ¹	52589-200 ¹
5	96.55 C-Channel (w/ Sq. Ends) ⁷	--	52591-9
6	#9-9x3 Quadrex Drive Wood Screw	50241 ²	50241 ²
7	2D x 1 11 Gauge Roofing Nail	50239 ²	50239 ²
8	1/4 x #10 x 1.75 Lag Screw	51039	51039
9	Actuator Wire (500')	46059-500 ³	46059-500 ³
10	Screw Hook	1214	1214
11	Cable Tensioner Bracket	51489	51489
12	5/16 x 3.25" Eyebolt	30663	30663
13	.31x 18 (Nyl. Insert) Nut	ST99074	ST99074

Item	Description	Models	
		4' Door Part No.	5' Door Part No.
14	#10 x 1/2" Sq. Drive Panhead Screw	52102 ²	52102 ²
15	Rope Guide	51173 ²	51173 ²
16	.406 x .812 x .065 Washer	4967	4967
17	.125 Cable Clamp	14898	14898
18	3/32-7x19 Aircraft Cable	28394	28394
19	Split Bolt Cap	40788	40788
20	Large Washer for Split Bolt	50234	50234
21	Split Bolt	50236	50236
22	1.5 x 2.5 SS Hinge	51917	51917
23	Rope	5-37173 ⁴	5-37173 ⁴
Available Replacement Panels			
24	1.5 x 48 x 120 Blk FRP Panel	51344	
	1.5 x 48 x 60 Blk FRP Panel		51344-6
25	48.55 C-Channel (White. w/ Sq. Ends)	--	52591-7
	120.55 C-Channel (White. w/ Sq. Ends)	52591-10	
¹ Packaged in boxes of 200' ² Must be ordered in increments of 100 pieces ³ 46059-500 is a 500' roll. ⁴ Rope must be ordered in increments of 1000' 5-37173-1000 ⁵ Section includes 51344 Panel with 52591-10 Top and Bottom C-Channels and 51917 Hinges assembled ⁶ Section includes 51344-6 Panel with 52591-7 Bottom C-Channel and 51917 Hinges assembled ⁷ Was Black C-Channel from 1-25-08 to 9-2-09. Replacement Black 10' C-Channel Part No. 51152-10.			

Part Numbers for Individual Door Assemblies

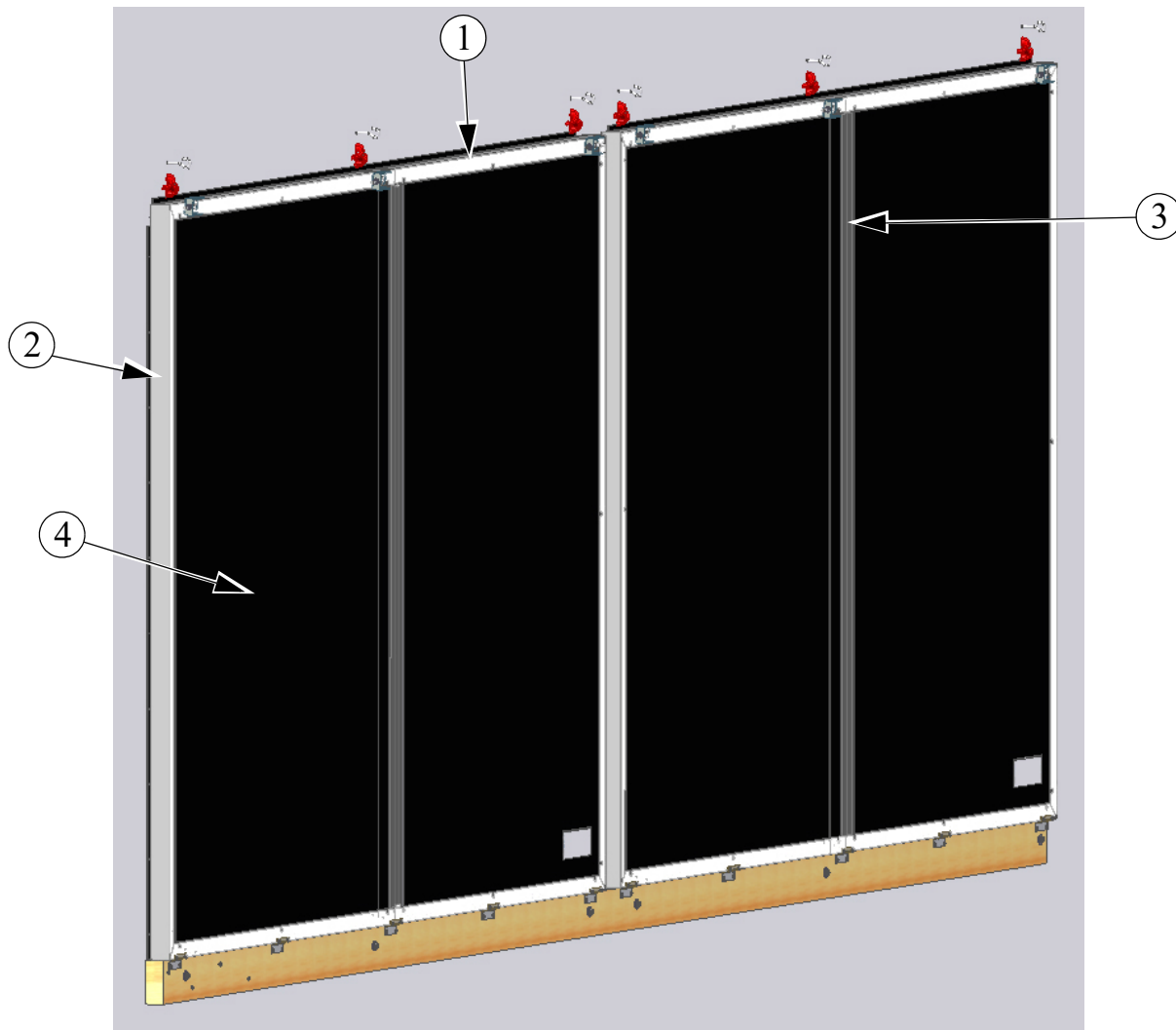

Item	Description	Size, Assembly Part No. and Component Part Numbers					
		4' x 48"	4' x 93"	4' x 115"	5' x 48"	5' x 93"	5' x 115" Door
1	White Top and Bottom C-Channel (45° ends) ¹	51664	51665	51666	51868	51869	51870
2	White Side C-Channel (45° ends) ¹	52591-1	52591-1	52591-1	52591-2	52591-2	52591-2
3	H-Channel	--	--	--	--	51153-8	51153-8
Available Replacement Panel Sizes		Part No.					
4	Panel, 1.5" x 48" x 60" Black FRP	51344-6					
	Panel, 1.5" x 48" x 96" Black FRP	51344-8					
	Panel, 1.5" x 48" x 120" Black FRP	51344					

¹Was Black C-Channel from 1-25-08 to 9-2-09. Replacement Black 10' C-Channel Part No. 51152-10.

This Page Left Blank for Notes.....



Note: The original, authoritative version of this manual is the [English] version produced by CTB, Inc. or any of its subsidiaries or divisions, (hereafter collectively referred to as "CTB"). Subsequent changes to any manual made by any third party have not been reviewed nor authenticated by CTB. Such changes may include, but are not limited to, translation into languages other than [English], and additions to or deletions from the original content. CTB disclaims responsibility for any and all damages, injuries, warranty claims and/or any other claims associated with such changes, inasmuch as such changes result in content that is different from the authoritative CTB-published [English] version of the manual. For current product installation and operation information, please contact the customer service and/or technical service departments of the appropriate CTB subsidiary or division. Should you observe any questionable content in any manual, please notify CTB immediately in writing to: CTB Legal Department, P.O. Box 2000, Milford, IN 46542-2000 USA.

Revisions to this Manual

Page No.	Description of Change	ECO
5	Added "Tunnel Doors should be shaded from direct sun light"	31001
7	Removed Screws from Seal installation	
26	Updated Contact Info	
2	Updated Warranty	

**For additional parts and information, contact your nearest Chore-Time distributor or representative.
Find your nearest distributor at: www.choretime.com/contacts**

Chore-Time Group, A division of CTB, Inc.
PO Box 2000
Milford, Indiana 46542-2000 USA
Phone (574) 658-4101 Fax (877) 730-8825
Email: choretime@choretime.com
Internet: www.choretime.com