

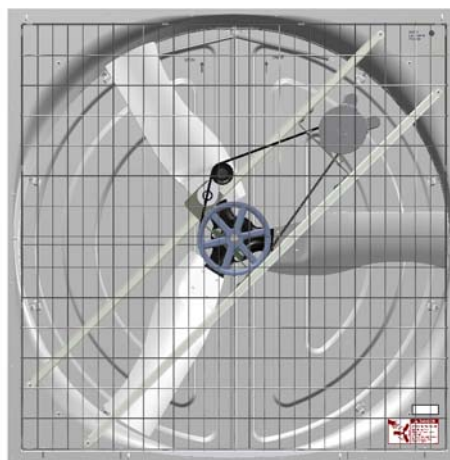

# 57" Endura® Fan Installation & Operator's Instruction Manual

**Thank You** The employees of CTB Inc. would like to thank you for your recent Chore-Time purchase. If a problem should arise, your Chore-Time distributor can supply the necessary information to help you.

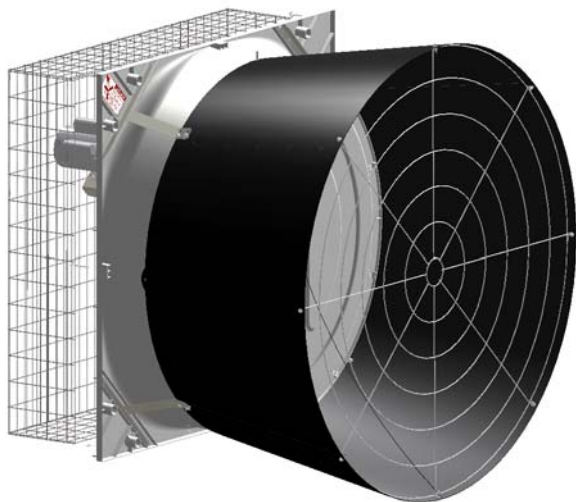

## Fan Part Numbers and Specifications

Fan Part No.	Bess Lab Test No.	Nominal RPM	Voltage	Phase	Hz	at .10" w.c. Static Pressure [25 Pa]			Starting Amps
						CFM	CFM/W	Amps @230V	
53464-21			230	1	60				
53464-22			230	1	60				
53464-41			200-230/400-460	3	60				
53464-42			230/460	3	60				
53464-51			200-230/380-415	3	50				
53464-52			200-230/380-415	3	50				

Operating static pressure should be less than 0.15 inches water column [37.5 Pa].

**The Fan Inlet and exhaust must be kept clear of obstructions. Failure to keep the Fan airflow path clear of obstructions could cause loss of Fan performance and Fan damage.**

## Safety Information

Carefully read all safety messages in this manual and on your equipment safety signs. Follow recommended precautions and safe operating practices. Keep safety signs in good condition. Replace missing or damaged safety signs.

### DANGER: Electrical Hazard

Disconnect electrical power before inspecting or servicing equipment. Ground all electrical equipment for safety. All electrical wiring must be done by a qualified electrician in accordance with local and national electric codes. Ground all non-current carrying metal parts to guard against electrical shock. With the exception of motor overload protection, electrical disconnects and over current protection are not supplied with the equipment.



### DANGER: Rotating Fan Blade

Keep Hands away. Disconnect power before servicing. Fan may start automatically. Do not operate the Fan without the screens in place. Disregard to these things will cause serious injury including death.



## Safety

**Chore-Time Egg Production Systems**, a division of CTB, Inc., ("Chore-Time"), warrants each new CHORE-TIME® product manufactured by it to be free from defects in material or workmanship for one (1) year from and after the date of initial installation by or for the original purchaser. If such a defect is found by Chore-Time to exist within the one-year period, Chore-Time will, at its option, (a) repair or replace such product free of charge, F.O.B. the factory of manufacture, or (b) refund to the original purchaser the original purchase price, in lieu of such repair or replacement. Labor costs associated with the replacement or repair of the product are not covered by the Manufacturer.

### Conditions and Limitations

1. The product must be installed by and operated in accordance with the instructions published by the **Manufacturer** or **Warranty will be void.**
2. Warranty is void if **all components** of the system are not original equipment supplied by the **Manufacturer.**
3. This product must be purchased from and installed by an authorized distributor or certified representative thereof or the Warranty will be void.
4. "Malfunctions or failure resulting from misuse, abuse, mismanagement, negligence, alteration, accident, or lack of proper maintenance, or from lightning strikes, electrical power surges or interruption of electricity shall not be considered defects under the Warranty. Corrosion, material deterioration and/or equipment malfunction caused by or consistent with excessive additions or application of chemicals, minerals, sediments or other foreign elements with the product shall not be considered defects under the Warranty."
5. This Warranty applies only to systems for the care of poultry and livestock. Other applications in industry or commerce are not covered by this Warranty.

Chore-Time shall not be liable for any **Consequential or Special Damage** which any purchaser may suffer or claim to suffer as a result of any defect in the product. **"Consequential" or "Special Damages" as used herein include, but are not limited to, lost or damaged products or goods, costs of transportation, lost sales, lost orders, lost income, increased overhead, labor and incidental costs and operational inefficiencies.**

THIS WARRANTY CONSTITUTES THE MANUFACTURER'S ENTIRE AND SOLE WARRANTY AND THIS MANUFACTURER DISCLAIMS ANY AND ALL OTHER WARRANTIES, INCLUDING, BUT NOT LIMITED TO, EXPRESS AND IMPLIED WARRANTIES AS TO MERCHANTABILITY, FITNESS FOR PARTICULAR PURPOSES SOLD AND DESCRIPTION OR QUALITY OF THE PRODUCT FURNISHED HEREUNDER.

Chore-Time Distributors are not authorized to modify or extend the terms and conditions of this Warranty in any manner or to offer or grant any other warranties for CHORE-TIME® products in addition to those terms expressly stated above. An officer of CTB, Inc. must authorize any exceptions to this Warranty in writing. Chore-Time reserves the right to change models and specifications at any time without notice or obligation to improve previous models.

# Un-assembled Fan Parts Packages



(53843-XX)  
Component Package

Fan Blade Part No.  
(on Blade Spider)

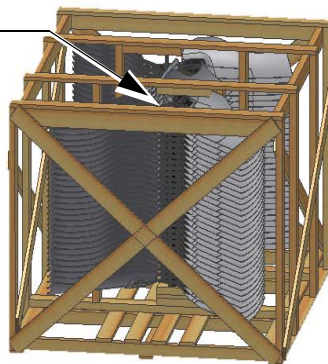

(53219-XX or 53532-XX)  
Fan Blade Package



(See Table Below)  
Motor Pallet

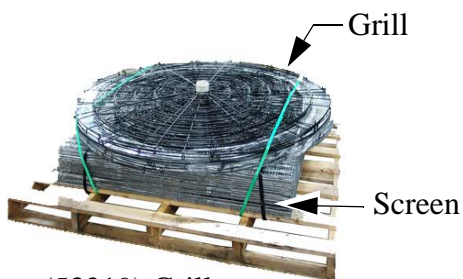

(53219) Grill  
(48794) Inlet Screen



(53850-XX)  
Shroud and Door Package



(53753-1, or -2)  
Drive Assembly  
1 or 2 Drives per Box



(53788-AAXX)  
Hardware Package

**Un-Assembled 57" Endura® Fan Component Part Numbers**

Fan Part No.	Drive Assembly	Motor	Hardware Pkg.	Fan Blade
53464-21	53753-1	50496	53788-21XX	53219
53464-22	53753-1	49903	53788-22XX	53532
53464-41	53753-1	48608	53788-41XX	53219
53464-42	53753-1	48608	53788-42XX	53532
53464-51	53753-2	48608	53788-51XX	53219
53464-52	53753-2	48608	53788-52XX	53532

**XX= Number of Fans that can be built with components in Package.**

## Hardware Needed Per Fan (Un-Assembled)

57" Endura® Fan Hardware Items Per Fan Items are Bulk packed in 53788-AAXX (See previous page).			
Item	Qty.	Description	Part No.
1	1	Bottom Pivot Plate	53036
2	1	Top Pivot Plate	53037
3	4	Door Hinge Pin	53038
4	1	1/4 x 1-1-8" Sq. Key (For Blade)	2419-2
5	20	5/16-18 x HHBS Bolt	39-20073
6	56	5/16-18 Hx. Serrated SS Flange Nut	46764
7	20	5/16-18 x .75 SS Carriage Bolt	27868-1
8	2	.38 SS Flat Washer	ST99070
9	1	72.5" Fan Cone Cable	53399
10	1	5/16-18 x 3" Eye Bolt	30663
11	2	Ø1/2" x 11" Door Spring	49629
12	24	1/4-10 x 1-1/2 Lag Screw SS	41561
13	9	Open Eye Hook	1214
14	11	Cable Tie (Includes 3 extra)	48103
15	6	Orifice Frame Bracket	53611
16	2	Cable Clamp	732
17	1	Fan Description Decal	39002-XXX
18	1/3	Anti-Seize Lubricant	47749
19	--	57" Endura® Fan Instruction Manual	MV2406

## Tools Needed and Supplies

3/8" socket	1/4" nut driver
1/2" socket or wrench	Motor power cord
Side cutters	Wire nuts / terminals
5/32" allen wrench (unassembled)	Optional screw hook installation tool (CTB part number 13150-1)
	Caulking

## New Installation Planning

Planning the layout of the spacing between Fans is very important. Spacing too close together will cause interference between the discharge Cones.

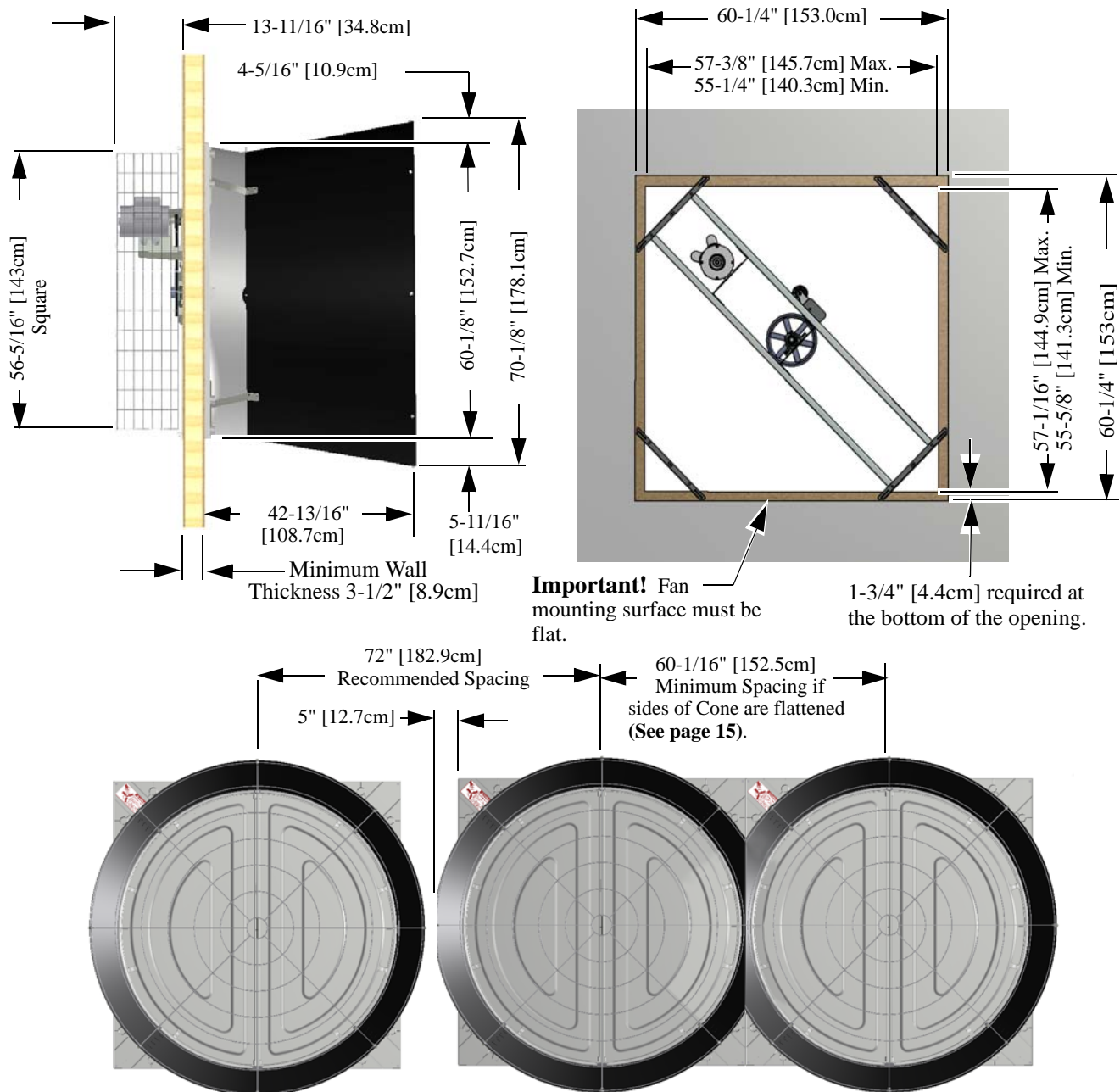

## Inspect Shroud Assembly for hardware as it is received

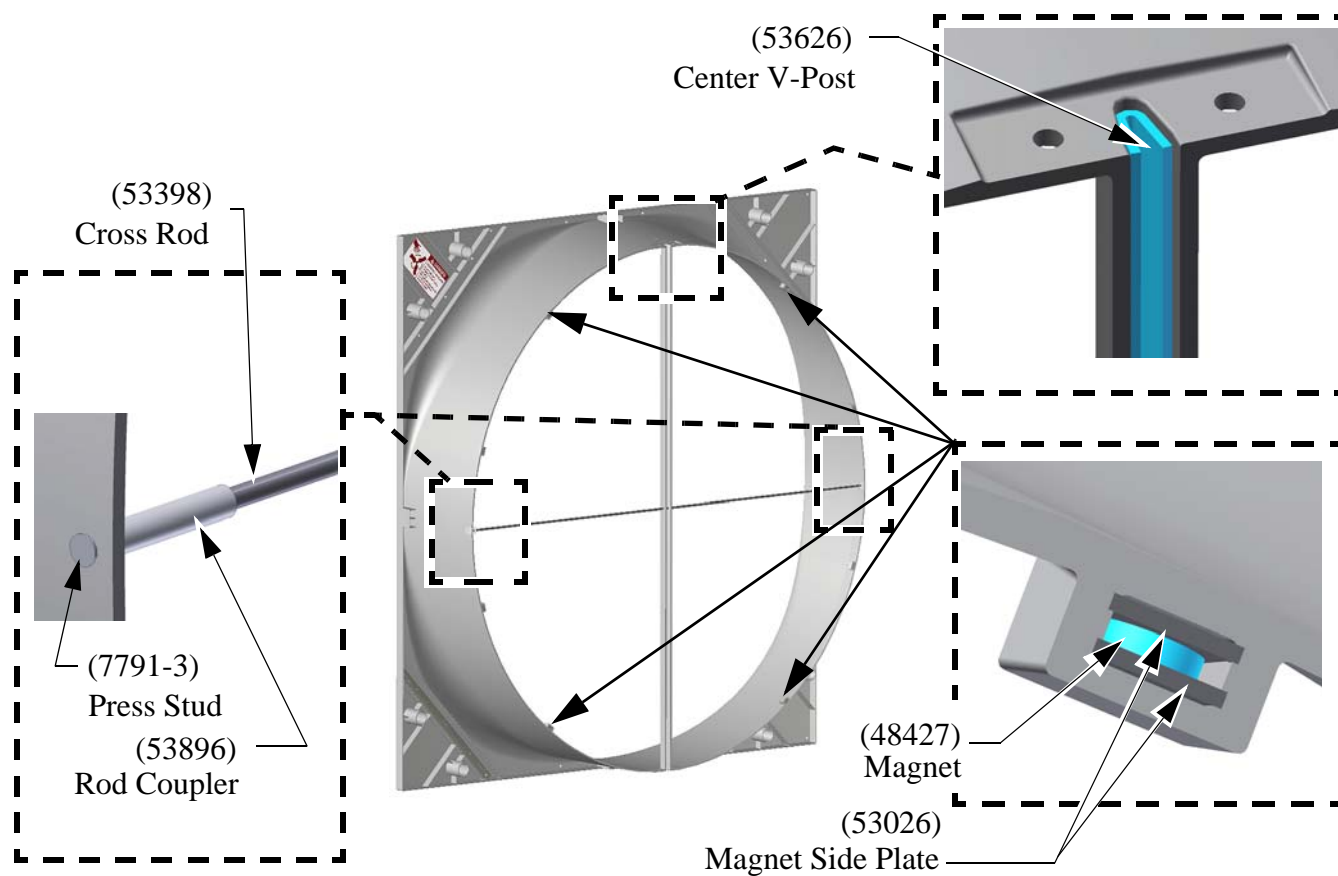

## Installation

### Rest Fan Shroud on Saw Horses for ease of Assembly

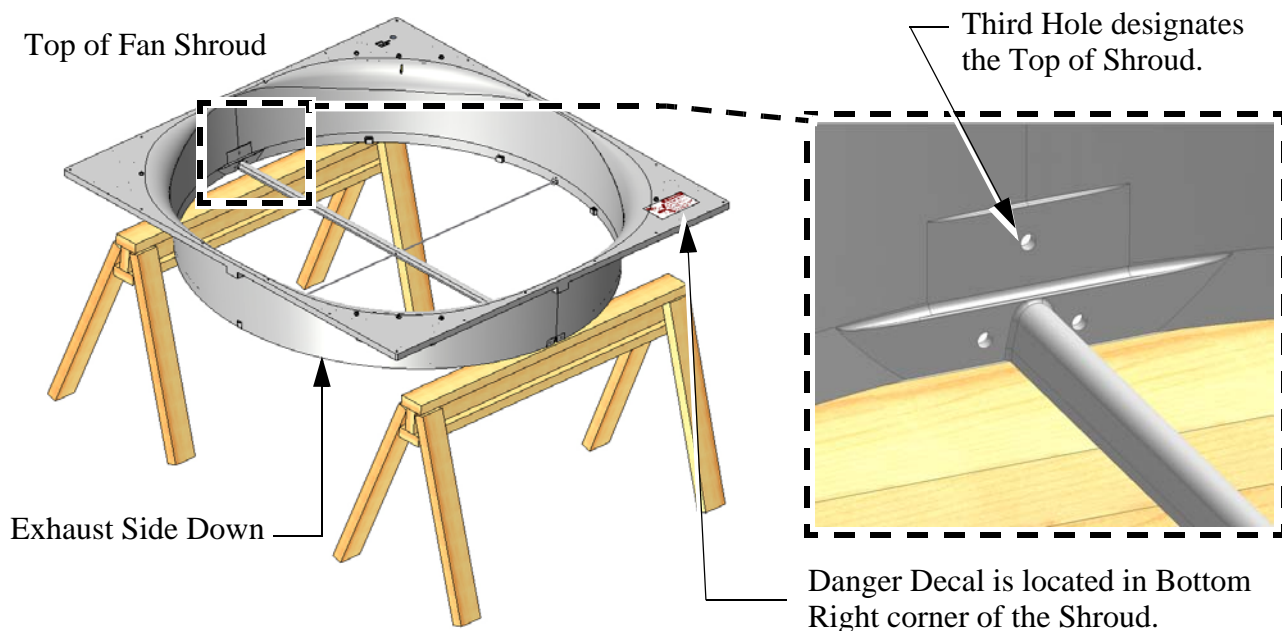



# Attaching Fan Posts

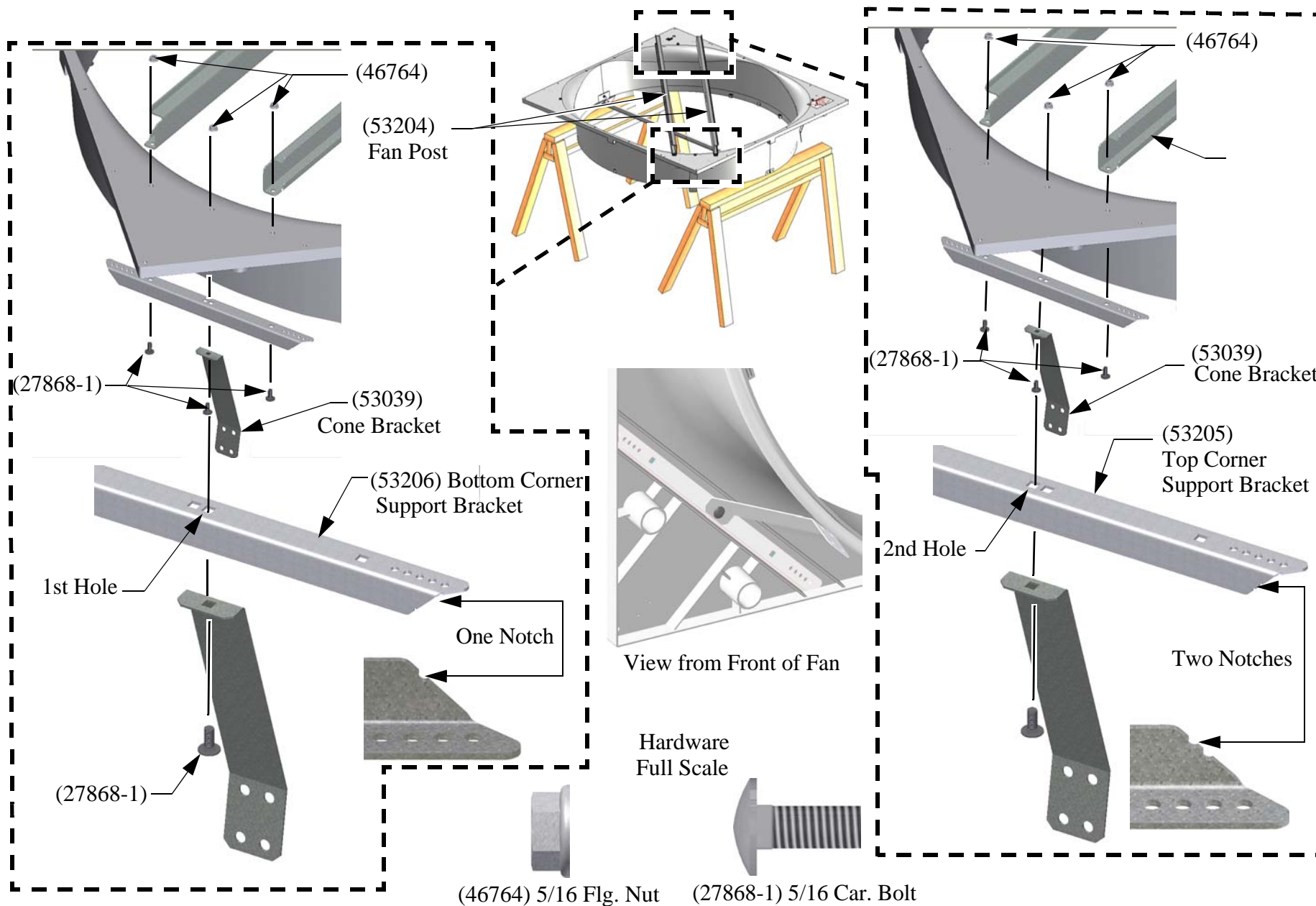

# Cone Brackets, Corner Brackets (Corners without Posts)

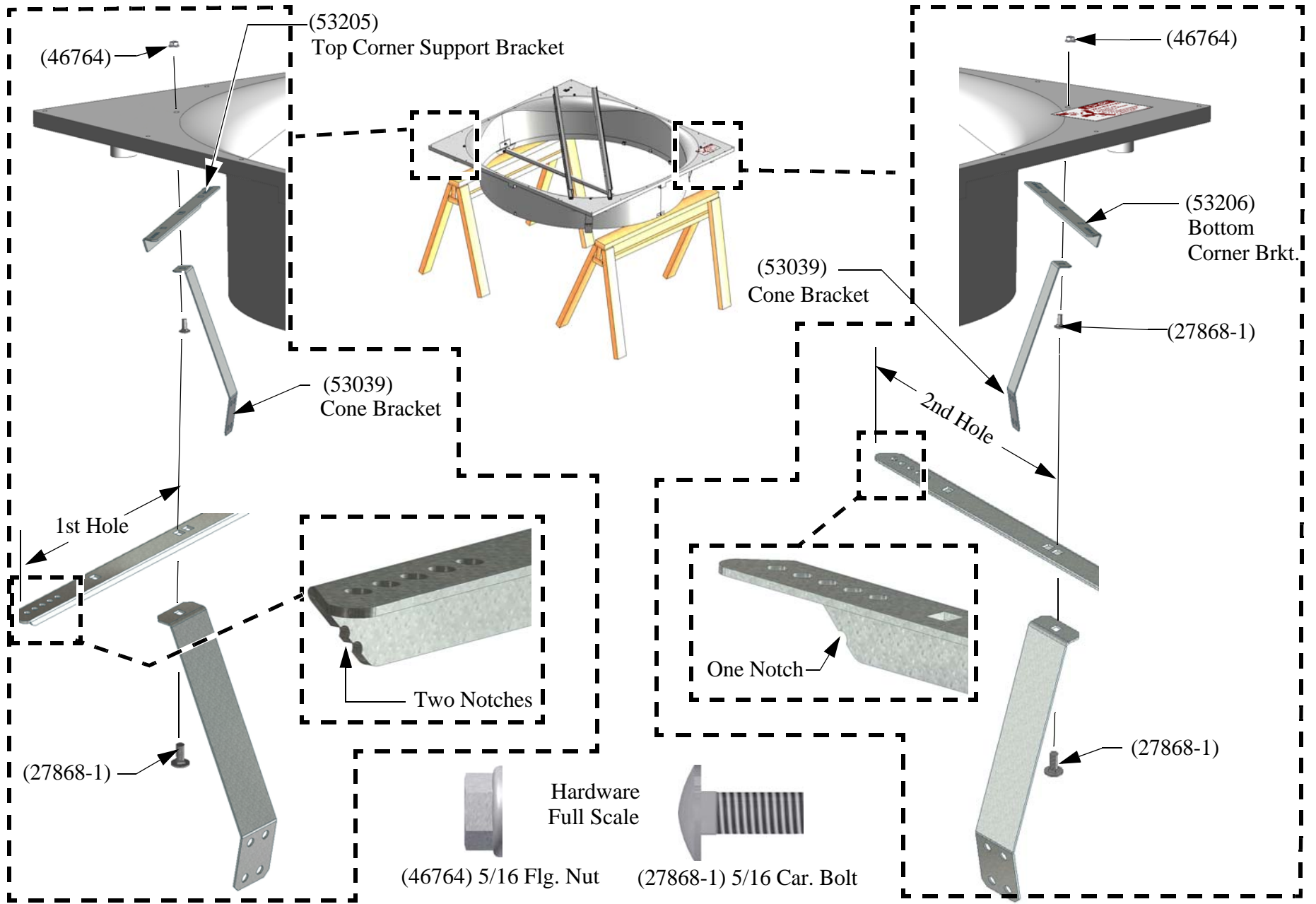



## Installing the Drive Assembly and Motor Mount

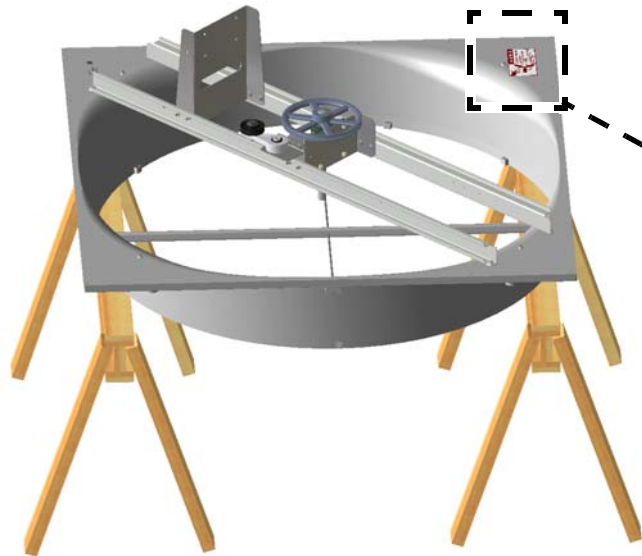

Apply a Fan Description Decal to the Shroud as shown. (Included in Parts Package)

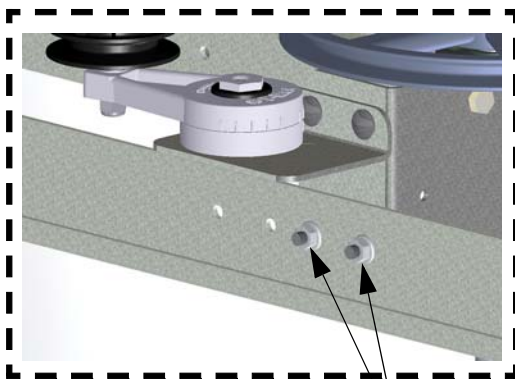
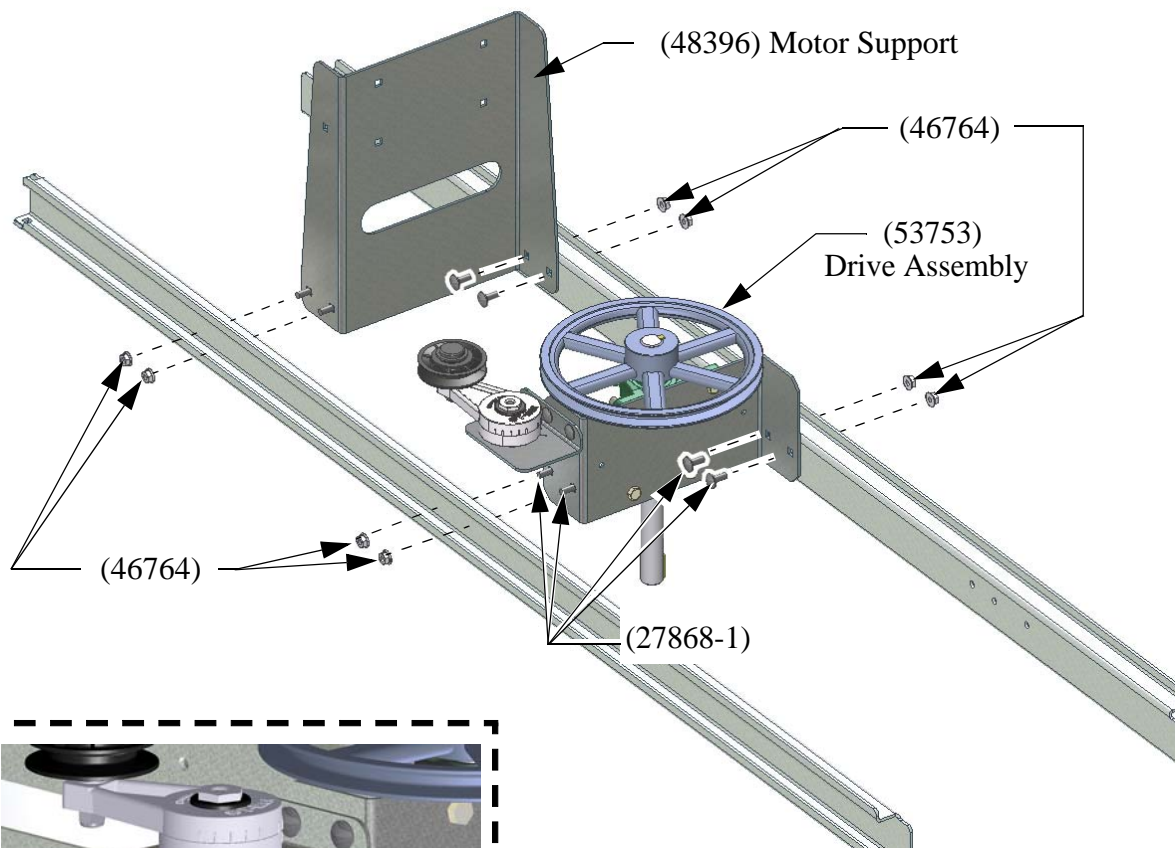

Use the Bottom Set of Holes in the Posts as shown.



(46764) 5/16 Flg. Nut

Hardware  
Full Scale



(27868-1) 5/16 Car. Bolt

## Top and Bottom Pivot Plates and Eyebolt, Door Stop Cable

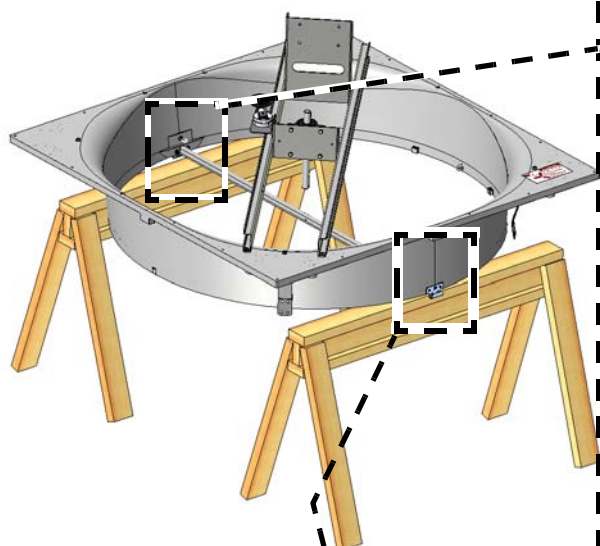

(53037)  
Top Pivot Plate

(46764)

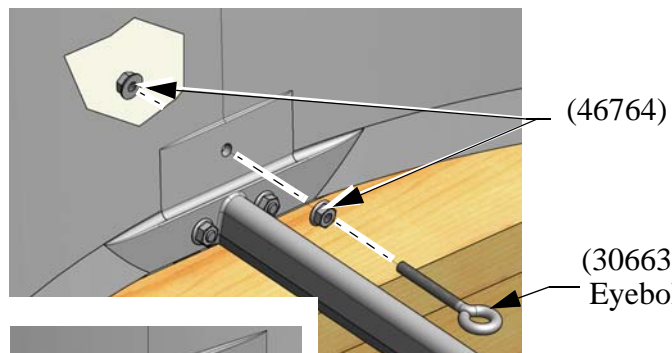
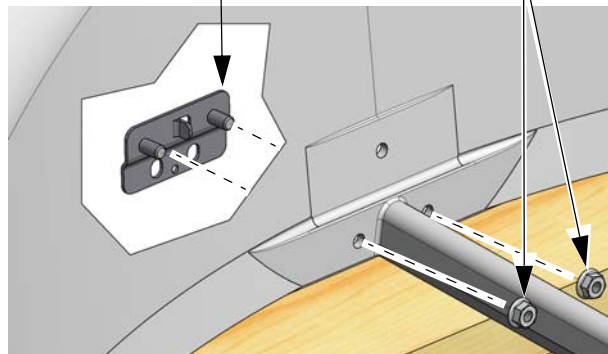

(46764)  
(30663)  
Eyebolt

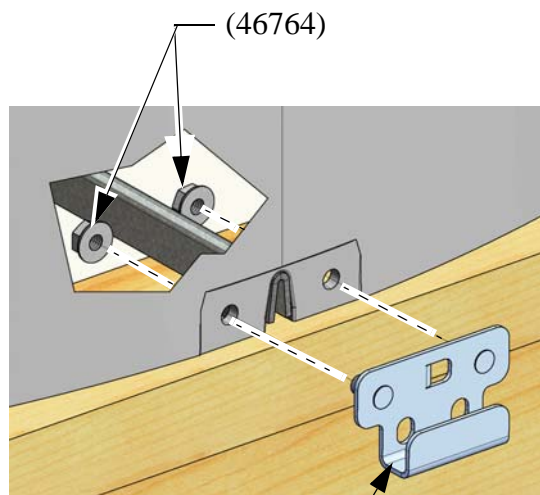

(53036)  
Bottom Pivot Plate



Insert (53399) Door Stop Cable  
Assembly into Top Pivot Plate



(46764) 5/16 Flg. Nut

## Bottom Shelf Installation

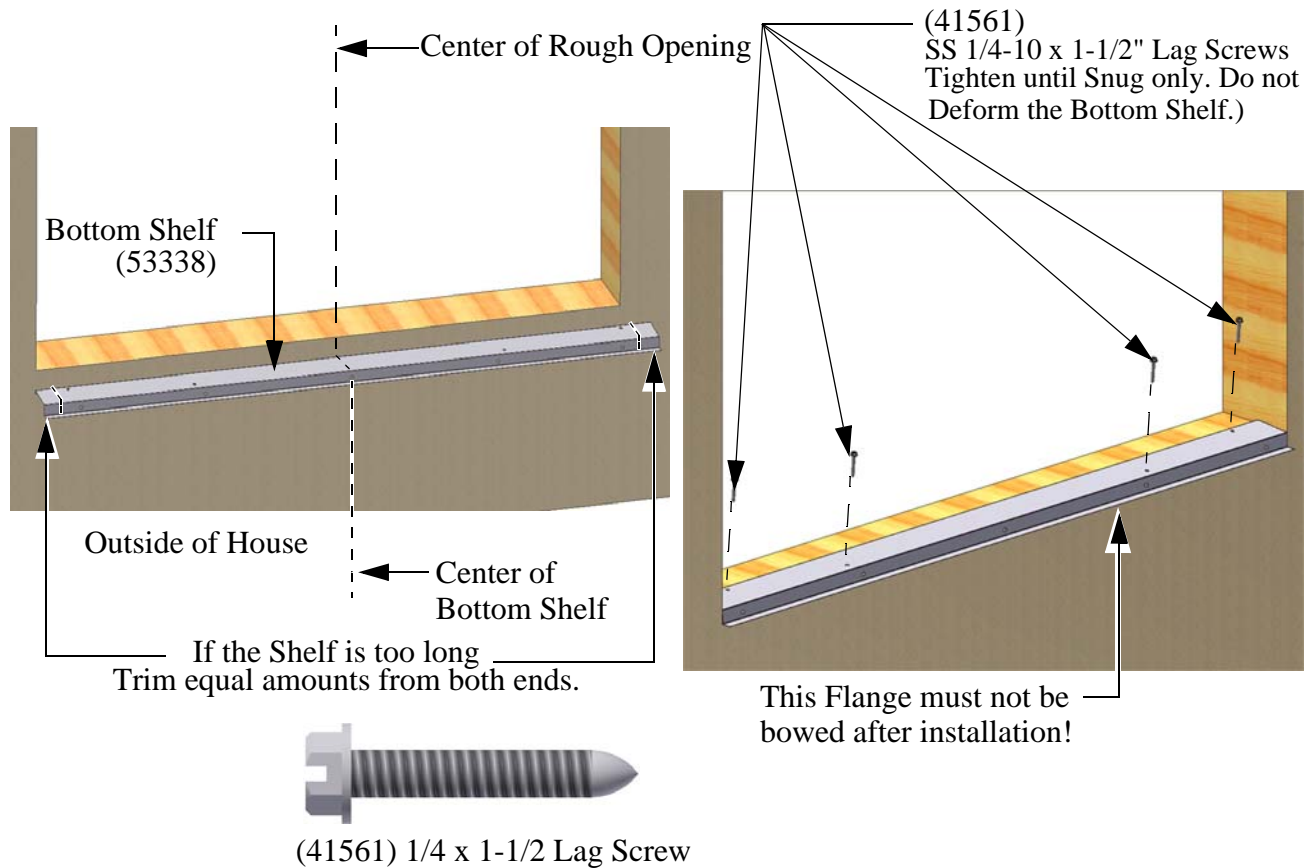

## Attaching the Fan to the Wall

Eyebolt indicates the  
**Top** of the Fan.

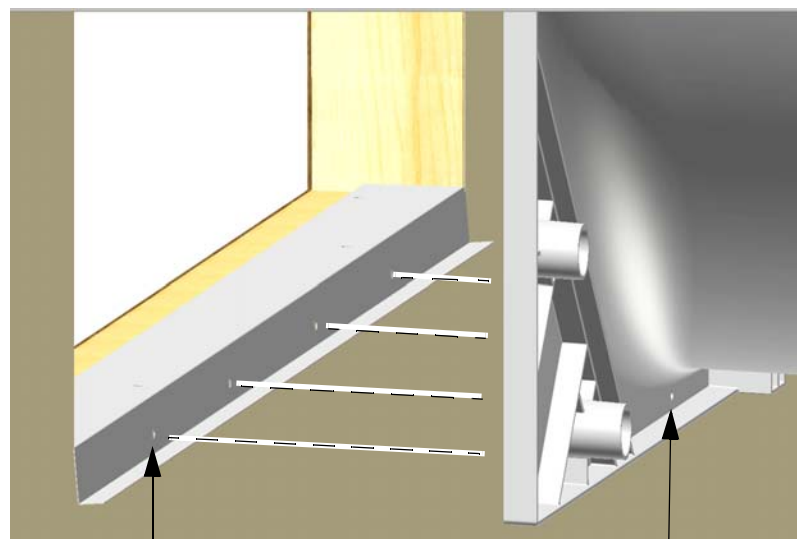

It is important when attaching the Fan to the Wall to keep edges of Shroud straight.

Keep Edges of Shroud Straight. **Do not** allow Shroud to bow inward.

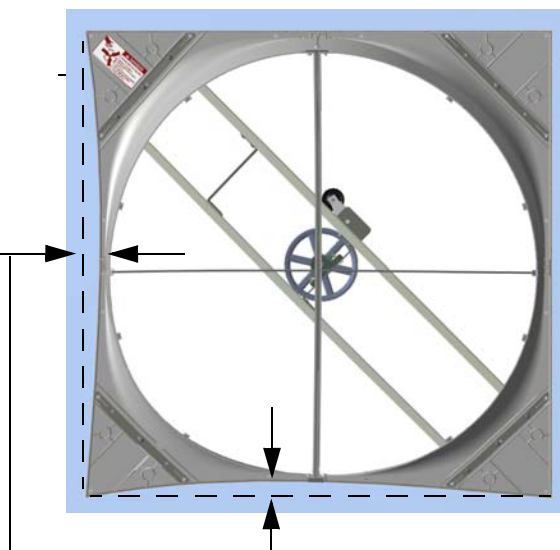

Pre-drill holes to 3/16" [4.8 mm] to avoid splitting lumber. If holes do not line up with the lumber it may be necessary to put Screws through Shroud. **Important!** Attach the Fan to the Wall with 1/4 x 1-1/2" Lag Screws (41561) in the specific order shown. Attach with a **total of 20 Lag Screws**.

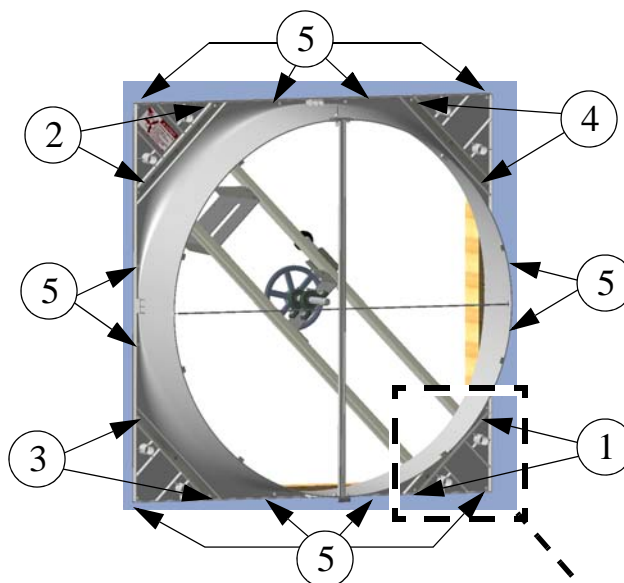

Use the Hole in the Corner Bracket that is centered with Lumber to avoid splitting.



(41561) 1/4 x 1-1/2 Lag Screw

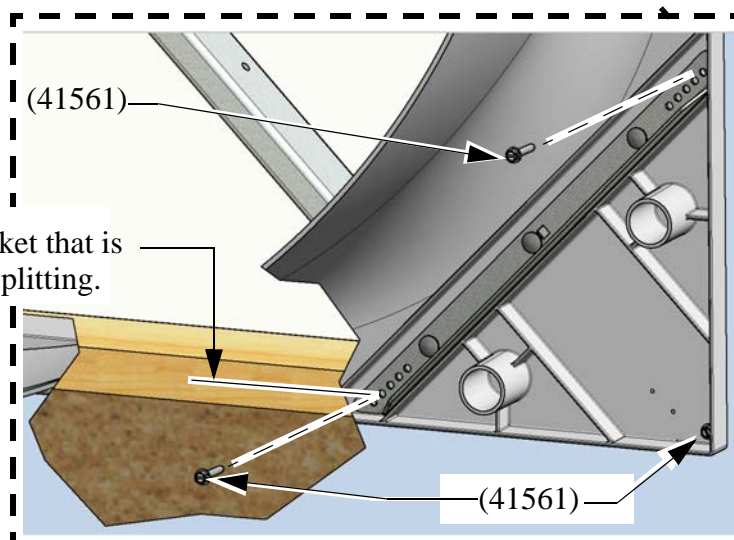



## Cone Assembly

Assemble Cone Panels as shown below.

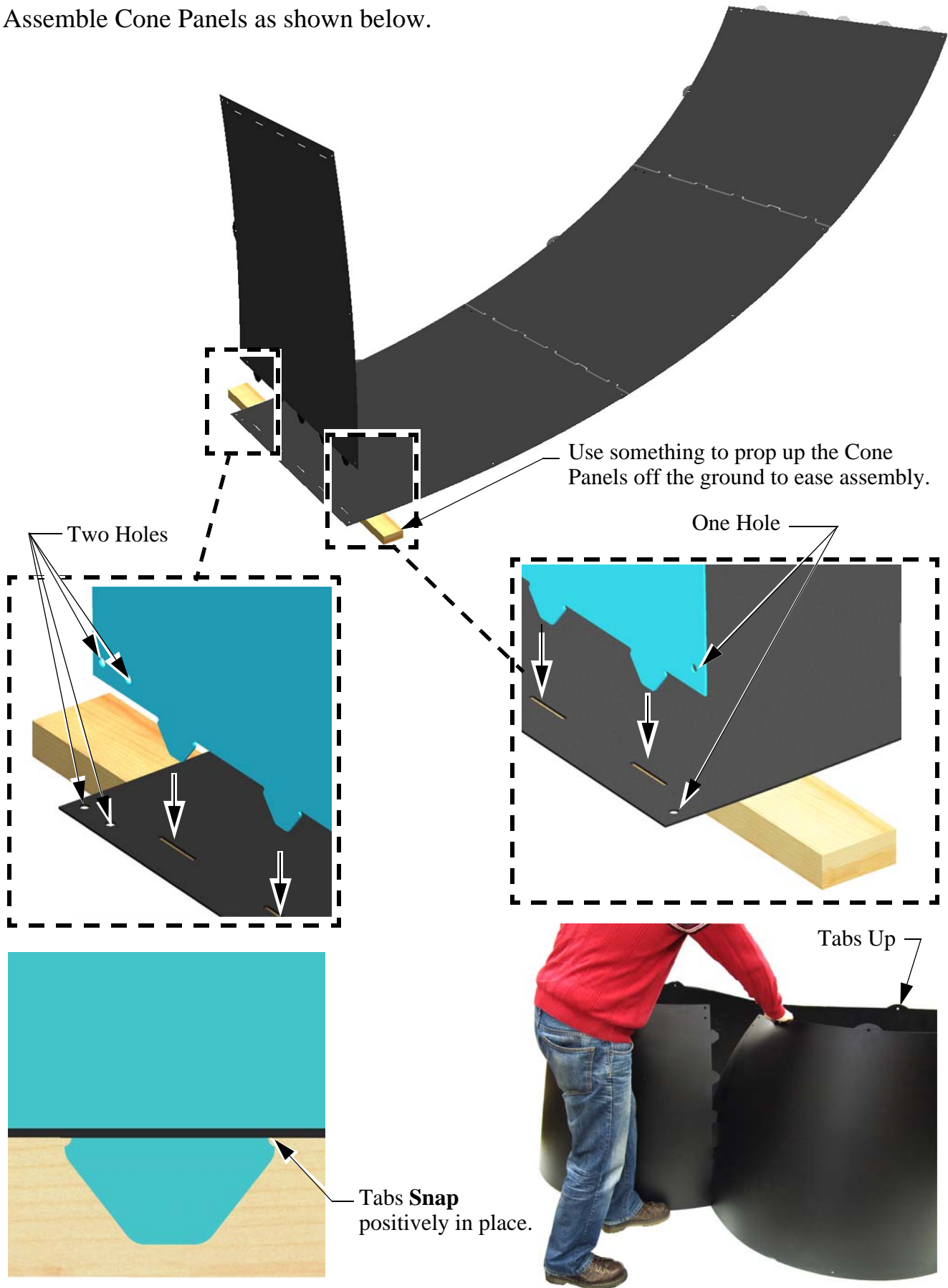

## Installing the Orifice Frame

Rounded Tab on the Cone

Important! Line up the Seam in the Orifice Frame with one of the rounded Tabs on the Cone.

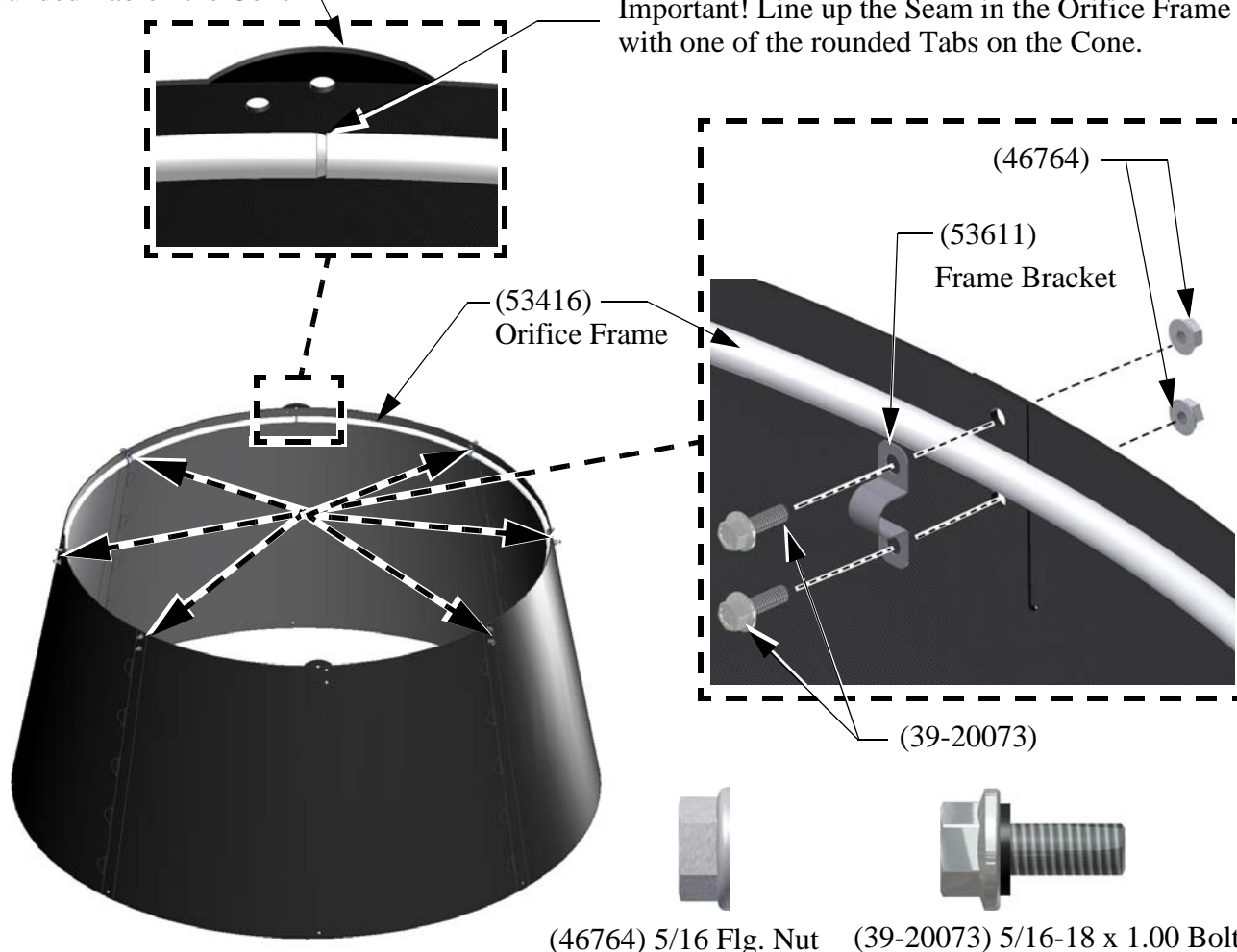

## Cone Installation

Hang the Cone on the Eye-Bolt extruding from the top of the Shroud using the hole in the Cone as shown.

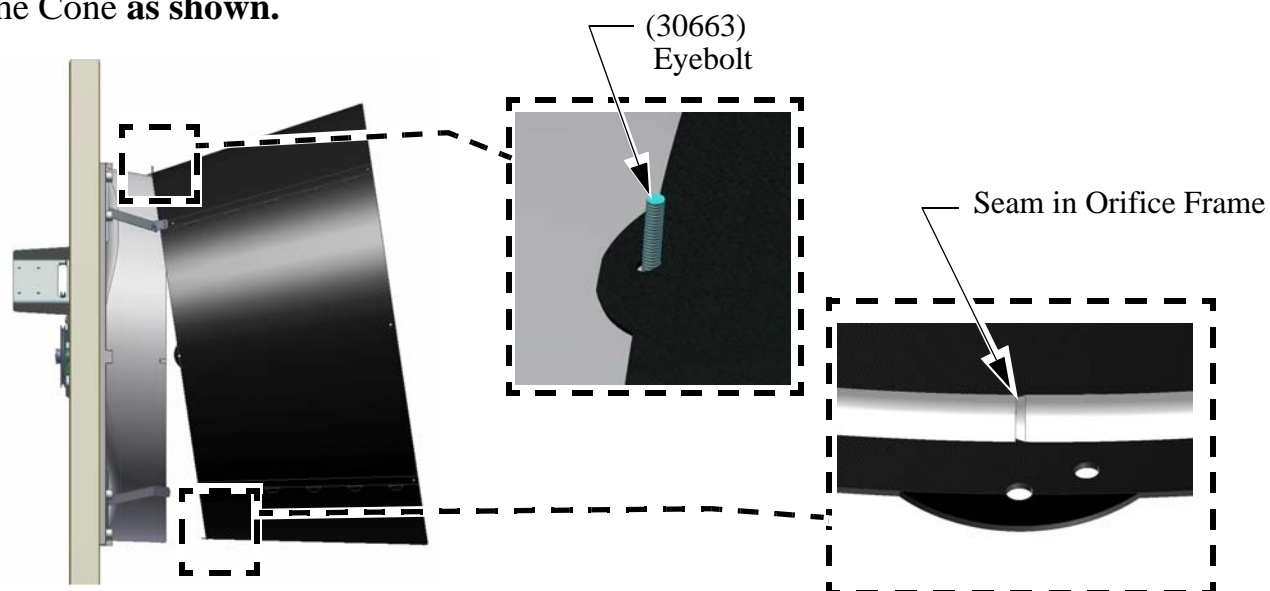



Attach the cone to the Shroud as shown below.

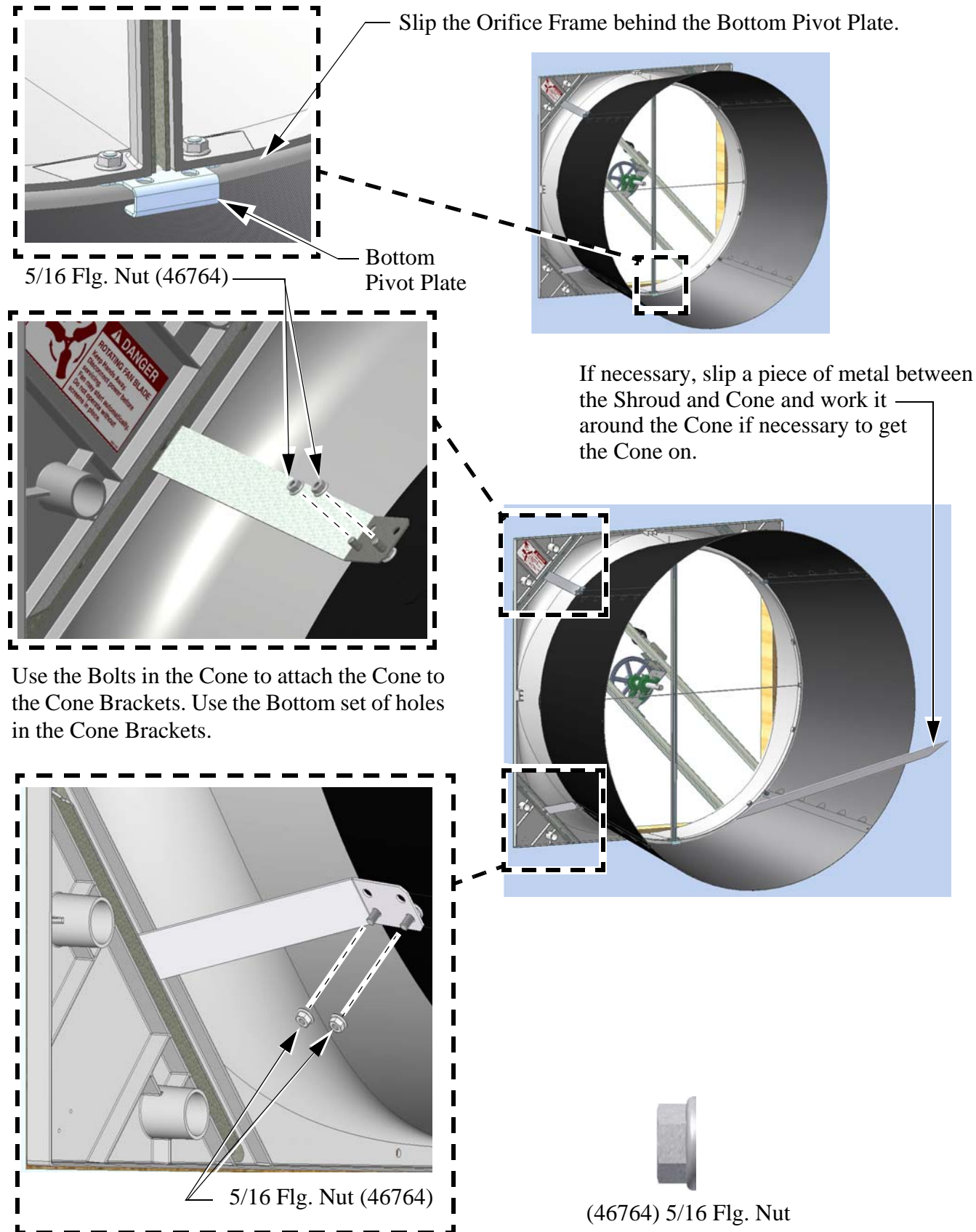

## Door Assembly and Installation

Insert Door Pins in both Doors as shown.  
Push Pins in until they bottom out.

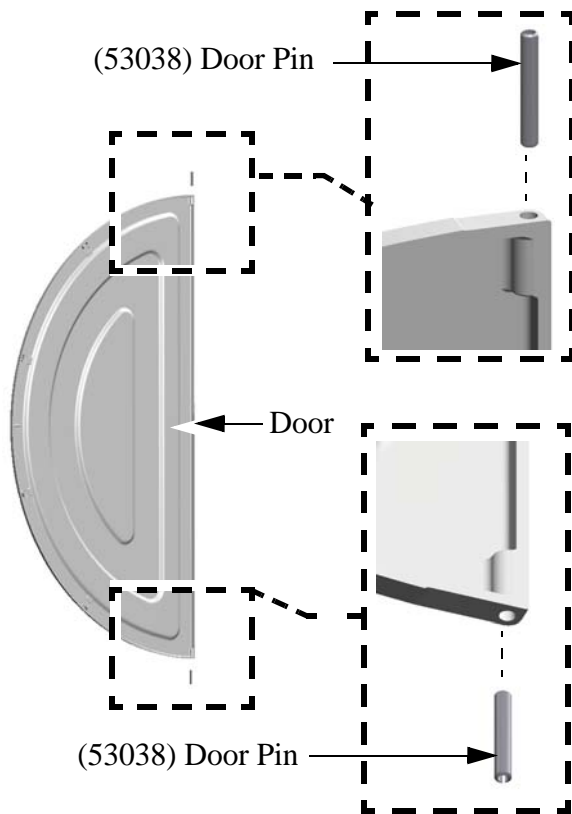

Doors are Left and Right specific.

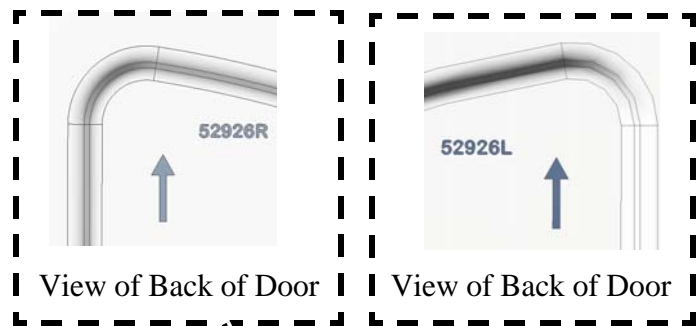

Insert Door Pins into Bottom Pivot Plate.

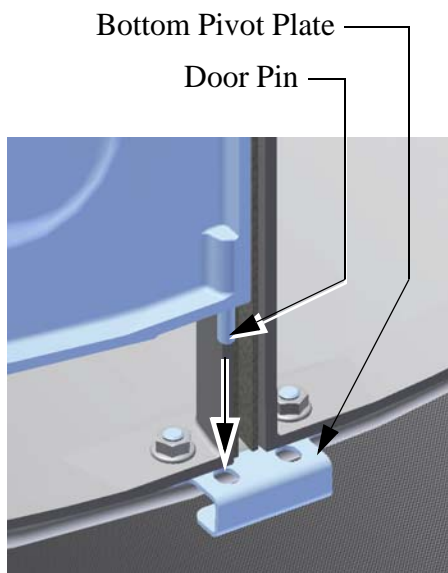

Grab the Door in the Center, Bow the Door, and insert the Top Door Pin into the Top Pivot Bracket as shown.  
**Do not Overbow the Doors!**



Top Pivot Plate

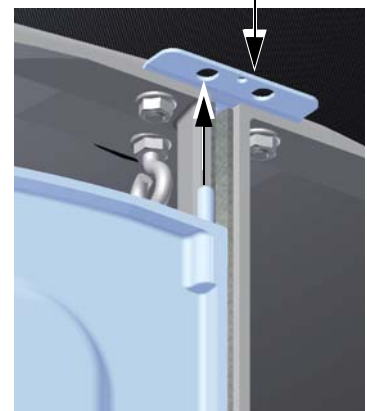

## Grill Installation

Install the Fan Cone Grill (as shown). Attach the end of the Door Stop Cable to the bottom Grill Leg as shown.

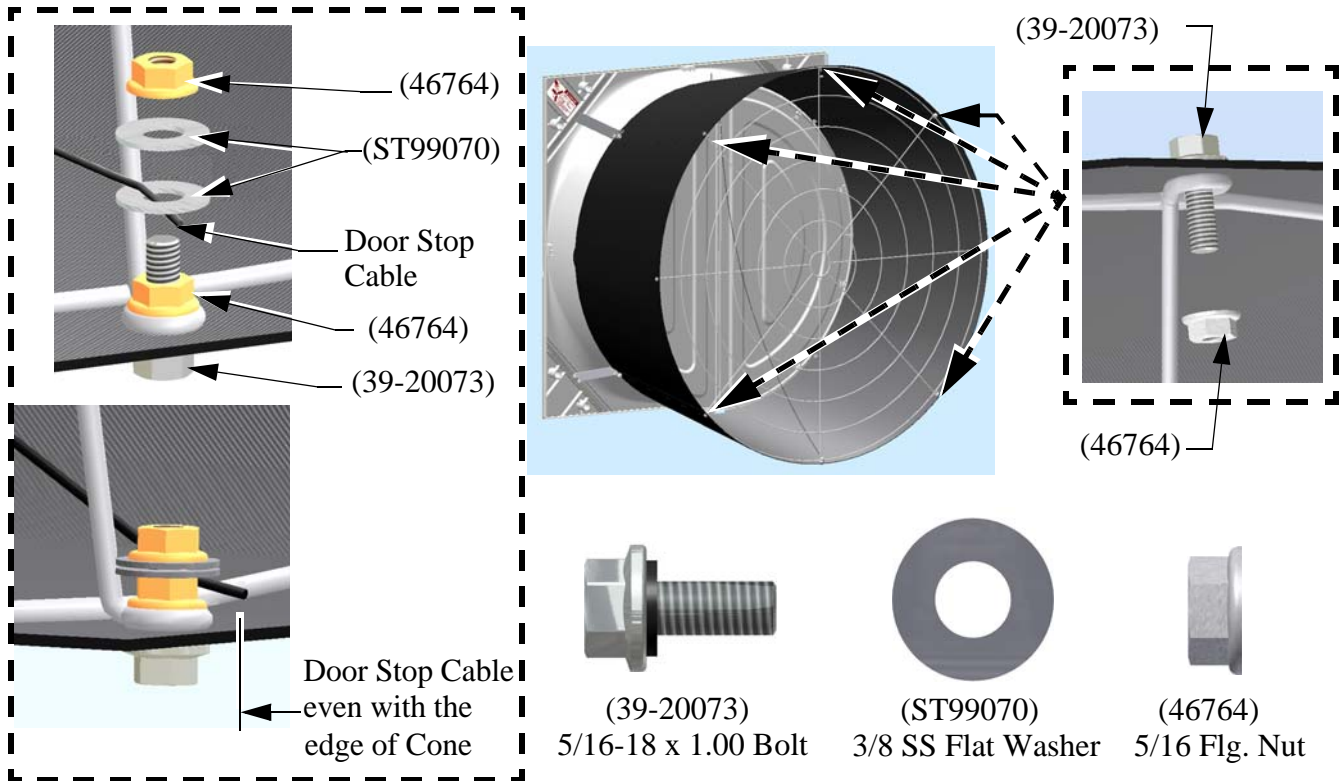

If it is desired to Mount Fans at the minimum spacing cutting the Grills is required as shown.

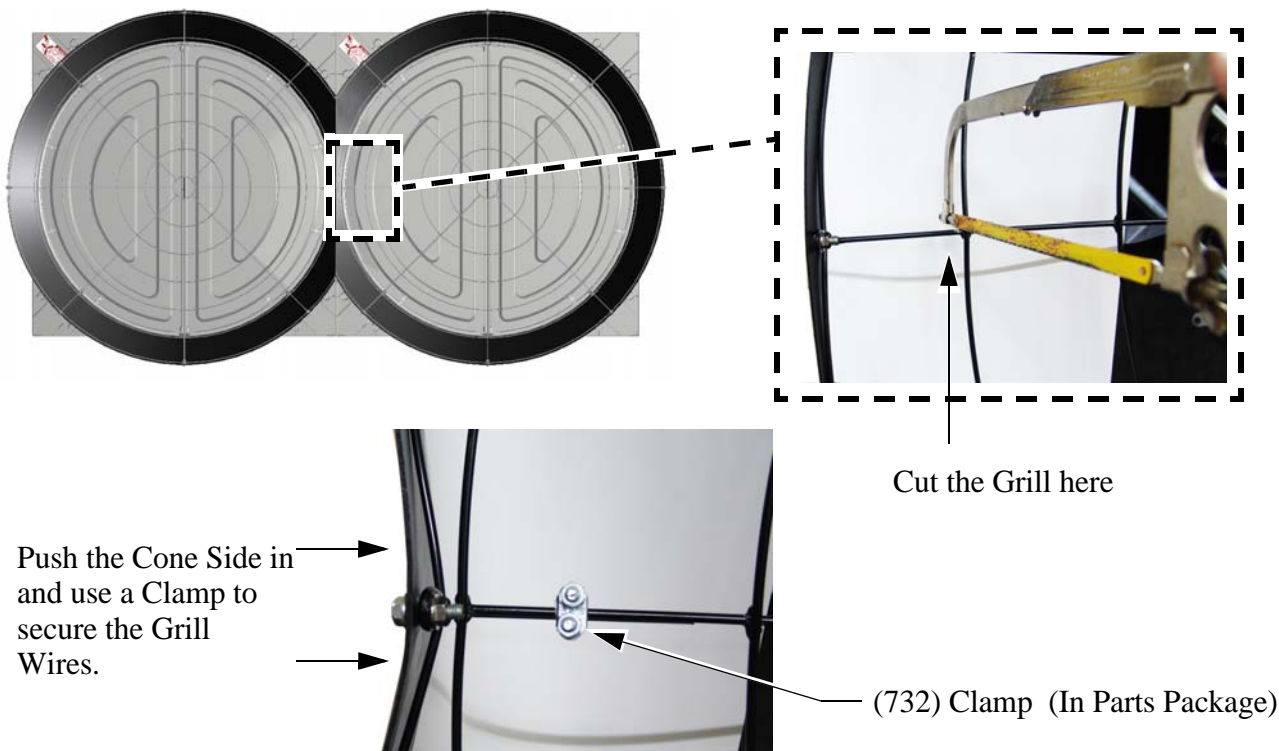

## Motor Installation

Attach Motor to Z-Bracket.

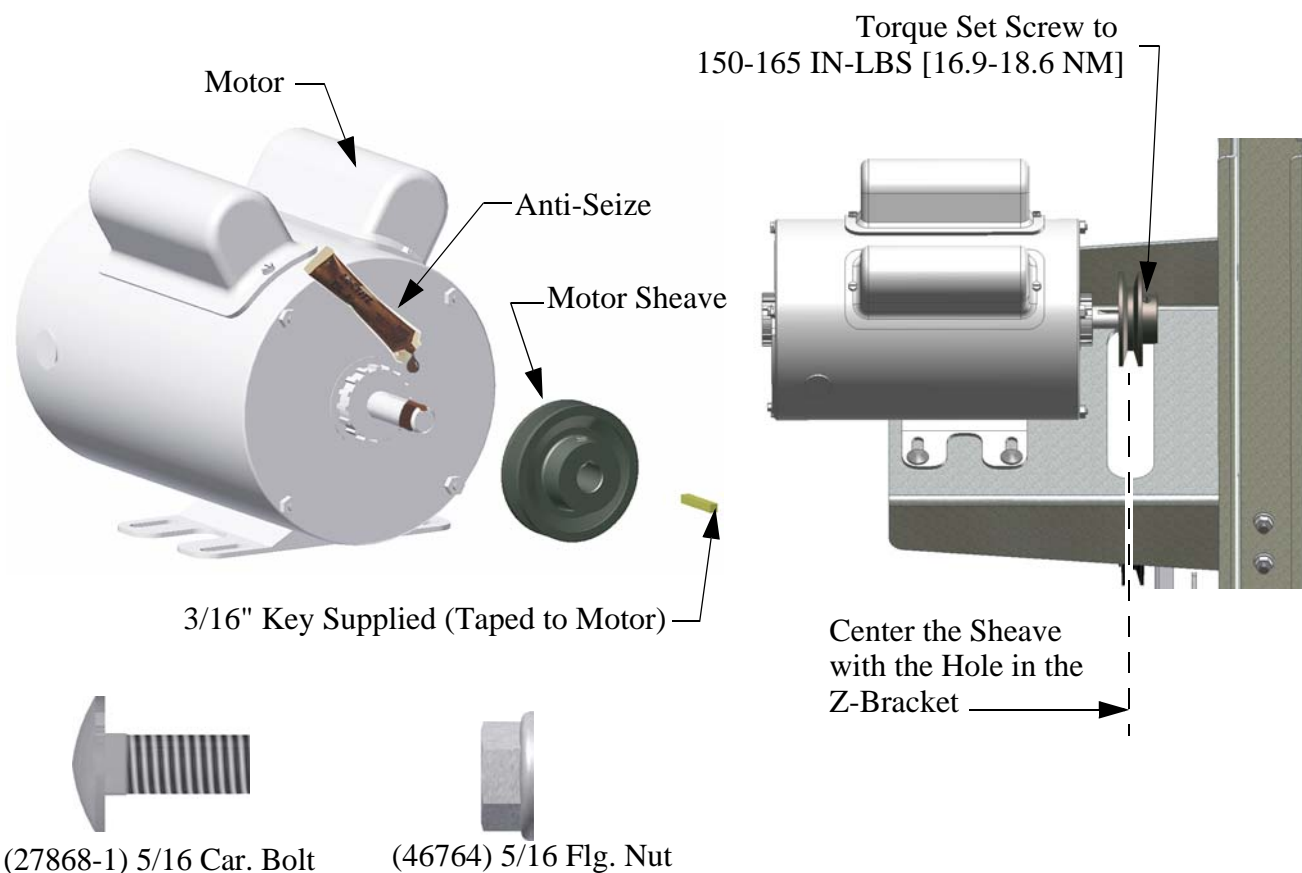
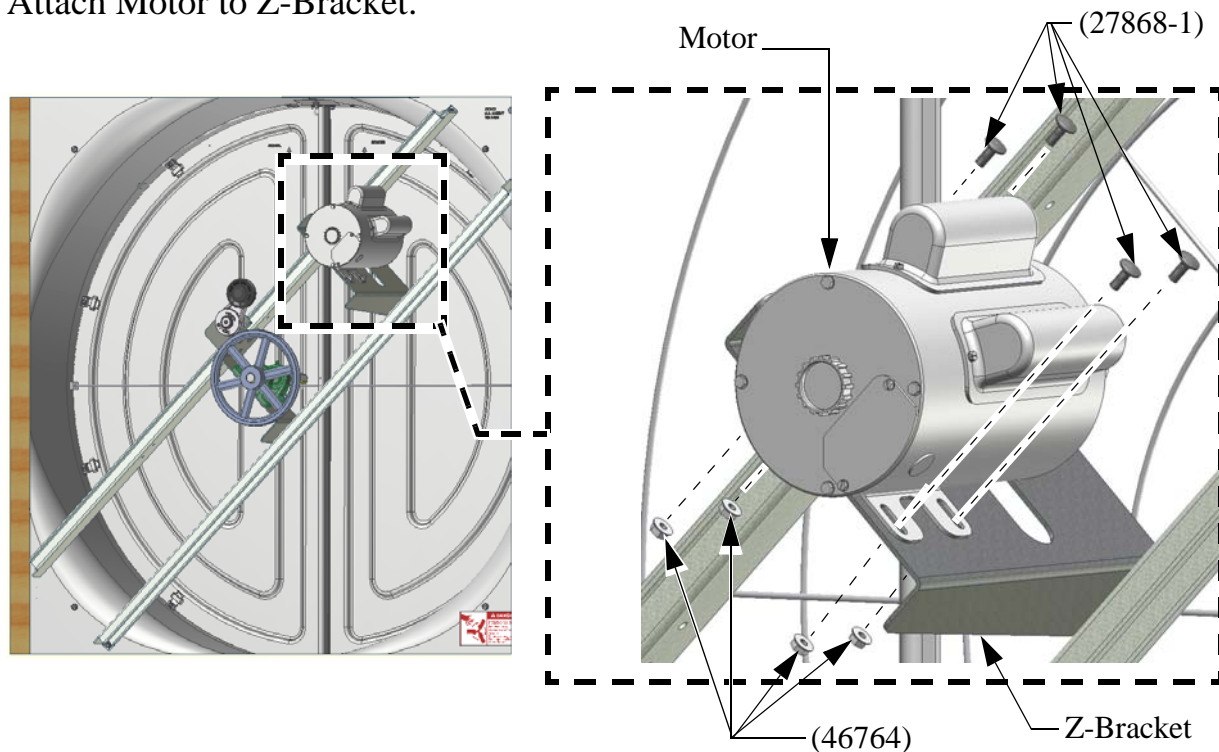



## Belt Installation

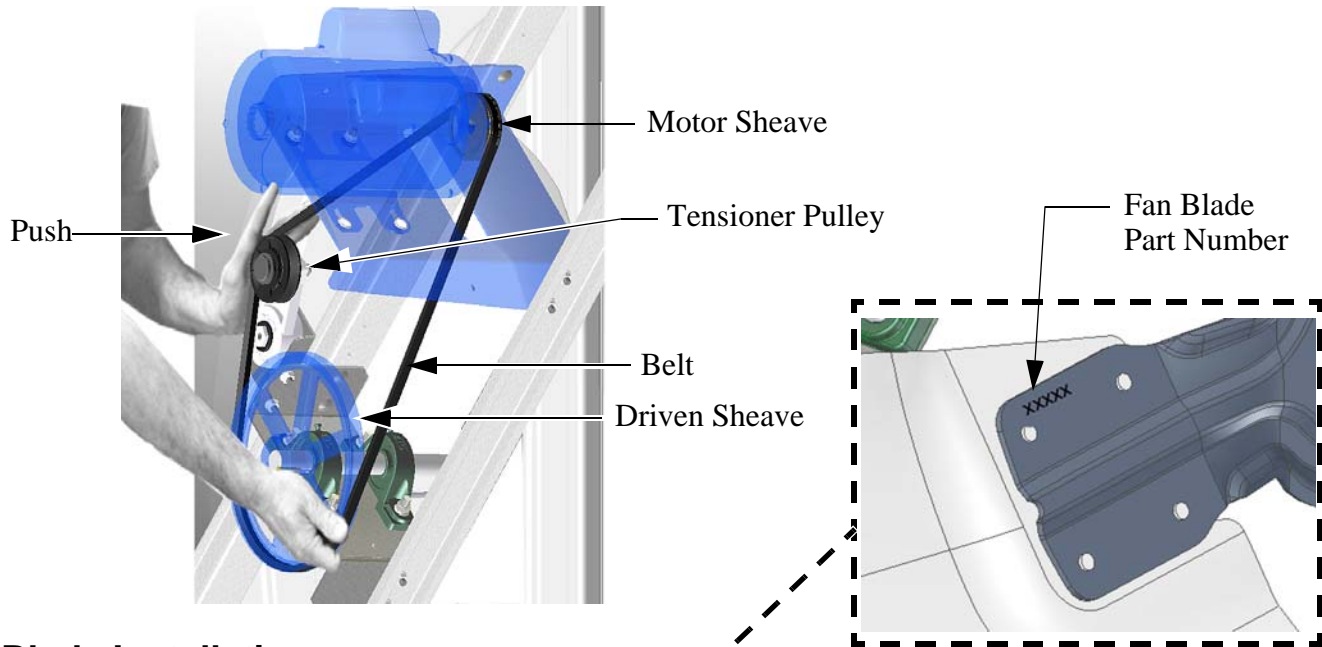

## Blade Installation

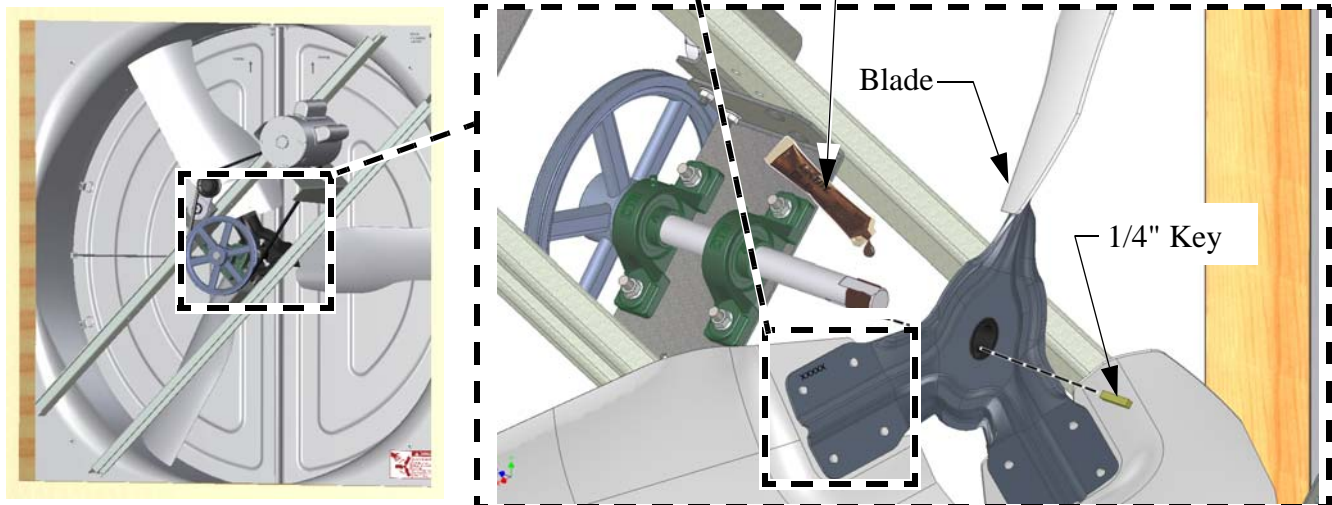

Fan Blade Flush  
with the End of Shaft.

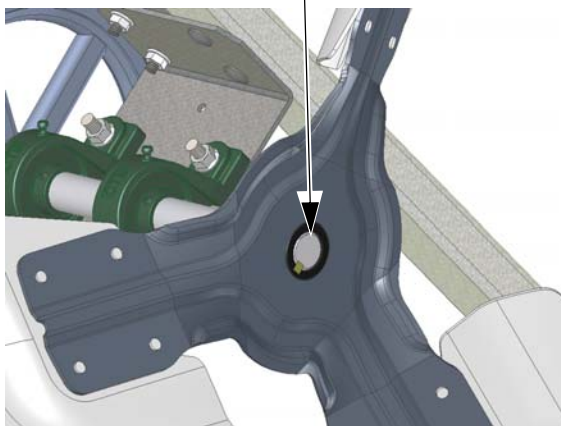

Torque Blade Set Screws  
to 290 - 300 IN LBS.  
[32.7-33.9 NM]

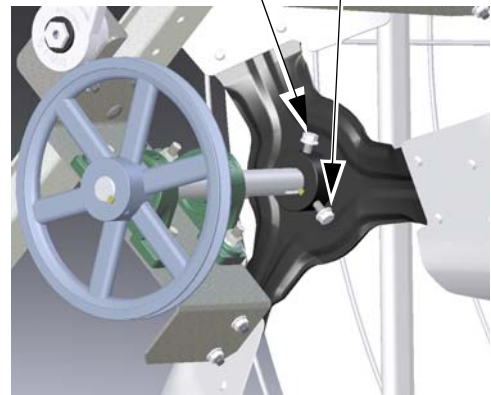

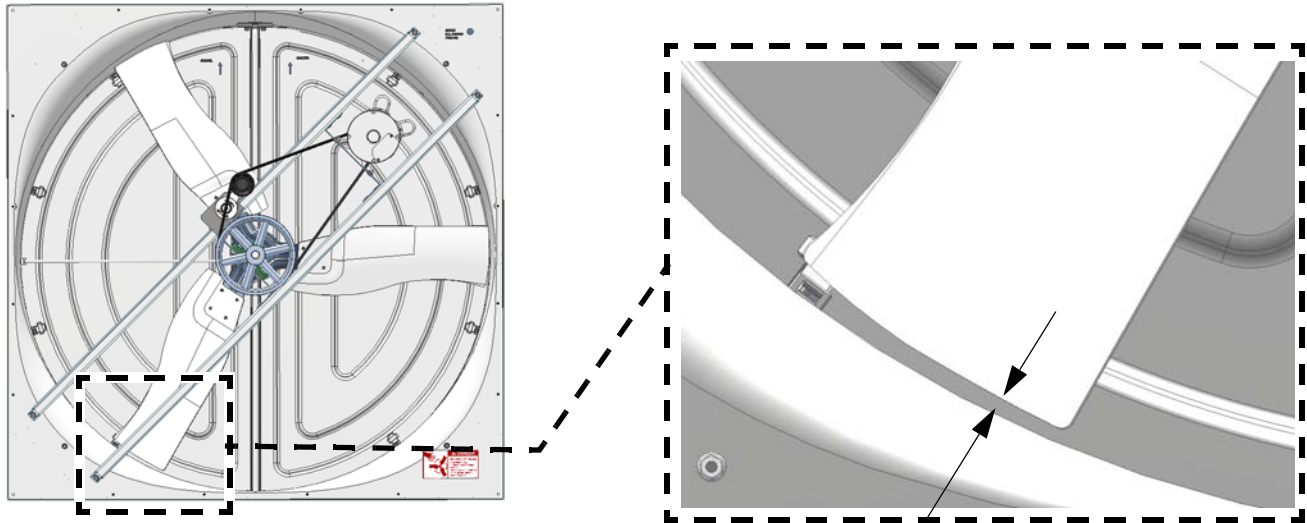

Spin the Blade by hand and check that there is minimum of  $\frac{1}{8}$ " [3 mm] Clearance from the Shroud all the way around orifice.

If Clearance is insufficient, check that the mounting surface is flat, and that the sides of the Shroud are straight. To Gain more Tip Clearance, remove the Lag Screws from the side with inadequate clearance, push out on the Shroud orifice and re-install Lag Screws in new holes.

## Door Spring Installation

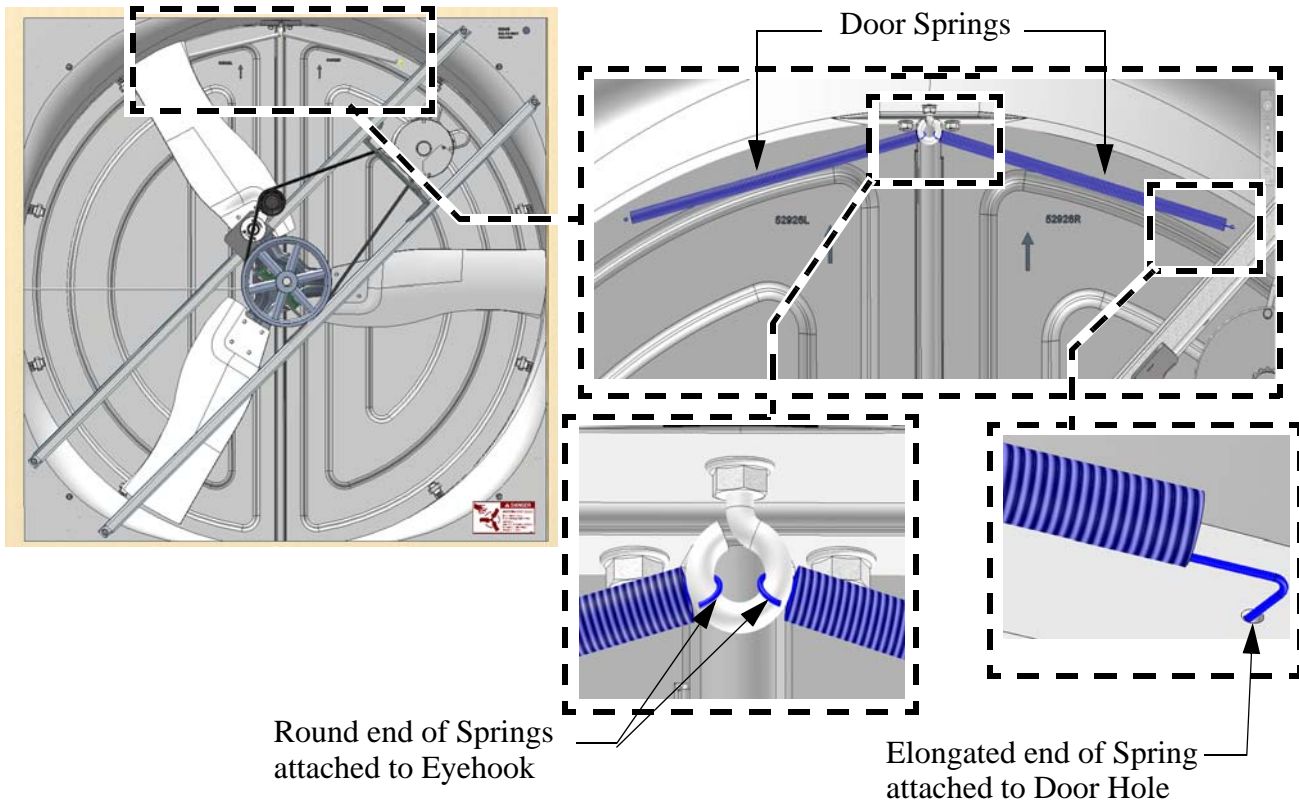



## Caulking

Caulk both Ends of the Bottom Shelf and as needed to fill any gaps between the Shroud and the Framed opening.

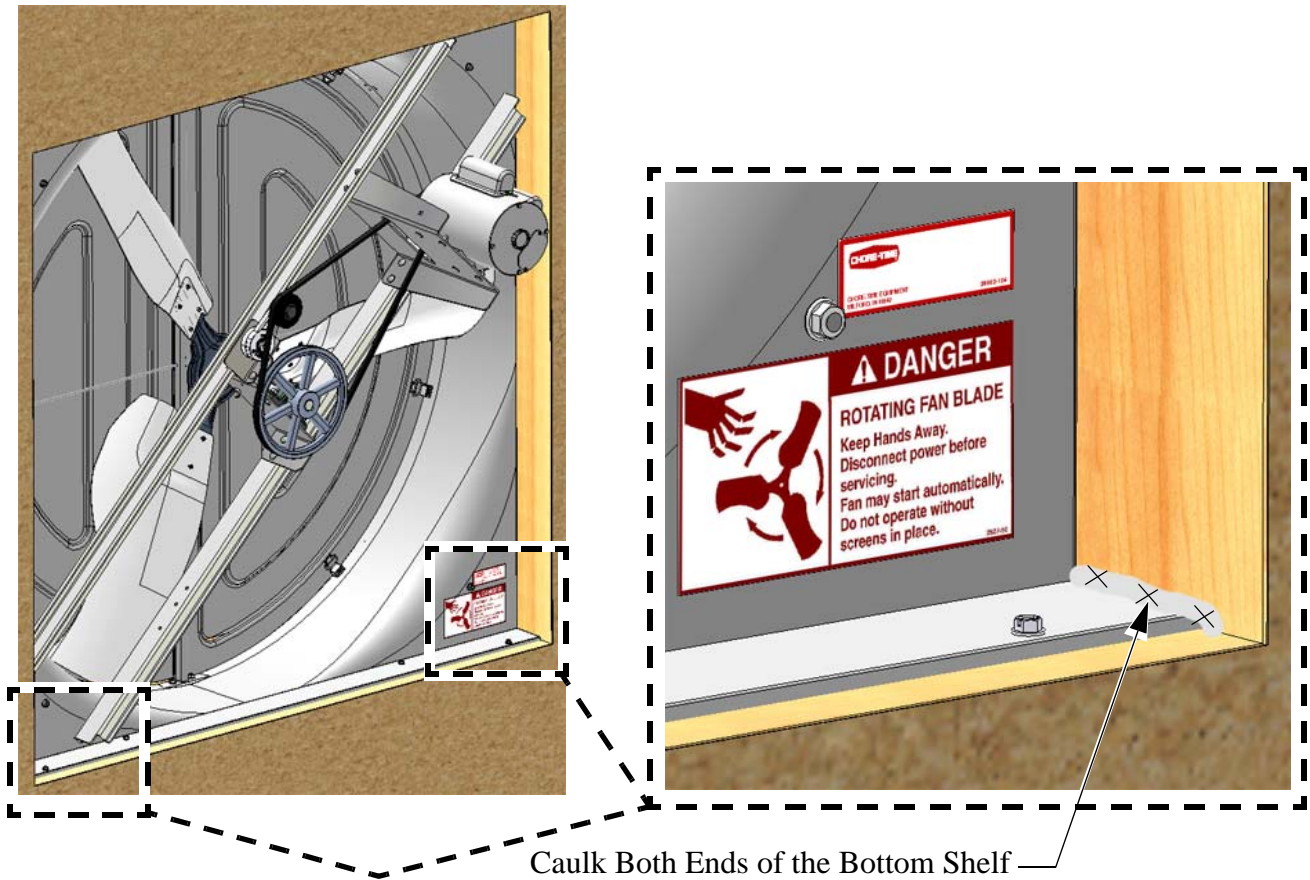

## Motor Wiring

1. Check that the electrical power being supplied to the Fan matches the electrical Specifications on the Fan and Motor Decals.
2. Remove the Motor Access Cover.
3. Install an electrical disconnect within reach of each Fan installed.
4. Connect the cord to the motor according to the wiring diagram on the motor. Verify that the motor is connected for counter clockwise rotation (viewing the back of the motor, opposite the shaft end.)
5. Follow local, state, and national electrical codes for wiring.
6. Attach the Cord to the Wall using a Screwhook **as shown**. Allow enough slack in the cord to form a "drip loop" for moisture to fall away from the cord and not into the motor.

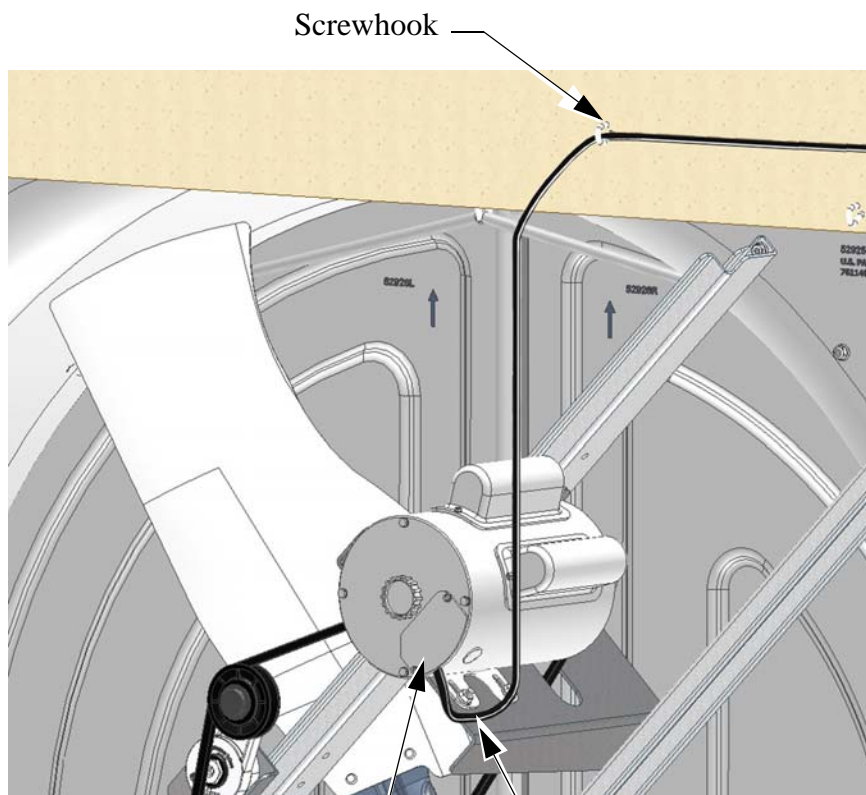

Motor Access Cover — Drip Loop

## Screen Assembly and Installation

Use two Nylon Cable Ties per Corner in the locations **shown below**. Trim off excess Cable tie. (**Cable ties shown before being cut off for clarity**).

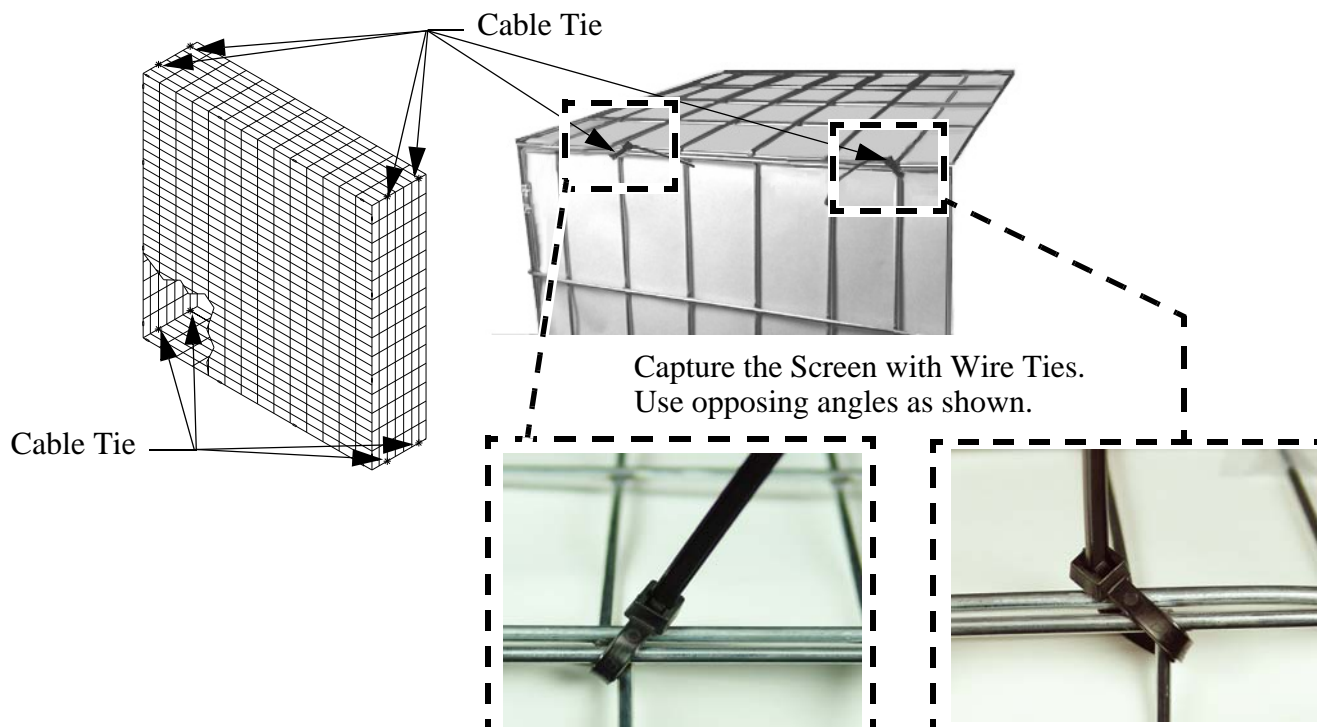

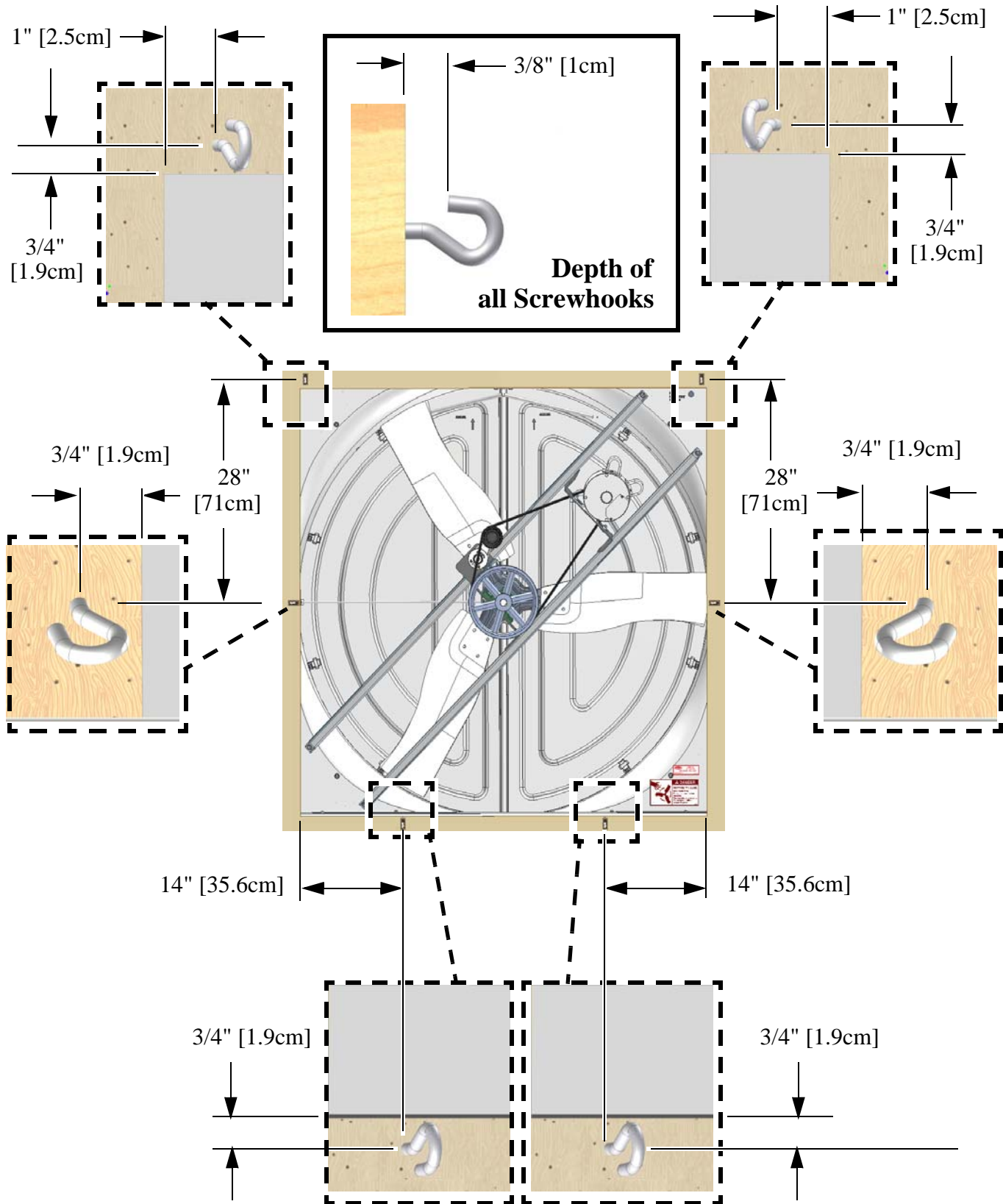

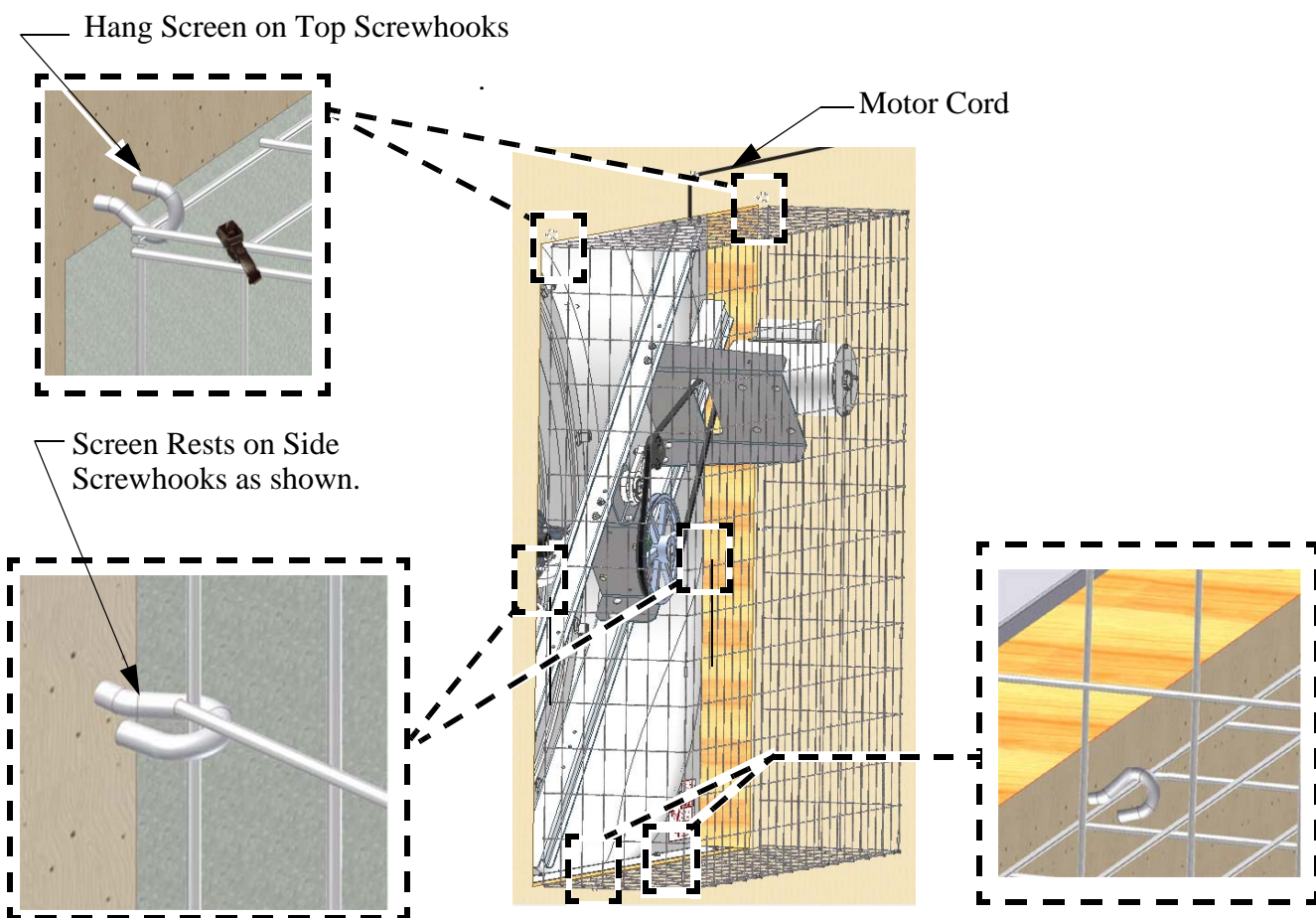



## Test Fan for proper operation.

Plug the Fan in and test for proper operation

## Maintenance

**IMPORTANT!** Disconnect Power Prior To Maintaining Or Cleaning The Fan. The fan may start automatically causing serious injury or death.

- Service and repair of fans should be done only by a qualified technician.
- Minimize contact of moisture or corrosive chemicals to the surfaces of the fan components to maximize fan life.
- After washing fans, operate fans long enough to remove moisture from all fan surfaces.
- Keep the fan clean for maximum life and best performance. **Do Not spray water on the Fan Shaft Bearings, the Belt Tensioner, or the Motor.**
- Periodically check the V-Belt and replace if necessary. A worn Belt will cause a substantial drop in Fan performance or it can break and cause Fan failure. If a Belt rides below the Sheave edge, replace the belt. (See below)

1747-054 04/03



**Good Belt**



**Bad Belt**

- Check Belt Tension. The Belt should be tensioned just tight enough to minimize Belt slippage. Over tensioning the belt will cause premature Belt and Bearing wear. With a new Belt the Idler Sheave indicator mark should line up with the Second notch in the Tensioner Housing as shown.

- The motor and Fan Shaft Bearings are pre-lubricated. Grease zerks are provided on the fan shaft bearings for installations where re-lubrication is needed. Add only a small amount of grease to purge impurities out of the bearing seals. Use only high quality lithium soap base grease and clean all dirt from zerk before applying grease. Chore-Time recommends using Shell Alvania # 2 in the fan shaft bearings.
- Check Sheaves for wear. Replace if a Sheave groove is worn.

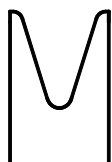
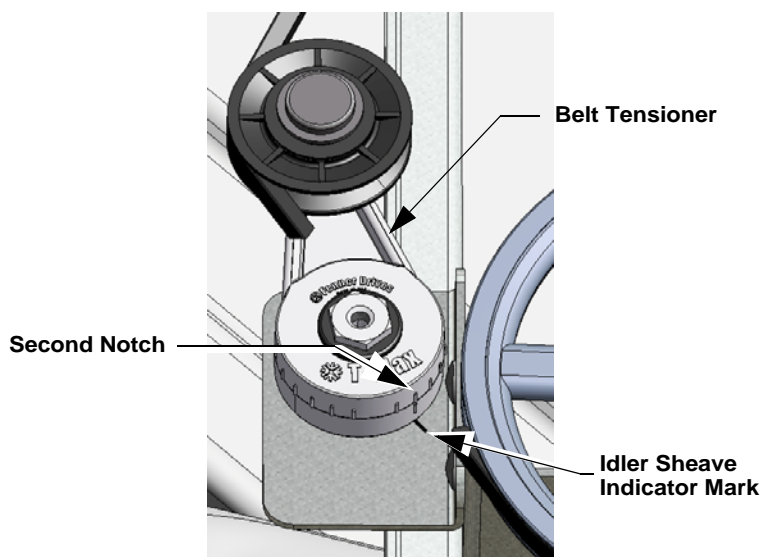

**Good Sheave**

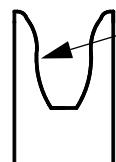

1747-053 04/03

**Bad Sheave**

# Part Numbers (Itemized)

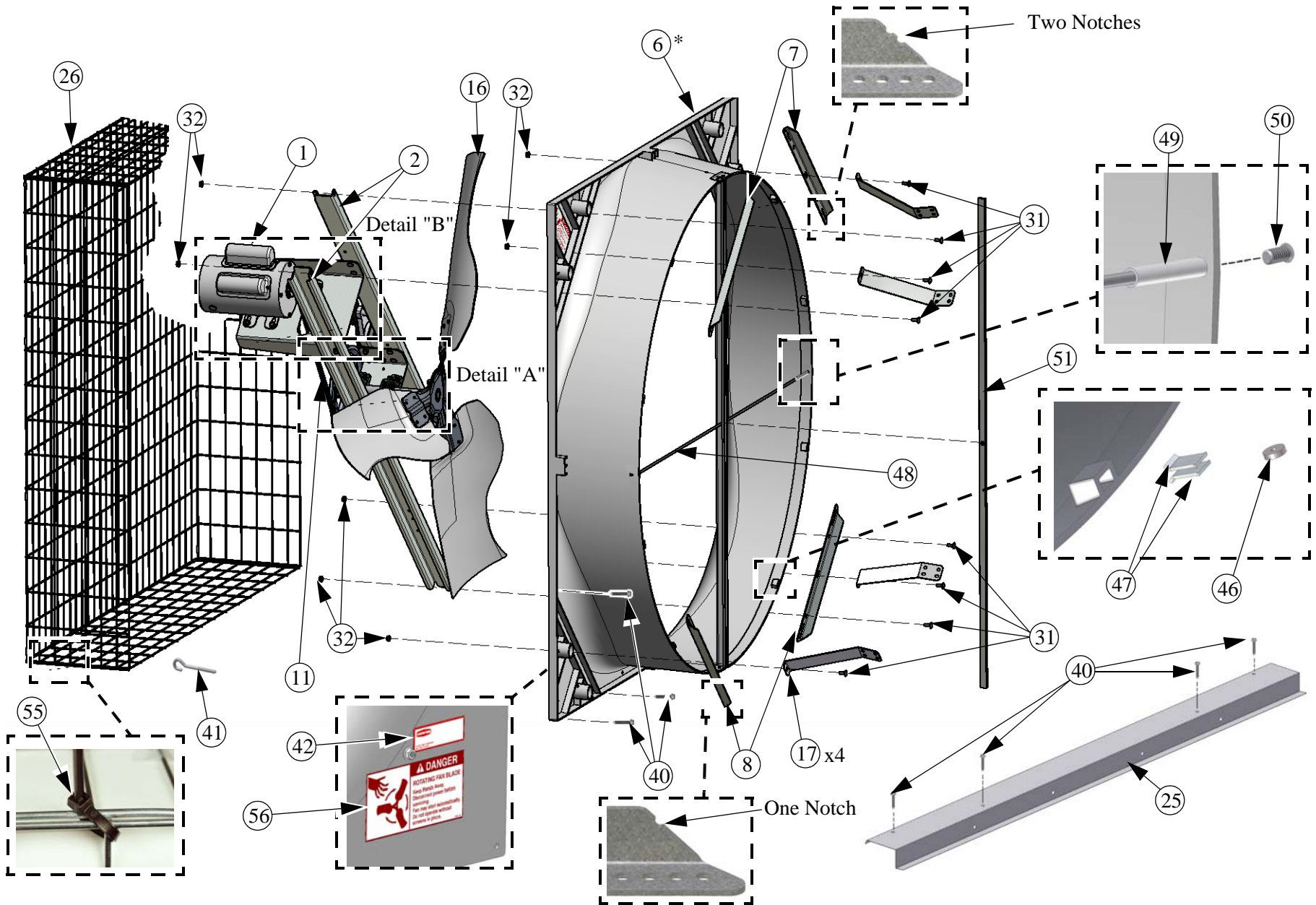



# Part Numbers

MM2406A

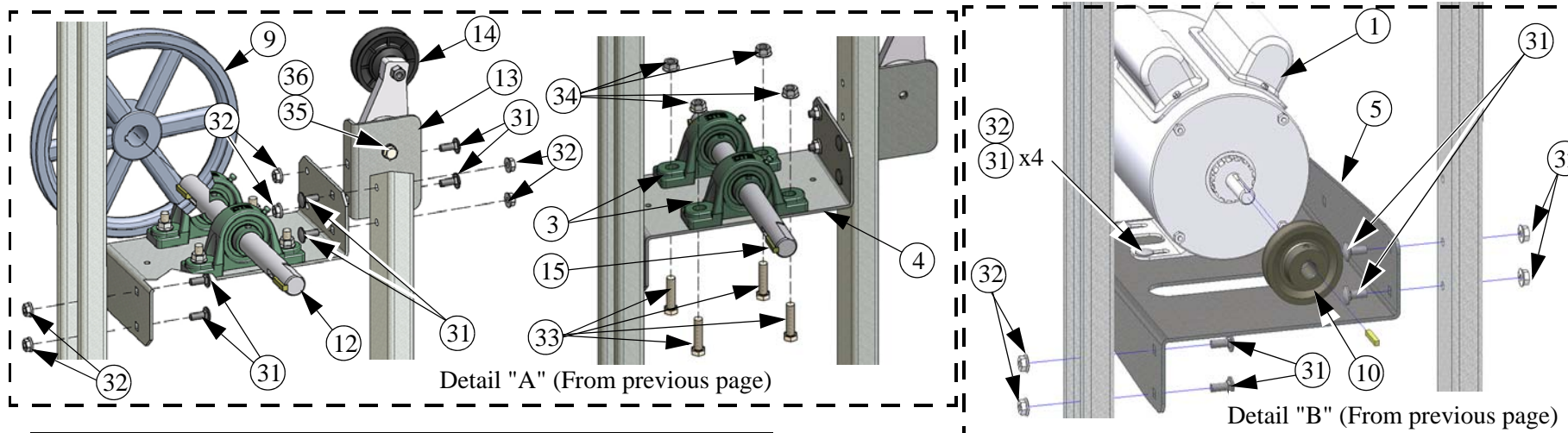

## 57" Endura® Fan Part Numbers 53464-XX

Item	Qty.	Description	Part No.	Models
1	1	Motor, 1.5H 1PH-60HZ-230V	49903	-22
		Motor, 1.5H 3PH-60/50HZ-200/380-460V	48608	-41,-42,-51,-52
		Motor, 1.5H 1PH-60HZ-230V	50496	-21
2	2	57" Fan Post	53204	All
3	2	1" Pillow Block Bearing	50553	All
4	1	Idler Drive Bearing Support	48395	All
5	1	Idler Drive Motor Support	48396	All
*6	1	57" Fan Shroud Assembly	52925	All
7	2	Upper Corner Support (2 Notches)	53205	All
8	2	Lower Corner Support (1 Notch)	53206	All
9	1	AK99 x 1.00" Bore Driven Sheave	53535	-21,-22,-41,-42
		AK94 x 1.00" Bore Driven Sheave	40274	-51,-52
10	1	AK30 3" O.D. x 5/8 Bore Motor Sheave	8773	-21,-22,-41,-42
		AK34	37919	-51,-52
11	1	AX60 V-Belt	48541	All
12	1	1" x 11.97" Fan Shaft	52083	All
13	1	Tensioner Support	48394	All
14	1	Tensioner Assembly 3.5" Arm 3" Dia.	48429	All
15	2	1/4" Sq. 1.13" Key	2419-2	All
16	1	57" Galv. High Capacity Fan Blade	53219	-21,-41,-51
		57" Galv. E. Efficiency Fan Blade	53532	-22,-42,-52

Item	Qty.	Description	Part No.	Models
17	4	Cone Bracket	53039	All
25	1	57" Fan Support Shelf	53338	All
26	1	56 x 56 x 12.35 Inlet Screen	48794	All
31	22	5/16-18 x .75 SS Carriage Bolt	27868-1	All
32	57	5/16-18 Hx. Serrated SS Flange Nut	46764	All
33	4	3/8-16 x 1.50 SS HH Bolt	4413-10	All
34	4	3/8-16 SS Serrated Flange Nut	50191	All
35	1	3/8-16 x .75 SS Hx. Bolt	ST99277	All
36	1	3/8 SS Lock Washer	ST99780	All
40	24	1/4-10 x 1-1/2 Lag Screw SS	41561	All
41	9	Open Eye Hook	1214	All
42	1	Fan Decal	39002-XXX	All
46	4	.125 x .50 Magnet	48427	All
47	8	Magnet Side Plate	53026	All
*48	1	57" Fan Cross Rod	53398	All
*49	2	57" Fan Cross Rod Coupler	53896	All
50	2	1/4-20 x 1/2 Press Stud	7791-3	All
*51	1	57" Center V-Post	53626	All
55	9	Cable Tie	48103	All
*56	2	Fan Danger Decal	2527-50	All

\* Fan Shroud Assembly (Item 6) Includes items 48,49,50,51, and 56

# Part Numbers Itemized (Continued)

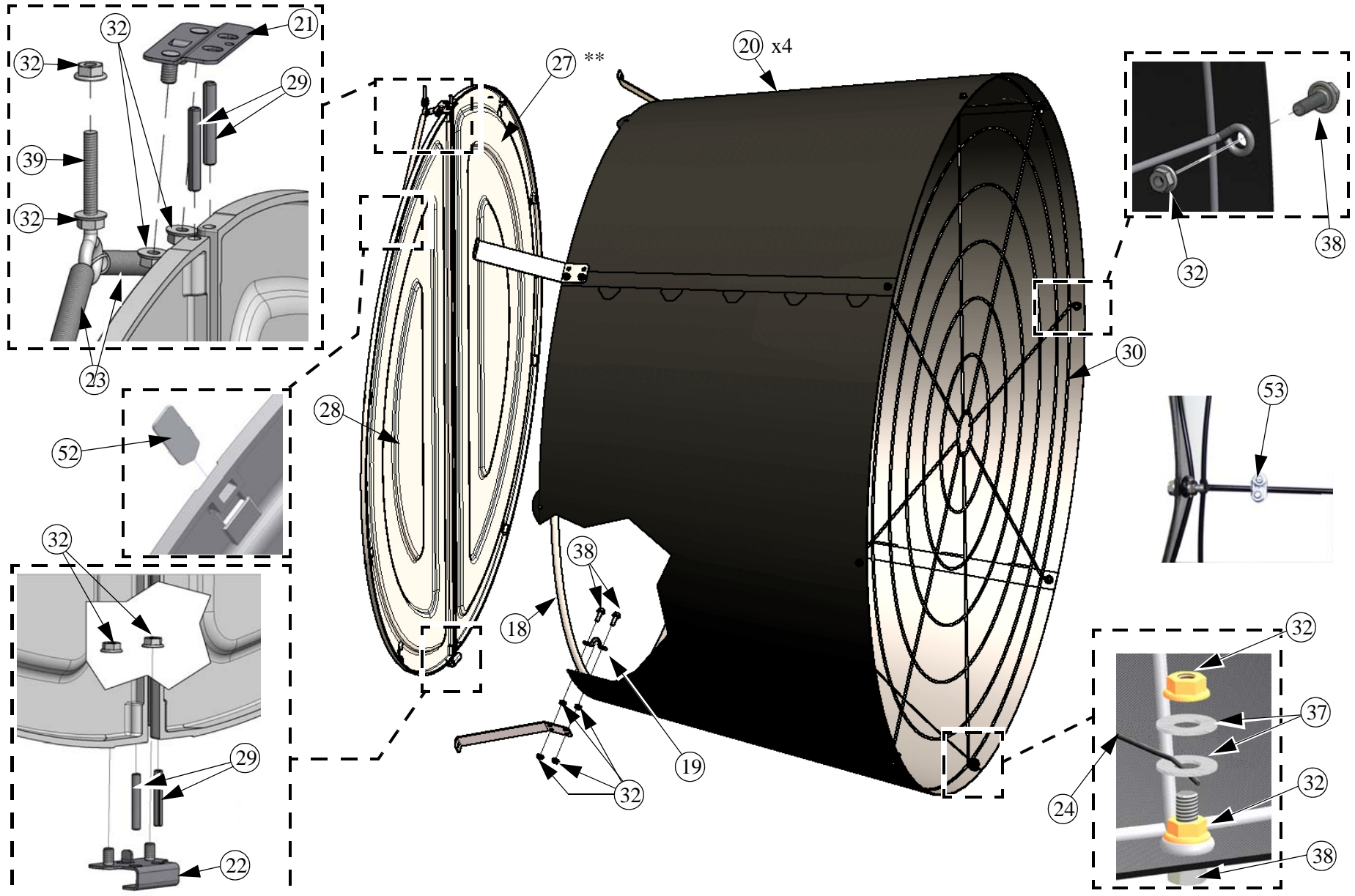

## Part Numbers (Continued)

<b>57" Endura® Fan Part Numbers 53464-XX</b>				
<b>Item</b>	<b>Qty.</b>	<b>Description</b>	<b>Part No.</b>	<b>Models</b>
18	1	Orifice Frame	53416	All
19	6	Orifice Frame Bracket	53611	All
20	4	57" Cone Panel	53163	All
21	1	Top Pivot Plate	53037	All
22	1	Bottom Pivot Plate	53036	All
23	1	Ø1/2" x 11" Door Spring	49629	All
24	1	72.5" Fan Cone Cable	53399	All
27**	1	Left 57" Door Assembly	52926L	All
28**	1	Right 57" Door Assembly	52926R	All
29	4	1/4 x 1-3/4 420 SS Spring Pin	53038	All
30	1	70" Cone Grill	53129	All
32	57	5/16-18 Hx. Serrated Flange Nut	46764	All
37	2	3/8 SS Flat Washer	ST99070	All
38	20	5/16-18 x 1 HHBS Gr8 Bolt	39-20073	All
39	1	5/16-18 x 2 SS Eye Bolt	30663	All
52	4	Striker Plate	53027	All
53	2	Cable Clamp	732	All
54	1/3	Anti-Seize (Not Shown)	47749	All
<b>**Doors Include 53027 Striker Plates (Item 52)</b>				



**Made to work.  
Built to last.**

### **Revisions to this Manual**

<b>Page No.</b>	<b>Description of Change</b>
	New Manual

**Contact your nearby Chore-Time distributor or representative for additional parts and information.**

**CTB Inc.  
P.O. Box 2000 • Milford, Indiana 46542-2000 • U.S.A.  
Phone (574) 658-4101 • Fax (877) 730-8825  
E-Mail: [ctb@ctbinc.com](mailto:ctb@ctbinc.com) • Internet: <http://www.ctbinc.com>  
Printed in the U.S.A.**