



Nipple Waterer Mini Drinker

Installation Instruction

Part No. 35412

Introduction:

The Nipple Waterer Mini Drinker is designed to be used on chicks from 1 day through 15 days. Install one Mini Drinker every 10 feet (3 m) the entire length of the waterer line.

Note: The Mini Drinker must be ordered in quantities of 50.

Installation:

The Mini Drinker components must be completely assembled prior to installing the bowl on the waterer line.

Figure 1 shows the components required for each bowl assembly.

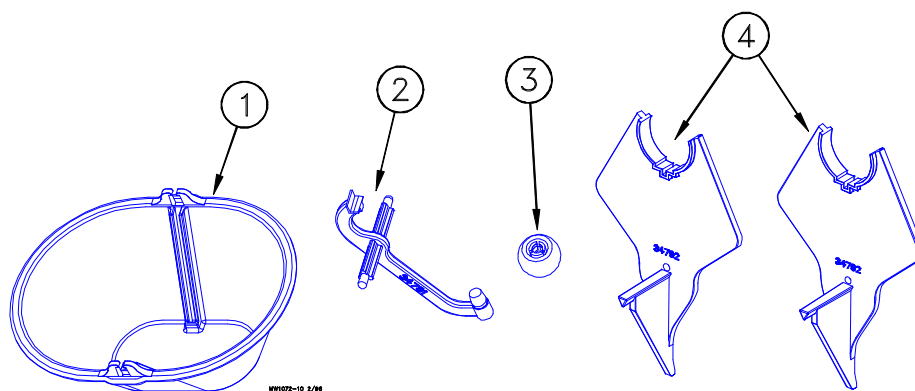

Figure 1: Mini Drinker Components

Key	Description	PartNo.
1	Mini Drinker Bowl	34790
2	Pivot Arm	34791
3	Float Ball (small)	25026
4	Mounting Bracket (2 req'd)	24792

1. Install the Mounting Bracket in the lock on the top of the Mini Drinker Bowl, as shown in Figure 2.
2. Lay the Mini Drinker Bowl on it's side on a flat surface and snap the lower portion of the Mounting Bracket into the Channel Snap.

Key	Description
1	Mounting Bracket
2	Mini Drinker Bowl

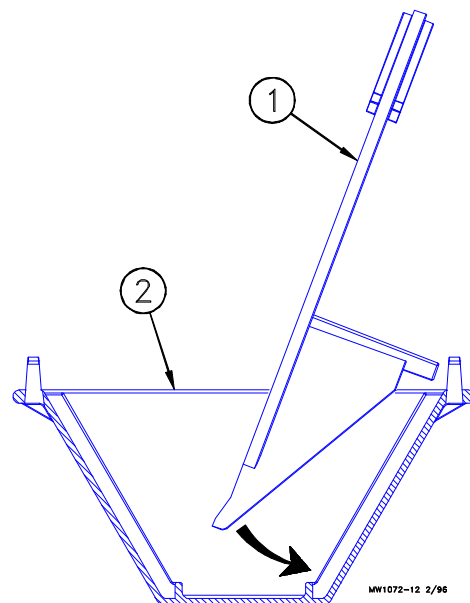

Figure 2: Mounting Bracket Installation

MW1072D2
February 1996

3. Install the Float Ball on the Pivot Arm, as shown in Figure 3.



Figure 3: Float Ball installation

4. Install the Pivot Arm/Float Ball assembly between the Mounting Brackets, as shown in Figure 4.
Note: Gently spread the Mounting Brackets apart to allow the pins on the Pivot Arm to slide through the Mounting Bracket holes.

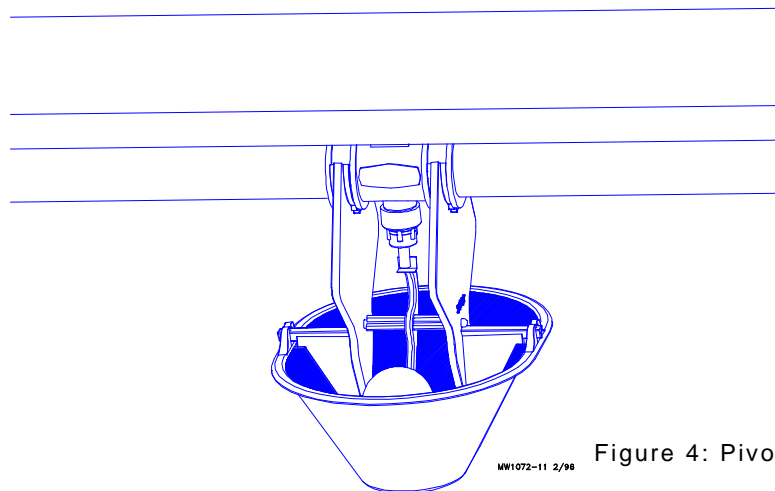

Figure 4: Pivot Arm installation

5. Install the Mini Drinker assembly on a Saddle, as shown in Figure 5.
Note: Rotate the Mini Drinker on the Saddle to properly lock it in place.
6. Adjust the Regulator to provide 4 to 6 inches (100 to 150 mm) of water column.



Figure 5: Mini Drinker Assembly installation