

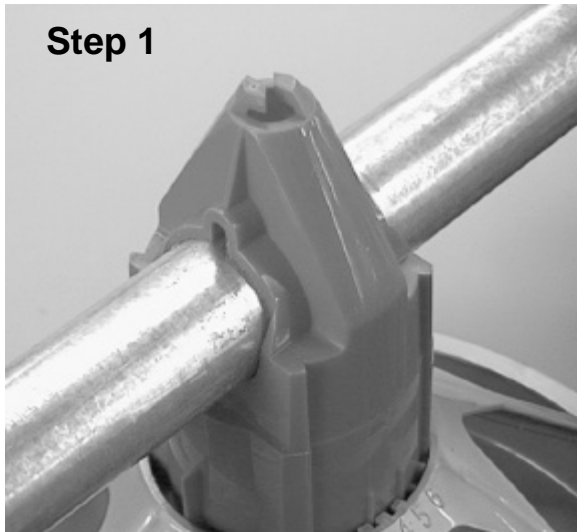

Feeder Lock

The Feeder Lock is designed to prevent the Feeders from swinging on the Auger Tubes

Installation Procedure



Step 1

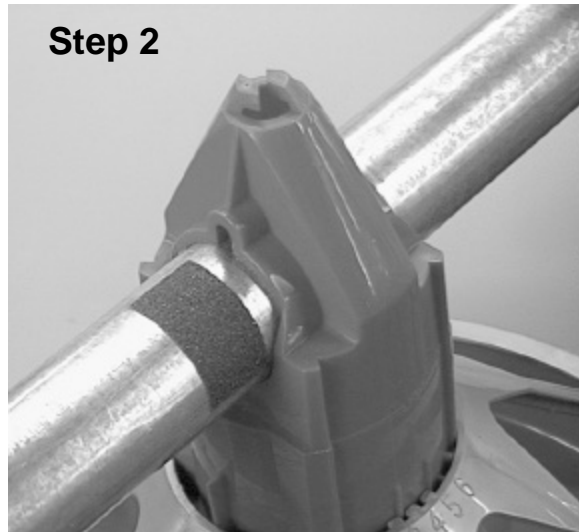

Step 2



Step 3

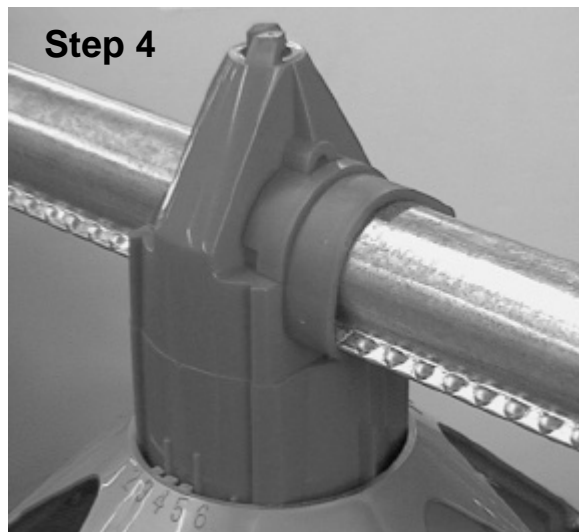

Step 4

Step 1 Pan on Tube—Tube has already been indexed to proper setting and Tube Clamps tightened.

Step 2 Remove backing paper and install Non-Skid Strip approximately as shown.

Step 3 Gently spread the Lock to allow it to slide over the Auger Tube as shown.

Note: The seam of the Auger Tube and hardware for the Lock must be on opposite sides as shown. Otherwise an interference will occur.

Slide Lock into position against the Feeder Support Cone. Make sure the Feeder is in the upright position before securing the Lock to the Auger Tube using the hardware supplied.

Step 4 Completed installation viewed from opposite side of Tube.



Feeder Lock

The Feeder Lock is designed to prevent the Feeders from swinging on the Auger Tubes

Installation Procedure

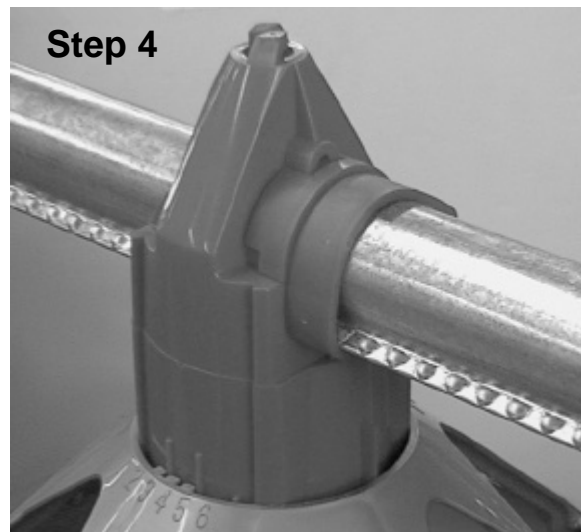
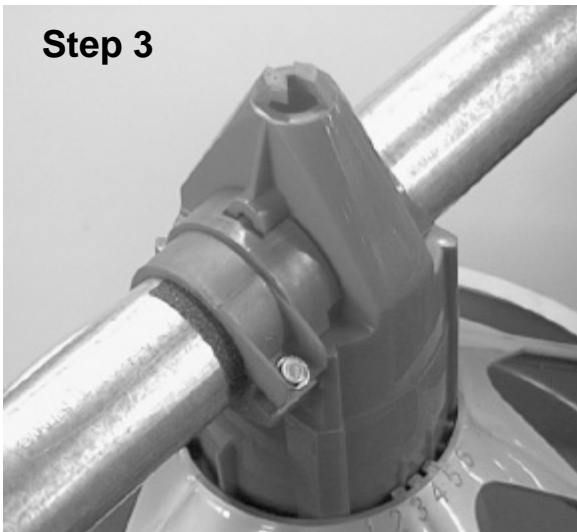
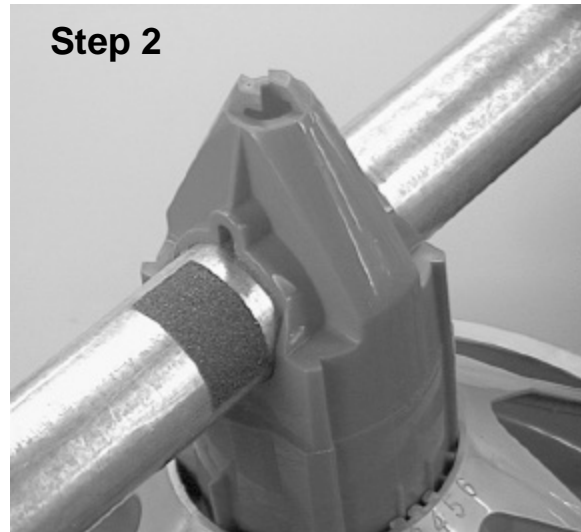
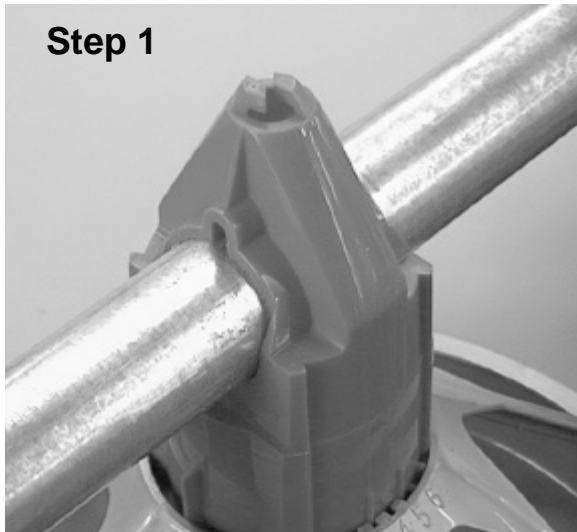

Step 1 Pan on Tube—Tube has already been indexed to proper setting and Tube Clamps tightened.

Step 2 Remove backing paper and install Non-Skid Strip approximately as shown.

Step 3 Gently spread the Lock to allow it to slide over the Auger Tube as shown.

Note: The seam of the Auger Tube and hardware for the Lock must be on opposite sides as shown. Otherwise an interference will occur.

Slide Lock into position against the Feeder Support Cone. Make sure the Feeder is in the upright position before securing the Lock to the Auger Tube using the hardware supplied.

Step 4 Completed installation viewed from opposite side of Tube.