

The Model C2 Control Update Kit is to be used on End Control Units and Intermediate Control Units. The diagrams, in this instruction, reflect End Control updates. However, Intermediate Control updates are very similar.

Installation:

1. Disconnect electrical power to the Control Unit.
 2. Remove the Top Cover from the Control Unit.
 3. Remove the (2) 10-24 nuts and washers securing the feeder components to the Control Unit. See Figure 2.
- Save the hardware.
4. Unlock the Grill from the Feeder Pan and remove the Grill Support and Cone.
 5. Discard the existing Cone and install the Cone (part no. 29064) supplied with Update Kit.
 6. Reassemble the feeder pan components.
 7. Lock the Grill in place on the Feeder Pan.
 8. Position the feeder setting to #5.
 9. Locate the Sleeve (part no. 29349) on top of the Grill, as shown in Figure 3.
 10. Reinstall the feeder pan components (including new Cone and Sleeve) to the Control Unit.
 11. Use original 10-24 nuts and washers to secure the feeder components to the Control Unit. See Figure 2.
 12. Reinstall the top cover on the Control Unit.
 13. Connect electrical power to the Control Unit.

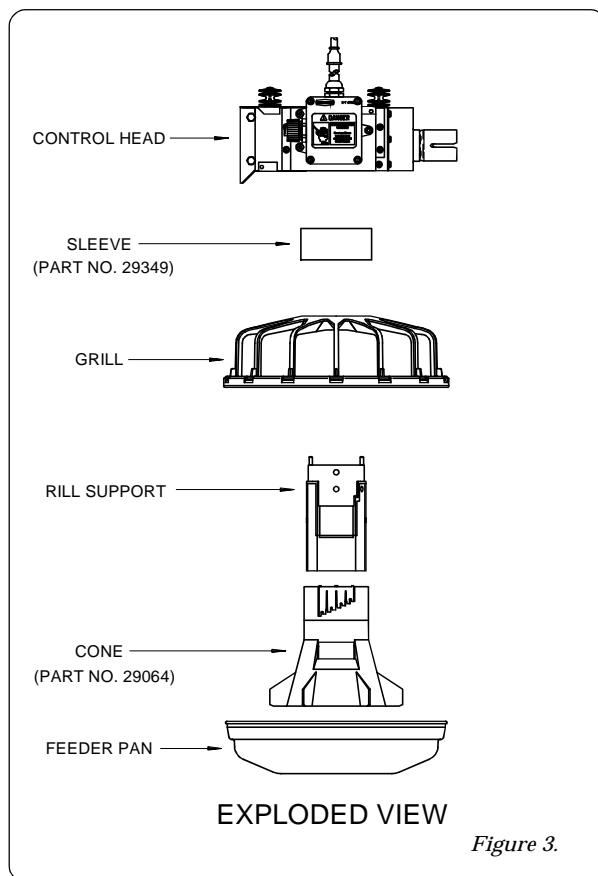
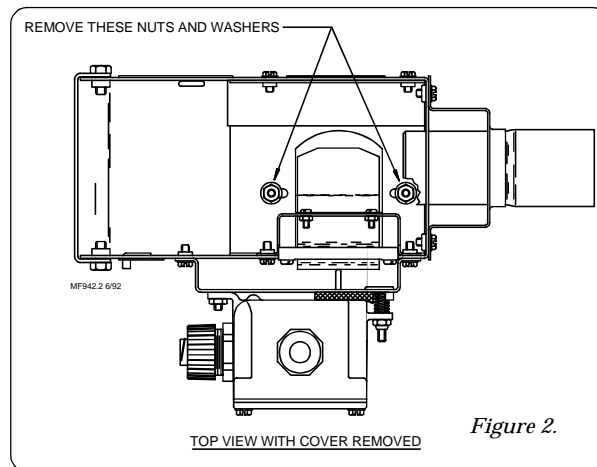

Note: The 29430 Model C2 Update Kit includes (1) Cone, Part No. 29064, and (1) Sleeve, Part No. 29349.

Contact your nearby Chore-Time distributor or representative for additional parts and information.
Chore-Time Equipment, A Division of CTB, Inc.
P.O. Box 2000, Milford, Indiana 46542-2000 U.S.A.