



300 lb. Hopper Assembly Instruction

Hopper Assembly Procedure:

1. Loosely assemble the 300# Hopper Sides, as shown in Figure 1, using 1/4-20 hardware, supplied in the hardware package.
2. Install the Hopper Hangers inside the Hopper Panels.
Notice the orientation of the Hopper Hangers.
If the hopper is to have a lower switch, as shown, the Hopper Hangers must be perpendicular to the switch location. Use 1/4-20 hardware to secure the Hopper Hangers inside Hopper Panels.
3. Secure the Hanger Bracket Assemblies to the Hopper Hangers, using 1/4-20 hardware.
4. Secure the Hopper Support to Hanger Bracket Assemblies, using 5/16-18 hardware.
5. Tighten the hardware. Keep the hopper assembly and support components as square as possible.
6. Install the (4) Boot Hangers on the bottom of the Hopper Panels, using 1/4-20x1/2" truss head screws and 1/4-20 nuts. Truss head screws should be installed from the inside to avoid feed flow restrictions.
7. Hopper Level Control Support Plate may be installed when the hopper assembly is fully assembled and installed to determine the optimum switch location.
8. If a Lower Hopper Switch is *not* to be installed, proceed to step
- 12.
9. Slide the Deflector Shield over the top (2) press studs on the Diaphragm Assembly, as shown in Figure 1.
10. Insert the (4) press studs on the Diaphragm Assembly through the (4) switch mounting holes, as shown.
11. The press studs extend through the Switch & Plate Assembly and are to be secured using 10-32 nuts.
12. If a Hopper Cover is *not* to be installed, proceed to step 15.
13. Secure the half of the Hopper Cover without the latches to the hopper assembly, using 1/4-20 hardware supplied. See Figure 2.
14. Set the other half of the cover on the hopper assembly and latch to secure.
15. Use 10-24 hardware to install Cover Plate over drop tube hole (in cover) not being used.
16. Use the cable clamp, supplied in hardware package, to form a loop, as shown in Figure 2.
17. Secure the cable to the Hopper Support, using 5/16-18 hardware, as shown in Figure 2.

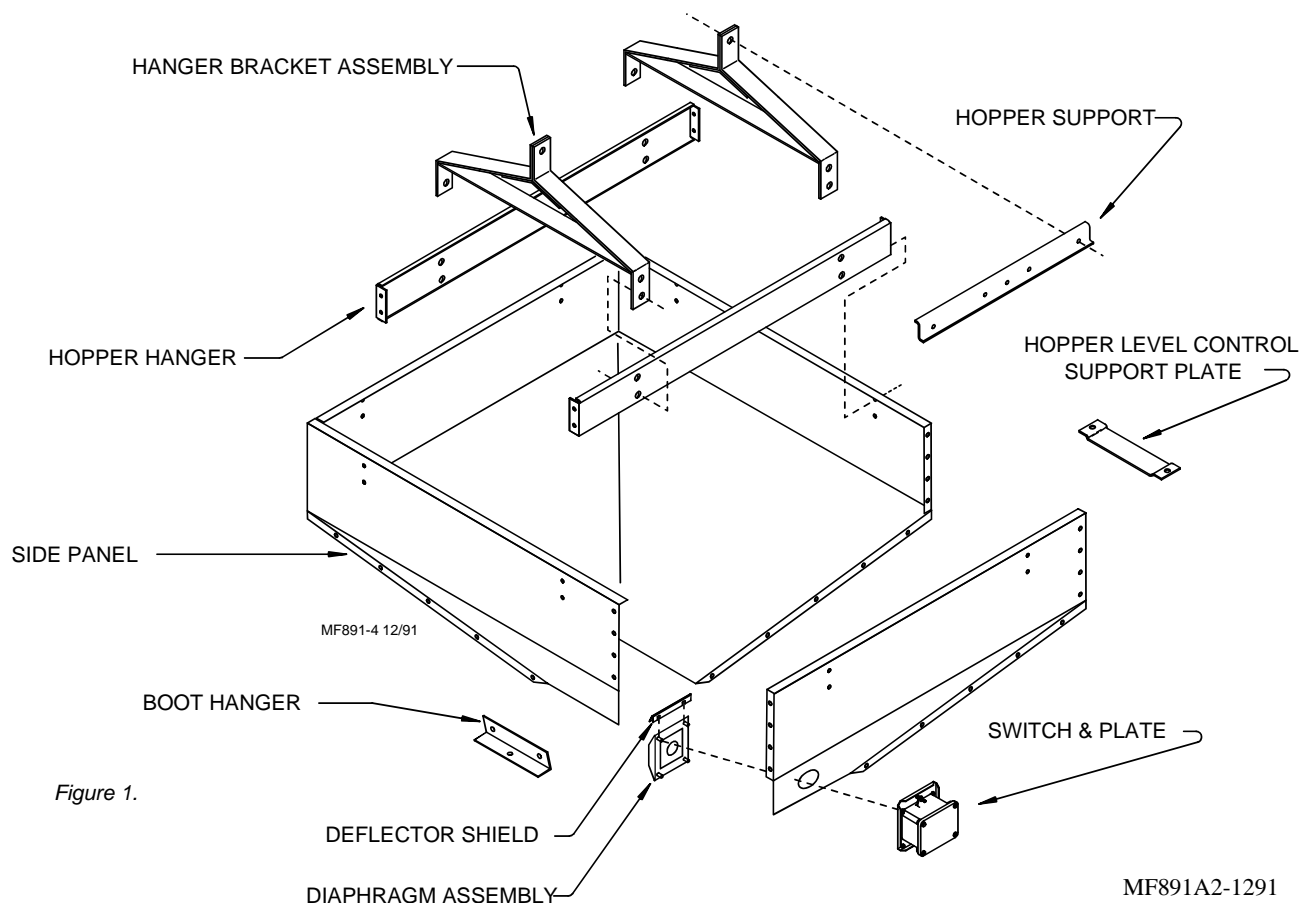
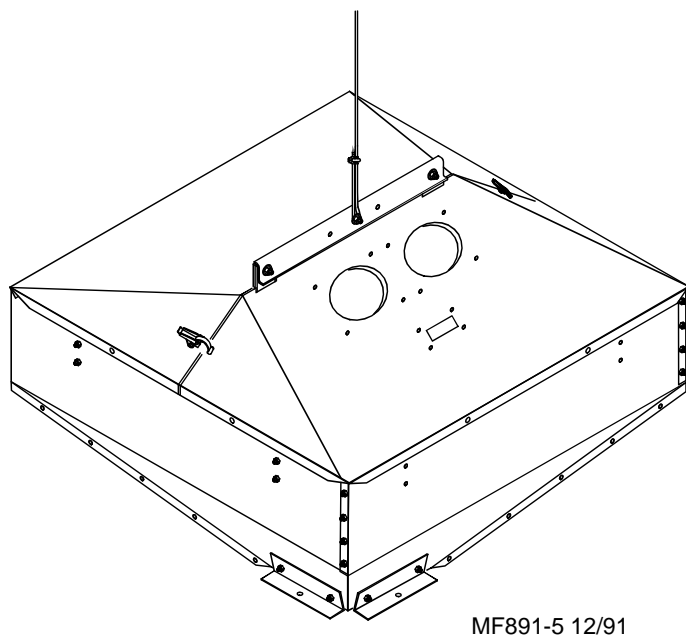

Figure 1.

MF891A2-1291



MF891-5 12/91

Figure 2.

Item	Description	Part No.
1	Hopper Support	24427
2	Hanger Bracket Assembly	2681
3	Hopper Hanger	24426
4	Hopper Side	24423
5	Boot Hanger	24425
6*	Diaphragm Assembly	7900
7*	Deflector Shield	28281
8	Hopper Side (w/Switch Hole)	24424
9*	Mounting Plate	7908
10*	Switch Box	7841
11*	Gasket	6777
12*	Switch Box Cover	6776
13*	6-32x7/8 Rd. Hd. M.S.	1921
14*	Pin	8757
15*	Spring	6972
16*	Switch Bracket	7068
17*	SPDT Actuator Switch	7114
18*	Paddle	7114
19*	Switch Insulation	1907-5
20*	#10 Twin Helix Screw	6980
21	Hopper Level Control Support Plate	28267
22**	Hopper Cover (w/ clamps)	28202
23**	Hopper Cover	28203
24	Cover Plate	28369

*These components may be ordered as an assembly under Part No. 8798.

**These components may be ordered as an assembly under Part No. 28201.

Hopper Assembly Part Numbers

Hopper Assembly w/o Switch or Cover: 28359

Hopper Assembly w/ Cover only: 28360

Hopper Assembly w/ Switch only: 24436

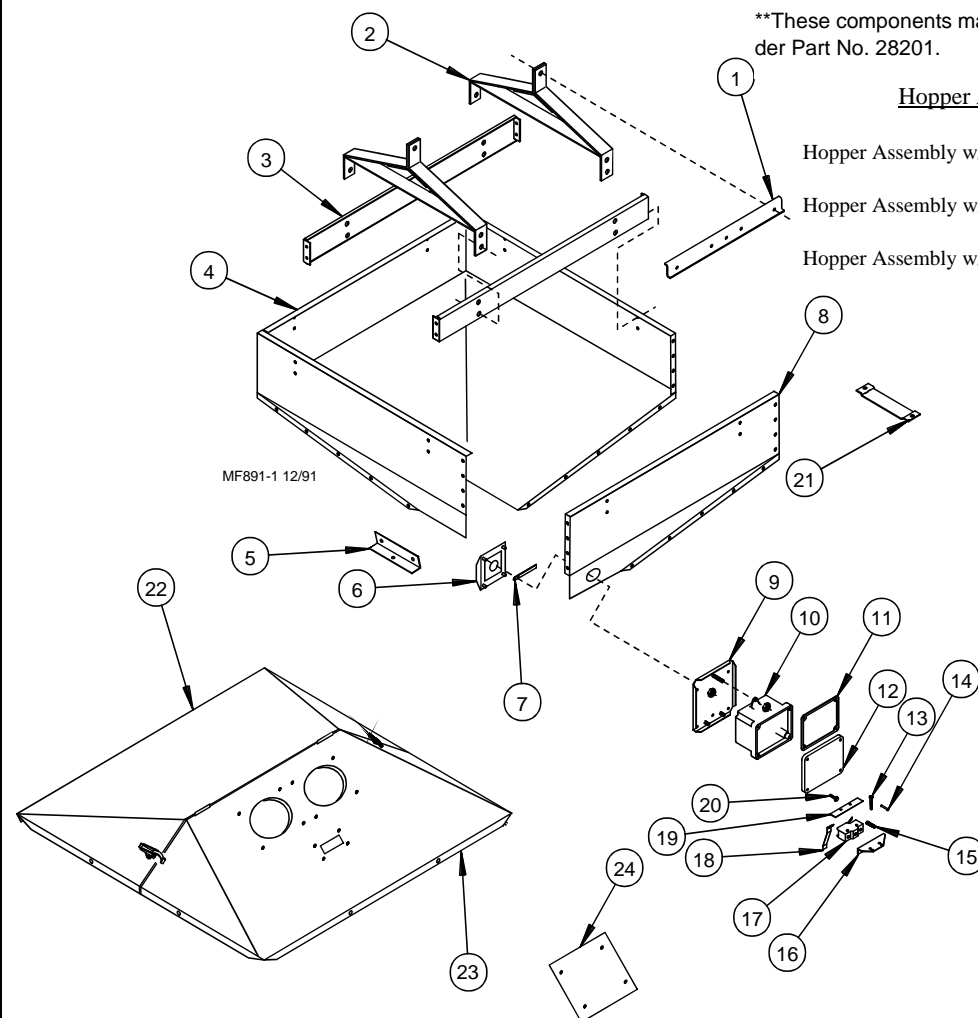

Contact your nearby Chore-Time distributor or representative for additional parts and information.
Chore-Time Equipment, A Division of CTB, Inc.
P.O. Box 2000, Milford, Indiana 46542-2000 U.S.A.

Printed in the U.S.A.