

24" Crated and Galvanized Crated Fan Installation & Operator's Instruction Manual

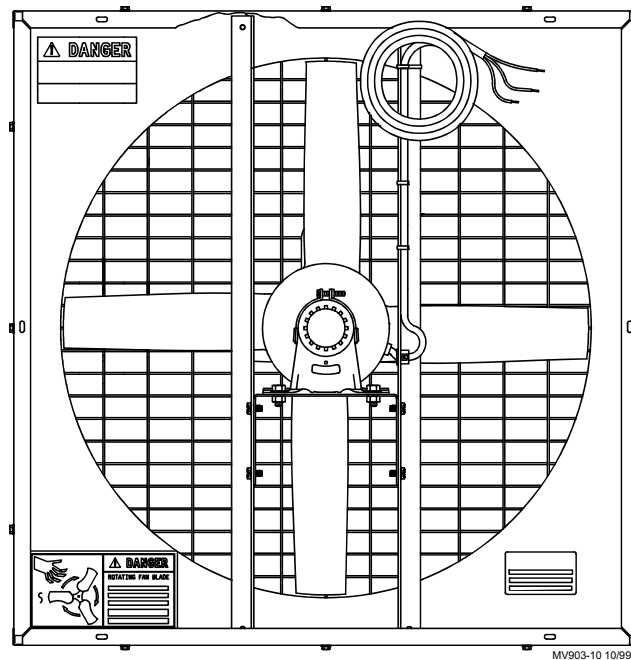

Chore-Time Warranty

CTB, Inc. ("Chore-Time") warrants new CHORE-TIME Cage and Cage Components manufactured by Chore-Time to be free from defects in material or workmanship under normal usage and conditions, for One (1) year from the date of installation by the original purchaser ("Warranty"). If such a defect is determined by Chore-Time to exist within the applicable period, Chore-Time will, at its option, (a) repair the Product or Component Part free of charge, F.O.B. the factory of manufacture or (b) replace the Product or Component Part free of charge, F.O.B. the factory of manufacture. This Warranty is not transferable, and applies only to the original purchaser of the Product.

CONDITIONS AND LIMITATIONS

THIS WARRANTY CONSTITUTES CHORE-TIME'S ENTIRE AND SOLE WARRANTY AND CHORE-TIME EXPRESSLY DISCLAIMS ANY AND ALL OTHER WARRANTIES, INCLUDING, BUT NOT LIMITED TO, EXPRESS AND IMPLIED WARRANTIES, INCLUDING, WITHOUT LIMITATION, WARRANTIES AS TO MERCHANTABILITY OR FITNESS FOR PARTICULAR PURPOSES. CHORE-TIME shall not be liable for any direct, indirect, incidental, consequential or special damages which any purchaser may suffer or claim to suffer as a result of any defect in the Product. Consequential or Special Damages as used herein include, but are not limited to, lost or damaged products or goods, costs of transportation, lost sales, lost orders, lost income, increased overhead, labor and incidental costs, and operational inefficiencies. *Some jurisdictions prohibit limitations on implied warranties and/or the exclusion or limitation of such damages, so these limitations and exclusions may not apply to you. This warranty gives the original purchaser specific legal rights. You may also have other rights based upon your specific jurisdiction.*

Compliance with federal, state and local rules which apply to the location, installation and use of the Product are the responsibility of the original purchaser, and CHORE-TIME shall not be liable for any damages which may result from non-compliance with such rules.

The following circumstances shall render this Warranty void:

- Modifications made to the Product not specifically delineated in the Product manual.
- Product not installed and/or operated in accordance with the instructions published by the CHORE-TIME.
- All components of the Product are not original equipment supplied by CHORE-TIME.
- Product was not purchased from and/or installed by a CHORE-TIME authorized distributor or certified representative.
- Product experienced malfunction or failure resulting from misuse, abuse, mismanagement, negligence, alteration, accident, or lack of proper maintenance, or from lightning strikes, electrical power surges or interruption of electricity.
- Product experienced corrosion, material deterioration and/or equipment malfunction caused by or consistent with the application of chemicals, minerals, sediments or other foreign elements.
- Product was used for any purpose other than for the care of poultry and livestock.

The Warranty and Extended Warranty may only be modified in writing by an officer of CHORE-TIME. CHORE-TIME shall have no obligation or responsibility for any representations or warranties made by or on behalf of any distributor, dealer, agent or certified representative.

Effective: April, 2014

CTB, Inc.
PO Box 2000
Milford, Indiana 46542-2000 USA
Phone (574) 658-4101 Fax (877) 730-8825
Email: choretime@choretime.com
Internet: www.choretime.com

Contents

Topic	Page	User
Chore-Time Warranty	2	C, D
Support Information	4	
General	4	C, D, I
Distributor and Installer Information	4	
About This Manual	5	C, D, I
Safety Information	5	C, I
Safety–Alert Symbol	5	
Understanding Signal Words	5	
Follow Safety Instructions	6	
Decal Descriptions	6	
Technical Information	7	C, I
Fan Installation	8	I
Side Wall Installations:	8	
Ceiling Mount Installations:	9	
Wire Screen Installation:	9	
WIRING:	9	
MAINTENANCE:	9	
Parts List	10	C, D, I
24" Wood Crated Fan PN 14843 and 24" Galvanized Crated Fan PN 27495	10	

General

Support Information

Using this equipment for any other purpose or in a way not within the operating recommendations specified in this manual will void the warranty and may cause personal injury.

This manual is designed to provide comprehensive planning, installation, safety, operation, and parts listing information. The Table of Contents provides a convenient overview of the information in this manual. The Table of Contents also specifies which pages contain information for the sales personnel, installer, and consumer (end user).

IMPORTANT: CE stands for "Certified Europe". It is a standard which equipment must meet or exceed in order to be sold in Europe. CE provides a benchmark for safety and manufacturing issues. **CE is required only on equipment sold in Europe.**

Chore-Time Equipment recognizes the CE Mark and pursues compliance in all applicable products. *Fill in the CE-Mark serial number in the blank space provided for future reference.*

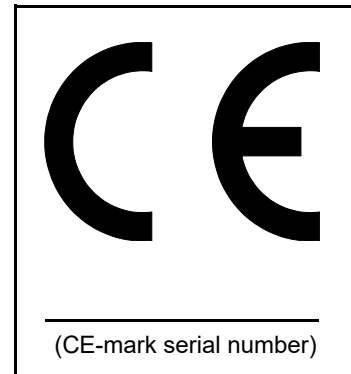

Distributor and Installer Information

Please fill in the following information about your Product.
Keep this manual in a clean, dry place for future reference.

Distributor's Name _____

Distributor's Address _____

Distributor's Phone _____ **Date of Purchase** _____

Installer's Name _____

Installer's Address _____

Installer's Phone _____ **Date of Installation** _____

System Specifications _____

About This Manual

The intent of this manual is to help you in two ways. One is to follow step-by-step in the order of assembly of your product. The other way is for easy reference if you have questions in a particular area.

Important ! Read ALL instructions carefully before starting construction.

Important ! Pay particular attention to all SAFETY information.

- *Metric measurements are shown in millimeters and in brackets, unless otherwise specified. " " equals inches and ' ' equals feet in English measurements.*

Examples:

1" [25.4]

4' [1 219]

- Optional equipment contains necessary instructions for assembly or operation.
- Major changes from the last printing will be listed on the back cover.
- This Planning Symbol is used in areas where planning needs to take place before construction continues.
- Very small numbers near an illustration (*i.e.*, 1257-48) are identification of the graphic, not a part number.



Safety Information

Caution, Warning and Danger Decals have been placed on the equipment to warn of potentially dangerous situations. Care should be taken to keep this information intact and easy to read at all times. Replace missing or damaged safety decals immediately.

Using the equipment for purposes other than specified in this manual may cause personal injury and/or damage to the equipment.



Safety–Alert Symbol

This is a safety–alert symbol. When you see this symbol on your equipment, be alert to the potential for personal injury. This equipment is designed to be installed and operated as safely as possible...however, hazards do exist.

Understanding Signal Words

Signal words are used in conjunction with the safety–alert symbol to identify the severity of the warning.



DANGER indicates an imminently hazardous situation which, if not avoided, **WILL** result in death or serious injury.



WARNING indicates a potentially hazardous situation which, if not avoided, **COULD** result in death or serious injury.



CAUTION indicates a hazardous situation which, if not avoided, **MAY** result in minor or moderate injury.

Safety Information

Follow Safety Instructions

Carefully read all safety messages in this manual and on your equipment safety signs. Follow recommended precautions and safe operating practices.

Keep safety signs in good condition. Replace missing or damaged safety signs.

Decal Descriptions

This diagram shows the proper location of the safety decals as shipped from the factory. Replace damaged or missing decals. Make sure the decals are easy to see at all times.

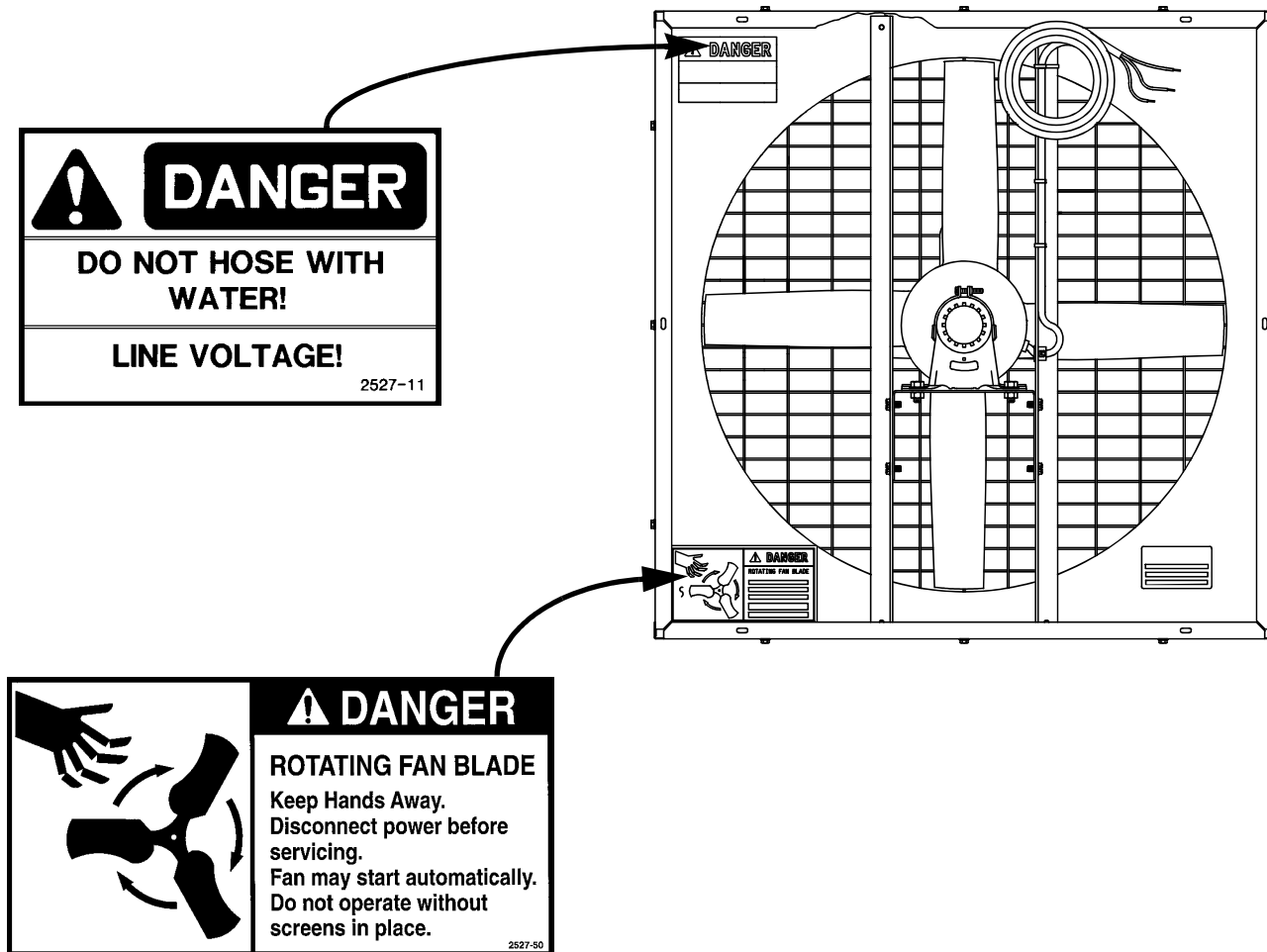

Technical Information

Motor Specifications:		
	Horsepower	1/3 HP
	Voltage	230 V
	Hz.	60 Hz.
	Phase	Single Phs.
	R.P.M.	1075 R.P.M.
Blade:		
	Size	24" (610 mm)
	Type	Cast Aluminum
Fan Assembly:		
	Weight (galvanized steel crate)	58 lbs. (26.3 kg)
	Weight (wood crate)	62 lbs. (28.1 kg)

Important ! Chore-Time recommends that a good alarm system should be installed in confinement buildings to warn of power failure and high temperature. Chore-Time also recommends that an alternate power source be available for confinement buildings in case of power failure.

Fan Installation

The installation information is the same for 24" Crated Fan and the 24" Galvanized Crated Fan, unless otherwise noted.

The Fan can be mounted in either of two ways:

1. Fan unit mounted in the building side wall, with or without the optional Shutter mounted on the outside.
2. Fan unit suspended from the ceiling.

Side Wall Installations:

Build wall framing as suggested by the Fan and Framing dimensions, see **Figure 1**. The required wall opening for each fan is included in the chart below.

Note: The 24" Fan Crates are square.

Dimension	Crated Fan	Galvanized Crated Fan
A	29" (736 mm)	28-1/8" (714 mm)

The Fans are shipped completely assembled and need only to be fastened to the wall framing with lag screws (not supplied).

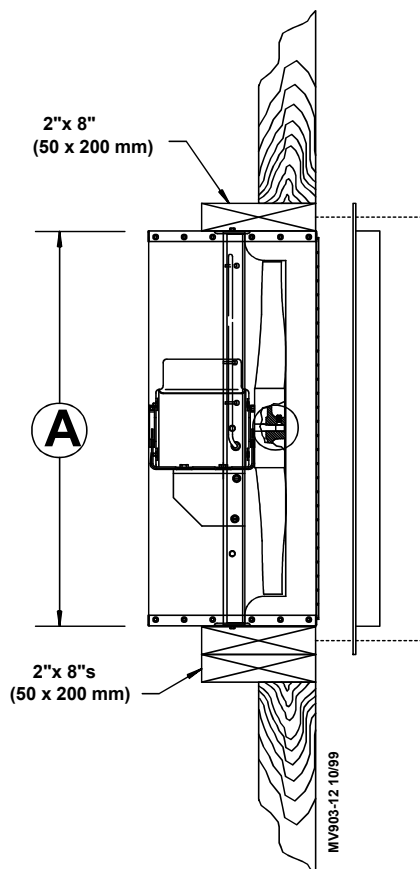

Figure 1. Side wall installation (side view)

Ceiling Mount Installations:

Drill (2) 3/8" (10 mm) holes into the top of the fan assembly, as shown in **Figure 2**. Holes provided in the Fan Shroud should be used to determine hole locations in the Fan Crate.

A Suspension Kit may be ordered separately, which includes 20' (6 m) of chain, (2) eye bolts, (4) nuts, (4) flat washers, (2) lock washers, (2) screw hooks, and (4) "S" Hooks. Assemble the Suspension Kit components as shown in **Figure 2**.

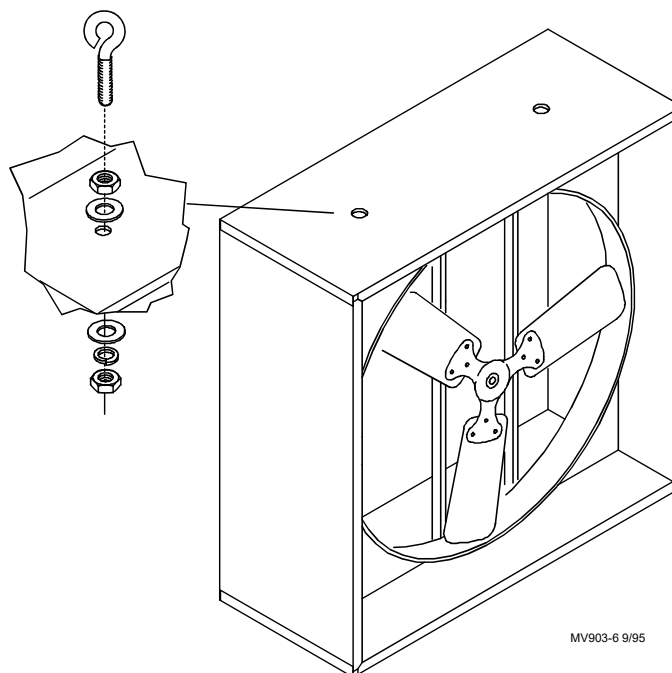

Figure 2. Ceiling installation (side view)

Wire Screen Installation

Secure the Wire Screen to the back of the Fan using the Wire Ties or Staples, supplied.

Note: If the optional Shutter is to be installed, remove the wire screen on the Shutter side of the fan.

Wiring

Wire the motor to fan controls according to the instructions packed with the fan controls.

IMPORTANT: Drill an exit hole through the crate as required for the electrical cord. Route the cord through a conduit locknut (not supplied) or bushing (not supplied) to avoid cord damage.

Maintenance

Service and maintenance of fans should be done only by a qualified technician.

DISCONNECT POWER PRIOR TO MAINTAINING OR CLEANING THE FAN!
The fan may start automatically causing serious injury or death.

Keep the fan clean for maximum life and best performance.

Do not spray motor with water or cleaning fluids; Remove dirt with a dry brush.

Parts List

24" Wood Crated Fan PN 14843
24" Galvanized Crated Fan PN 27495

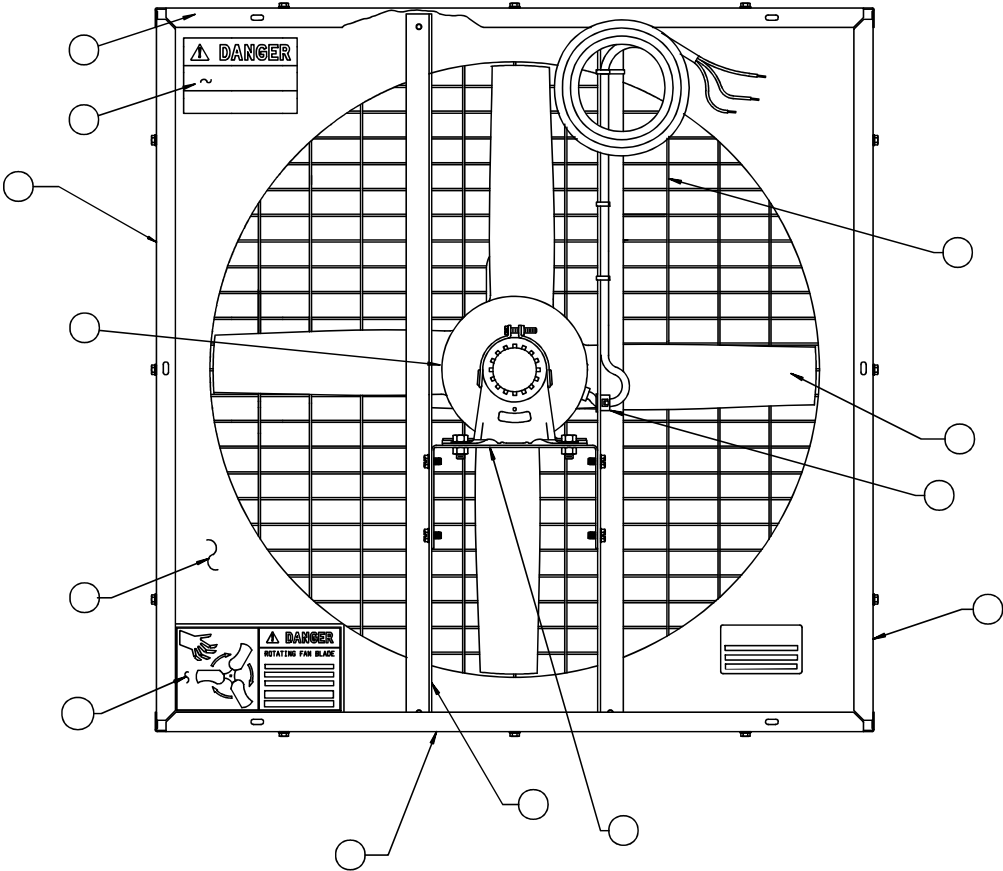

		14843*	27495*
Item	Description	Part No.	Part No.
1	Fan Blade	40277	40277
2	1/3 H.P. Motor	3005	3005
3	Post	27825	27825
4	24" Shroud	5544	5544
5	Wire Screen	6023-27	6023-21
6	Top and Bottom Panel	- - - -	27328
7	Side Panel	- - - -	27368
8	Danger Decal	2527-11	2527-11
9	Post Bracket	27826	27826
10	Danger Decal	2527-50	2527-50
11	Snap Bushing	28479	28479
--**	Suspension Kit	13123	13123
--**	Shutter	24119	24119

*NOTE: 27495 Galvanized Crated Fan Assembly is shown. 14843 (wood) Crated Fan Assembly is similar except that the shroud is enclosed by a plywood crate instead of galvanized steel.

**The Suspension Kit and Shutter are optional and must be ordered separately.

Maintenance

IMPORTANT! Disconnect Power Prior To Maintaining Or Cleaning The Fan. The fan may start automatically causing serious injury or death.

- Service and repair of fans should be done only by a qualified technician.
- Minimize contact of moisture or corrosive chemicals to the surfaces of the fan components to maximize fan life.
- After washing fans, operate fans long enough to remove moisture from all fan surfaces.
- Keep the fan clean for maximum life and best performance.



**Made to work.
Built to last.**

Note: The original, authoritative version of this manual is the [English] version produced by CTB, Inc. or any of its subsidiaries or divisions, (hereafter collectively referred to as "CTB"). Subsequent changes to any manual made by any third party have not been reviewed nor authenticated by CTB. Such changes may include, but are not limited to, translation into languages other than [English], and additions to or deletions from the original content. CTB disclaims responsibility for any and all damages, injuries, warranty claims and/or any other claims associated with such changes, inasmuch as such changes result in content that is different from the authoritative CTB-published [English] version of the manual. For current product installation and operation information, please contact the customer service and/or technical service departments of the appropriate CTB subsidiary or division. Should you observe any questionable content in any manual, please notify CTB immediately in writing to: CTB Legal Department, P.O. Box 2000, Milford, IN 46542-2000 USA.

Revisions to this Manual

Page No.	Description of Change	ECO
10	Changed 4146 to 40277	36121

Contact your nearby Chore-Time distributor or representative for additional parts and information.

CTB, Inc.
PO Box 2000
Milford, Indiana 46542-2000 USA
Phone (574) 658-4101 Fax (877) 730-8825
Email: chovertime@chovertime.com
Internet: www.chovertime.com