

**Vike™ RDE-49 & RDE-58 Nest**

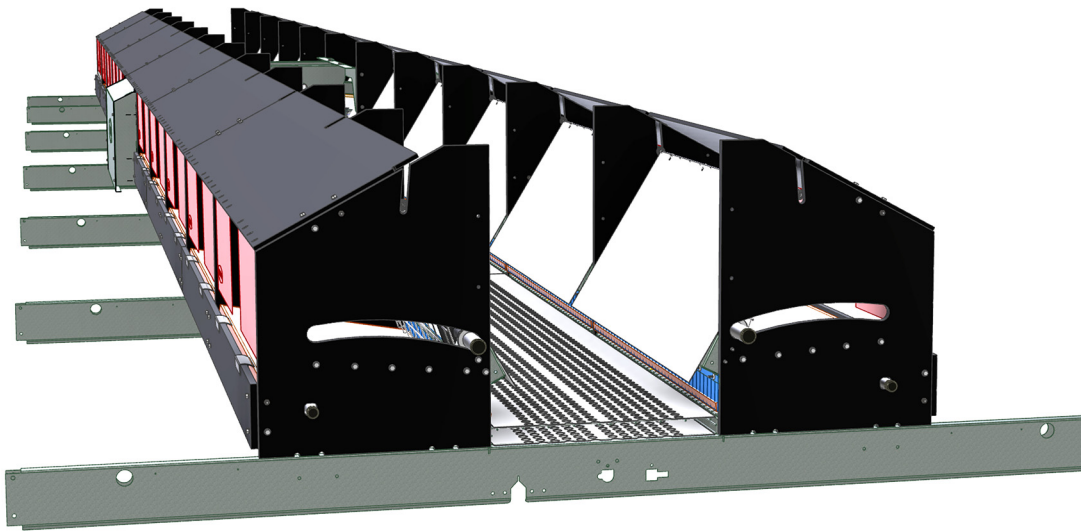

**Installation and Operators Manual**

**Installation and Operators Manual**

For additional parts and information, contact your nearest Chore-Time distributor or representative.  
Find your nearest distributor at: [www.choretime.com/contacts](http://www.choretime.com/contacts)

# Contents

Topic	Page
<b>Limited Warranty</b> .....	<b>3</b>
<b>Safety and General Information</b> .....	<b>4</b>
Follow Safety Instructions .....	4
Decal Descriptions .....	4
DANGER: Rotating Parts .....	4
DANGER: Electrical Hazard .....	4
<b>Planning the System</b> .....	<b>5</b>
Section Dimensions and Expulsion Unit Location .....	5
Systems 50 Sections or less .....	5
Systems longer than 50 Sections .....	5
Egg Belt Installation .....	6
Return Egg Belt .....	6
Egg Belt Supports .....	6
Bottom Rails/Expulsion Plates .....	7
Egg Belt Dividers (Two Belt System) .....	7
Installing Egg Belt back to the Belt Drive End .....	8
Egg Belt Divider Tubes .....	8
Rack Plate/Side Panel Installation .....	9
At Expulsion Unit .....	11
Egg Curtains .....	12
Entrance Board Installation .....	13
Floor Pipe Installation .....	14
Nest Bottom Installation .....	15
Nest Pad Installation .....	16
Expulsion Unit .....	17
Expeller Tube Support & Crosses .....	17
Expeller Pipes .....	18
Motor Installation .....	19
Expulsion Tube Installation .....	20
Expulsion Shafts .....	22
Connections .....	22
Expulsion Shafts/Caps .....	23
Tightening down Toothed Wheels on Expulsion Shafts .....	25
Expulsion Unit Cover .....	25
Side Braces .....	25
Front Cover .....	26
Expeller Installation .....	27
Expeller Panel Assembly .....	27
Expeller Panel Installation .....	28
Back Wall Installation .....	29
Curtain/Roof Assembly & Installation .....	30
Valego® RDE Nest Control (601150) .....	31
<b>Part Numbers</b> .....	<b>31</b>
Miscellaneous Parts .....	31
RDE 49 (58506-X) & 58 (58505-X) Nest Kits .....	32
Starter and 1.2m Specific Kit Parts.....	33
Part Numbers .....	34
Expulsion Unit .....	35

## Limited Warranty

### LIMITED WARRANTY

CTB, Inc. (“Chore-Time”) warrants the new CHORE-TIME Vike™ 49 & 58 Nests manufactured by Chore-Time to be free from defects in material or workmanship under normal usage and conditions, for One (1) year from the date of installation by the original purchaser (“Warranty”). Chore-Time provides for an extension of the aforementioned Warranty period (“Extended Warranty Period”) with respect to certain Product parts. If such a defect is determined by Chore-Time to exist within the applicable period, Chore-Time will, at its option, (a) repair the Product or Component Part free of charge, F.O.B. the factory of manufacture or (b) replace the Product or Component Part free of charge, F.O.B. the factory of manufacture. This Warranty is not transferable, and applies only to the original purchaser of the Product.

### CONDITIONS AND LIMITATIONS

THIS WARRANTY CONSTITUTES CHORE-TIME’S ENTIRE AND SOLE WARRANTY AND CHORE-TIME EXPRESSLY DISCLAIMS ANY AND ALL OTHER WARRANTIES, INCLUDING, BUT NOT LIMITED TO, EXPRESS AND IMPLIED WARRANTIES, INCLUDING, WITHOUT LIMITATION, WARRANTIES AS TO MERCHANTABILITY OR FITNESS FOR PARTICULAR PURPOSES. CHORE-TIME shall not be liable for any direct, indirect, incidental, consequential or special damages which any purchaser may suffer or claim to suffer as a result of any defect in the Product. Consequential or Special Damages as used herein include, but are not limited to, lost or damaged products or goods, costs of transportation, lost sales, lost orders, lost income, increased overhead, labor and incidental costs, and operational inefficiencies. *Some jurisdictions prohibit limitations on implied warranties and/or the exclusion or limitation of such damages, so these limitations and exclusions may not apply to you. This warranty gives the original purchaser specific legal rights. You may also have other rights based upon your specific jurisdiction.*

Compliance with federal, state and local rules which apply to the location, installation and use of the Product are the responsibility of the original purchaser, and CHORE-TIME shall not be liable for any damages which may result from non-compliance with such rules.

The following circumstances shall render this Warranty void:

- Modifications made to the Product not specifically delineated in the Product manual.
- Product not installed and/or operated in accordance with the instructions published by the CHORE-TIME.
- All components of the Product are not original equipment supplied by CHORE-TIME.
- Product was not purchased from and/or installed by a CHORE-TIME authorized distributor or certified representative.
- Product experienced malfunction or failure resulting from misuse, abuse, mismanagement, negligence, alteration, accident, or lack of proper maintenance, or from lightning strikes, electrical power surges or interruption of electricity.
- Product experienced corrosion, material deterioration and/or equipment malfunction caused by or consistent with the application of chemicals, minerals, sediments or other foreign elements.
- Product was used for any purpose other than for the care of poultry and livestock.
- 

The Warranty and Extended Warranty may only be modified in writing by an officer of CHORE-TIME. CHORE-TIME shall have no obligation or responsibility for any representations or warranties made by or on behalf of any distributor, dealer, agent or certified representative.

Effective: April 2014

## Safety and General Information

**Caution, Warning and Danger Decals** have been placed on the equipment to warn of potentially dangerous situations. Care should be taken to keep this information intact and easy to read at all times. Replace missing or damaged safety decals immediately.

### Safety–Alert Symbol



**This is a safety–alert symbol.** When you see this symbol on your equipment, be alert to the potential for personal injury. This equipment is designed to be installed and operated as safely as possible...however, hazards do exist.

### Understanding Signal Words

**Signal words** are used in conjunction with the safety–alert symbol to identify the severity of the warning.



**DANGER** indicates an imminently hazardous situation which, if not avoided, **WILL** result in death or serious injury.



**WARNING** indicates a potentially hazardous situation which, if not avoided, **COULD** result in death or serious injury.



**CAUTION** indicates a hazardous situation which, if not avoided, **MAY** result in minor or moderate injury.

### Follow Safety Instructions

Carefully read all safety messages in this manual and on your equipment safety signs. Follow recommended precautions and safe operating practices.

Keep safety signs in good condition. Replace missing or damaged safety signs.

### Decal Descriptions

#### **DANGER: Rotating Parts**

Disconnect electrical power before working on system, equipment may start automatically. Otherwise personal injury will result.

Severe personal injury will result if the equipment is operated without covers properly installed.

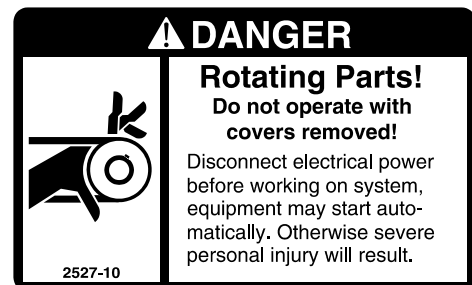

#### **DANGER: Electrical Hazard**

Disconnect electrical power before inspecting or servicing equipment unless maintenance instructions specifically state otherwise.

Ground all electrical equipment for safety.

All electrical wiring must be done by a qualified electrician in accordance with local and national electric codes.

Ground all non-current carrying metal parts to guard against electrical shock.

Electrical disconnects and over current protection are not supplied with the equipment.

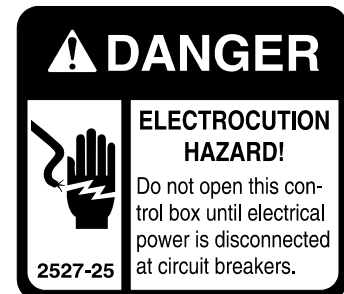

## Planning the System

### Section Dimensions and Expulsion Unit Location

Dimensions for each Section and for Expulsion Units **shown below**.

#### Systems 50 Sections or less

If the number of sections in the house are 50 Sections or less; only one Expulsion Unit is required and is centered as shown in **Figure 1**.

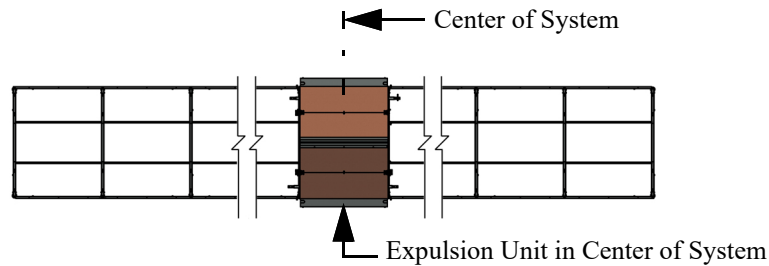

Figure 1. Systems less than 50 sections long

#### Systems longer than 50 Sections

If the number of sections in the house are more than 50; two Expulsion Units are required and it is recommended to be spaced as shown in **Figure 2**.

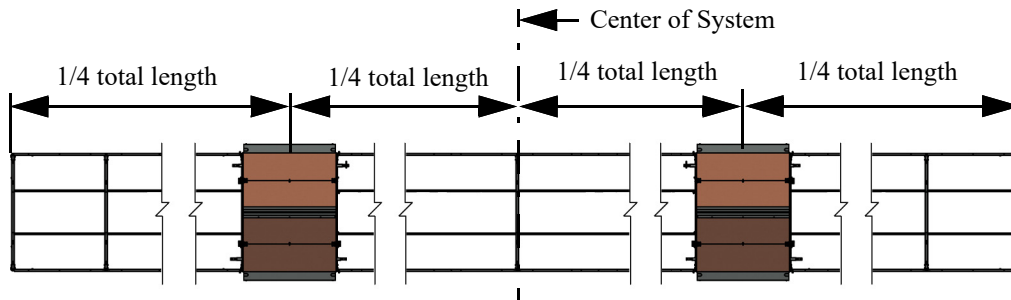
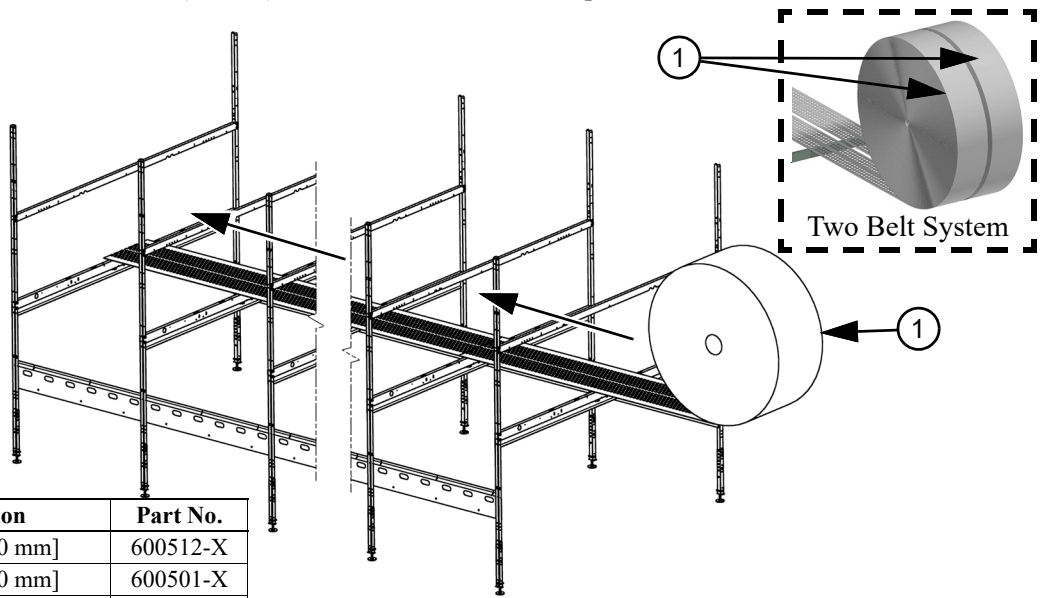

Figure 2. Systems 50 Sections and longer

## Egg Belt Installation

### Return Egg Belt

1. Install the Egg Belt Drive Unit and Egg Belt Return Unit.
2. Start with the Egg Belt Roll/Rolls (**Item 1**) at the Belt Drive end and pull the Belt to the other end as shown.



Item	Description	Part No.
1	Egg Belt [500 mm]	600512-X
	Egg Belt [250 mm]	600501-X
	Egg Belt [600 mm]	600517-X

Figure 3.Return Egg Belt

### Egg Belt Supports

1. Install Egg Belt Trays (**Item 1**) by inserting the wires into the holes in the Nest Crosses (**Item 2**) as shown.

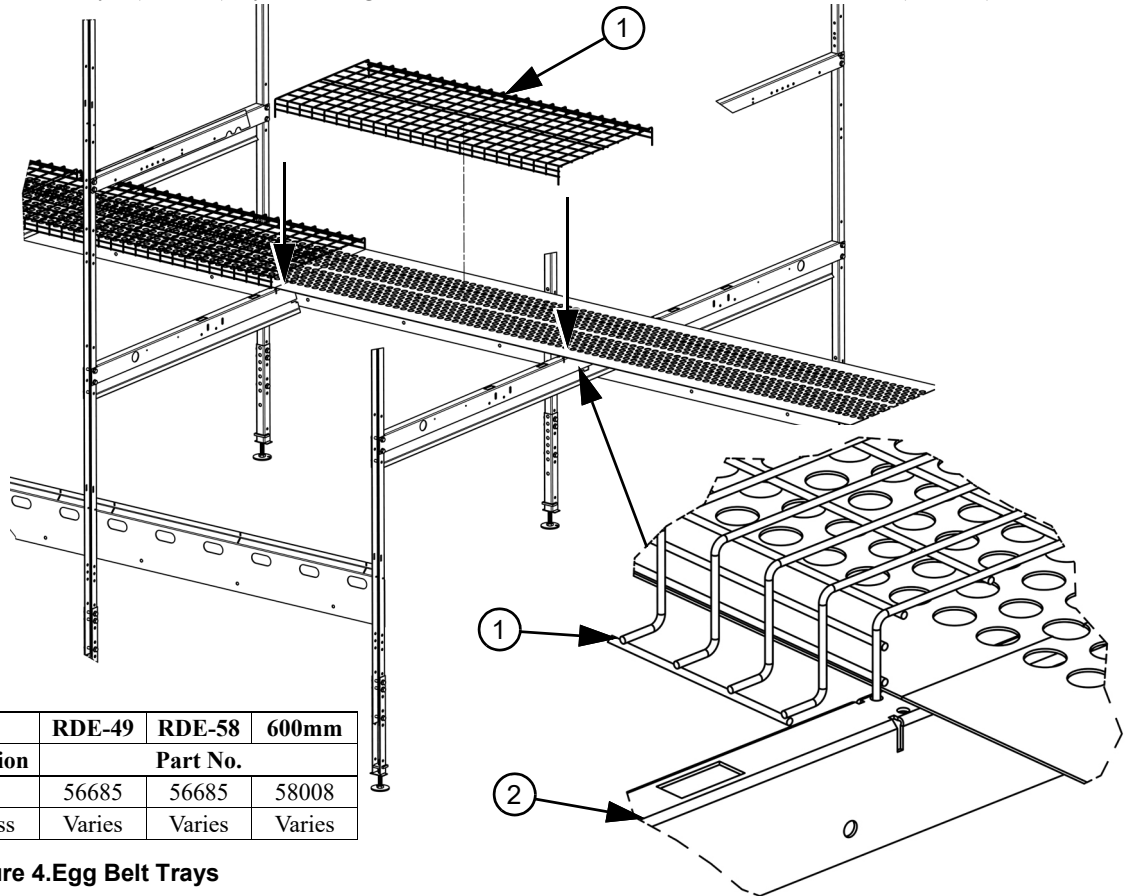

Item	Description	RDE-49	RDE-58	600mm
		Part No.		
1	Egg Tray	56685	56685	58008
2	Nest Cross	Varies	Varies	Varies

Figure 4.Egg Belt Trays

### Bottom Rails/Expulsion Plates

1. Install Nest Bottom Rails (Item 1) in the slots in the Nest Front Rails (Item 2) from the front all the way to the back of the system as shown.
2. At Expulsion Units Install Egg Expulsion Plates (Item 3) as shown.

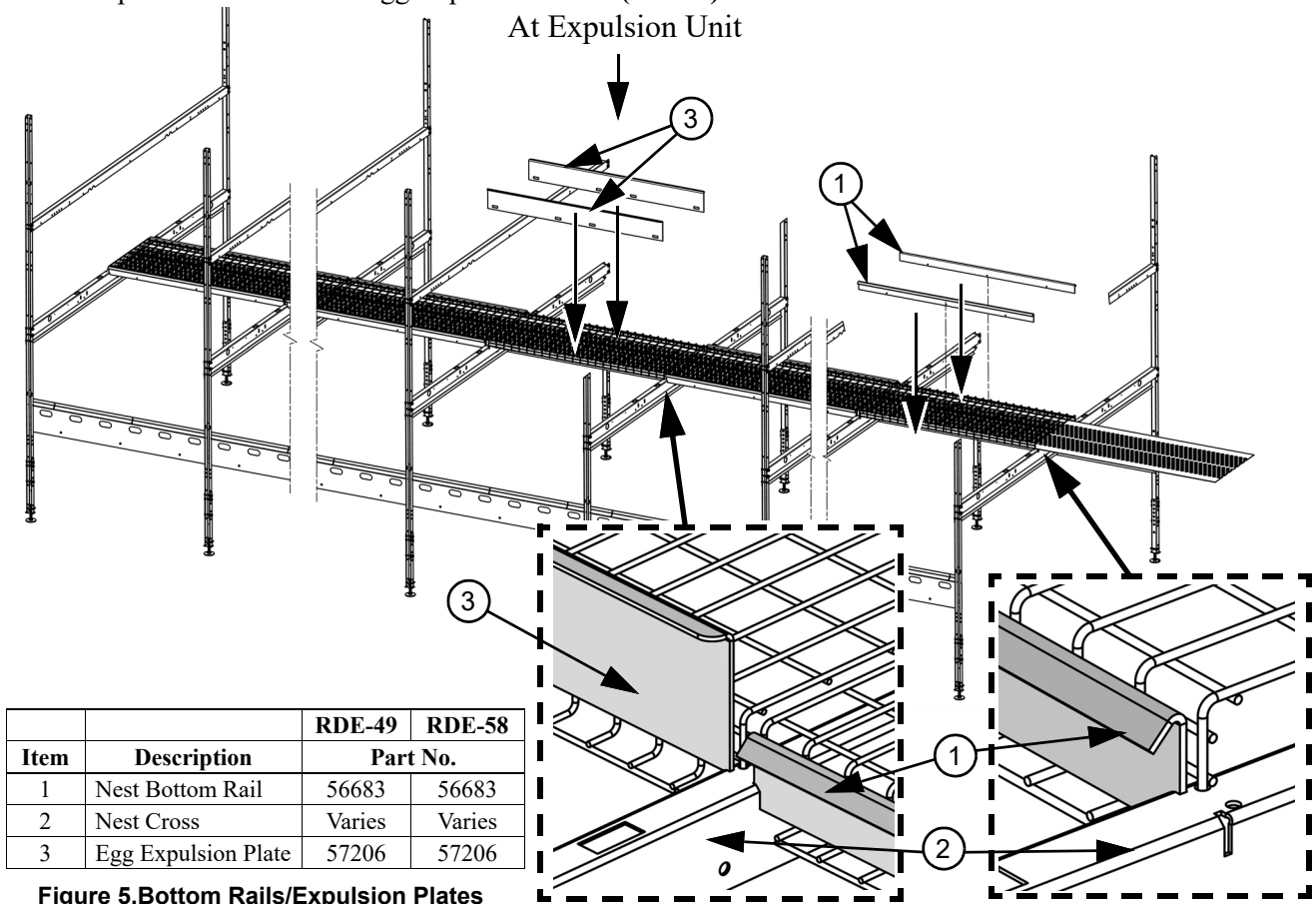

Figure 5. Bottom Rails/Expulsion Plates

### Egg Belt Dividers (Two Belt System)

1. Snap Egg Belt Dividers (Item 1) onto the end of the Egg Trays (Item 2) at every other Nest Cross as shown.

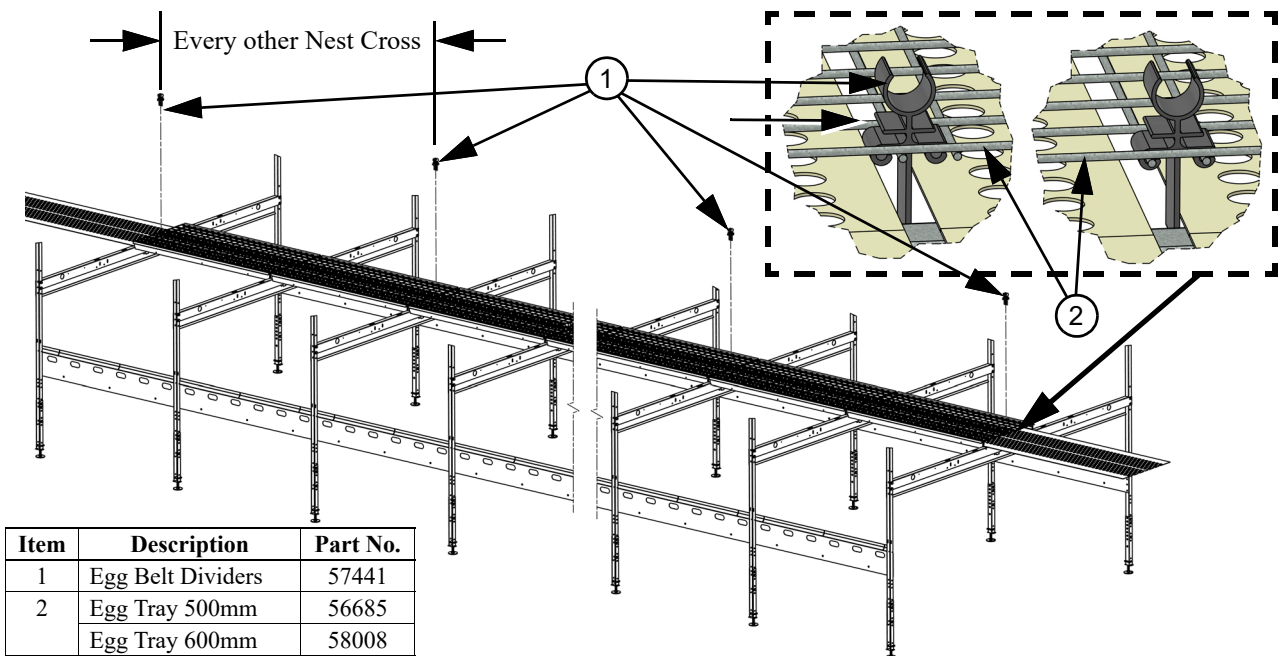

Figure 6. Egg Belt Dividers

### Installing Egg Belt back to the Belt Drive End

1. Feed the Egg Belt through the Return Unit (Not Shown) and pull the Belt back to the Drive Unit.
2. For Two Belt Systems, make sure that the Belt is under the Tabs of the Egg Belt Dividers (Item 1) as shown.

Return Unit

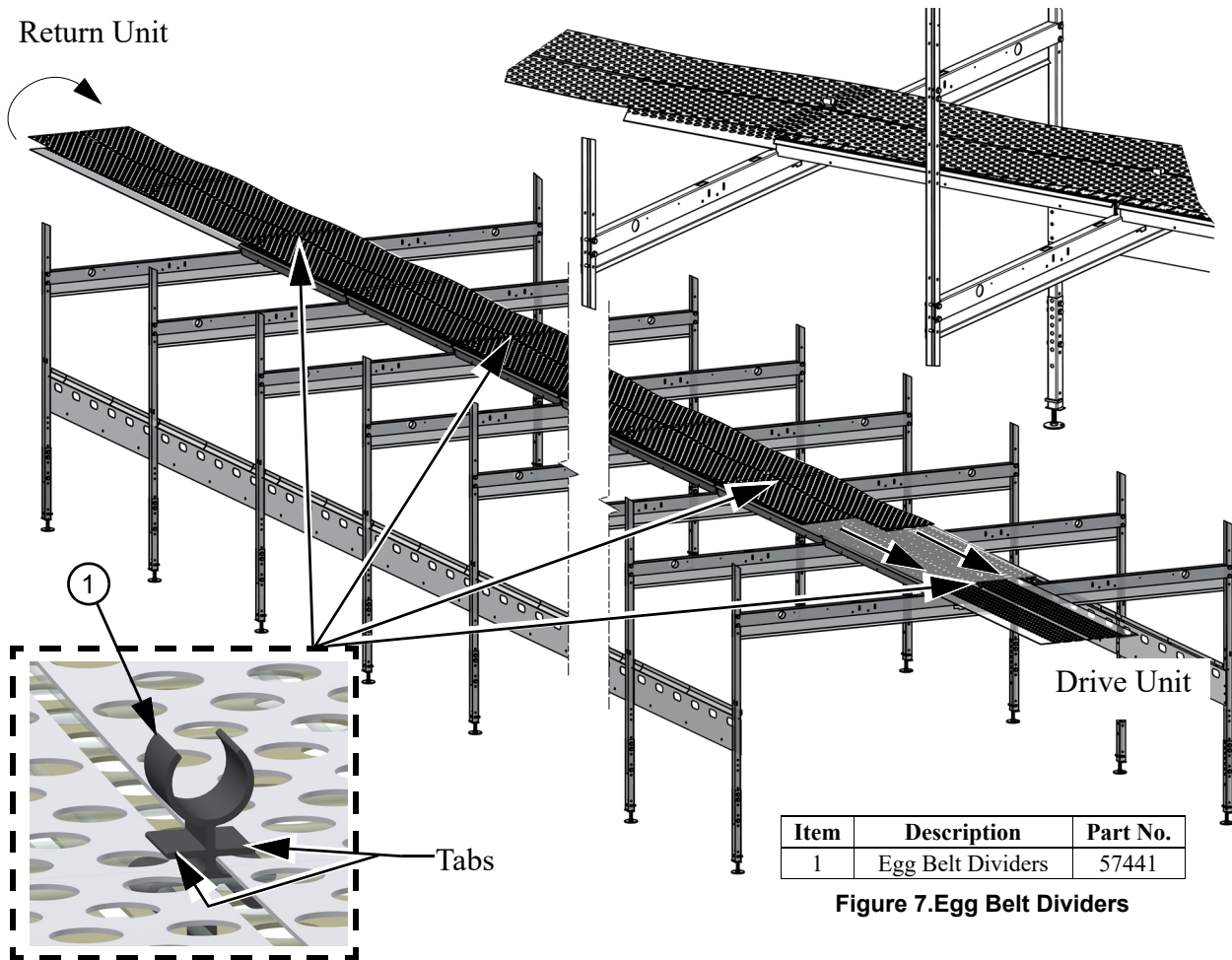

Figure 7. Egg Belt Dividers

### Egg Belt Divider Tubes

1. Install 1/2" PVC Pipe (Not Included) in the Egg Belt Dividers (Item 1) as shown.

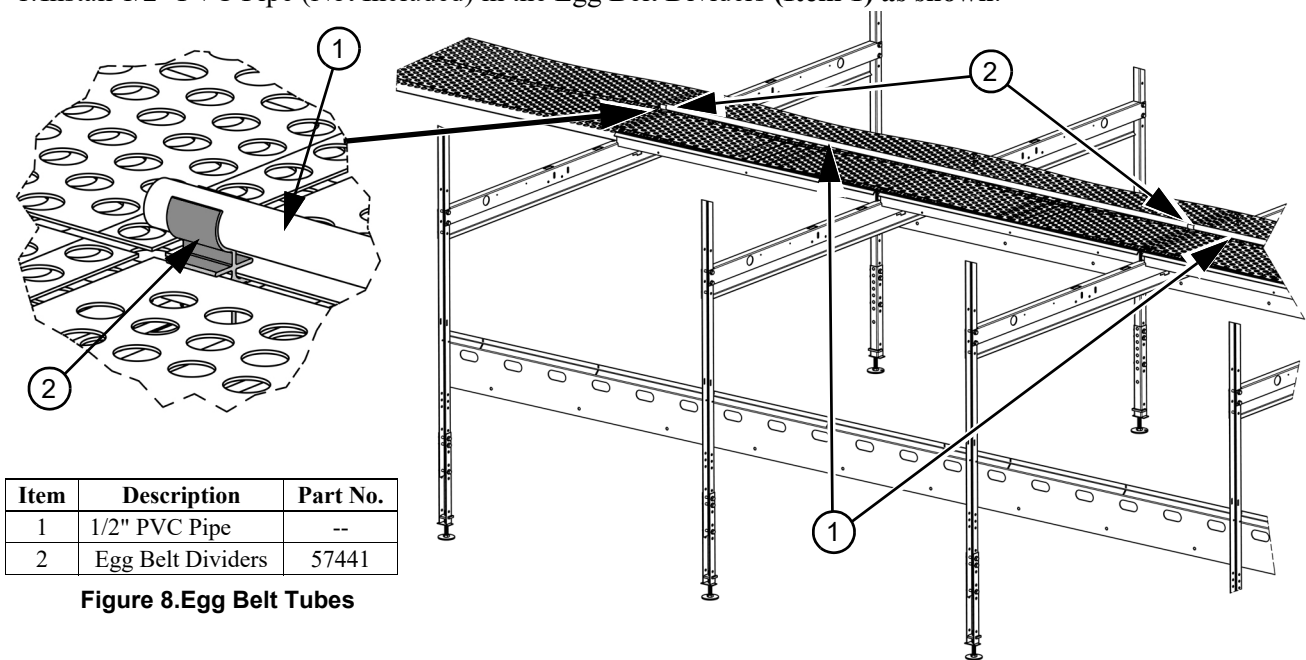

Figure 8. Egg Belt Tubes

6 **Rack Plate/Side Panel Installation**

1. Attach Toothed Rack Plates (Item 1) and Corner Brackets (Item 2) to the Side Panels (Item 3) as shown.
  - Side Panels at end of System get one Rack Plate and one Corner Bracket. Use Two M6 Taptites (Item 4) and one M6 Nut (Item 5).
  - "A" location Side Panels **do not** get Rack Plates. Fasten two Corner Brackets with M6 Taptites using the smaller holes in the Brackets.
  - "B" location Side Panels get a Rack Plate and three Corner Brackets.
  - Side Panels at Expulsion Unit location- Toothed Rack Plates both face each other (towards Inside) of the Expulsion Unit and get four Corner Brackets. See Figure (on page 11)
2. Continue installing Rack Plates, to the end of the system. The End Side Panels get two Corner Bracket (See Detail).

See next two pages for Details

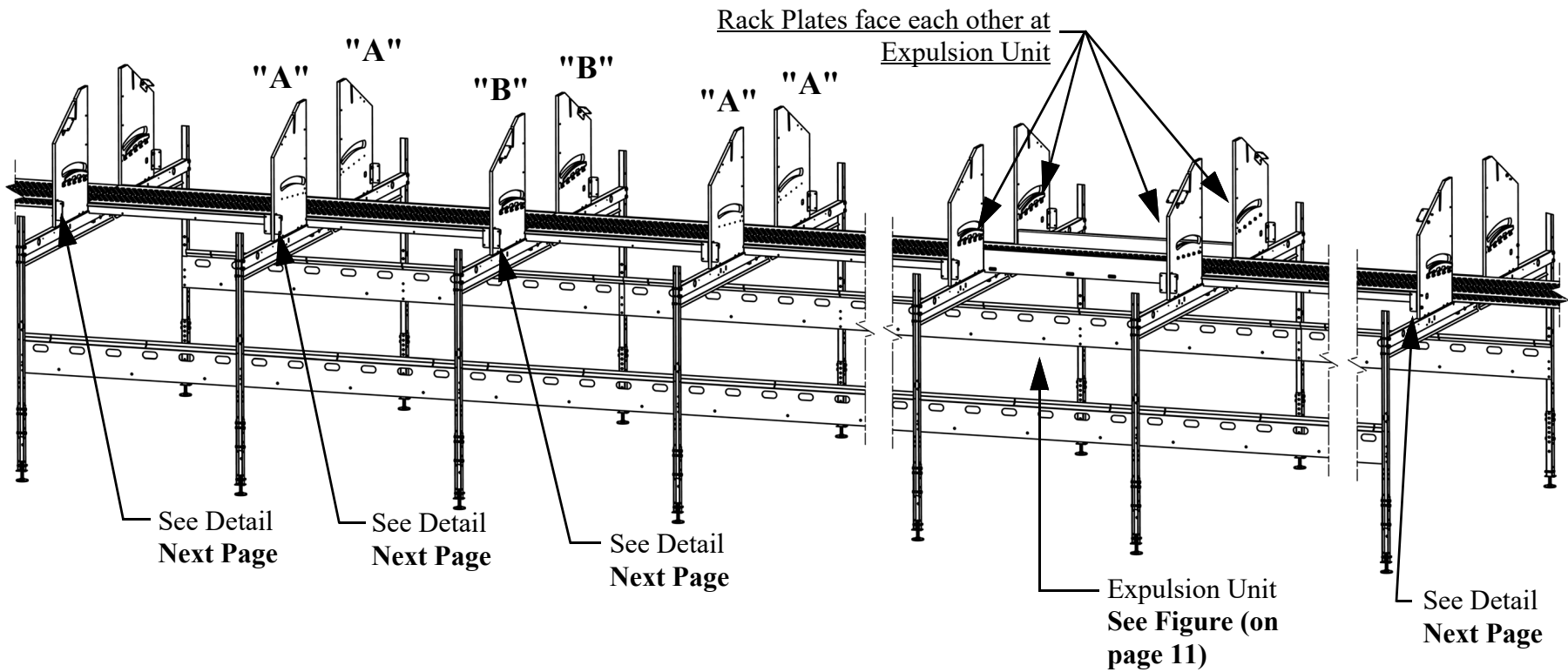
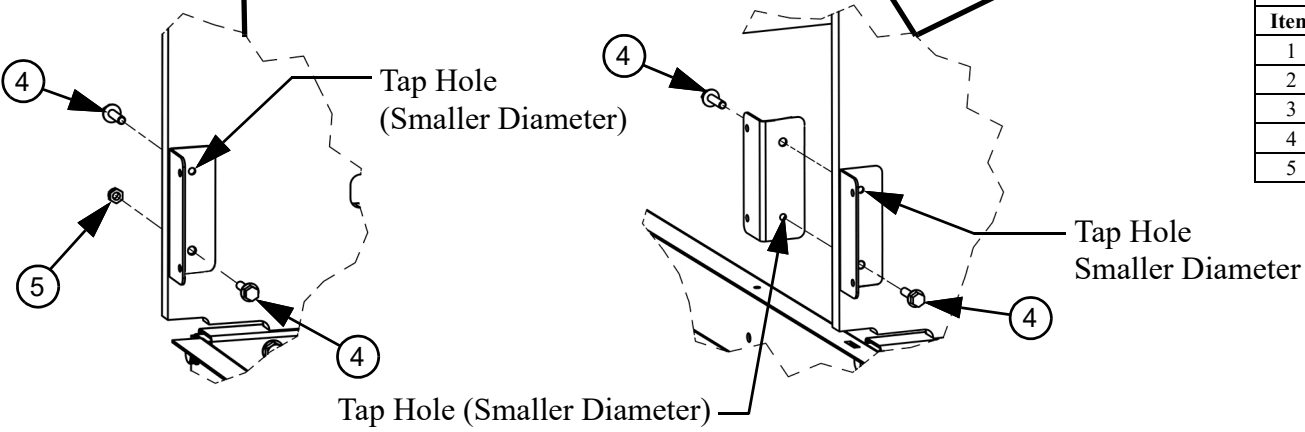
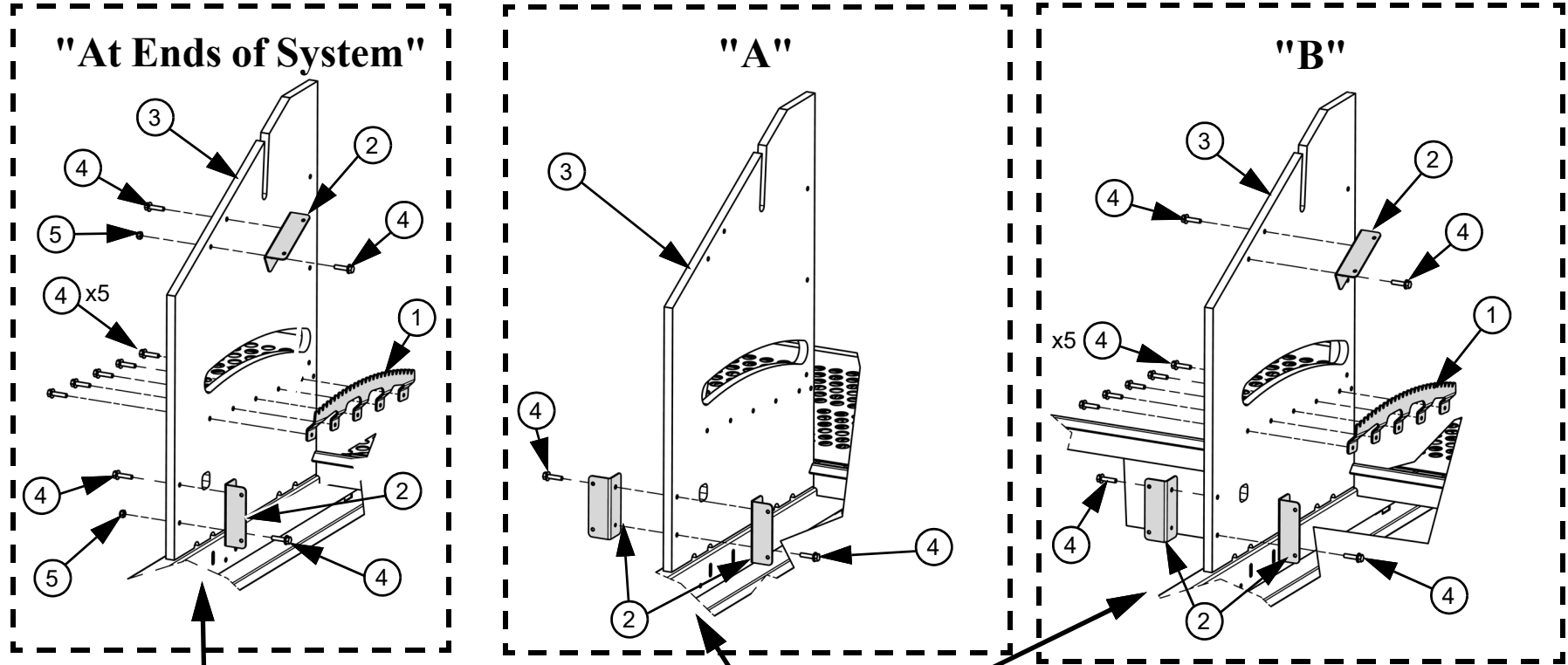
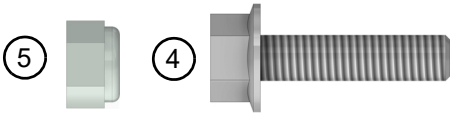

Figure 9.Rack Plate/Side Panels



Item	Description	RDE-49	RDE-58
		Part No.	
1	RDE Toothed Rack Plate	600602	56693
2	Corner Bracket	56692	56692
3	RDE Side Panel	58501	58502
4	M6 x 25 DIN7500-D Taptite	201067	201067
5	M6 DIN985 Lock Nut	201037	201037

Figure 10. Rack Plate/Side Panels



## At Expulsion Unit

Attach Corner Brackets and Hinges exactly the same on both sides of the system with Rack Plates towards the inside of the Expulsion Unit **as shown**.

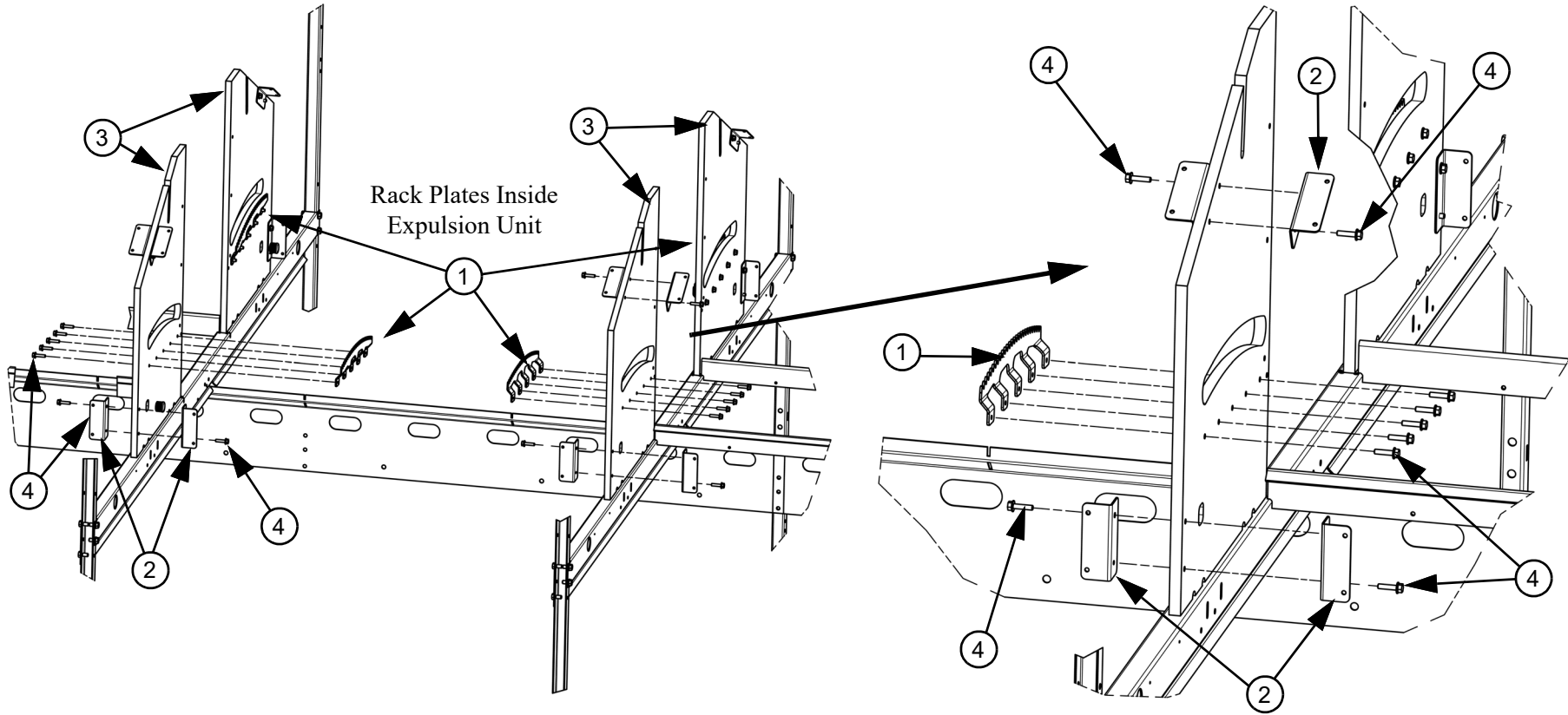

		RDE-49	RDE-58
Item	Description	Part No.	
1	RDE Toothed Rack Plate	600602	56993
2	Corner Bracket	56692	56692
3	RDE Side Panel	58501	58502
4	M6 x 25 DIN7500-D Taptite	201067	201067

## "At Expulsion Unit"

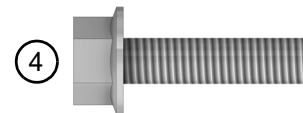
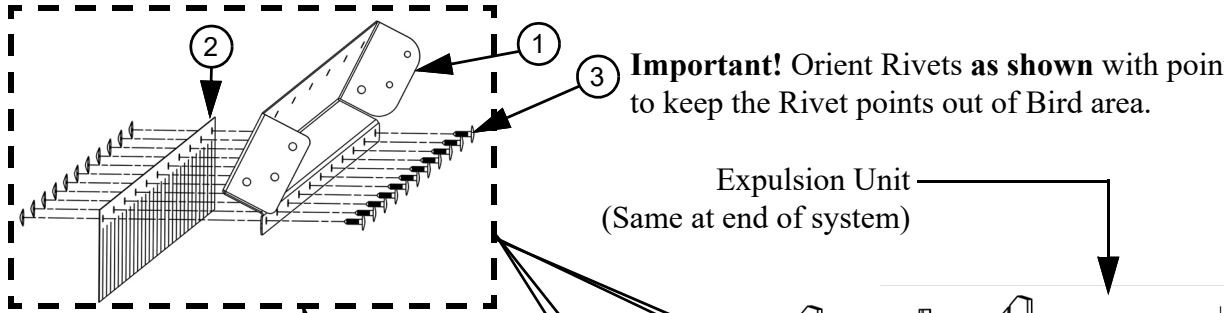

Figure 11. Rack Plate/Side Panels at Expulsion Unit

# Egg Curtains

- Important!** Orient Rivets **as shown** with Heads toward the Belt area to keep points of Rivets are away from the bird area.
1. Assemble Nest Back Rails (**Item 1**) to Egg Curtains (**Item 2**) with 2 Piece Rivets (**Item 3**) **as shown**.
  2. Attach the Egg Curtain Assembly you just assembled to the Side Panels with M6 Taptites (**Item 4**). Use Lock nuts (**Item 5**) at the end of the System.



Item	Description	Part No.
1	Nest Back Rail	56684
2	Egg Curtain	56863
3	2 Piece Rivet	56879
4	M6 x 25 DIN7500-D Taptite	201067
5	M6 DIN985 Lock Nut	201037

Figure 12.Egg Curtains

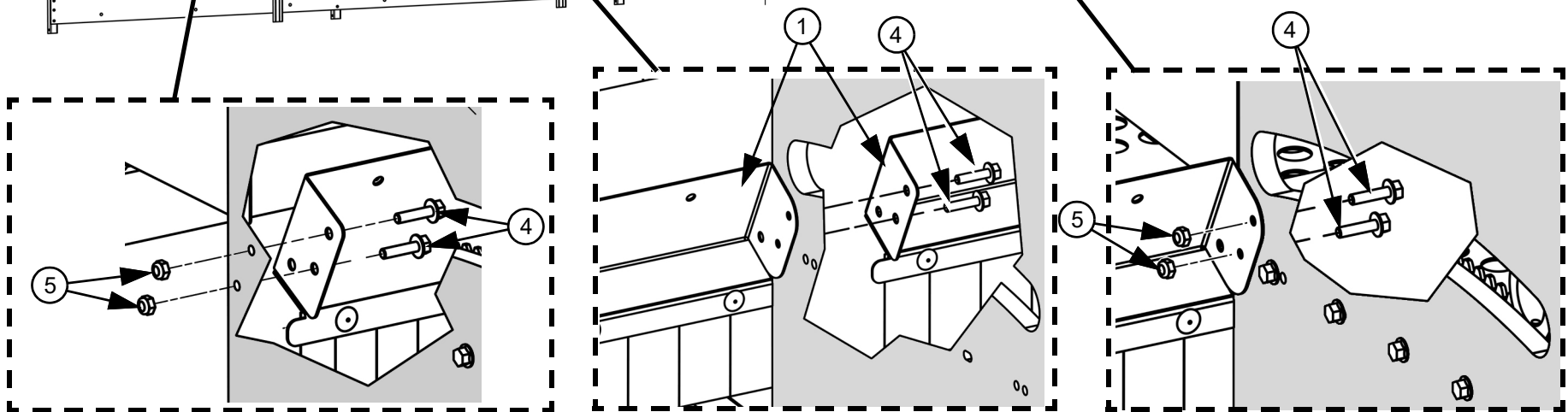

# Entrance Board Installation

**Important!** When fastening Entrance Boards install Screws in center of Board first to avoid out of square issues.

1. Attach Entrance Boards (**Item 1**) to the Corner Brackets with M6 Taptites (**Item 2**) as shown.
2. At the Expulsion Units use 1.2M Nest Entrance Boards (**Item 3**).

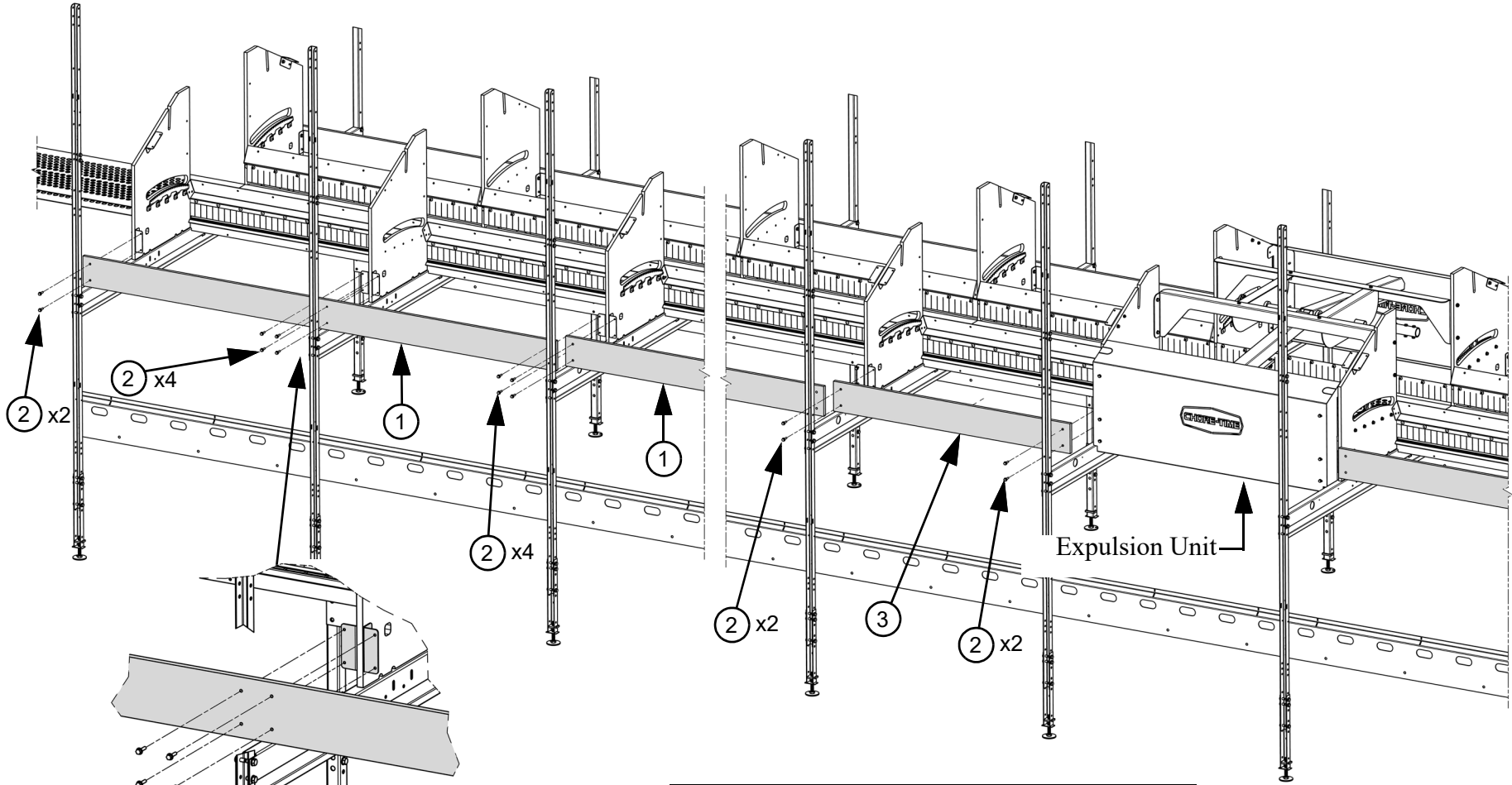

**2** x 4 Fasten Boards at center first to avoid out of square issues.

Item	Description	Part No.
1	2.4M Nest Entrance Board	56691
2	M6 x 25 DIN7500-D Taptite	201067
3	1.2M Nest Entrance Board	56691-1

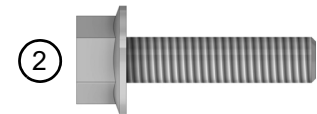

Figure 13. Entrance Boards

## Floor Pipe Installation

1. Install a Support Tube (**Item 1**) by inserting it into the square holes in the Side Panels (**Item 2**) as shown. Let the Tubes extend approximately 1-1/2" [3.81 cm] at the end of the system as shown.
2. Attach Tubes together using M6 Screws (**Item 3**) in the holes provided in the Tubes.
3. Tubes need to be cut off at the Expulsion Unit. Cut pipes leaving 1-1/2" [3.81 cm].
4. Install Plastic Caps (**Item 4**) in the ends of all of the Floor Support Tubes.

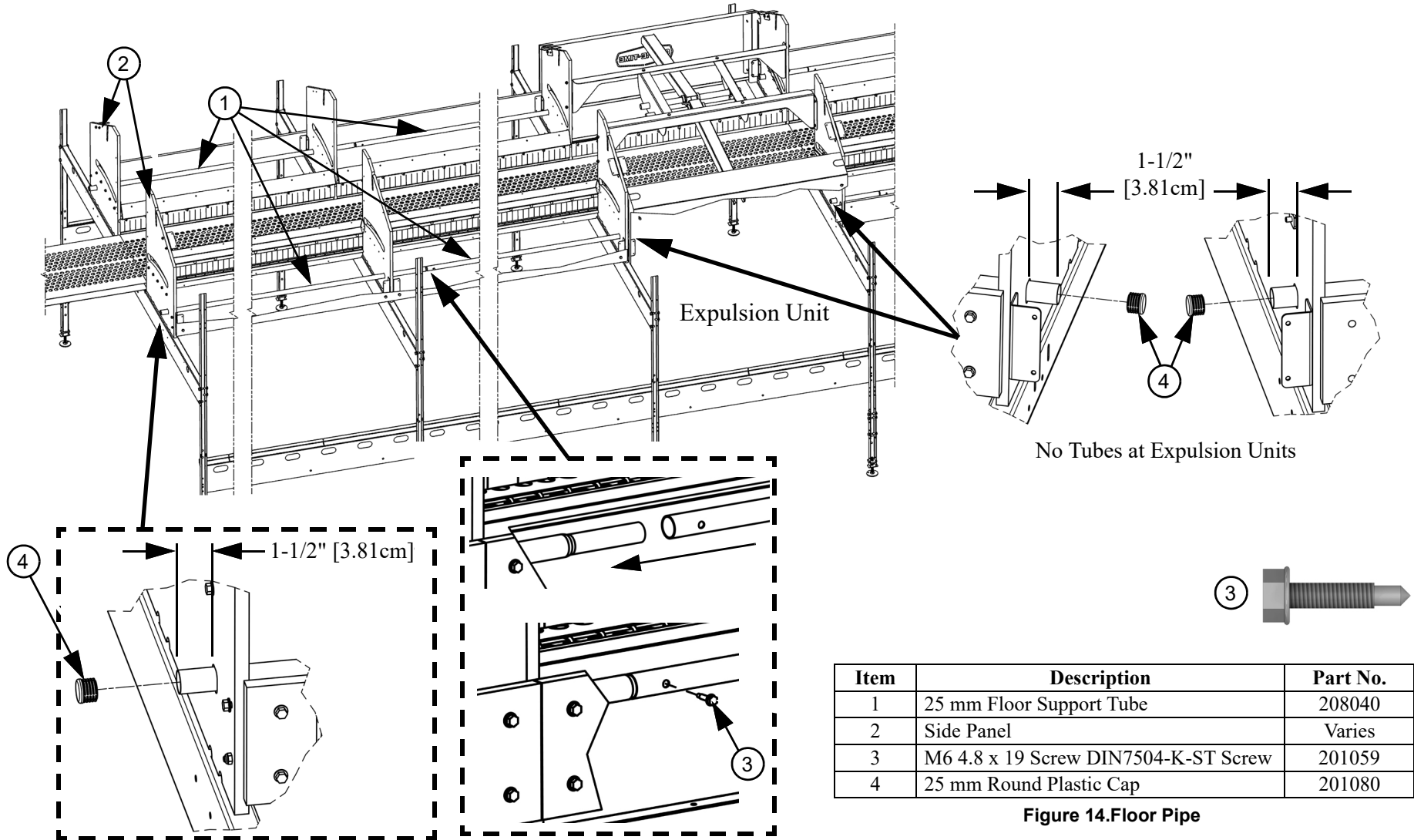
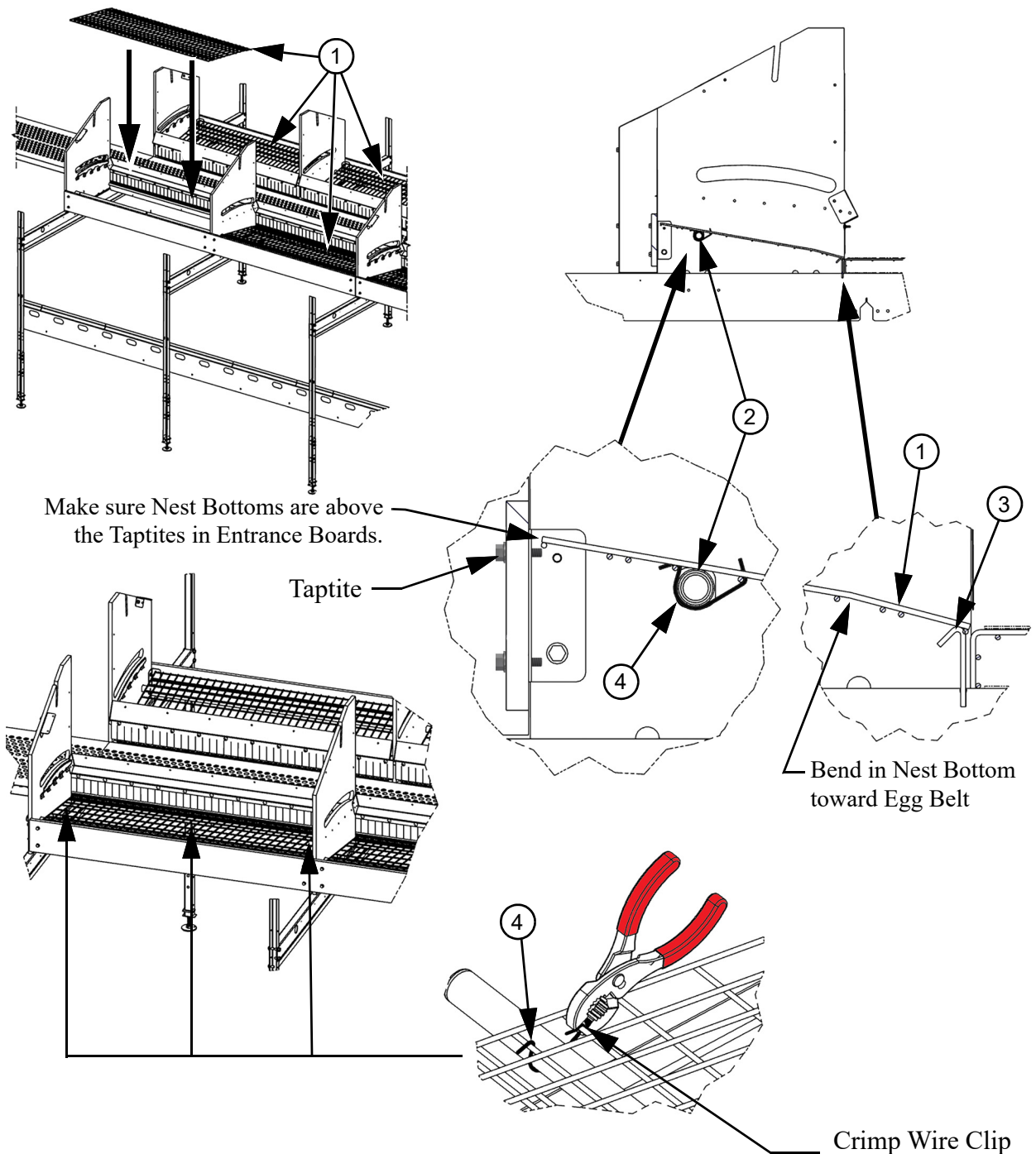

Figure 14.Floor Pipe

### Nest Bottom Installation

1. Install Nest Bottoms (**Item 1**) by centering them in each Nest section and resting them on the Floor Support Tubes (**Item 2**) and Nest Bottom Rails **as shown**. **Note** the direction of the Bend in Nest Bottom.
2. Fasten each Nest Bottom to the Floor Support Tubes by crimping on three Nest Floor Wire Clips (**Item 4**)



Item	Description	RDE-49	RDE-58
		Part No.	
1	RDE Nest Bottom	57128	57296
2	25 mm Floor Support Tube	208040	208040
3	Nest Bottom Rail	56683	56683
4	Nest Floor Wire Clip	57004	57004

Figure 15.Nest Bottom

### Nest Pad Installation

1. Slide two Nest Pad Clips (Item 1) onto each nest Pad (Item 2) as shown.
2. Place the Nest Pads on the Nest Bottoms while snapping the Nest Pad Clips onto the Nest Entrance Boards.

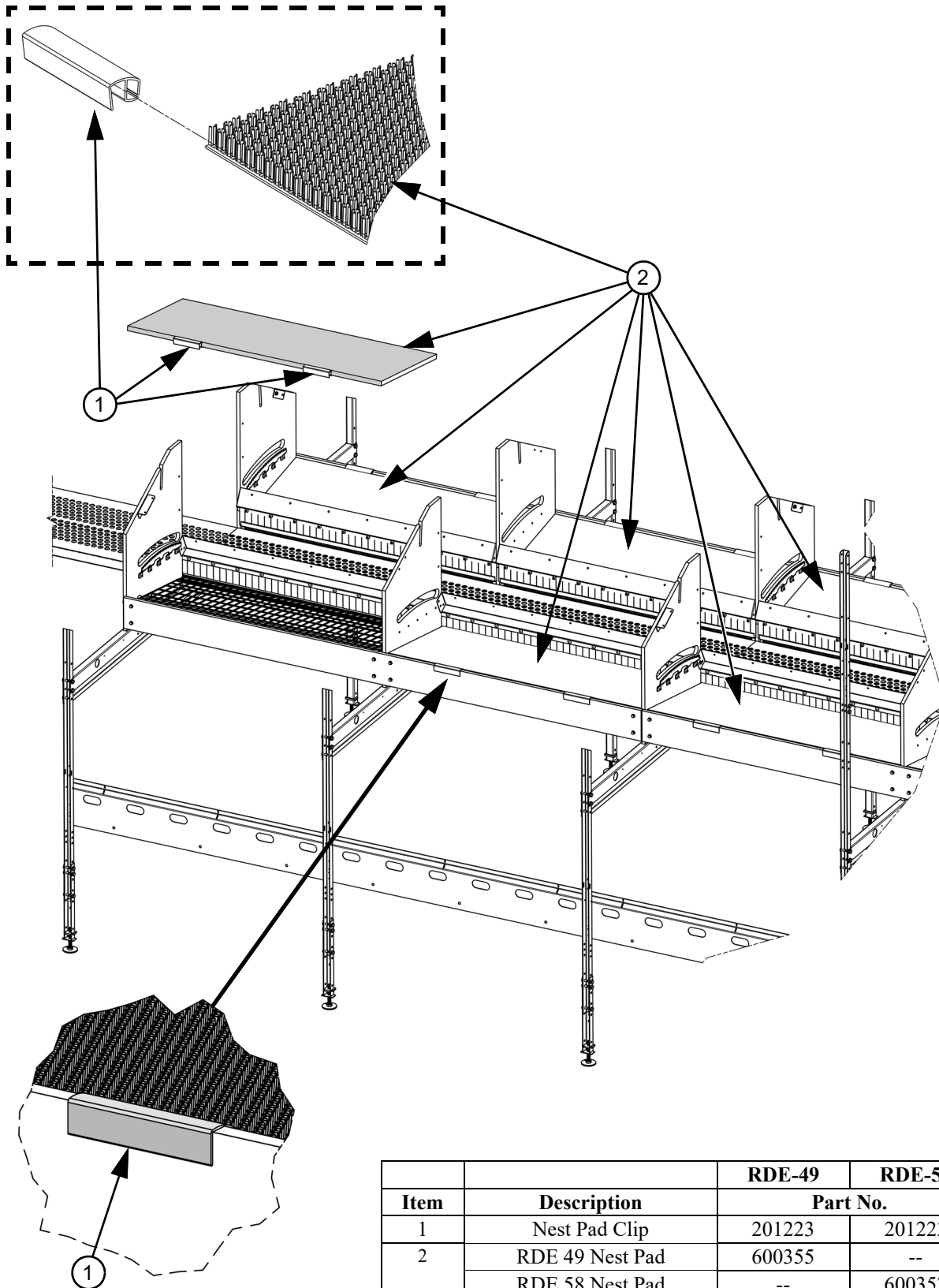

Figure 16. Nest Pad Installation

# Expulsion Unit

## Expeller Tube Support & Crosses

Note: Make sure that the Expulsion Plates are installed. See “Bottom Rails/Expulsion Plates” on page 7.

1. Fasten Expeller Tube Supports (Item 1) to Expeller Mount Crosses (Item 2) with M8 Hardware as shown.

2. Use the same Hardware to fasten the Expeller Mount Crosses to the Side Panels.

**Note 1:** No Floor Pipe or Nest Pad at Expulsion Unit. See “Floor Pipe Installation” on page 14.

**Note 2:** Use short Entrance Boards at Expulsion Units. See “Entrance Board Installation” on page 13.

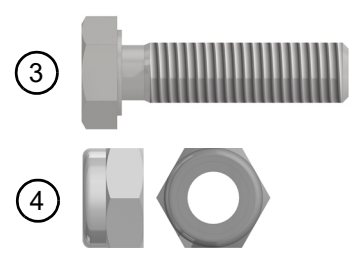
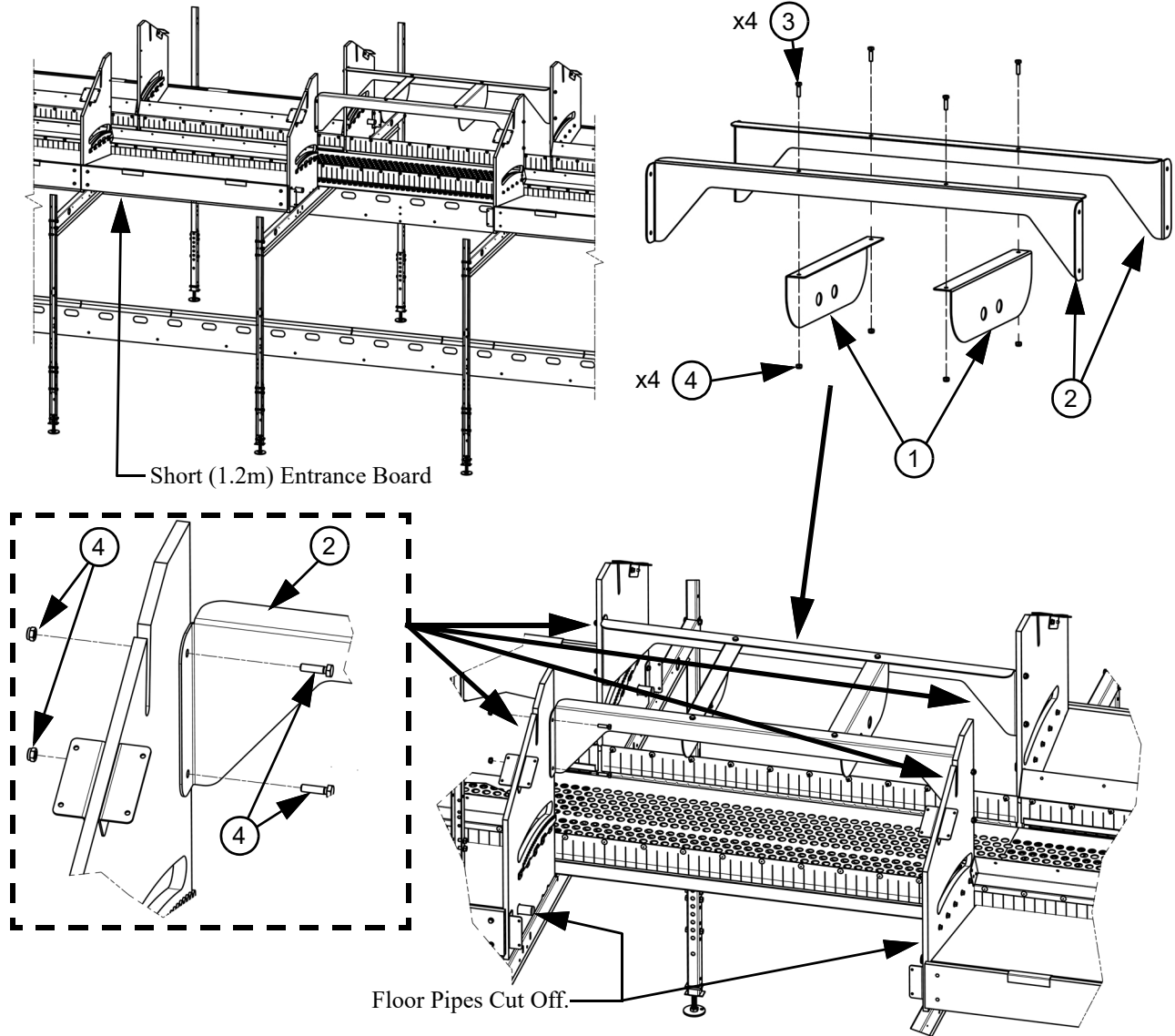

		RDE-49	RDE-58	RDE-49 600mm	RDE-58 600mm
<b>Item</b>	<b>Description</b>	<b>Part No.</b>			
1	Expeller Tube Support	57188	57188	58367	58367
2	Expeller Mount Cross	57187	57187	57187	57187
3	M8 x 30 DIN933 Hex Bolt	201007	201007	201007	201007
4	M8 DIN985 Lock Nut	201003	201003	201003	201003

Figure 17. Expeller Tube Support & Crosses

### Expeller Pipes

1. Insert Expeller Pipes (**Item 1**) into the Expeller Mounting Profiles (**Item 2**).
2. Slide Set Collars (**Item 3**) and Slide Bearings (**Item 4**) onto the Pipe and Insert the Pipe into the Expeller Tube Supports (**Item 5**) as shown.
3. Center the Pipes in the Tube Supports and torque the Outside Set Collars to 6.3 ft./lbs. [5 Nm].

**Important!** Do not torque the inside Set Collars at this time (See Figure).

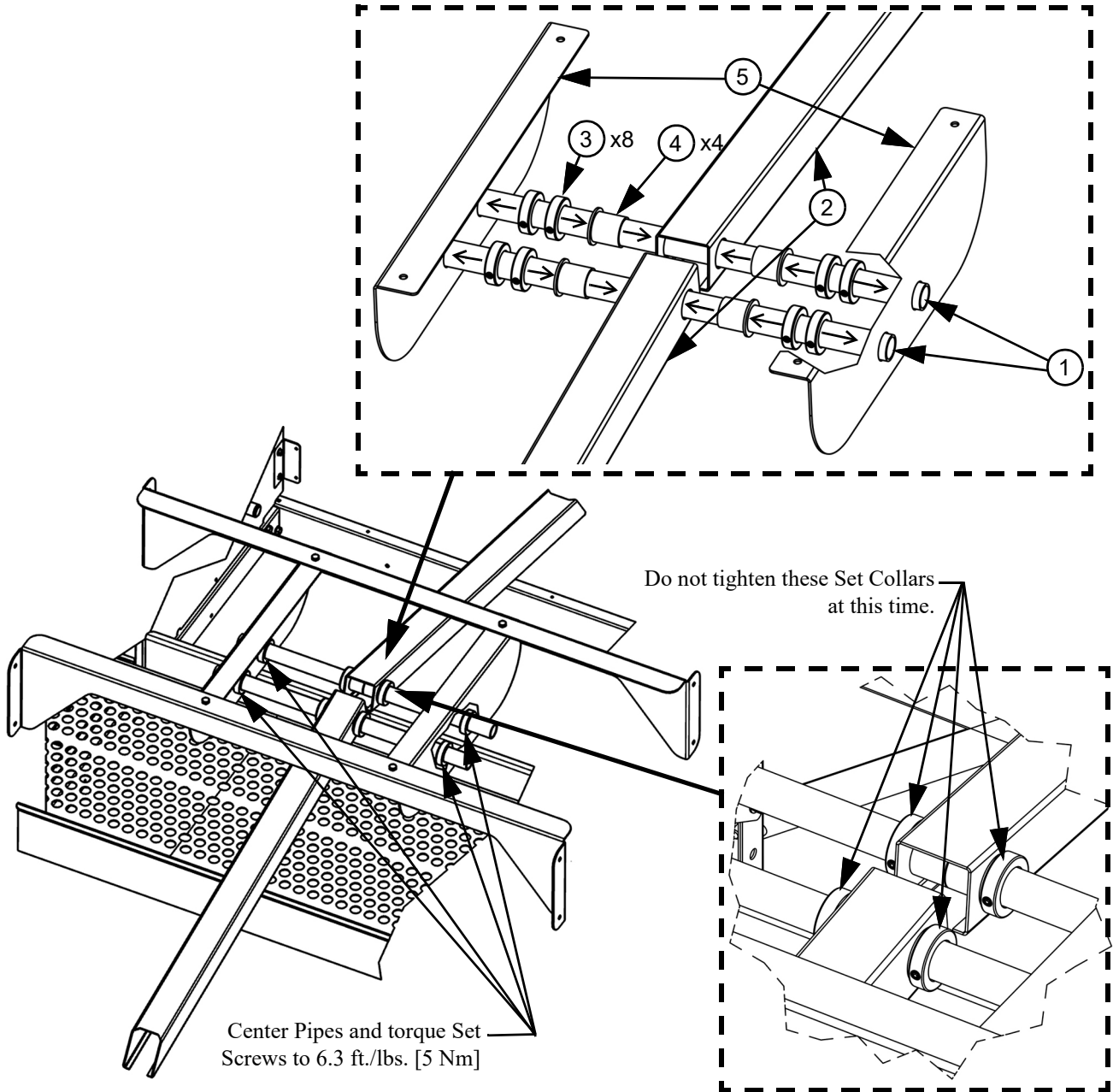

Item	Description	RDE-49	RDE-58	RDE-49 600mm	RDE-58 600mm
		Part No.			
1	500 MM RDE Mounting Profile Expeller Pipe	600638	600638	600638	600638
2	RDE-49 Expeller Mounting Profile	600630	--	600630	--
	RDE-58 Expeller Mounting Profile	--	600646	--	600646
3	32 MM DIN705A Set Collar	201140	201140	201140	201140
4	30x34x26MM Plastic Axle Slide Bearing	201139	201139	201139	201139
5	Expeller Tube Support	57188	57188	58367	58367

Figure 18.Expeller Pipes

### Motor Installation

1. Fasten Motor Mounting Plates (Item 1) to the Motors (Item 2) with M8 Hardware as shown.
2. Slide the Motors onto the Expeller Channels (Item 5) as shown.

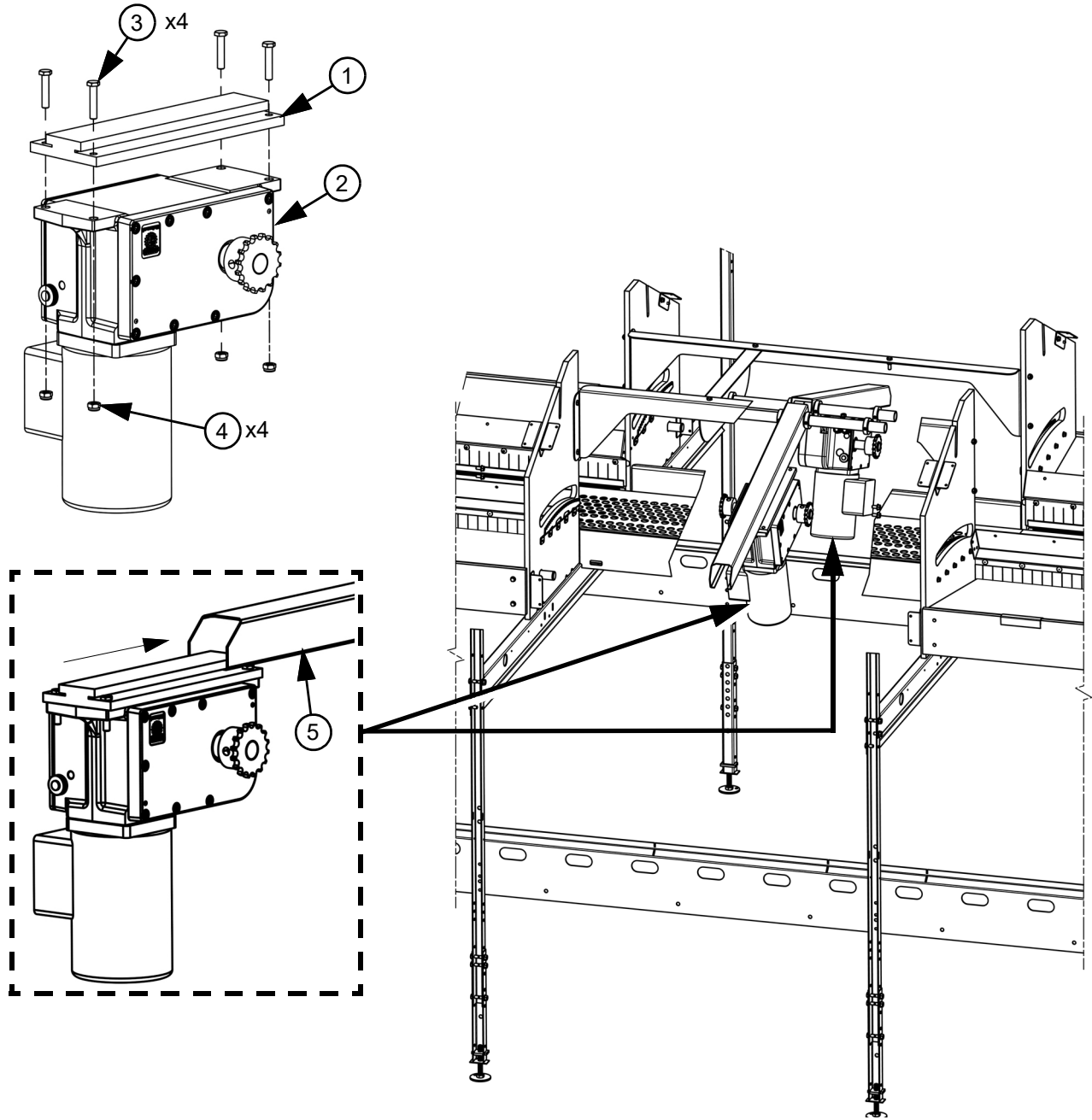

Item	Description	RDE-49	RDE-58
		Part No.	
1	Motor Mounting Plate	600631	600631
2	50 Hz Motor (EU)	603104	603104
	60 Hz Motor (US)	603119	603119
3	M8 X 40 DIN933 Hex Bolt	201053	201053
4	M8 DIN985 Lock Nut	201003	201003
5	Expeller Mounting Profile	600630	600646

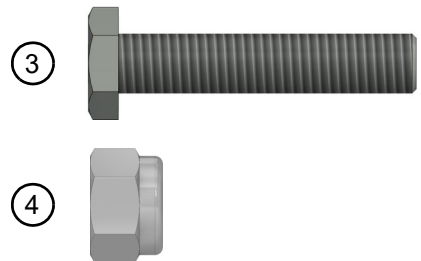
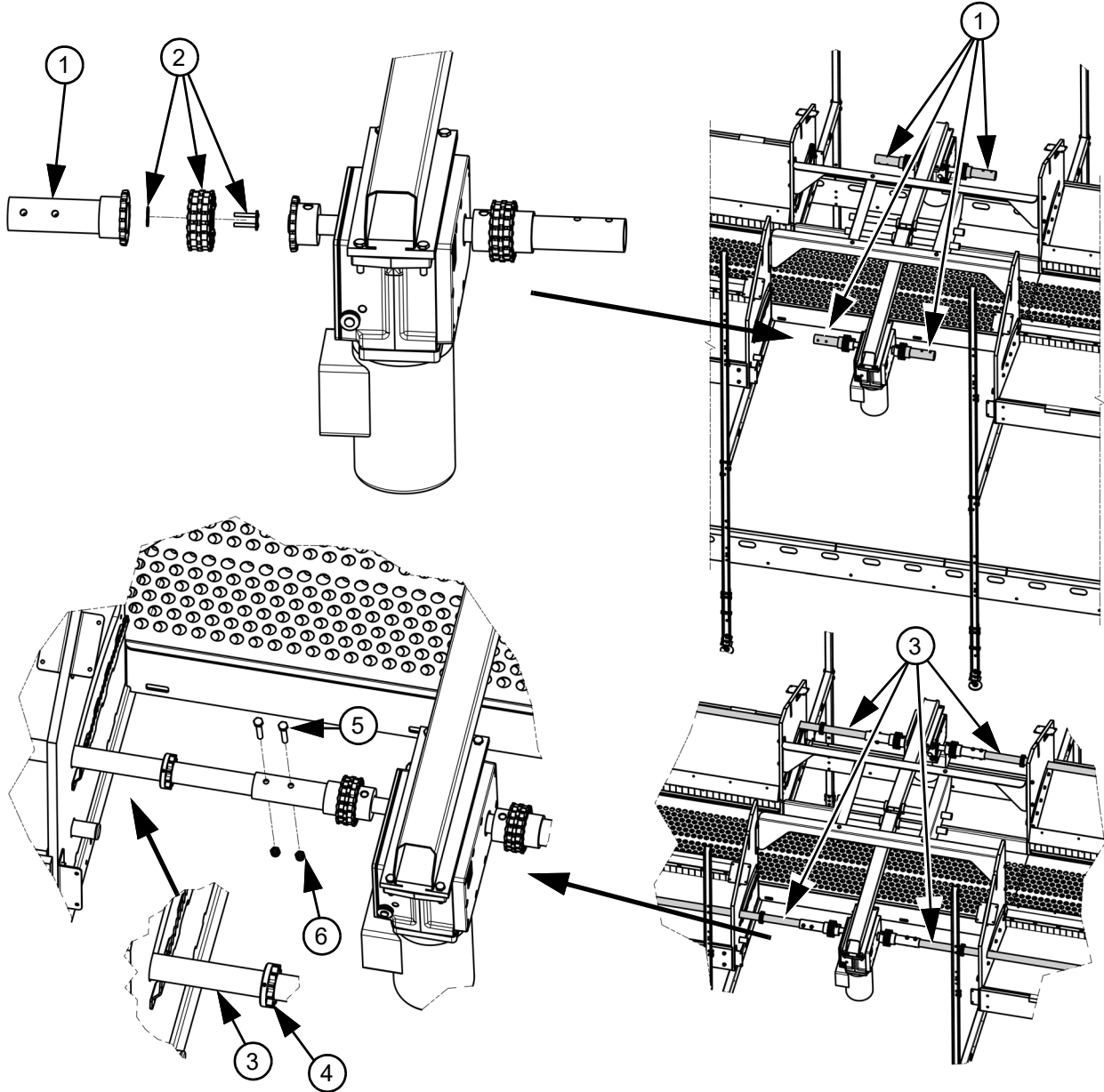

Figure 19. Motor Installation

### Expulsion Tube Installation

1. Fasten Expulsion Shaft Couplings (**Item 1**) to the Motor Shaft Couplings using Chain Couplings (**Item 2**) as shown.
2. Insert Expulsion Shafts (**Item 3**) in the Slots in the Side Panels and slide on Toothed Wheels (**Item 4**) oriented with Teeth in the direction shown.
3. Insert the Expulsion Shafts (**Item 3**) into the Expulsion Shaft Couplings and Fasten with M8 Hardware.
4. **Do Not** tighten Set Screws on the Toothed Wheels at this time.



Item	Description	Part No.
1	Expulsion Shaft Coupling	603140
2	Chain Couplings	603113
3	Expulsion Shaft	208050
4	Single Sided Toothed Wheel	600622
5	M8 x 50 DIN 933 Hex Bolt	201006
6	M8 DIN 985 Lock Nut	201003



Figure 20. Expulsion Tube Installation

5. Move the Expulsion Shafts all the way toward the front of the Nest **as shown**.
6. Line up the Teeth in the Toothed Wheels (**Item 1**) with the Teeth on the Toothed Rack Plates (**Item 2**). Orient Toothed Wheels with one Set Screw toward the front of Nest and the other up **as shown**. This will make adjustment easier later! **Do Not** tighten Set Screws on Toothed Wheels at this time.
7. Tighten the four Set Collars on the Mounting Profile Expeller Pipes (**Item 3**) to 6.3 ft./lbs. [5 Nm].
8. **Do not** tighten Set Screws on Toothed wheels at this time.

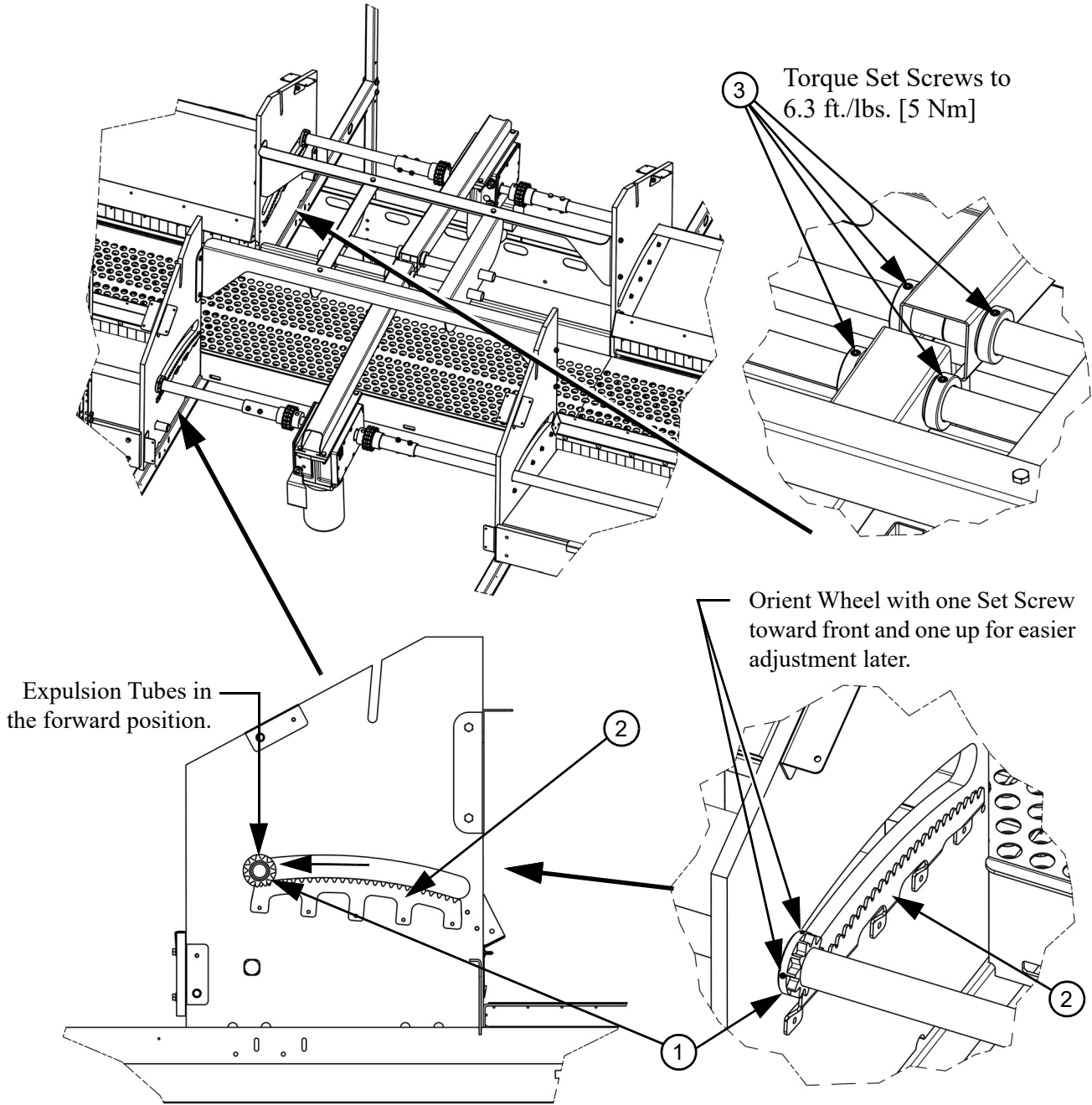

Item	Description	RDE-49	RDE-58
		Part No.	
1	Single Sided Toothed Wheel	600622	600622
2	RDE-49 Toothed Rack Plate	600602	--
	RDE-58 Toothed Rack Plate	--	56993
3	32 MM DIN705A Set Collar	201140	201140

Figure 21. Expulsion Tube Installation continued

## Expulsion Shafts Connections

**Note:** There is a Single Sided Toothed Wheel at every Side Panel that has a Toothed Rack Plate.

1. **Important!** Make Sure that the Expulsion Shafts are in the forward position.
2. Set a Single Sided Toothed Wheel (**Item 1**) on every Toothed Rack Plate (**Item 2**) orienting them with the Set Screws facing toward front and top of nest **as shown**. **Do not** Tighten Set Screws at this time.
3. Slide the Expulsion Tubes (**Item 3**) through the Toothed Wheels and connect them together with M8 x 50 Bolts (**Item 4**) and M8 Locking Nuts (**Item 5**).
4. Continue connecting Expulsion Tubes until you reach the Expulsion Unit, or the end of the system. **Do Not** tighten set screws on Toothed wheels at this time.

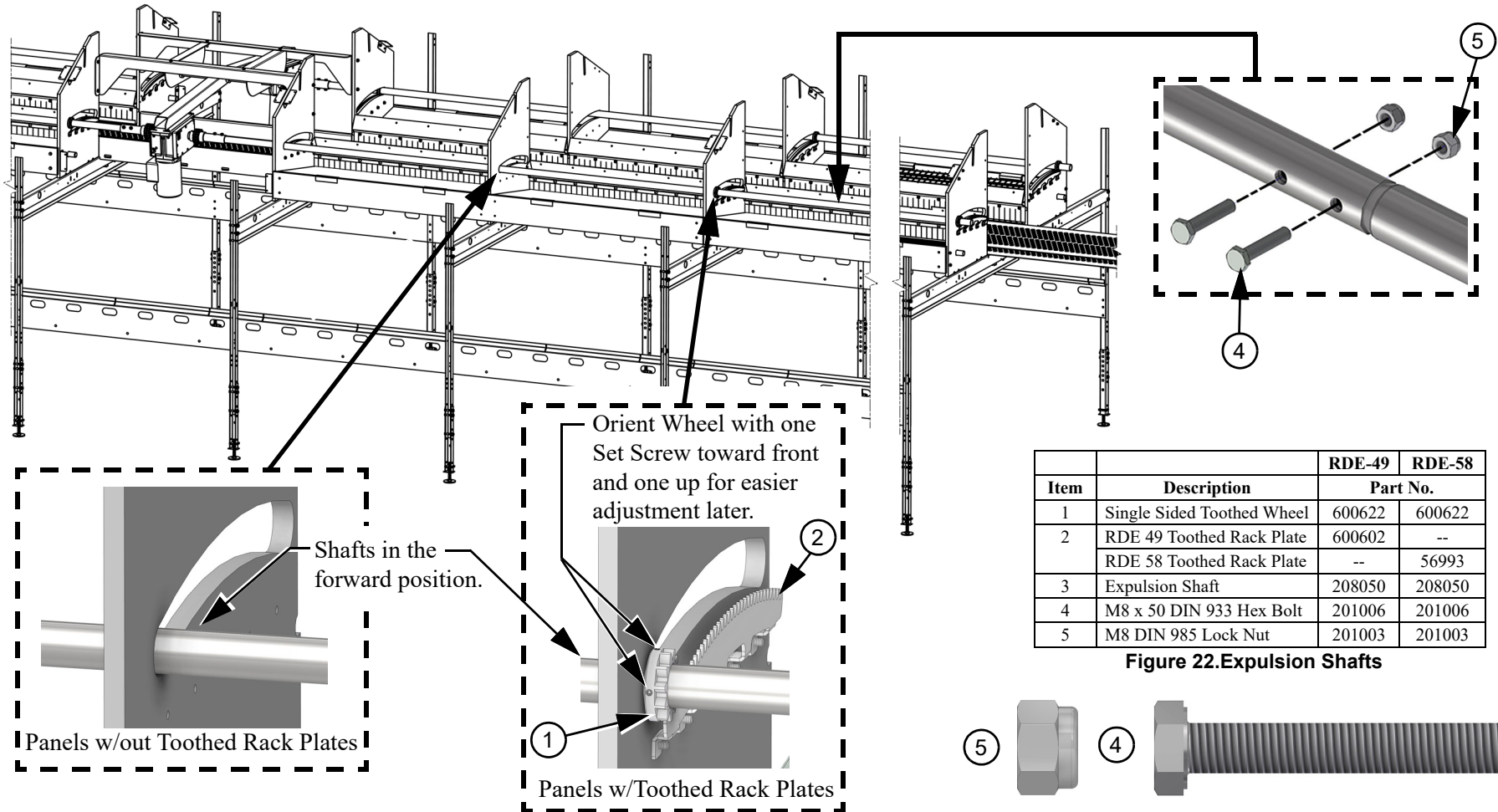

## Expulsion Shafts/Caps

### Ends of the System

1. Continue Connecting Expulsion Shafts (**Item 1**) together until you reach the end of the system.
2. Cut Shafts off at the End of the System and Install Expulsion Shaft Caps (**Item 2**) as shown.
3. **Important!** Do not tighten the Toothed Wheels at this time. They will be tightened in the next step.

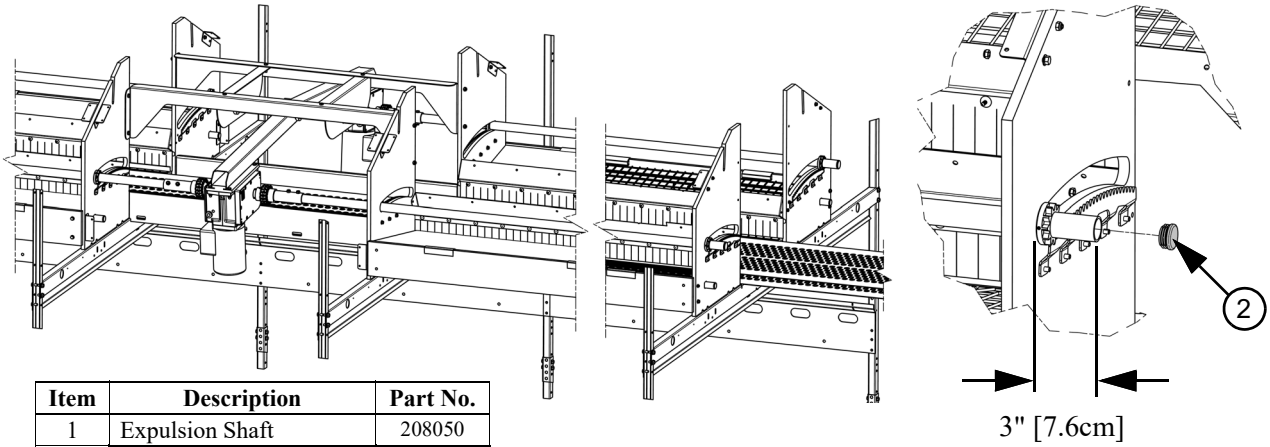

Item	Description	Part No.
1	Expulsion Shaft	208050
2	Expulsion Shaft Cap	201038

Figure 23. Expulsion Shafts/Caps

### Center of System (Systems more than 50 sections with two Expulsion Units)

Expulsion Shafts need to be cut and separated at the center between Expulsion Units so Rack Plates and Toothed Wheels are required at the end of each of the Tubes.

1. Drill the five holes out to 1/4" [6.35mm] in two Rack Plates (**Item 1**).
2. Use M6 Taptites (**Item 2**) in those through holes to attach Rack Plates to Panels as shown.

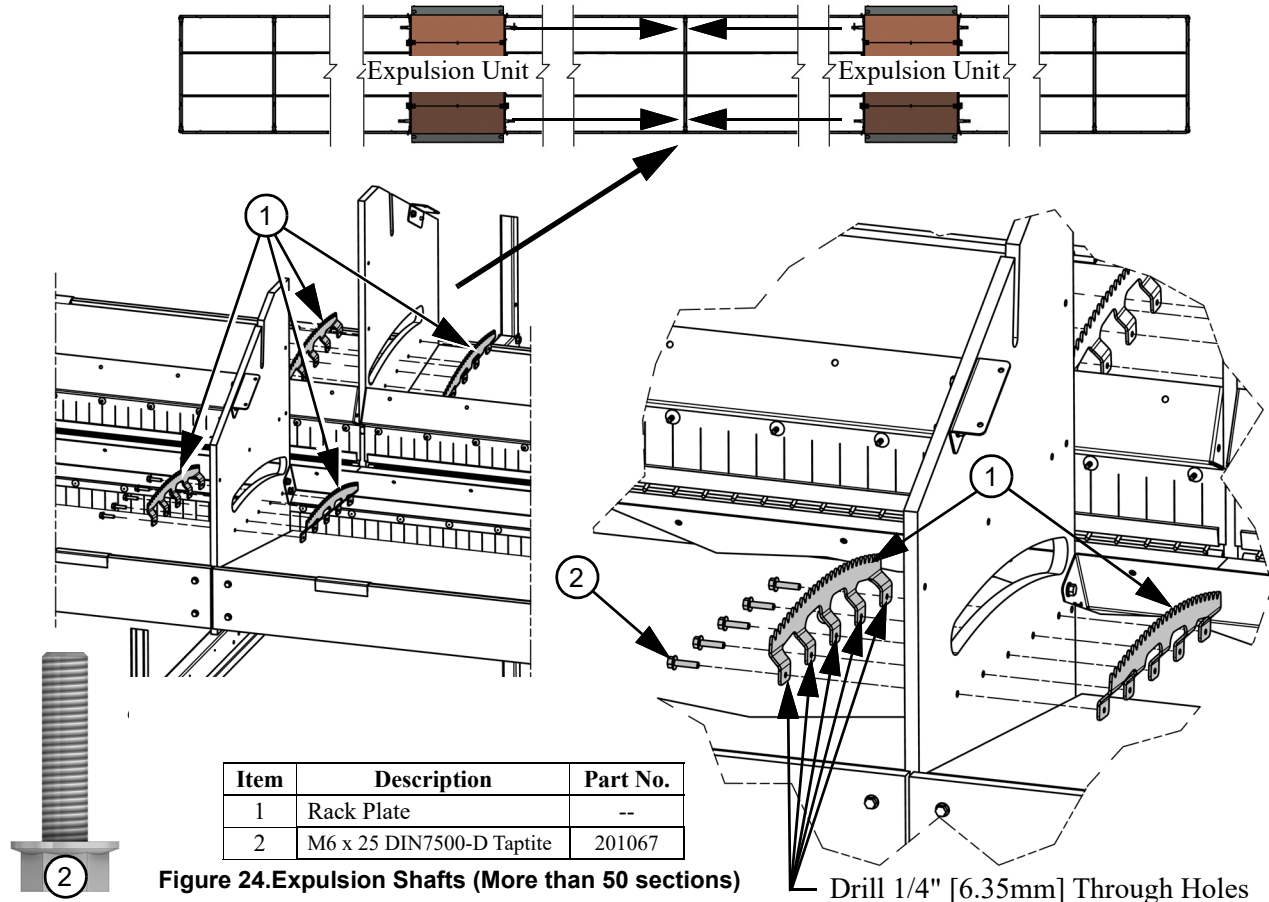

Item	Description	Part No.
1	Rack Plate	--
2	M6 x 25 DIN7500-D Taptite	201067

Figure 24. Expulsion Shafts (More than 50 sections)

Drill 1/4" [6.35mm] Through Holes

3. Cut off both Expulsion Shaft **(Item 1)** Flush with the RDE Panel **as shown**.
4. Install Expulsion Shaft Caps **(Item 2)** in the end of the Shafts.
5. Install Single Sided Toothed Wheels **(Item 2)**, **as shown**. **Do not** tighten Set Screws at this time.

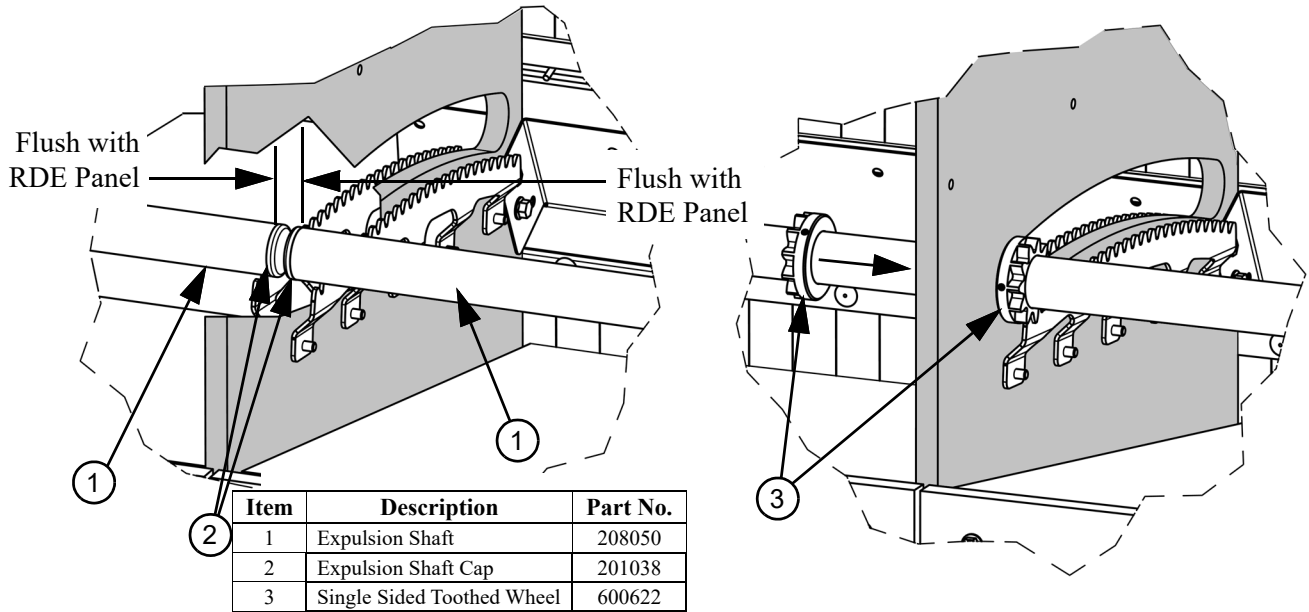

**Figure 25. Expulsion Shafts (Caps)**

6. Temporarily Set a spare Toothed Wheel on the Rack Plates **(Item 1)** to use as a guide to position the Tube Hold Downs **(Items 2 & 3)** **as shown**. Make sure Notches are oriented toward Belt area. Leave a 1/16" [1.6mm] Gap between the top of the Toothed Wheels and the RDE Tube Hold Downs.
7. Drill three 1/4" [6.35mm] holes in each RDE Side Panels using the holes as guides **as shown**.
8. Fasten the RDE Tube Hold Downs to the Side Panels with M6 hardware.

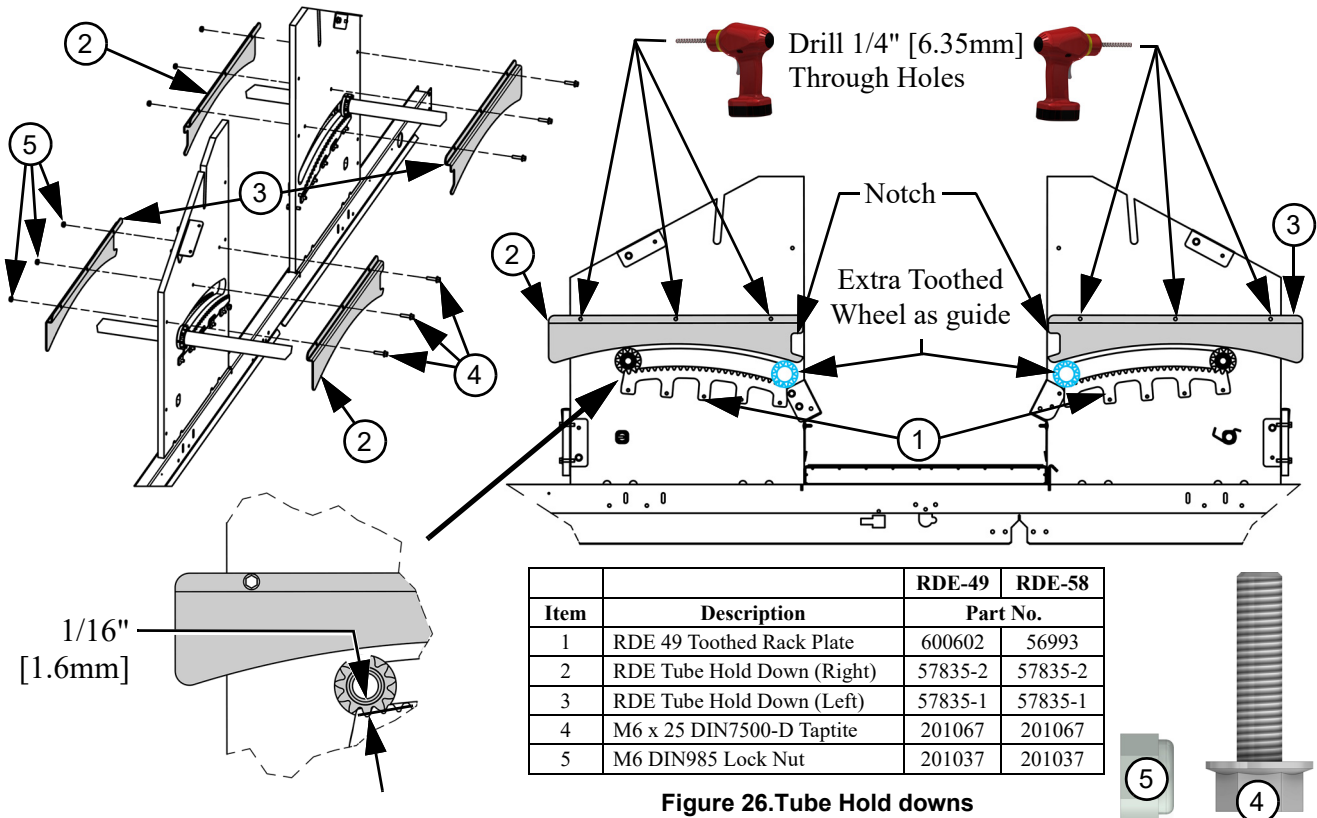
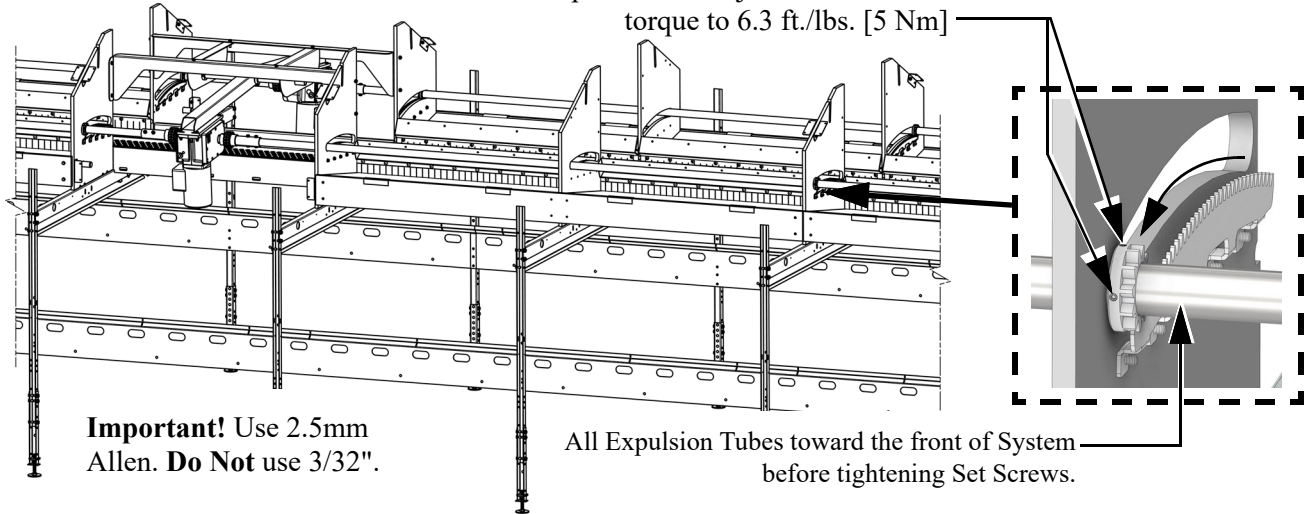

**Figure 26. Tube Hold downs**

### Tightening down Toothed Wheels on Expulsion Shafts

1. Make sure the Expulsion Tubes are all toward the front of the nest as **shown**.
2. **Important!** Rotate the Toothed Wheels so the Set Screws are toward the front and top of the nest and torque all of the Set Screws to 6.3 ft./lbs. [5 Nm] using a 2.5mm Allen Wrench. **Do not** use a 3/32" Allen Wrench to avoid stripping the Set Screws. Proper orientation of the Set Screws allows for easy adjustment later.

Orient Wheel with one Set Screw toward front  
and one up for easier adjustment later and  
torque to 6.3 ft./lbs. [5 Nm]



**Important!** Use 2.5mm Allen. **Do Not** use 3/32".

All Expulsion Tubes toward the front of System before tightening Set Screws.

Figure 27. Tightening Down Toothed Wheels to Expulsion Shafts

### Expulsion Unit Cover

#### Side Braces

1. Fasten Cover Side Braces (Items 1 & 2) with M6 x 16 Bolts (Item 3) as shown.

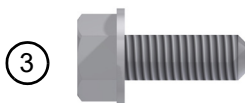
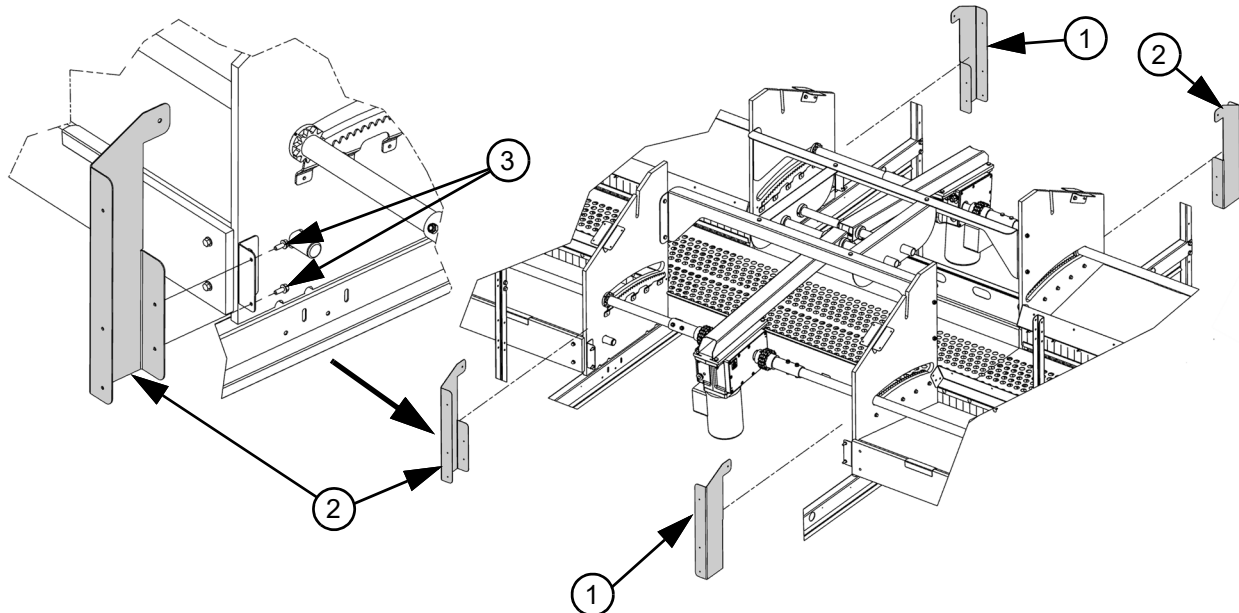

Item	Description	Part No.
1	RDE Cover Side Brace (Right)	57213-1
2	RDE Cover Side Brace (Left)	57213-2
3	M6x16 DIN7500D Taptite	201077

Figure 28. Expulsion Cover Side Braces

### Front Cover

1. Fasten the Front Covers (Item 1) with M6 Taptites (Item 2) as shown.

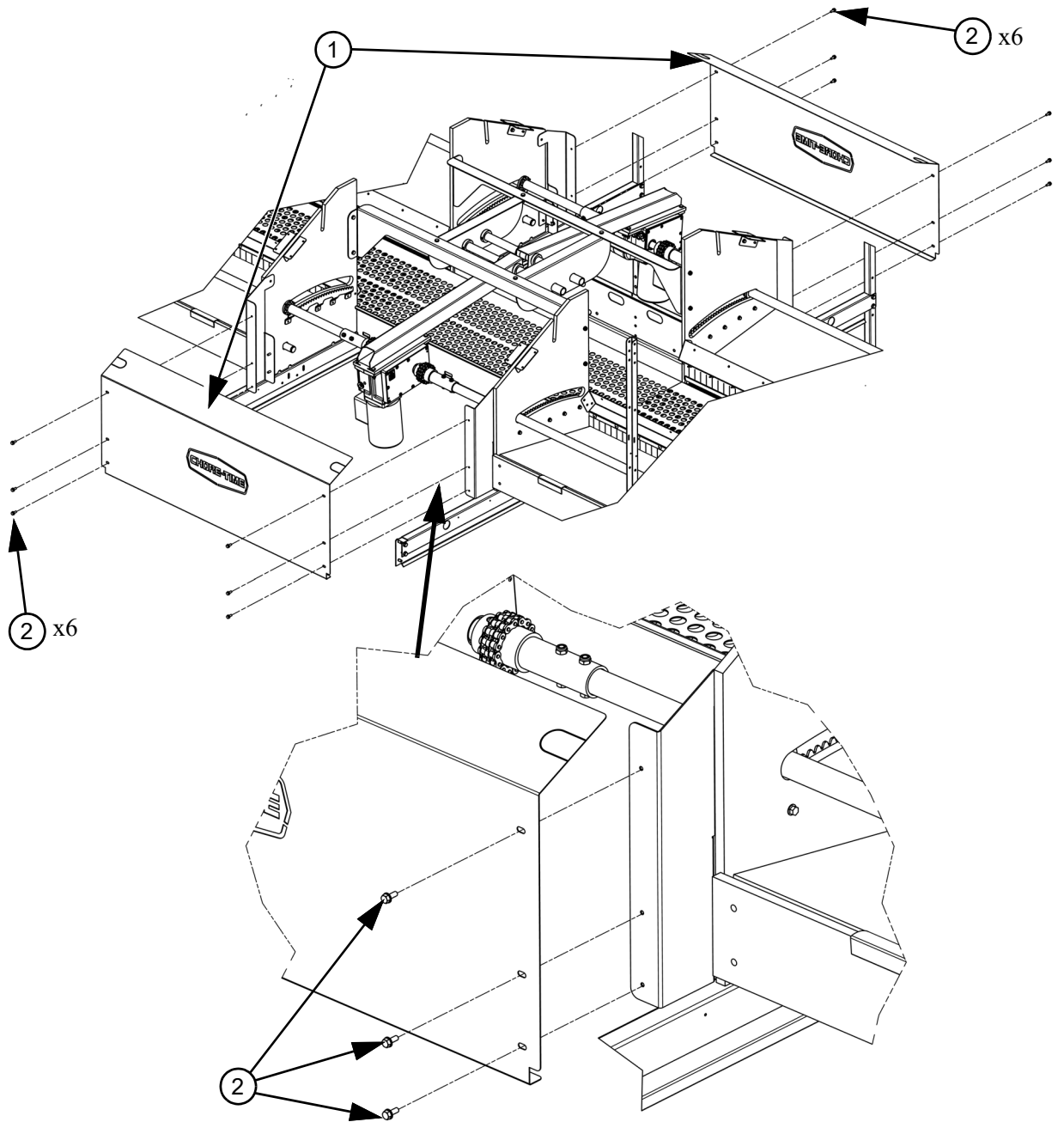

Item	Description	Part No.
1	RDE Front Expulsion Cover	57212
2	M6x16 DIN7500D Taptite	201077

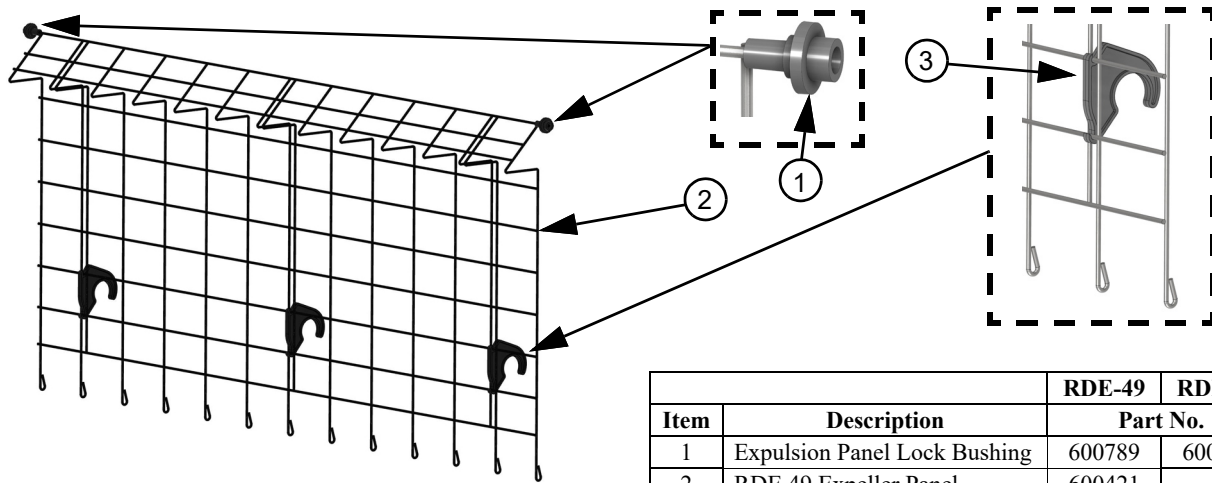

Figure 29. Expulsion Front Covers

## Expeller Installation

### Expeller Panel Assembly

1. Install two Panel Lock Bushings (**Item 1**) per Expeller Panel (**Item 2**).
2. Attach three Panel Clamps (**Item 3**) per Panel in the locations shown.



Item	Description	RDE-49	RDE-58
		Part No.	
1	Expulsion Panel Lock Bushing	600789	600789
2	RDE 49 Expeller Panel	600421	--
	RDE 58 Expeller Panel	--	58783
3	Expulsion Panel Clamp	600795	600795

Figure 30. Assembling Expeller Panel

### Expeller Panel Installation

1. Insert the Panel Lock Bushings (Item 1) of the Expeller Panel Assembly (Item 2) into the Slots of the Side Panels and snap the Panel Clamps (Item 3) onto the Expulsion Shafts as shown.

Position Expulsion Shaft all the way toward the front of the Nest as shown for easier assembly.

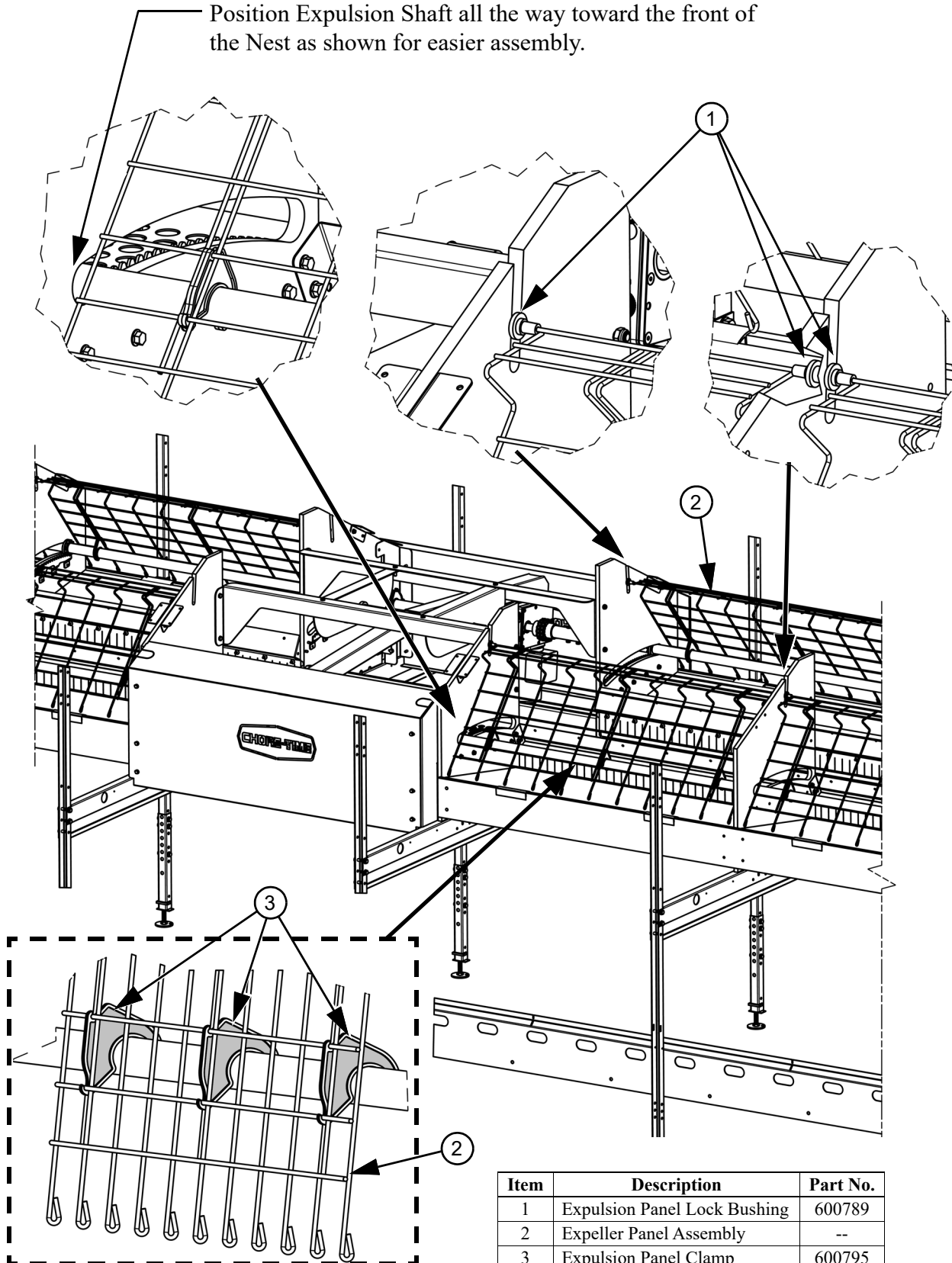

Item	Description	Part No.
1	Expulsion Panel Lock Bushing	600789
2	Expeller Panel Assembly	--
3	Expulsion Panel Clamp	600795

Figure 31. Installing Expeller Panels

### Back Wall Installation

1. Attach RDE Back Walls (**Item 1**) to the Expeller Panels (**Item 2**) with Wire Mesh Staples (**Item 3**) or Wire Rings (**Item 4**), 4 per Panel, using Mesh Staple Pliers (**Item 5**) or a Ring Tool (**Item 6**) as shown.

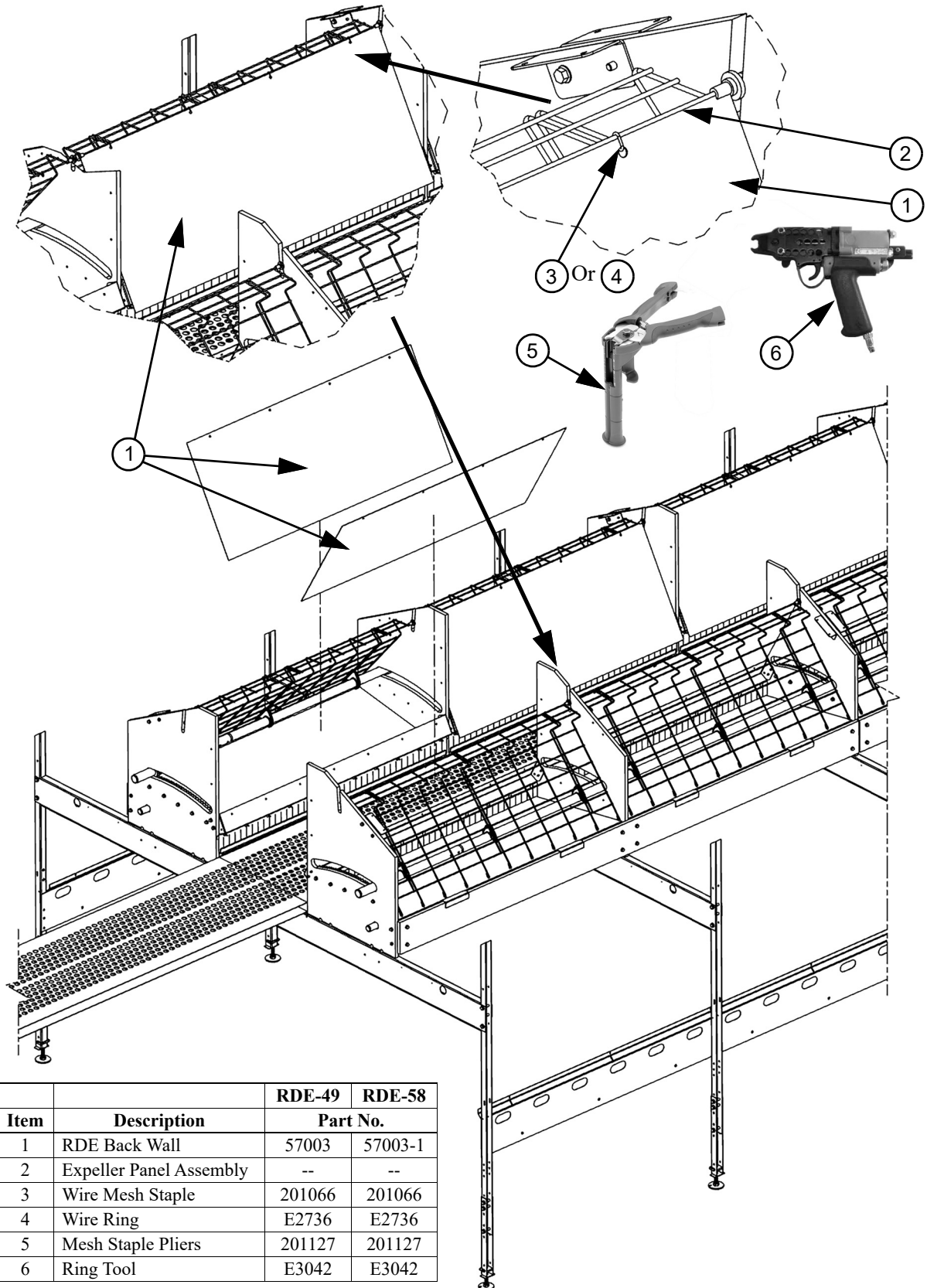

		RDE-49	RDE-58
Item	Description	Part No.	
1	RDE Back Wall	57003	57003-1
2	Expeller Panel Assembly	--	--
3	Wire Mesh Staple	201066	201066
4	Wire Ring	E2736	E2736
5	Mesh Staple Pliers	201127	201127
6	Ring Tool	E3042	E3042

Figure 32. Installing Back Wall

### Curtain/Roof Assembly & Installation

1. Fasten Nest Front Curtains (**Items 1 & 2**) to Roof Panels (**Item 3 or 4**) with Two Piece Rivets (**Item 5**) as shown.
2. Fasten the Curtain and Roof Panel Assemblies to the Corner Brackets with M6 Tapites (**Item 6**).

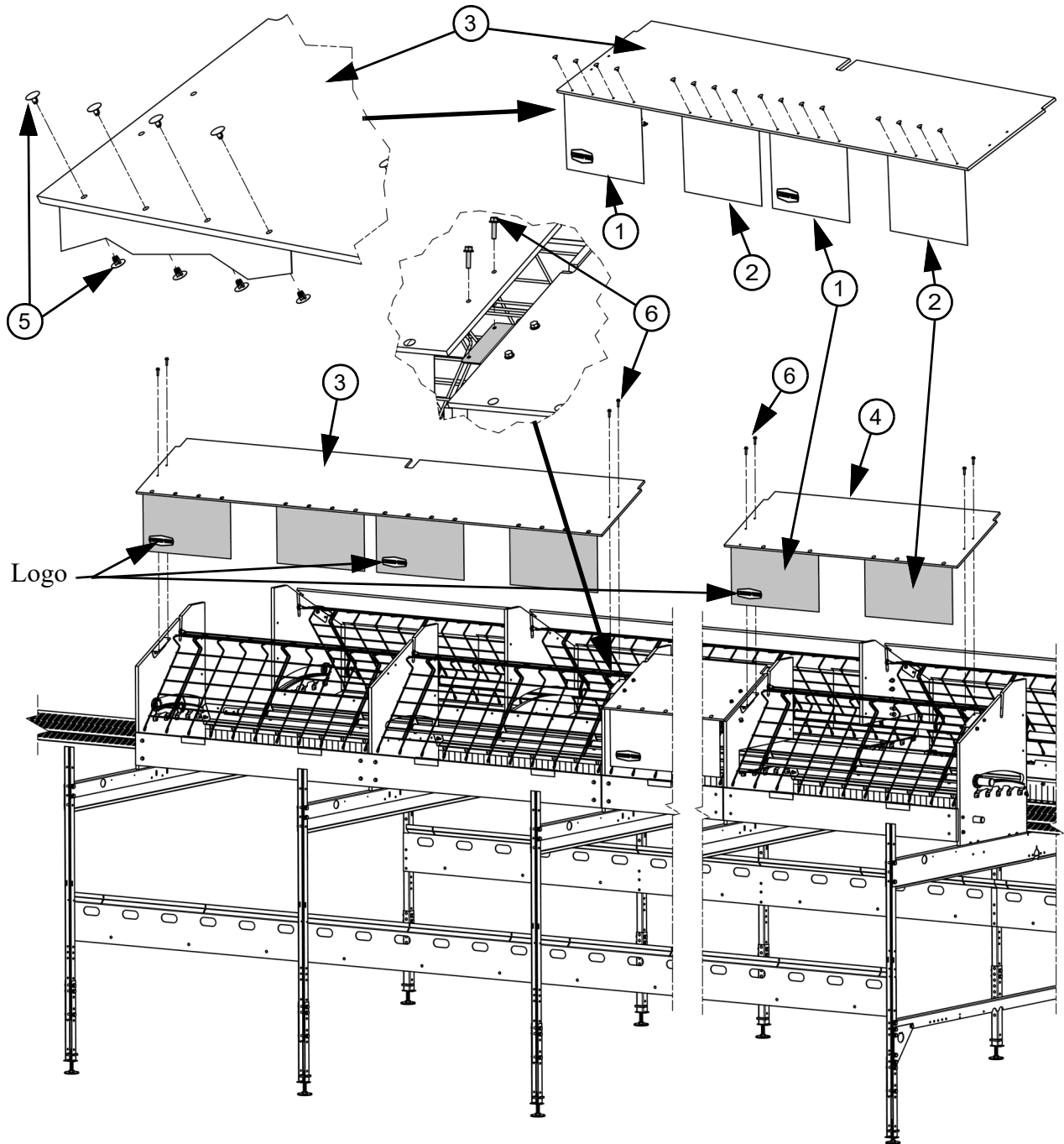

Item	Description	Part No.
1	Nest Front Curtain with Logo	57887
2	Nest Front Curtain	57886
3	Vike Nest Roof (2400)	58503
4	Vike Nest Roof (1200)	58503-1
5	Two Piece Rivet	58302
6	M6 x 25 DIN7500-D Tapite	201067

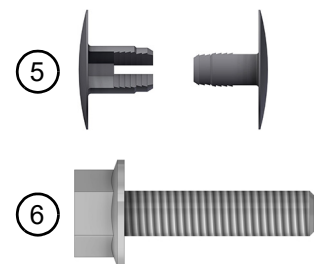

Figure 33. Curtain/Roof Assembly & Installation

# Valego® RDE Nest Control (601150)

See the installation manual included with the 601150 Control for Installation and operation instructions.

## Part Numbers

### Miscellaneous Parts

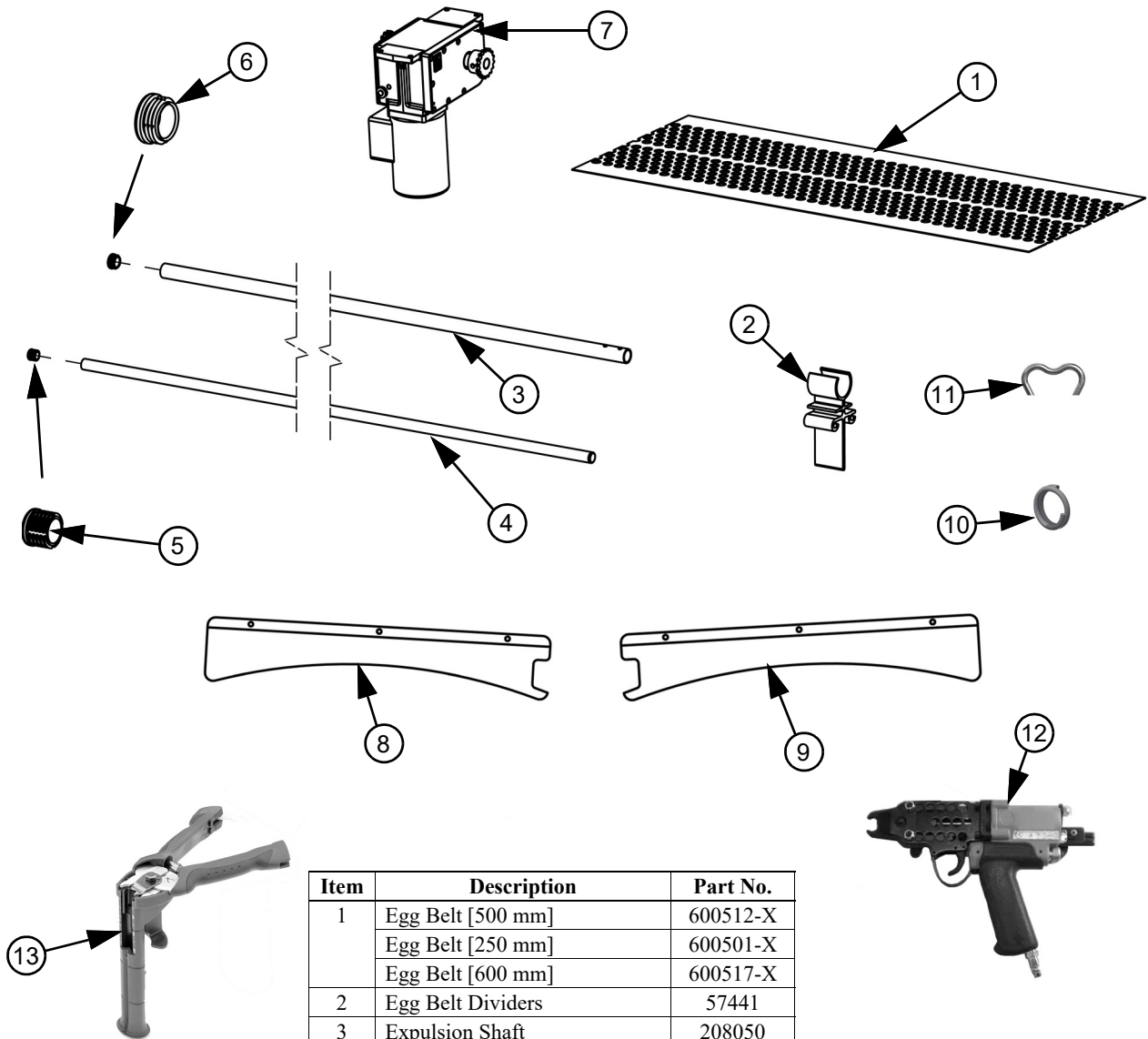

Item	Description	Part No.
1	Egg Belt [500 mm]	600512-X
	Egg Belt [250 mm]	600501-X
	Egg Belt [600 mm]	600517-X
2	Egg Belt Dividers	57441
3	Expulsion Shaft	208050
4	25 mm Floor Support Tube	208040
5	25 mm Round Plastic Cap	201080
6	33.4 mm Tube Plug	201038
7	50 Hz Motor (EU)	603104
	60 Hz Motor (US)	603119
8	RDE Tube Hold Down (Right)	57835-2
9	RDE Tube Hold Down (Left)	57835-1
10	Wire Ring	E2736
11	Staple	201066
12	Ring Tool	E3042
13	Mesh Staple Pliers	201127

### RDE 49 (58506-X) & 58 (58505-X) Nest Kits

There are three different Nest Kits that share many of the same part numbers. The following two pages show part numbers shared by all three kits. See the second page for part numbers that are specific to the Starter -1, 2, and -4 Kits.

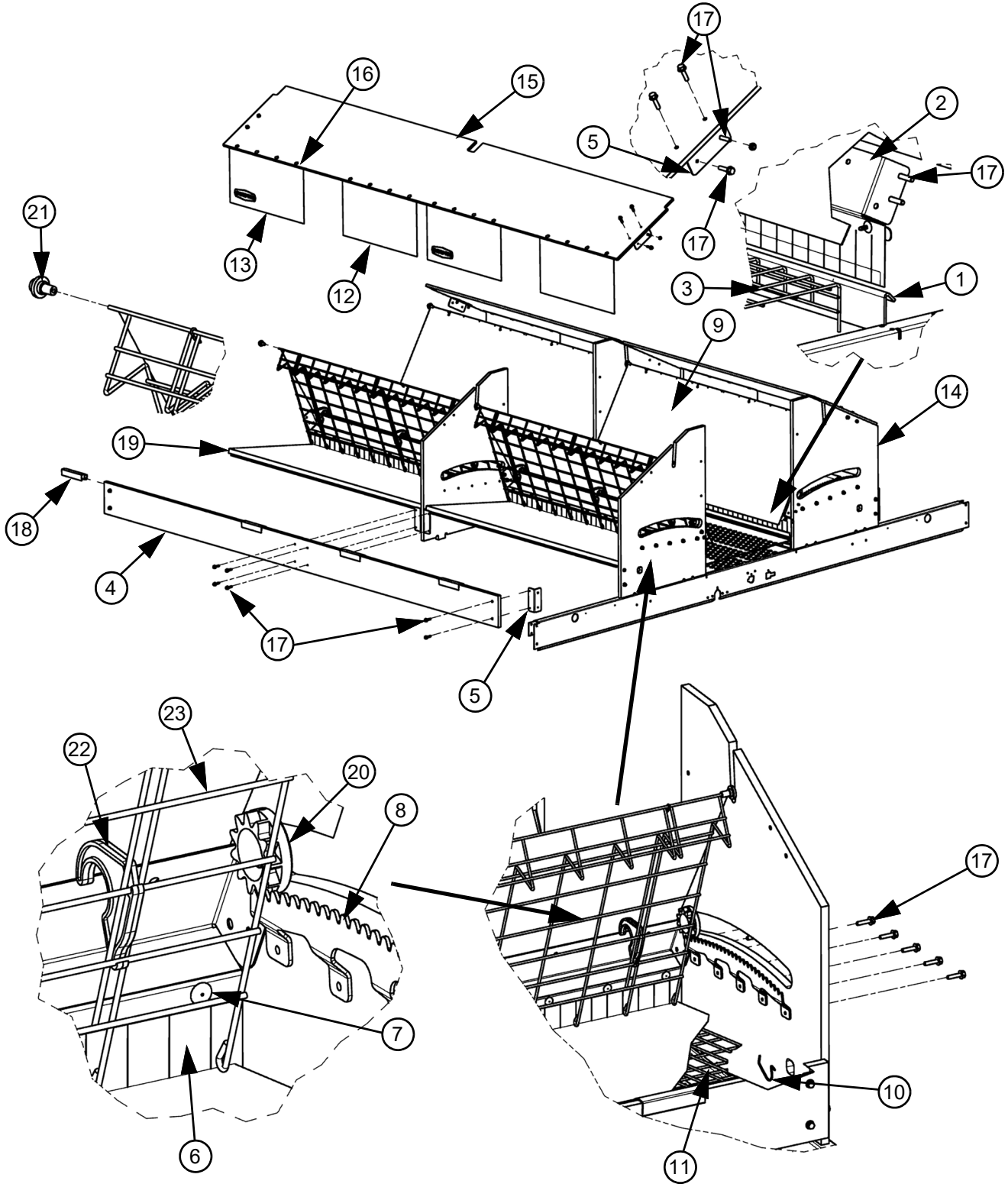

### Starter and 1.2m Specific Kit Parts.....

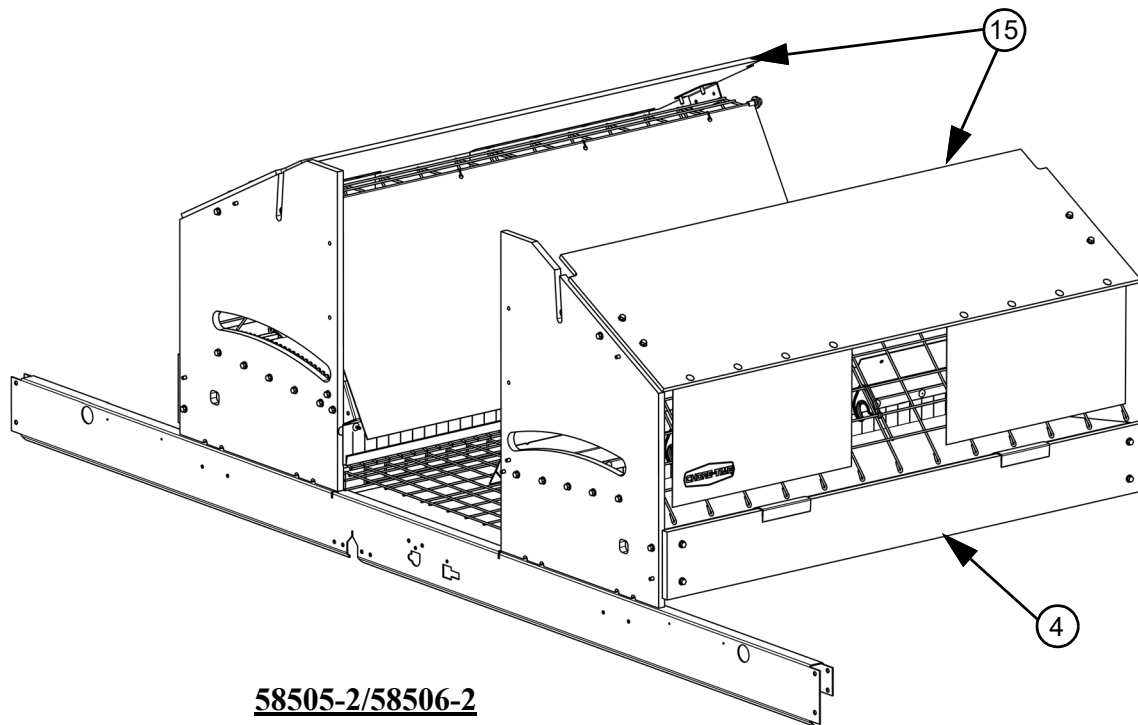

**58505-2/58506-2**  
**& 58505-4/58506-4**  
**1.2m Kits**

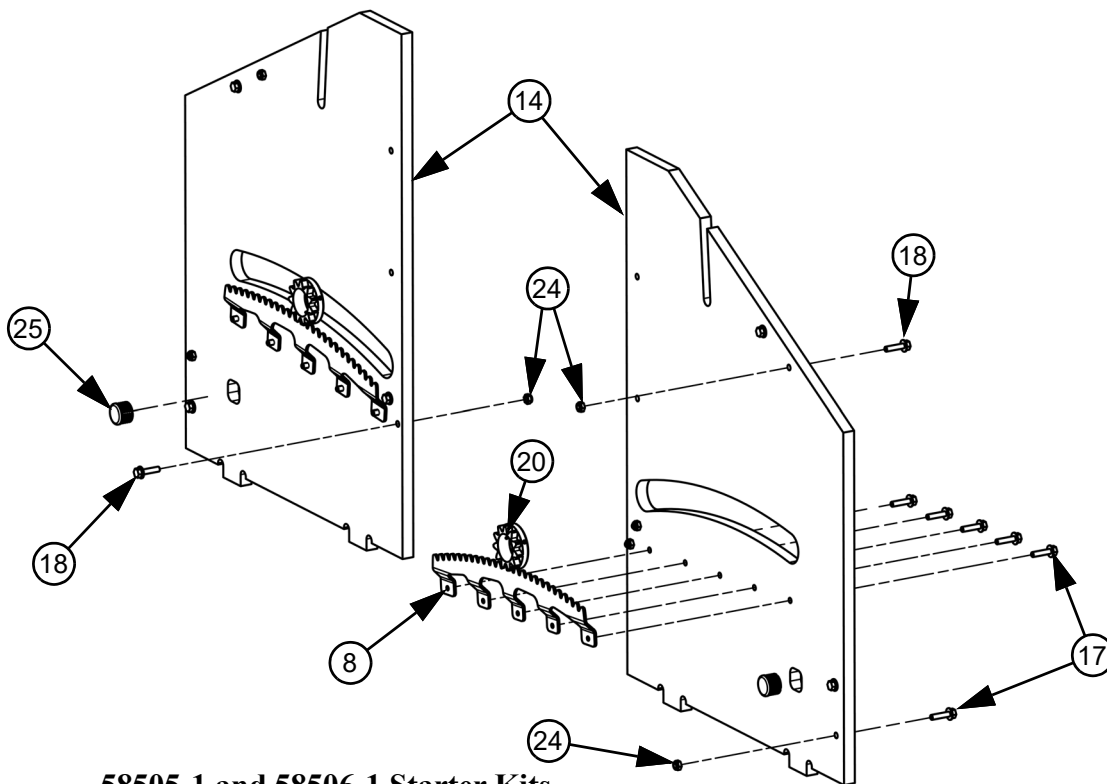

**58505-1 and 58506-1 Starter Kits**

## Part Numbers

Item	Description	RDE 49					RDE-58				
		58506-1 Start Kit	58506 Vike 2400	58506-2 Vike 1200	58506-3 Vike 2400 600mm	58506-4 Vike 1200 600mm	58505-1 Start Kit	58505 Vike 2400	58505-2 Vike 1200	58505-3 Vike 2400 600mm	58505-4 Vike 1200 600mm
1	Nest Bottom Rail	--	56683	56683	56683	56683	--	56683	56683	56683	56683
2	Nest Back Rail	--	56684	56684	56684	56684	--	56684	56684	56684	56684
3	500mm Egg Tray	--	56685	56685	--	--	--	56685	56685	--	--
	600mm Egg Tray	--	--	--	58008	58008	--	--	--	58008	58008
4	Nest Entrance Board (2.4 m)	--	56691	--	56691	--	--	56691	--	56691	
	Nest Entrance Board (1.2 m)	--	--	56691-1	--	56691-1	--	--	56691-1	--	56691-1
5	Corner Bracket	--	56692	56692	56692	56692	--	56692	56692	56692	56692
6	Egg Curtain	--	56863	56863	56863	56863	--	56863	56863	56863	56863
7	2 Piece Rivet	--	56879	56879	56879	56879	--	56879	56879	56879	56879
8	RDE 58 Toothed Rack Plate	--	--	--	--	--	56993	56993	56993	56993	56993
	RDE49 Toothed Rack Plate	600602	600602	600602	600602	600602	--	--	--	--	--
9	RDE Back Wall	--	57003-1	57003-1	57003-1	57003-1	--	57003-1	57003-1	57003-1	57003-1
10	Nest Floor Wire Clip	--	57004	57004	57004	57004	--	57004	57004	57004	57004
11	RDE-58 Nest Bottom	--	57296	57296	57296	57296	--	57296	57296	57296	57296
12	Front Nest Curtain	--	57886	57886	57886	57886	--	57886	57886	57886	57886
13	Front Nest Curtain w/Logo	--	57887	57886	57886	57886	--	57886	57886	57886	57886
14	RDE 58 Vike Side Panel	58502	58502	58502	58502	58502	--	--	--	--	--
	RDE 49 Vike Side Panel	--	--	--	--	--	58501	58501	58501	58501	58501
15	2400 Vike Nest Roof	--	58503	--	58503	--	--	58503	--	58503	--
	1200 Vike Nest Roof	--	--	58503-1	--	58503-1	--	--	58503-1	--	58503-1
16	.250x.346-.500 2 Piece Rivet	--	58302	58302	58302	58302	--	58302	58302	58302	58302
17	M6 x 25 DIN7500-D Taptite	201067	201067	201067	201067	201067	201067	201067	201067	201067	201067
18	Nest Pad Clip	--	201223	201223	201223	201223	--	201223	201223	201223	201223
19	590 x 1175 Nest Pad	--	--	--	--	--	--	600357	600357	600357	600357
	500 x 1175 Nest Pad	--	600355	600355	600355	600355	--	--	--	--	--
20	Toothed Single Sided Wheel	600622	600622	600622	600622	600622	600622	600622	600622	600622	600622
21	Expulsion Panel Lock Bushing	--	600789	600789	600789	600789	--	600789	600789	600789	600789
22	Expulsion Panel Clamp	--	600795	600795	600795	600795	--	600795	600795	600795	600795
23	RDE 58 Vike Expeller	--	58783	58783	58783	58783	--	58783	58783	58783	58783
	RDE 49 Vike Expeller	--	600421	600421	600421	600421	--	600421	600421	600421	600421
24	M6 DIN985 Lock Nut	201037	--	--	--	--	201037	--	--	--	--
25	25mm Plastic Cap	201080	--	--	--	--	201080	--	--	--	--

# Expulsion Unit

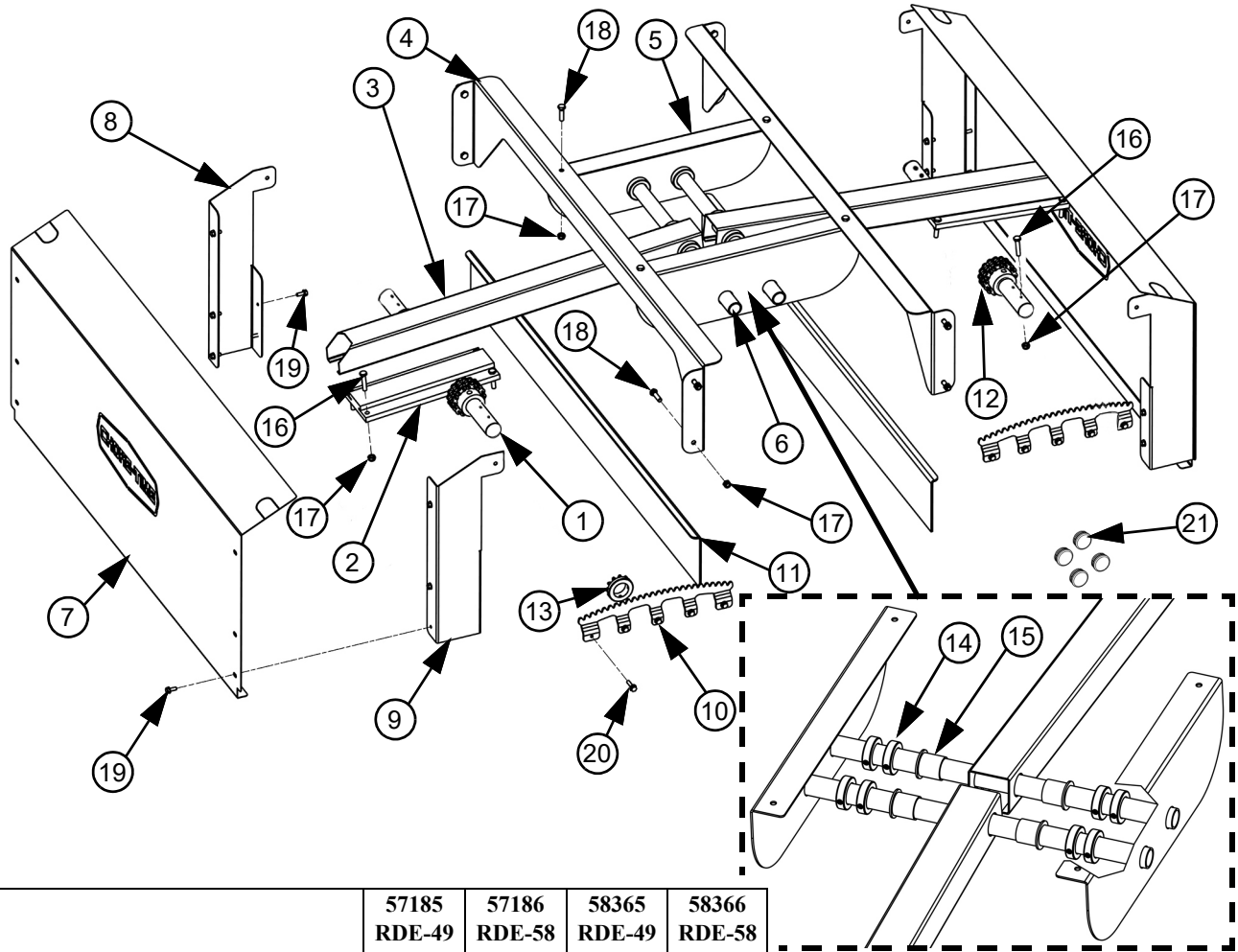

		57185 RDE-49	57186 RDE-58	58365 RDE-49 600mm	58366 RDE-58 600mm
Item	Description	Part No.			
1	Expulsion Shaft Coupling	603140	603140	603140	603140
2	Motor Mounting Plate	600631	600631	600631	600631
3	Expeller Mtg. Profile	600630	600646	600630	600646
4	Expeller Mount Cross	57187	57187	57187	57187
5	Expeller Tube Support	57188	57188	58367	58367
6	500 MM RDE Mounting Profile Expeller Pipe	600638	600638	600638	600638
7	RDE Front Expulsion Cover	57212	57212	57212	57212
8	RDE Cover Side Brace (Left)	57213-2	57213-2	57213-2	57213-2
9	RDE Cover Side Brace (Right)	57213-1	57213-1	57213-1	57213-1
10	RDE Rack Plate	600602	56993	600602	56993
11	Egg Expulsion Plate	57206	57206	57206	57206
12*	Chain Coupling	603113	603113	603113	603113
13*	Toothed Single Sided Wheel	600622	600622	600622	600622
14*	32 mm DIN 705A Set Collar	201140	201140	201140	201140
15*	34.2x30.1x35mm Flanged Sleeve Bearing	201139	201139	201139	201139
16*	M8 X 40 DIN933 Hex Bolt	201006	201006	201006	201006
17*	M8 DIN985 Lock Nut	201003	201003	201003	201003
18*	M8 x 30 DIN933 Bolt	201007	201007	201007	201007
19*	M6x16 DIN7500D Taptite	201077	201077	201077	201077
20*	M6 x 25 DIN7500-D Taptite	201067	201067	201067	201067
21*	33.4mm Round Tube Plug	201038	201038	201038	201038
*Included in 57891 Hardware Package.					

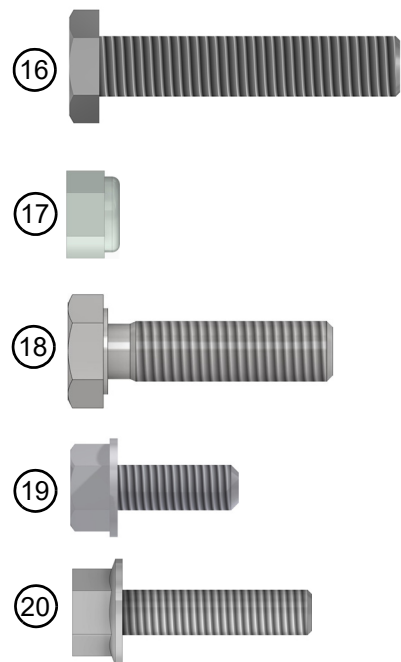

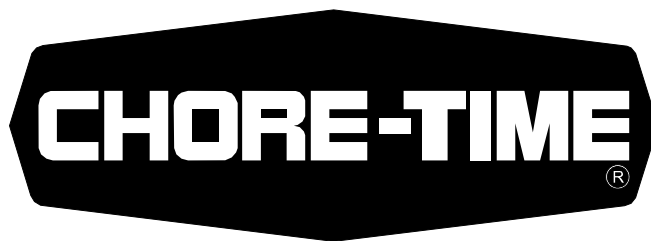

**MADE TO WORK.  
BUILT TO LAST.®**

**Revisions to this Manual+**

<b>Page No.</b>	<b>Description of Change</b>	<b>ECO</b>
29	Added E2736 Ring and E3042 Ring Tool	41177
31	Added Wire Ring, Ring Tool, Staple, and Mesh Staple Pliers	
34	Moved E2736 (Item 17) to Miscellaneous page, Re-numbered items	

**For additional parts and information, contact your nearest Chore-Time distributor or representative.  
Find your nearest distributor at: [www.choretime.com/contacts](http://www.choretime.com/contacts)**

CTB, Inc.  
PO Box 2000  
Milford, Indiana 46542-2000 USA  
Phone (574) 658-4101 Fax (877) 730-8825  
Email: [choretime@choretime.com](mailto:choretime@choretime.com)  
Internet: [www.choretime.com](http://www.choretime.com)